

West Valley @ 224th Building B | FOR LEASE

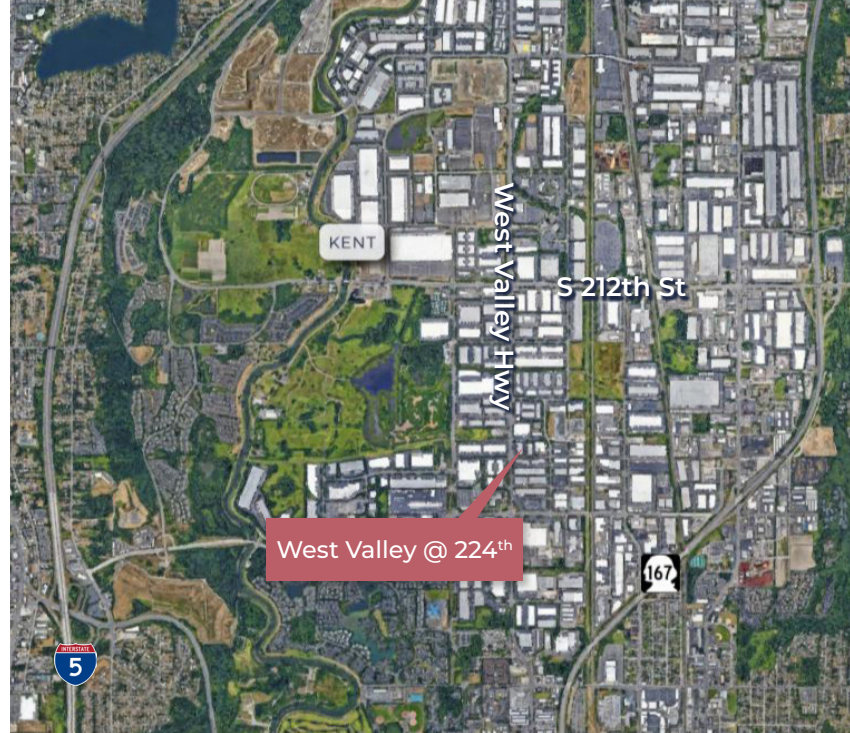

6848 South 224th Street, Kent, WA 98032

- 10,810 SF
- 1,683 SF Office
- 20' Clear height
- 4 Dock-high doors
- 1 Grade-level door
- Available November 1, 2026
- 2026 est. NNN \$0.41/SF
- Located in the heart of Kent Valley with great access to I-5, I-405 and SR-167.



Matt Wood, SIOR
206 595 6814
matt.wood@kbcadvisors.com

John Broom
206 877 2750
john.broom@kbcadvisors.com

KBCADVISORS.COM

West Valley @ 224th Building B

6848 S 224th St. Kent, WA 98032

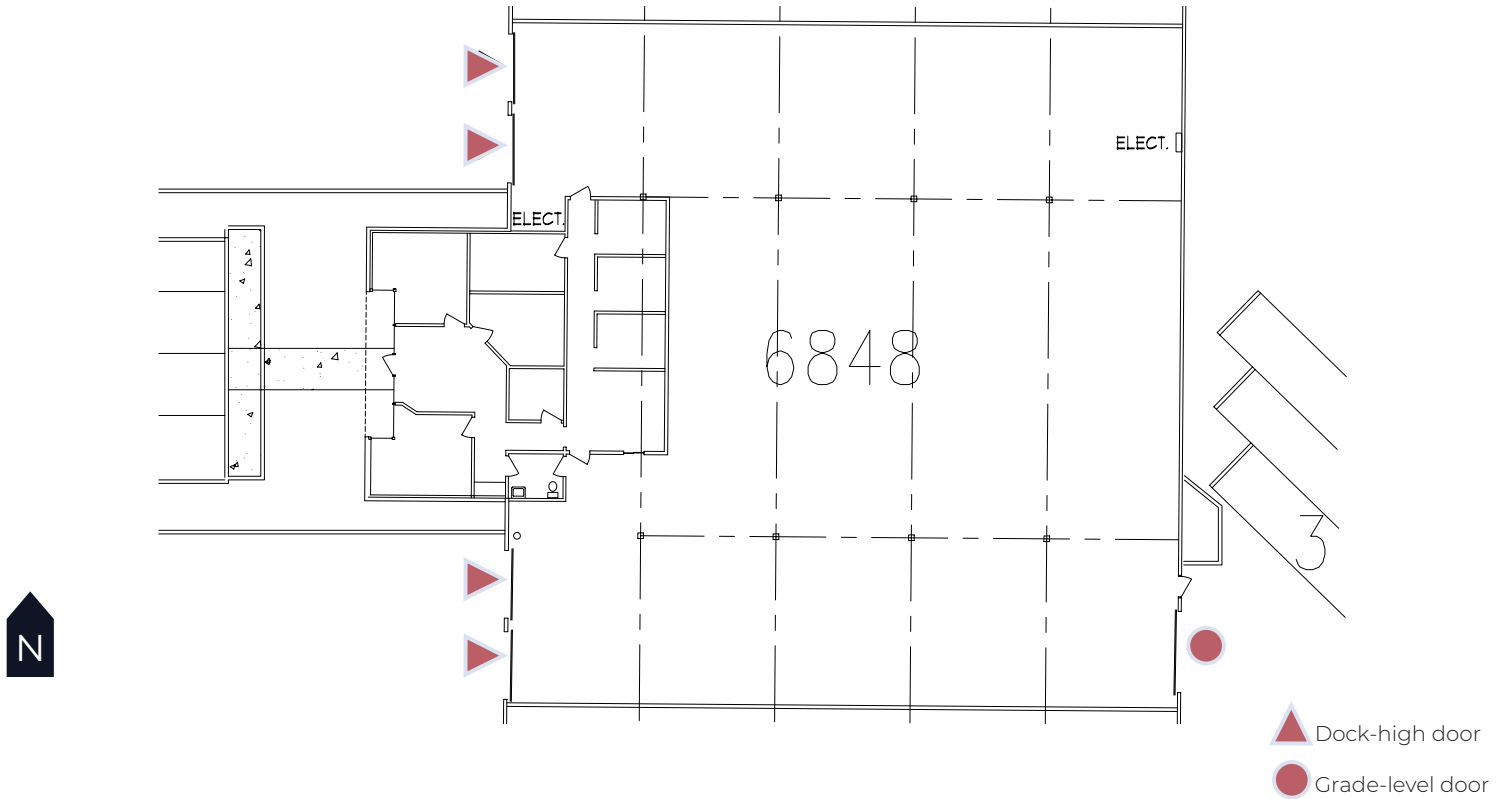

Space Information

Building SF	10, 810 SF
Office SF	1,683 SF
Clear Height	20'
Loading Doors	4 Dock-high 1 Grade-level
Available	November 1, 2026

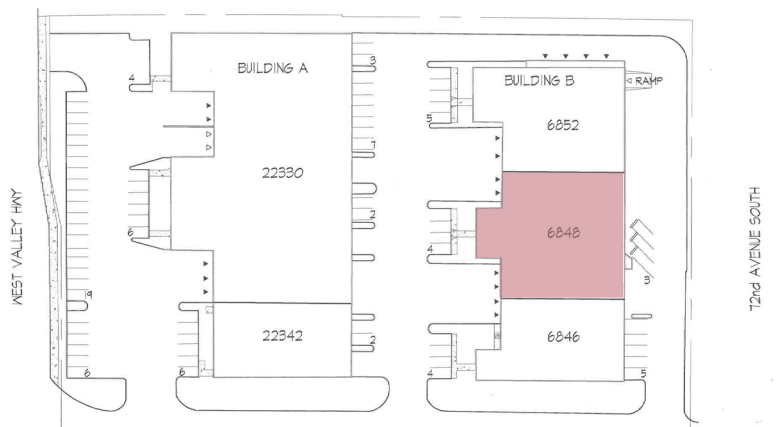

Matt Wood, SIOR
206 595 6814
matt.wood@kbcadvisors.com

John Broom
206 877 2750
john.broom@kbcadvisors.com

KBCADVISORS.COM

© 2026 KBC ADVISORS This information has been obtained from sources believed to be reliable but has not been verified for accuracy or completeness. You should conduct a careful, independent investigation of the property and verify all information. Any reliance on this information is solely at your own risk. The KBC ADVISORS logo is a service mark of KBC ADVISORS. All other marks displayed on this document are the property of their respective owners. Photos herein are the property of their respective owners. Use of these images without the express written consent of the owners is prohibited.