

FOR LEASE

Sea King Industrial Park

1601 South 92nd Place, Seattle, WA 98108

Immediate Access
to SR-99



Rare Institutional
Dock-High Spaces



Minutes to
Boeing Field



Near Port of
Seattle

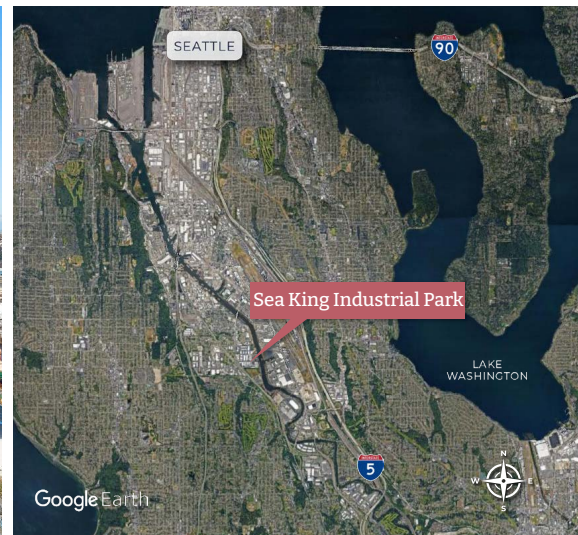

Kevin Skillestad
+1 206 715 0757
kevin.skillestad@kbcadvisors.com

Michael Roy
+1 206 940 7199
michael.roy@kbcadvisors.com

Hans Vieser
+1 425 765 7926
hans.vieser@kbcadvisors.com

KBC Advisors | Seattle
5628 Airport Way, Suite 238
Seattle, WA 98108

KBCADVISORS

Floor Plan

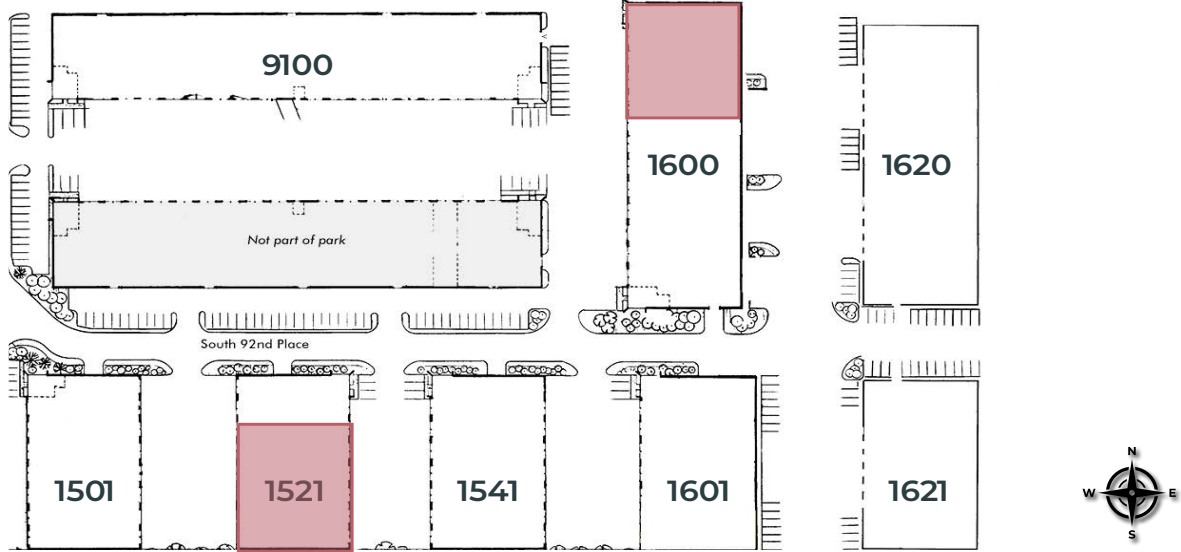

Building	Suite	Available SF (Office)	Loading Doors	Clear Height	Comments
1521	110	18,124 (973)	12 DH 10 GL	18'	End cap unit. Available 6/1/2026.

1600	100	19,165 (3,134)	5 DH 3 GL	24'	End cap unit. Available now.
------	-----	----------------	--------------	-----	------------------------------



Kevin Skillestad
 +1 206 715 0757
 kevin.skillestad@kbcadvisors.com

Michael Roy
 +1 206 940 7199
 michael.roy@kbcadvisors.com

Hans Vieser
 +1 425 765 7926
 hans.vieser@kbcadvisors.com

KBC Advisors | Seattle
 5628 Airport Way, Suite 238
 Seattle, WA 98108

© 2026 KBC ADVISORS This information has been obtained from sources believed to be reliable but has not been verified for accuracy or completeness, and KBC Advisors disclaims any guarantees, warranties or representations, express or implied, as to the completeness or accuracy as to the information contained herein. You should conduct a careful, independent investigation of the property and verify all information. Any reliance on this information is solely at your own risk. The KBC ADVISORS logo is a service mark of KBC ADVISORS. All other marks displayed on this document are the property of their respective owners. Photos herein are the property of their respective owners. Use of these images without the express written consent of the owners is prohibited.