



SUNRIDGE INDUSTRIAL PARK

200 SUNRIDGE BLVD, WILMER, TX

565,259 SF AVAILABLE
CLASS A INDUSTRIAL BUILDING



AVAILABLE NOW!



STONEMONT



Property Specifications

BUILDING FEATURES

Building Size	565,259 SF AVAILABLE
Building Footprint	470' X 1,176'
Office Space	3,091 SPEC OFFICE
Typical Bay Spacing	56'W X 50'-60'D, WITH 70' SPEED BAYS
Clear Height	40'
Dock Doors	128
Dock Levelers	20 (35K LBS)
Ramps	4
Car Parks	308
Trailer Storage	135
Truck Court	135'-190'
Roof	60MIL TPO MEMBRANE, 20 YR WARRANTY
Floor Slab	7" REINFORCED SLAB W/ #3 BARS @ 18" O.C.
Power	3000 AMPS, 3PH/480V ESFR
Warehouse Lighting	LED WAREHOUSE LIGHTING TO 25 FC

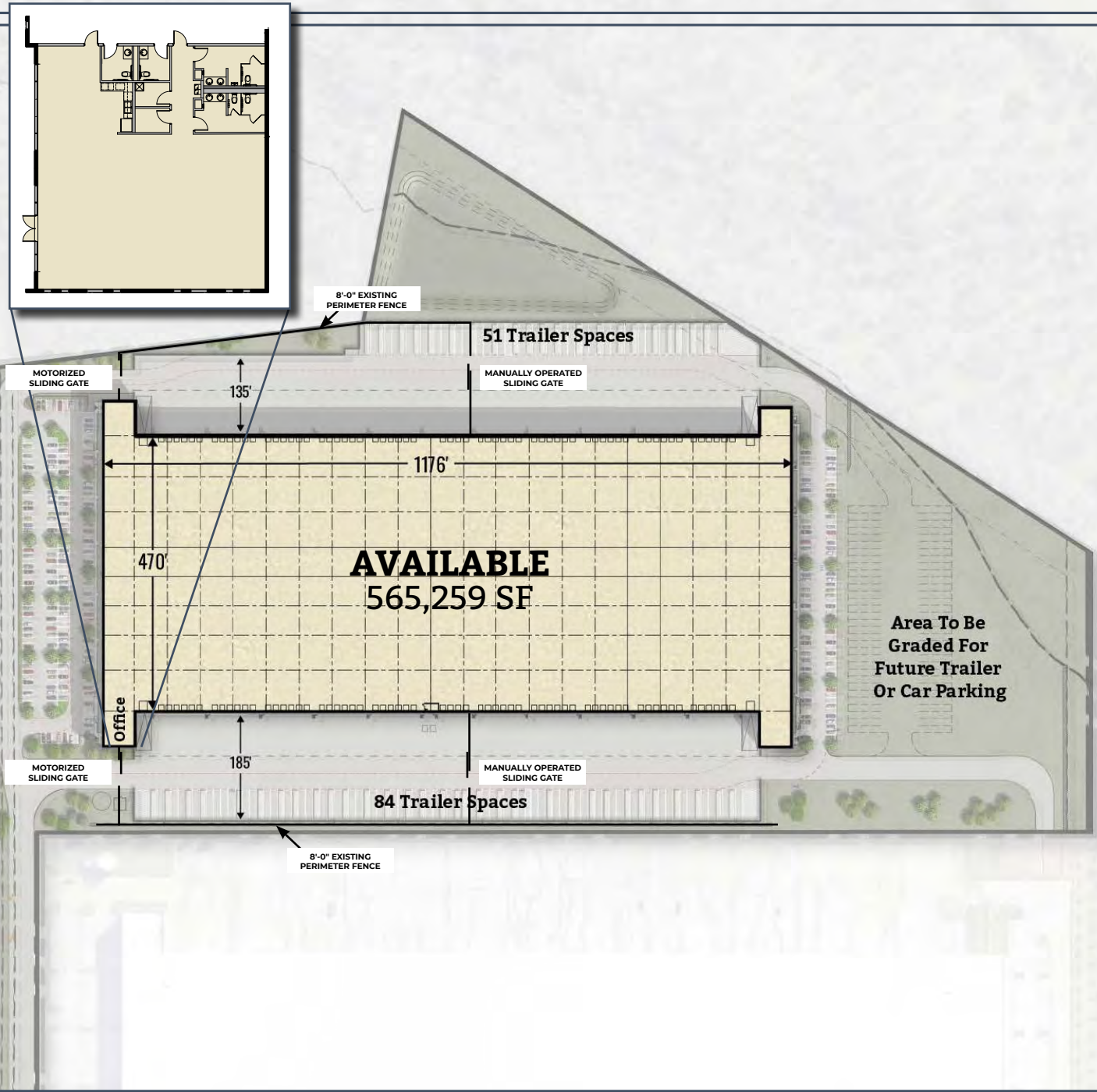

Nathan Lawrence
 +1 214 402 6016
 nathan.lawrence@kbcadvisors.com

Krista Raymond
 +1 972 971 2785
 krista.raymond@kbcadvisors.com

Whit Maddox
 +1 817 437 5708
 whit.maddox@kbcadvisors.com

Will Carney
 +1 214 240 0014
 will.carney@kbcadvisors.com



STONEMONT



Location Overview

PROPERTY ADVANTAGES

-  Class A Logistics Facilities
-  Proven Industrial District
-  Superior Highway Access
-  Triple Freeport Tax Exemption

LOCATION ADVANTAGES

- I-45 1 Mile
- UP Intermodal 1.5 Miles
- FedEx Ground Hub 5 Miles
- I-20 6 Miles
- Dallas CBD 15 Miles

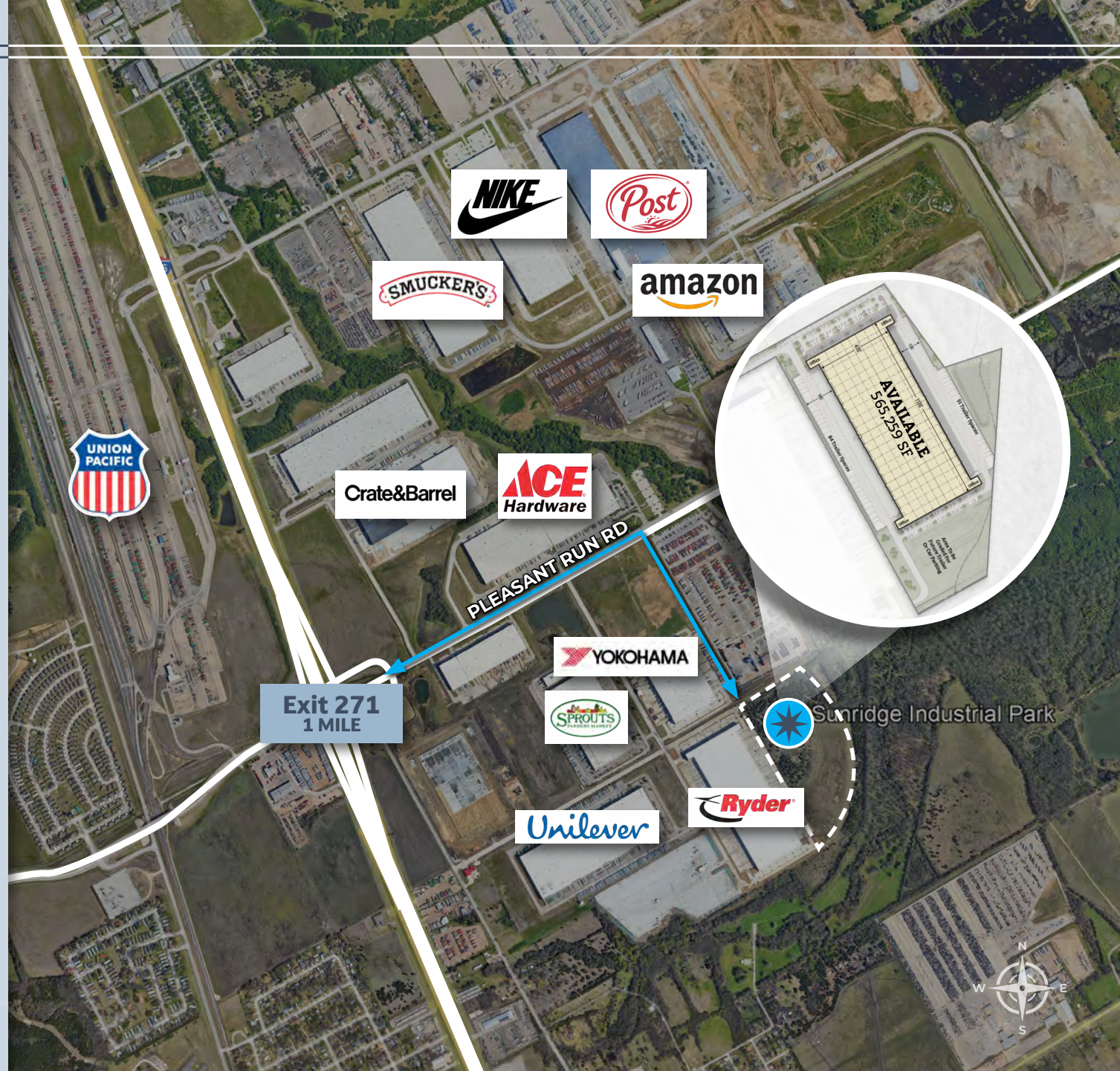

Nathan Lawrence
 +1 214 402 6016
 nathan.lawrence@kbcadvisors.com

Krista Raymond
 +1 972 971 2785
 krista.raymond@kbcadvisors.com

Whit Maddox
 +1 817 437 5708
 whit.maddox@kbcadvisors.com

Will Carney
 +1 214 240 0014
 will.carney@kbcadvisors.com



STONEMONT



Property Photos

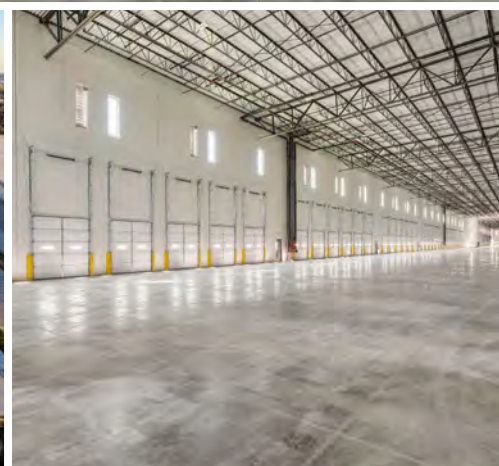

Nathan Lawrence
+1 214 402 6016
nathan.lawrence@kbcadvisors.com

Krista Raymond
+1 972 971 2785
krista.raymond@kbcadvisors.com

Whit Maddox
+1 817 437 5708
whit.maddox@kbcadvisors.com

Will Carney
+1 214 240 0014
will.carney@kbcadvisors.com



STONEMONT



Surrounding Neighbors

- | | |
|---|--|
| 1  Georgia-Pacific | 15  |
| 2  | 16  |
| 3  Georgia-Pacific | 17  |
| 4  | 18  |
| 5  Georgia-Pacific | 19  |
| 6  | 20  |
| 7  | 21  |
| 8  | 22  |
| 9  | 23  |
| 10  | 24  |
| 11  | 25  |
| 12  | 26  |
| 13  | 27  |
| 14  | |



Nathan Lawrence
 +1 214 402 6016
 nathan.lawrence@kbcadvisors.com

Krista Raymond
 +1 972 971 2785
 krista.raymond@kbcadvisors.com

Whit Maddox
 +1 817 437 5708
 whit.maddox@kbcadvisors.com

Will Carney
 +1 214 240 0014
 will.carney@kbcadvisors.com



STONEMONT

