



FOR SUBLEASE

## 30,000 – 60,000 SF Warehouse

7811-7915 South 188th Street, Kent, WA 98032

- 9,775 SF 2nd Floor office
- 12 Dock-high doors
- Lunchroom & Restrooms
- Controlled access
- Excess trailer/car parking
- Adjacent service shop available
- Term Through 12/31/28
- Asking Rate: \$0.50 PSF + NNN's

**Matt Wood, SIOR**  
+1 206 595 6814  
matt.wood@kbcadvisors.com

**John Broom**  
+1 206 877 2750  
john.broom@kbcadvisors.com

**KBC Advisors | Seattle**  
5628 Airport Way, Suite 238  
Seattle, WA 98108

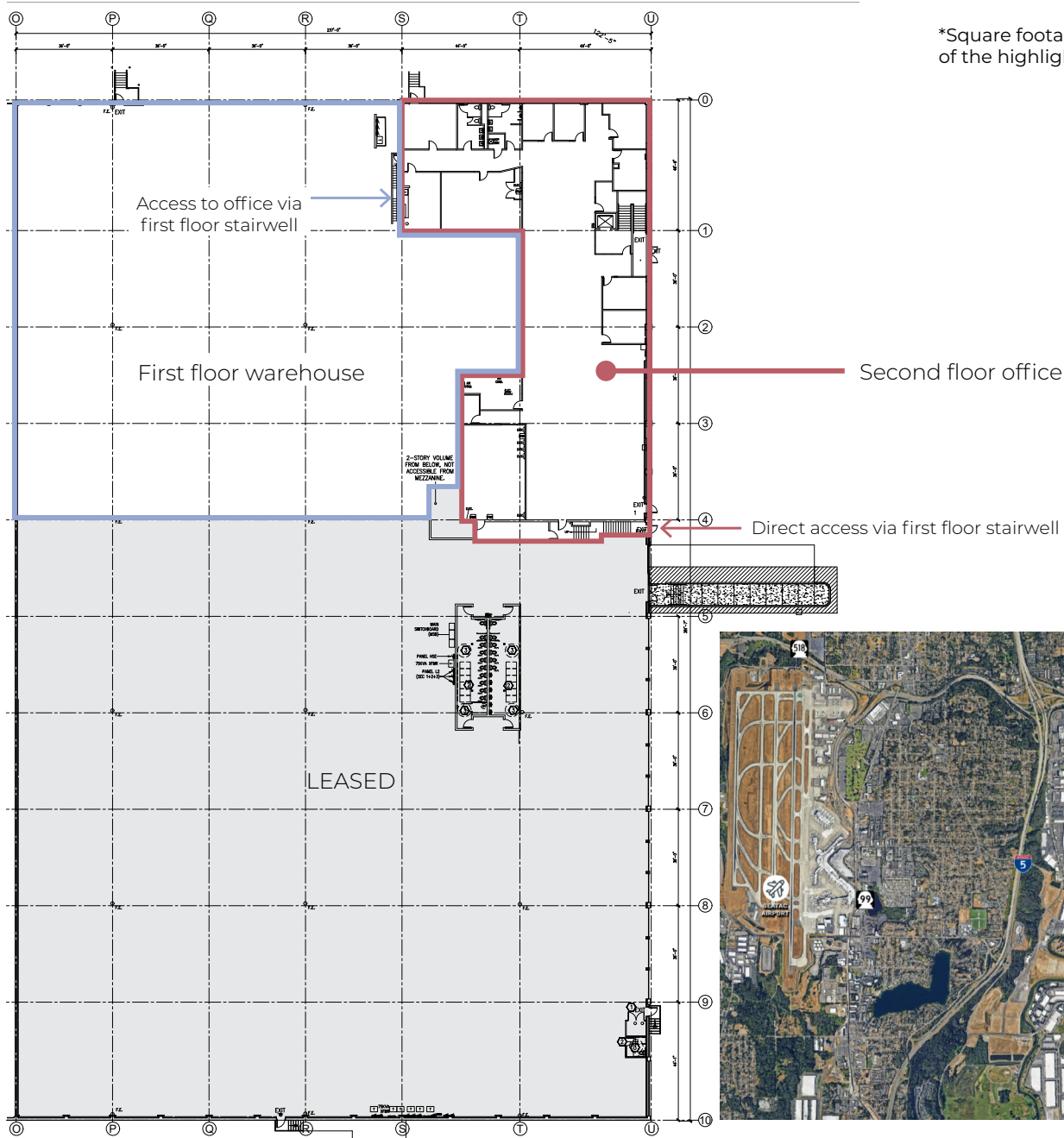

\*Square footage is an estimate of the highlighted area.

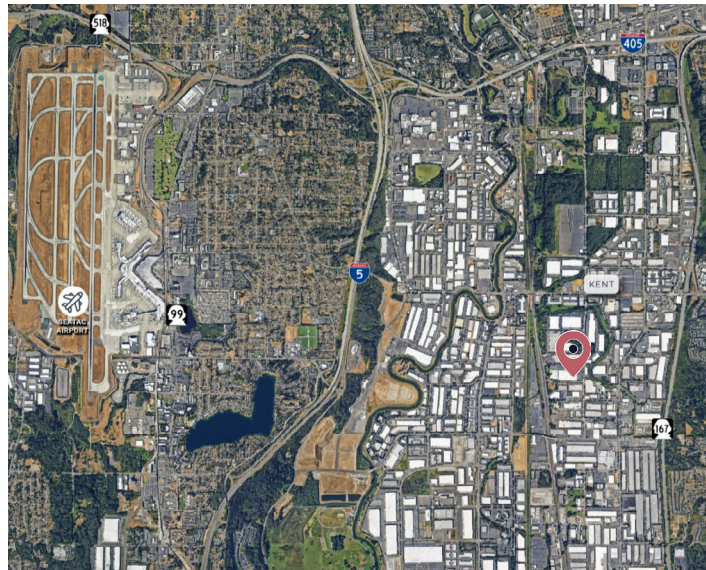

**Matt Wood, SIOR**  
 +1 206 595 6814  
 matt.wood@kbcadvisors.com

**John Broom**  
 +1 206 877 2750  
 john.broom@kbcadvisors.com

**KBC Advisors | Seattle**  
 5628 Airport Way, Suite 238  
 Seattle, WA 98108

© 2026 KBC ADVISORS This information has been obtained from sources believed to be reliable but has not been verified for accuracy or completeness, and KBC Advisors disclaims any guarantees, warranties or representations, express or implied, as to the completeness or accuracy as to the information contained herein. You should conduct a careful, independent investigation of the property and verify all information. Any reliance on this information is solely at your own risk. The KBC ADVISORS logo is a service mark of KBC ADVISORS. All other marks displayed on this document are the property of their respective owners. Photos herein are the property of their respective owners. Use of these images without the express written consent of the owners is prohibited.

