

# 19,500 SF

**20408 87th Ave S  
Kent, WA 98031**

Northwest Corporate Park Kent 9

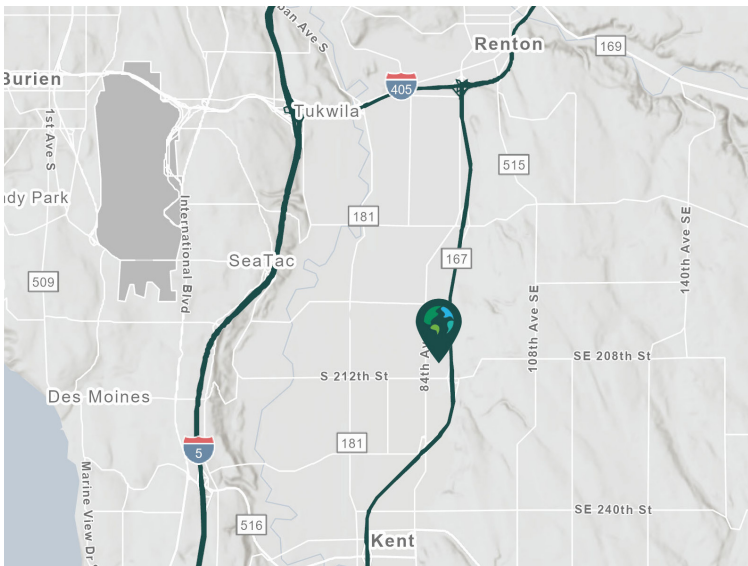

## Property Features

Available Space	19,500 SF
Office SF	942 SF
Clear Height	24'
Dock Doors	7
Drive-In Doors	1
Rail Doors	2
Availability	August 1, 2026

- 50-yard line location
- Great access to Hwy 167, I-5, and I-405



Unlock the full potential of your warehouse with one strategic, single-source partner.

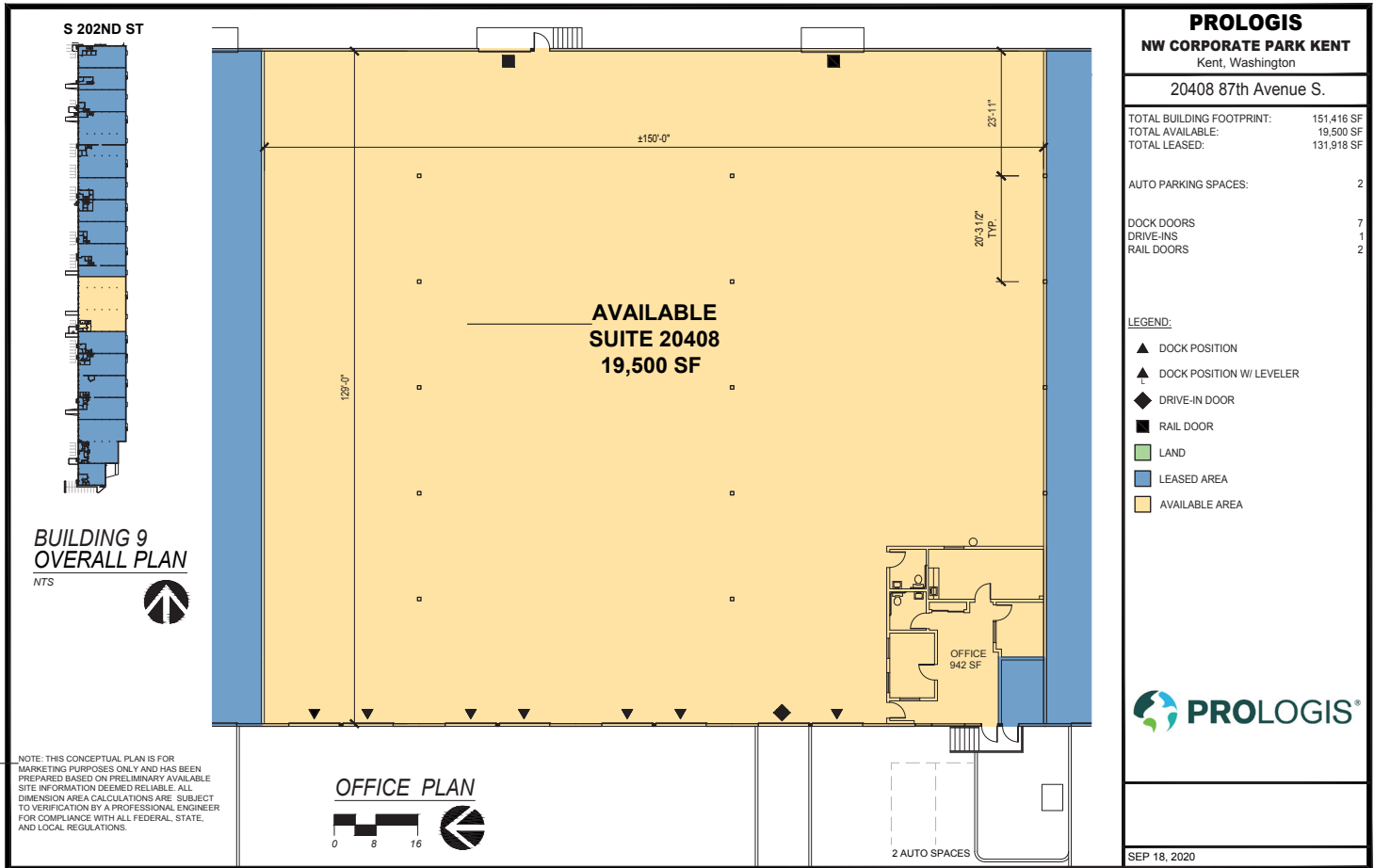

**KBC Advisors**  
**Matt Wood, SIOR**  
matt.wood@kbcadvisors.com  
ph +1 206 741 1030  
cell +1 206 595 6814

**KBC Advisors**  
**Hans Vieser**  
hans.vieser@kbcadvisors.com  
ph +1 206 741 1030  
cell +1 425 765 7926

**Prologis**  
**Kimberley Nemethy**  
knemethy@prologis.com  
ph +1 206 414 7616  
cell +1 253 508 1737