

BMI Icopal Profiles XL FireSmart

Concrete Deck: Cold Roof System

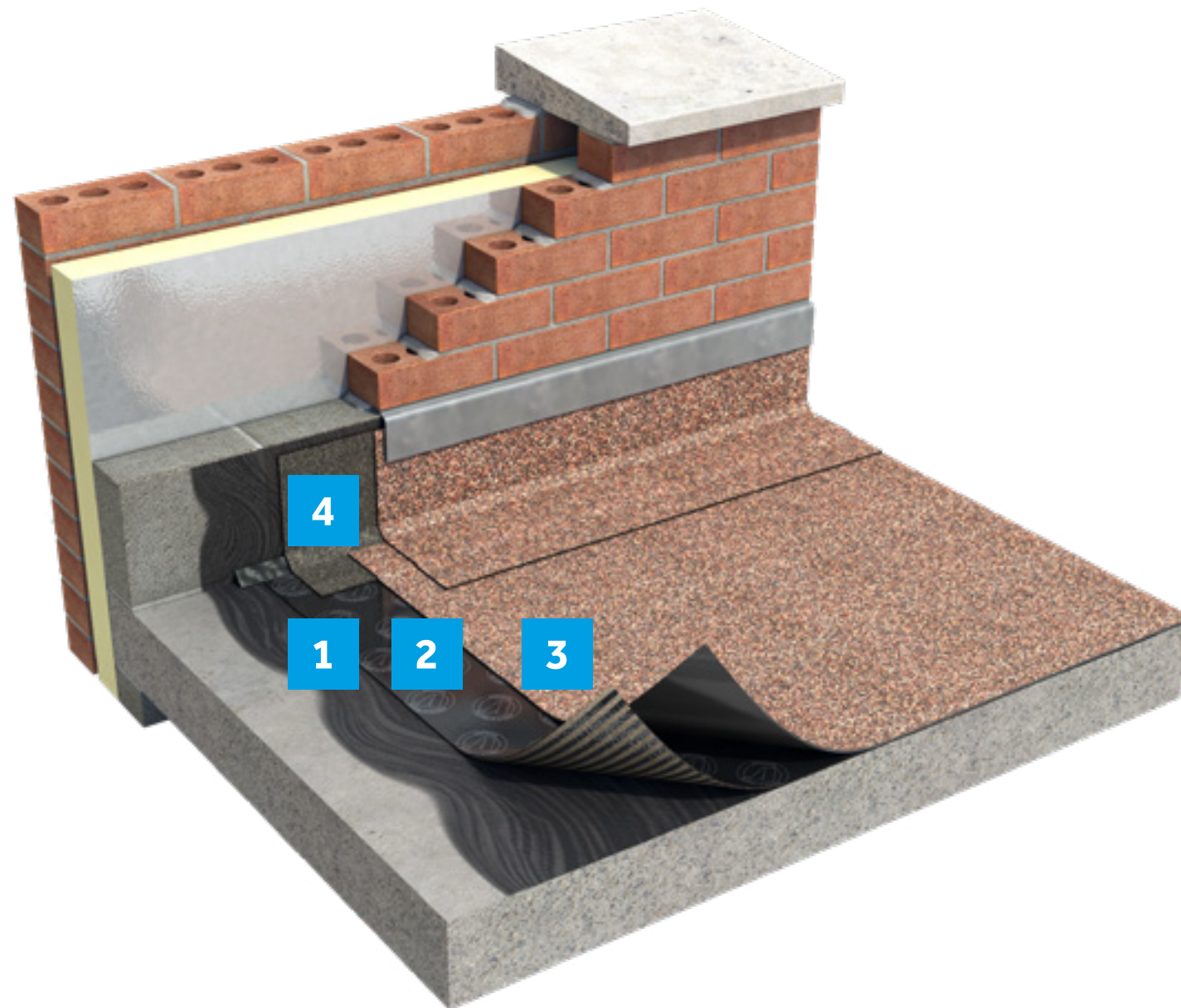

System features and benefits

Profiles XL Firesmart

- High-quality SBS modified bitumen membranes for flexibility.
- Exceptional durability for long-lasting peace of mind.
- Compatible with self-adhesive membranes for flame-free detailing.
- Installed via IMA Approved Contractor Network
- Incorporates FireSmart technology for safety and compliance.
- Extended guarantee available up to 25 years.

Quality without compromise

BMI Icopal Profiles is the UK's premier range of tried-and-tested bitumen roofing systems. Perfectly suited to the UK climate and the demands of UK projects, Profiles combines premium systems, professional installation, and the support of our flat roofing experts, from specification, design and diagnostics, to full system and workmanship guarantees. Putting quality at the core, **Profiles gives you control, cost certainty and confidence that your roofs will perform and protect your clients' investment for longer** – without compromise.

System layer	Product
1 Primer	Siplast Primer
2 Underlay	Profiles Vent XL
3 Cap sheet	Profiles XL FireSmart
4 Detailing underlay	Profiles XL Sand



Profiles is supported by evidence-based diagnostic technologies including in-depth moisture mapping.

[Explore our moisture mapping service](#)

Specifying Profiles

Profiles can be specified as a complete system comprising a number of component options to suit the specific challenges and requirements of your project. Recommendations on building your custom Profiles system can be found in our System Selector tool.

[Explore our systems](#)

Protected in every profile

For absolute peace of mind, Profiles is protected by a range of guarantees covering both system and IMA-installed workmanship for up to 30 years, giving you greater confidence in the lifetime performance of your roof, as well as reducing risk and responsibility through fewer call-backs and in-depth support from the BMI Icopal team.

[Explore our support and services](#)



BMI Icopal Profiles XL FireSmart

System Variations: Cold Roof System

PROFILES XL FIRESMART : OSB OR PLY SUBSTRATE

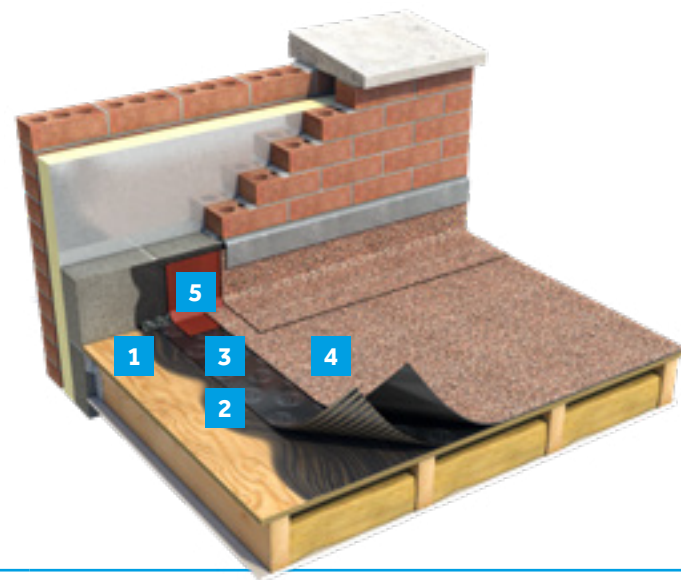

System layer	Product
1	Preparation HT125 Tape
2	Primer SA Primer
3	Underlay TorchSafe TA Underlay
4	Cap sheet Profiles XL FireSmart
5	Detailing underlay Torchsafe TA Detailing Underlay

PROFILES XL FIRESMART : OVERLAY – NON COMBUSTIBLE

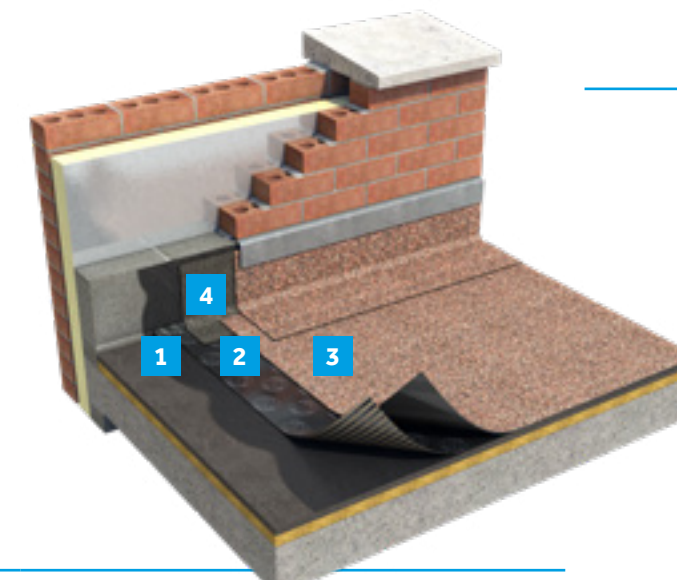

System layer	Product
1	Primer Siplast Primer
2	Underlay Profiles Vent XL
3	Cap sheet Profiles XL FireSmart
4	Detailing underlay Profiles XL Sand

NOTE: These are example systems, for project specific specifications, please [contact our technical services department](#)



TorchSafe™

Profiles systems are available with the combination of self-adhesive membranes using a thermally activated application for a Safe2Torch compliant system.



Every application, expertly installed

Profiles is suitable for a wide range of flat roofing projects, environments and sectors, including education, healthcare, public and government, commercial, industrial and residential buildings. The support behind the system makes it the ideal choice when quality, durability and performance are critical – especially as Profiles is exclusively installed by contractors approved by the Intelligent Membrane Association. IMA contractors adhere to the highest standards of quality, workmanship, and health and safety – meaning the installation of your roof is in the very best hands.

[Explore more IMA-installed projects](#)

Backed by BMI Icopal

As the premium bitumen system in the BMI Icopal family, Profiles is enhanced by our most comprehensive range of specialist support. From cutting-edge moisture mapping technology to training and tools, our trusted team partners with yours to take you effortlessly from design and specification to installation and aftercare.

Services include:

- Comprehensive roof surveys
- Condition reports
- Moisture mapping diagnostics
- Refurbishment and specification services
- Tapered insulation design
- U-value and Annex C thermal calculations
- Wind load calculations
- Drainage calculations and rainfall modelling
- [Explore the full scope of our support for our Profiles system](#)

For further information and technical support, please contact our technical services team:

T: +44 (0) 330 123 4585

E: TECHNICAL.UK@BMIGROUP.COM

