

BMI Icopal Thermaweld

Concrete Deck: Warm Roof System

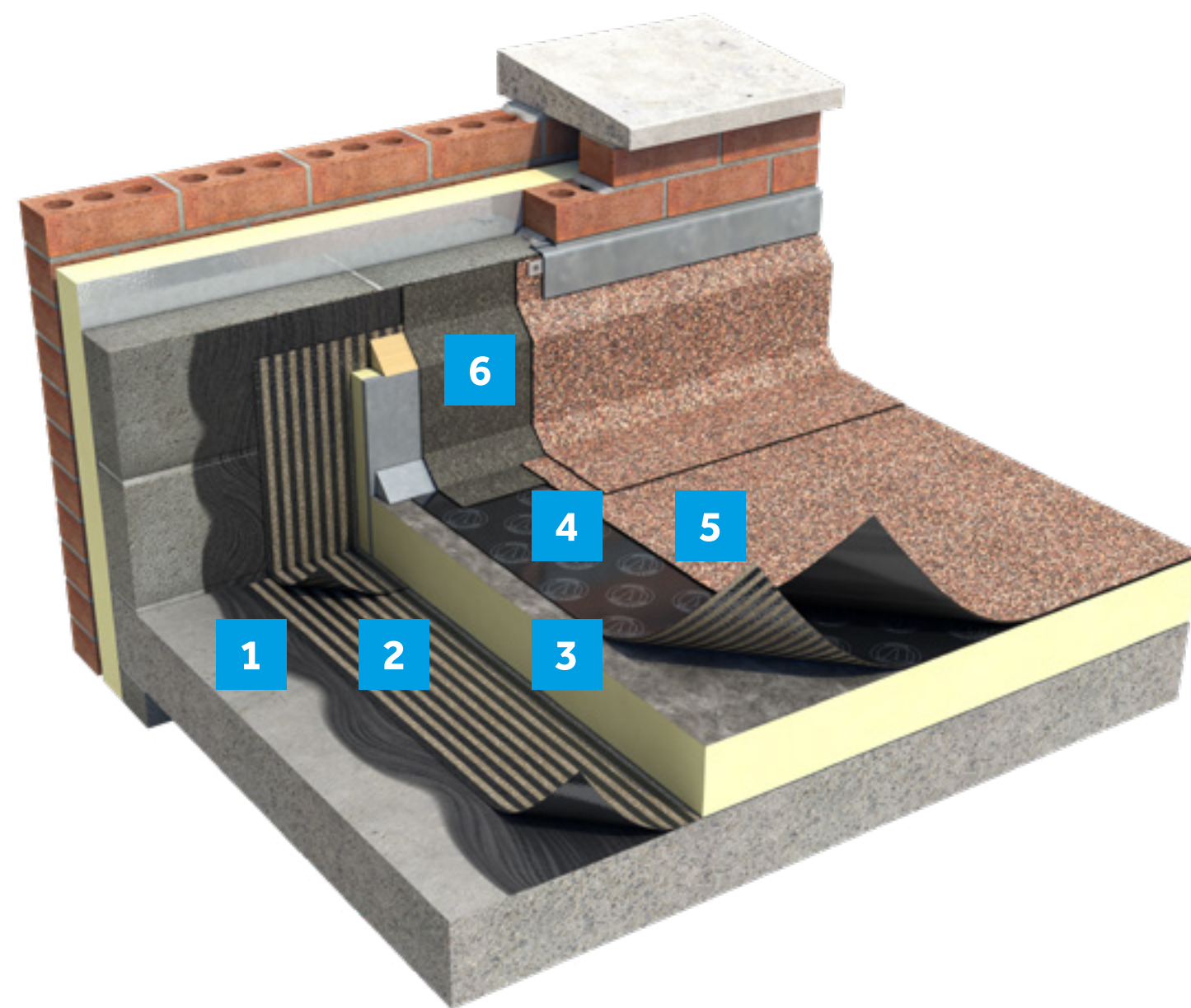

System features and benefits

- Safer low-flame application thanks to our technically advanced, low-heat-reactive SBS modified bitumen formulation
- Designed and manufactured in the UK to meet our unique environment and project demands
- Thermaweld is time-tested and proven to deliver outstanding durability, with an expected service life of at least 35 years
- Thermaweld is tailored and trusted to deliver the quality and finish you demand for every project, with Icopal's full technical support, from design and site monitoring through to guarantees
- Installed by IMA and Team Icopal-approved contractors. Project quality monitoring and sign-off is provided by the Icopal Site Inspection Team for projects requiring a system guarantee
- Reduced gas consumption and faster installation thanks to our unique mini groove profile technology
- Incorporates FireSmart® technology, a fire-retardant additive, for fully tested fire safety
- Thermaweld can be covered by an Icopal product guarantee of up to 25 years, as well as the option of a full 20-year system guarantee when installed by an Icopal-approved contractor

Tested. Trusted. Tailored.

BMI Icopal Thermaweld is our tried and trusted bituminous waterproofing system, delivering tailored roofing solutions that guarantee longevity. That's why Thermaweld is ideal for large-scale commercial and new build projects. Delivering solid performance over a long lifetime of low risk and low maintenance, enabling safe installation practices and peace of mind, Thermaweld is a complete system backed by the tailored service of Icopal's specification and technical team – from design to handover.

	System layer	Product
1	Primer	Siplast Primer
2	Vapour control	Total Torch VCL
3	Insulation	Thermazone Torch on
4	Underlay	Total Torch VDL
5	Cap sheet	Thermaweld FireSmart
6	Detailing underlay	Tecnatorch Sand

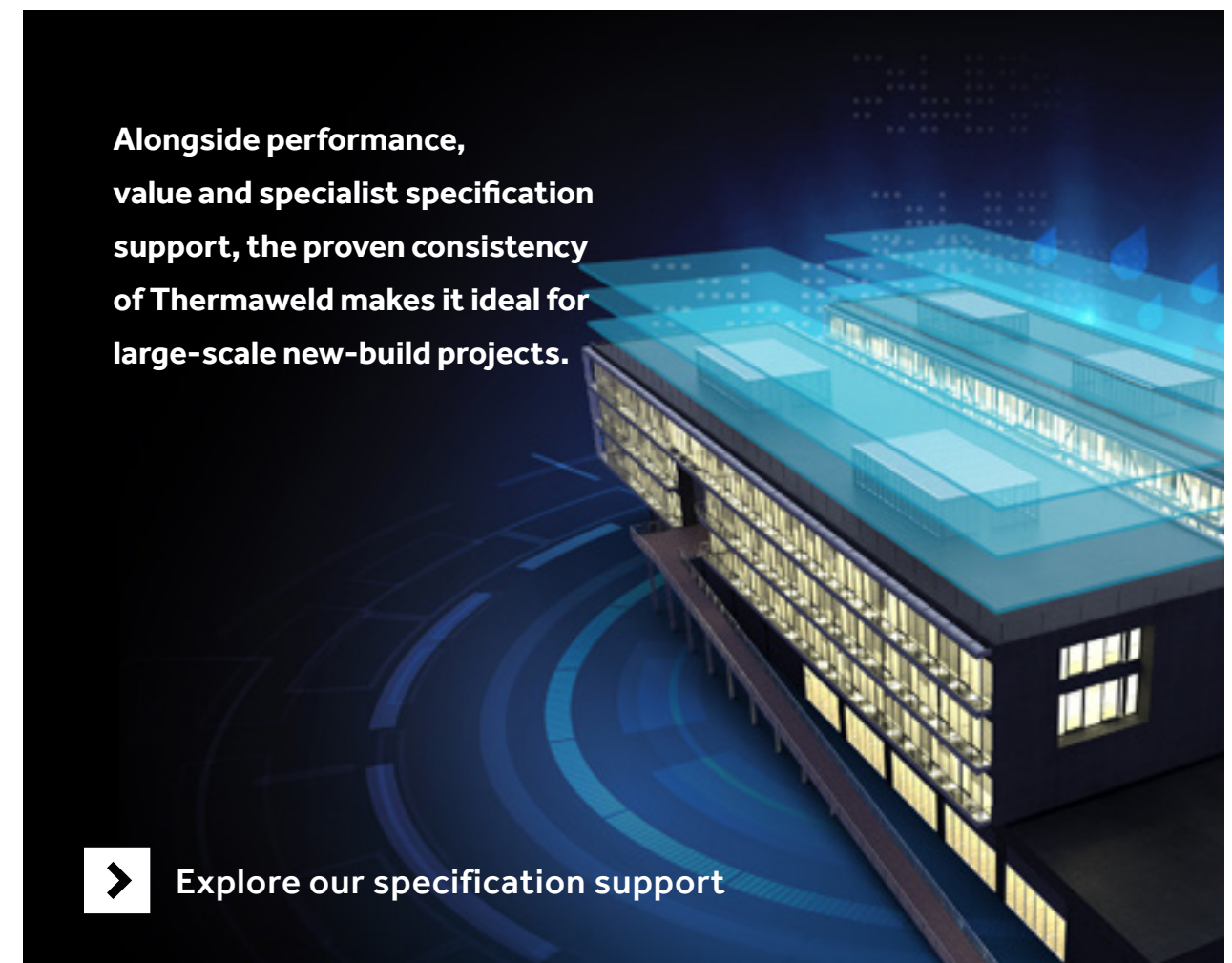

Alongside performance, value and specialist specification support, the proven consistency of Thermaweld makes it ideal for large-scale new-build projects.

[Explore our specification support](#)

Specifying Thermaweld

Designed and tested in the UK, for the UK, Thermaweld is a multi-layer bituminous system encompassing a broad range of products and systems for different types of projects. With its tried and tested longevity, this is a system of choice – particularly for new-build, large commercial projects.

[Explore our product brochure](#)

End-to-end peace of mind

When installed to a BMI Icopal-approved specification, Thermaweld products are guaranteed for up to 25 years. In addition to its proven track record, you'll also benefit from project quality monitoring and sign-off from the BMI Site Inspection Team for projects where a system guarantee is required.

[View our support and services](#)

BMI Icopal Thermaweld

System Variations: Warm Roof System

THERMAWELD: OSB OR PLY SUBSTRATE

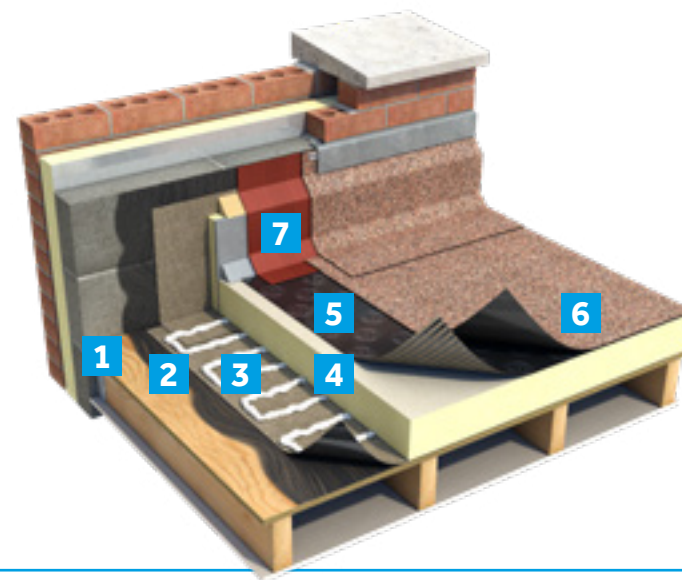

THERMAWELD: PROFILED METAL DECK SUBSTRATE

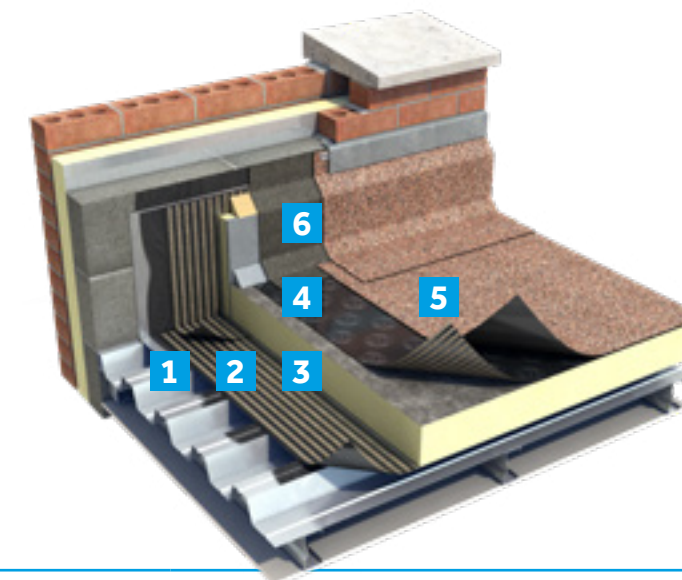

System layer	Product
1	Preparation HT 125 Tape
2	Primer SA Primer
3	Vapour control Torchsafe TA AVCL Sand
4	Insulation Thermazone Roofboard
5	Underlay TorchSafe TA Underlay
6	Cap sheet Thermaweld FireSmart
7	Detailing underlay TorchSafe TA Detailing Underlay

System layer	Product
1	Primer SA Primer
2	Vapour control Torchsafe TA AVCL Stripes
3	Insulation Thermazone Torch On
4	Underlay Total Torch VDL
5	Cap sheet Thermaweld FireSmart
6	Detailing underlay Tecnatorch Sand

NOTE: These are example systems, for project specific specifications, please [contact our technical services department](#)

Backed by BMI Icopal

In addition to delivering a lifetime of safety, proven performance and low maintenance, Thermaweld is backed by the tailored service of BMI Icopal's Specification and Technical Team – so, you'll benefit from consistency and certainty from initial design to final delivery.

Services include:

-  Comprehensive roof surveys
-  NBS specification
-  Tapered insulation design
-  U-value calculations
-  Wind load calculations
-  Condensation risk analysis and estimating
-  On-site quality control checks

[➤ Explore the full scope of Thermaweld support](#)



TorchSafe™

Safe2Torch-compliant systems available, incorporating TorchSafe™ membrane technology, for enhanced safety during application

For further information and technical support, please contact our technical services team:

T: +44 (0) 330 123 4585

E: TECHNICAL.UK@BMIGROUP.COM



Built on trust

Thermaweld is a proven bituminous waterproofing system that delivers tailored roofing solutions guaranteeing longevity. It can be installed by either our premium approved contractor network, the Intelligent Membrane Association (IMA), or by our Team Icopal-approved contractor network. Our teams will help you with a specification based on your precise project needs, including on-site support, site inspections, technical calculations and certification. Also, our approved installer network, featuring contractors approved by the IMA, ensures you're guaranteed exceptional service, skill and roofing expertise, start to finish.

[➤ Find your nearest approved contractor](#)

