

# Cambrian Verge.

## Standard CAD Details

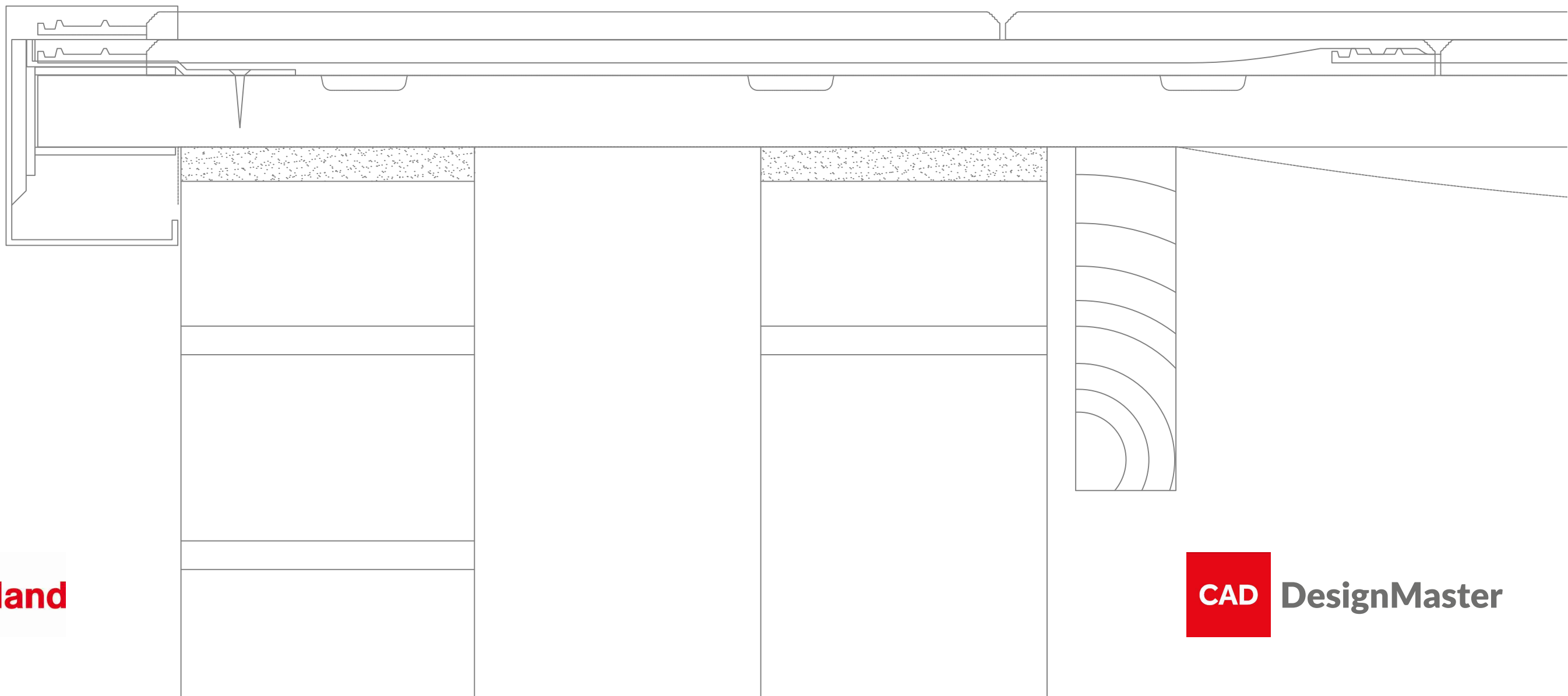

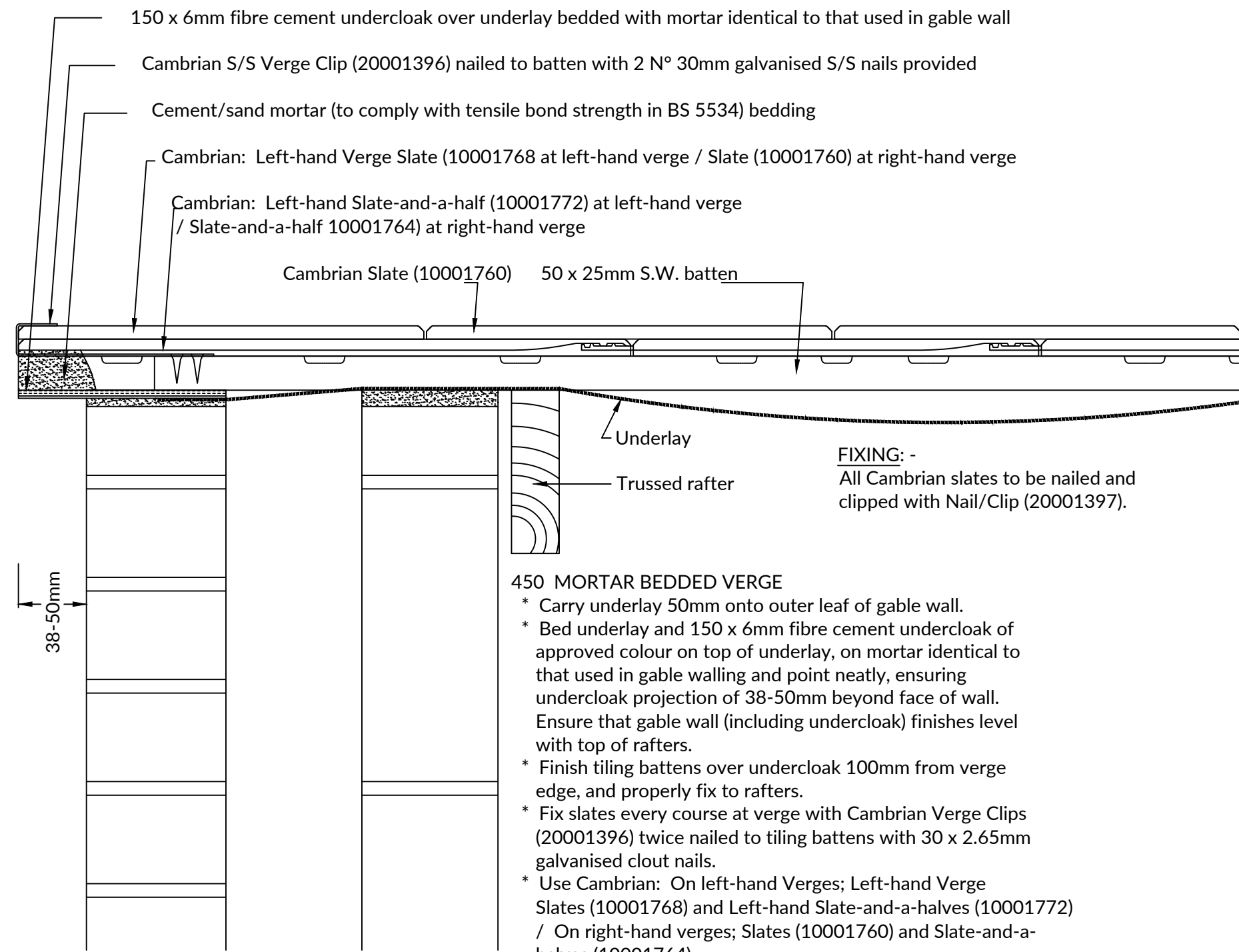

**FIXING: -**  
All Cambrian slates to be nailed and clipped with Nail/Clip (20001397).

- 450 MORTAR BEDDED VERGE**
- \* Carry underlay 50mm onto outer leaf of gable wall.
  - \* Bed underlay and 150 x 6mm fibre cement undercloak of approved colour on top of underlay, on mortar identical to that used in gable walling and point neatly, ensuring undercloak projection of 38-50mm beyond face of wall. Ensure that gable wall (including undercloak) finishes level with top of rafters.
  - \* Finish tiling battens over undercloak 100mm from verge edge, and properly fix to rafters.
  - \* Fix slates every course at verge with Cambrian Verge Clips (20001396) twice nailed to tiling battens with 30 x 2.65mm galvanised clout nails.
  - \* Use Cambrian: On left-hand Verges; Left-hand Verge Slates (10001768) and Left-hand Slate-and-a-halves (10001772) / On right-hand verges; Slates (10001760) and Slate-and-a-halves (10001764).
  - \* Bed edge of all slates at verge, on a 75mm wide bed of mortar as clause 290, ensuring that mortar is not displaced or cracked by mechanical fixing of slates.



BMI Group UK Limited  
[bmigroup.com/uk](http://bmigroup.com/uk)  
 T: +44 (0) 330 123 4585  
 E: [technical.redland@bmigroup.com](mailto:technical.redland@bmigroup.com)

<b>Drawing Title:</b>	Mortar Bedded Verge				
<b>System:</b>	Cambrian				
<b>Dwg. No:</b>	CA00VRG3	<b>Date:</b>	09 April 2022	<b>Scale</b>	NTS

This drawing has been prepared for general information purposes only. This details drawing is to recommend the correct procedure for installing BMI products. All other building details are indicative and are not to be used for building construction. (Do not scale- use figured dimensions only)

© This drawing and the design therein is the exclusive property of BMI Group UK Limited. It should not be copied or reproduced without consent and shall only be used in reference to materials or goods supplied by them.

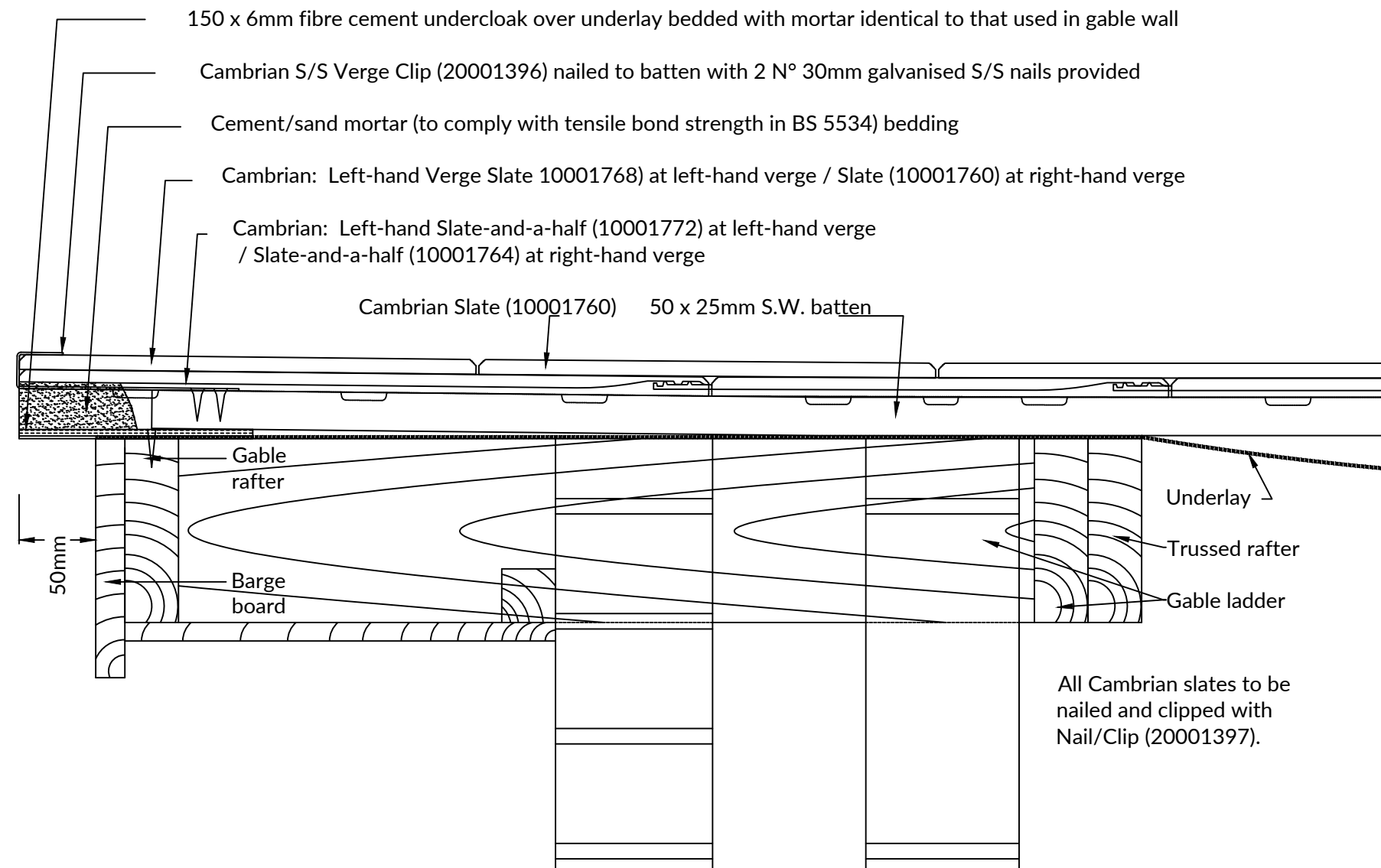

#### 450 OVERHANGING MORTAR BEDDED VERGE

- \* Ensure that gable wall and gable ladder are constructed level with top of rafters.
- \* Carry underlay over full width of verge to outer face of barge board.
- \* Place 6mm fibre cement undercloak of approved colour over underlay and projecting 50mm beyond face of bargeboard , and fix to gable rafter with 25mm galvanised clout nails.
- \* Finish tiling battens at centre of gable rafter and properly fix to rafters and gable rafter.
- \* Fix slates every course at verge with Cambrian Verge Clips (20001396) twice nailed to tiling battens with 30 x 2.65mm galvanised clout nails.
- \* Use Cambrian: On left-hand Verges; Left-hand Verge Slates (10001768) and Left-hand Slate-and-a-halves (10001772) / On right-hand verges; Slates (10001760) and Slate-and-a- halves (10001764).
- \* Bed edge of all slates at verge, on a 75mm wide bed of mortar as clause 290, ensuring that mortar is not displaced or cracked by mechanical fixing of slates.



BMI Group UK Limited  
[bmigroup.com/uk](http://bmigroup.com/uk)  
 T: +44 (0) 330 123 4585  
 E: [technical.redland@bmigroup.com](mailto:technical.redland@bmigroup.com)

<b>Drawing Title:</b>	Overhanging Mortar Bedded Verge				
<b>System:</b>	Cambrian				
<b>Dwg. No:</b>	CA00VRG4	<b>Date:</b>	09 March 2022	<b>Scale</b>	NTS

This drawing has been prepared for general information purposes only. This details drawing is to recommend the correct procedure for installing BMI products. All other building details are indicative and are not to be used for building construction. (Do not scale- use figured dimensions only)

© This drawing and the design therein is the exclusive property of BMI Group UK Limited. It should not be copied or reproduced without consent and shall only be used in reference to materials or goods supplied by them.

**BMI Redland Cambrian Ambi-Dry Verge System (10002828) Comprising: -**

- PVC-U Ambi-Dry Interlocking Verge Unit
- S/S Ambi-Dry Verge Clip nailed to batten with 25mm galvanised clout nail

Cambrian Slate (10001760) at left/right-hand verge inserted fully into Verge Units

Cambrian Slate-and-a-half (10001764) at left/right-hand verge inserted fully into Verge Units

50 x 25mm S.W. tiling batten Cambrian Slate (10001760)

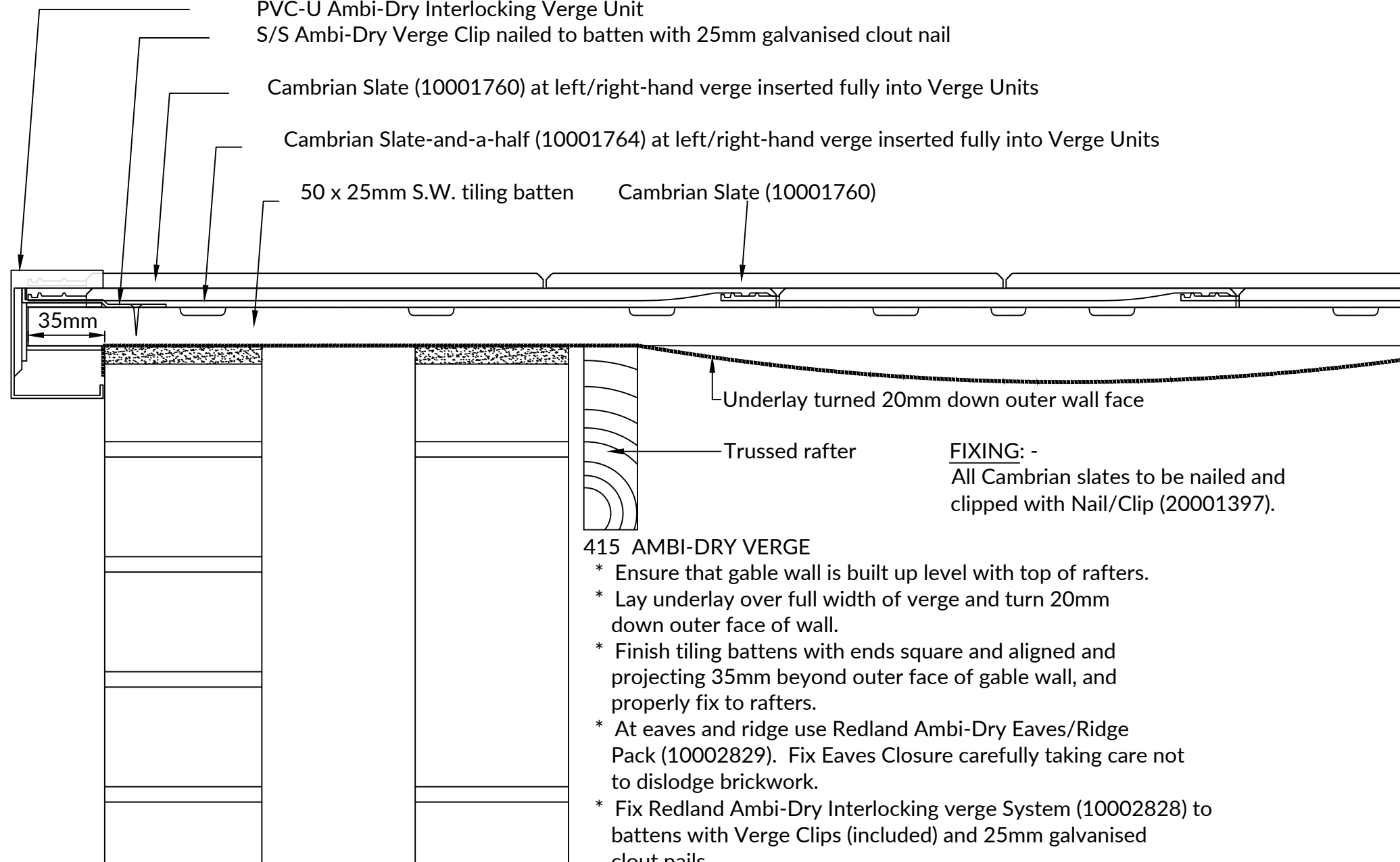

**FIXING: -**

All Cambrian slates to be nailed and clipped with Nail/Clip (20001397).

**415 AMBI-DRY VERGE**

- \* Ensure that gable wall is built up level with top of rafters.
- \* Lay underlay over full width of verge and turn 20mm down outer face of wall.
- \* Finish tiling battens with ends square and aligned and projecting 35mm beyond outer face of gable wall, and properly fix to rafters.
- \* At eaves and ridge use Redland Ambi-Dry Eaves/Ridge Pack (10002829). Fix Eaves Closure carefully taking care not to dislodge brickwork.
- \* Fix Redland Ambi-Dry Interlocking verge System (10002828) to battens with Verge Clips (included) and 25mm galvanised clout nails.
- \* Fix Cambrian: Slates 10001760) and Slate-and-a-Halves (10001764) to left hand and right hand verges, inserted fully into Verge Units.



BMI Group UK Limited  
[bmigroup.com/uk](http://bmigroup.com/uk)  
 T: +44 (0) 330 123 4585  
 E: [technical.redland@bmigroup.com](mailto:technical.redland@bmigroup.com)

<b>Drawing Title:</b>	Ambi-Dry Verge				
<b>System:</b>	Cambrian / Ambi-Dry Verge				
<b>Dwg. No:</b>	CA00VRG5	<b>Date:</b>	09 May 2022	<b>Scale</b>	NTS

This drawing has been prepared for general information purposes only. This details drawing is to recommend the correct procedure for installing BMI products. All other building details are indicative and are not to be used for building construction. (Do not scale- use figured dimensions only)

© This drawing and the design therein is the exclusive property of BMI Group UK Limited. It should not be copied or reproduced without consent and shall only be used in reference to materials or goods supplied by them.

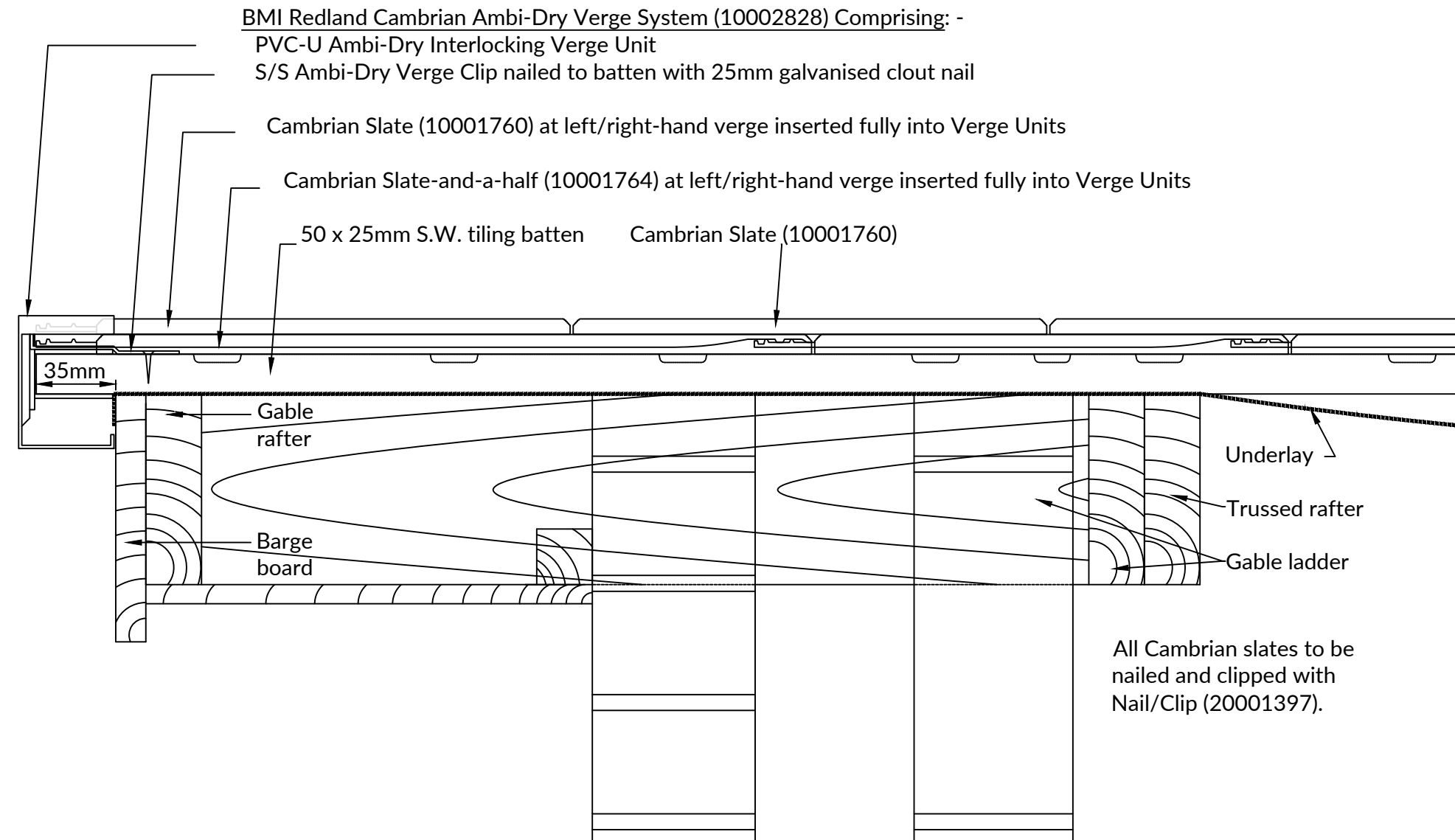

#### 415 OVERHANGING AMBI-DRY VERGE

- \* Ensure that gable wall and gable ladder are constructed level with top of rafters.
- \* Lay underlay over full width of verge and turn 20mm down outer face of wall.
- \* Finish tiling battens with ends square and aligned and projecting 35mm beyond outer face of gable wall, and properly fix to rafters.
- \* At eaves and ridge use Redland Ambi-Dry Eaves/Ridge Pack (10002829). Fix Eaves Closure carefully taking care not to dislodge brickwork.
- \* Fix Redland Ambi-Dry Interlocking verge System (10002828) to battens with Verge Clips (included) and 25mm galvanised clout nails.
- \* Fix Cambrian: Slates (10001760) and Slate-and-a-Halves (10001764) to left hand and right hand verges, inserted fully into Verge Units.



BMI Group UK Limited  
[bmigroup.com/uk](http://bmigroup.com/uk)  
 T: +44 (0) 330 123 4585  
 E: [technical.redland@bmigroup.com](mailto:technical.redland@bmigroup.com)

<b>Drawing Title:</b>	Overhanging Ambi-Dry Verge				
<b>System:</b>	Cambrian / Ambi-Dry Verge				
<b>Dwg. No:</b>	CA00VRG6	<b>Date:</b>	09 May 2022	<b>Scale</b>	NTS

This drawing has been prepared for general information purposes only. This details drawing is to recommend the correct procedure for installing BMI products. All other building details are indicative and are not to be used for building construction. (Do not scale- use figured dimensions only)

© This drawing and the design therein is the exclusive property of BMI Group UK Limited. It should not be copied or reproduced without consent and shall only be used in reference to materials or goods supplied by them.

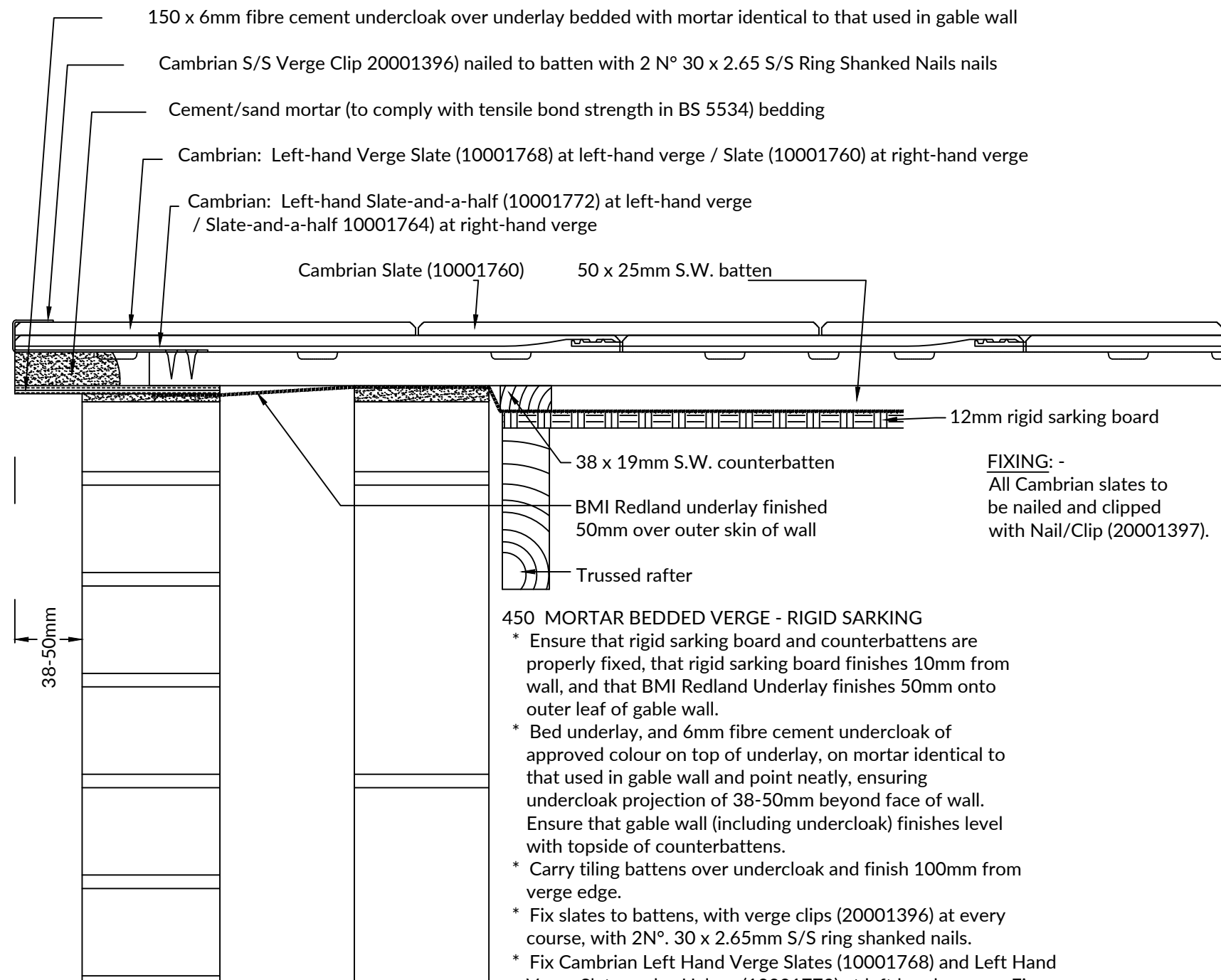

**450 MORTAR BEDDED VERGE - RIGID SARKING**

- \* Ensure that rigid sarking board and counterbattens are properly fixed, that rigid sarking board finishes 10mm from wall, and that BMI Redland Underlay finishes 50mm onto outer leaf of gable wall.
- \* Bed underlay, and 6mm fibre cement undercloak of approved colour on top of underlay, on mortar identical to that used in gable wall and point neatly, ensuring undercloak projection of 38-50mm beyond face of wall. Ensure that gable wall (including undercloak) finishes level with topside of counterbattens.
- \* Carry tiling battens over undercloak and finish 100mm from verge edge.
- \* Fix slates to battens, with verge clips (20001396) at every course, with 2N°. 30 x 2.65mm S/S ring shanked nails.
- \* Fix Cambrian Left Hand Verge Slates (10001768) and Left Hand Verge Slate-and-a-Halves (10001772) at left hand verges. Fix Cambrian Slates (10001760) and Slate-and-a-Halves (10001764) at right hand verges.
- \* Bed edge of verge slates on 75mm wide bed of mortar as clause 290, ensuring that mortar is not displaced or cracked by mechanical fixing of slates.



BMI Group UK Limited  
[bmigroup.com/uk](http://bmigroup.com/uk)  
 T: +44 (0) 330 123 4585  
 E: [technical.redland@bmigroup.com](mailto:technical.redland@bmigroup.com)

<b>Drawing Title:</b>	Mortar Bedded Verge - Rigid Sarking				
<b>System:</b>	Cambrian				
<b>Dwg. No:</b>	CA00VGK3	<b>Date:</b>	09 May 2022	<b>Scale</b>	NTS

This drawing has been prepared for general information purposes only. This details drawing is to recommend the correct procedure for installing BMI products. All other building details are indicative and are not to be used for building construction. (Do not scale- use figured dimensions only)

© This drawing and the design therein is the exclusive property of BMI Group UK Limited. It should not be copied or reproduced without consent and shall only be used in reference to materials or goods supplied by them.

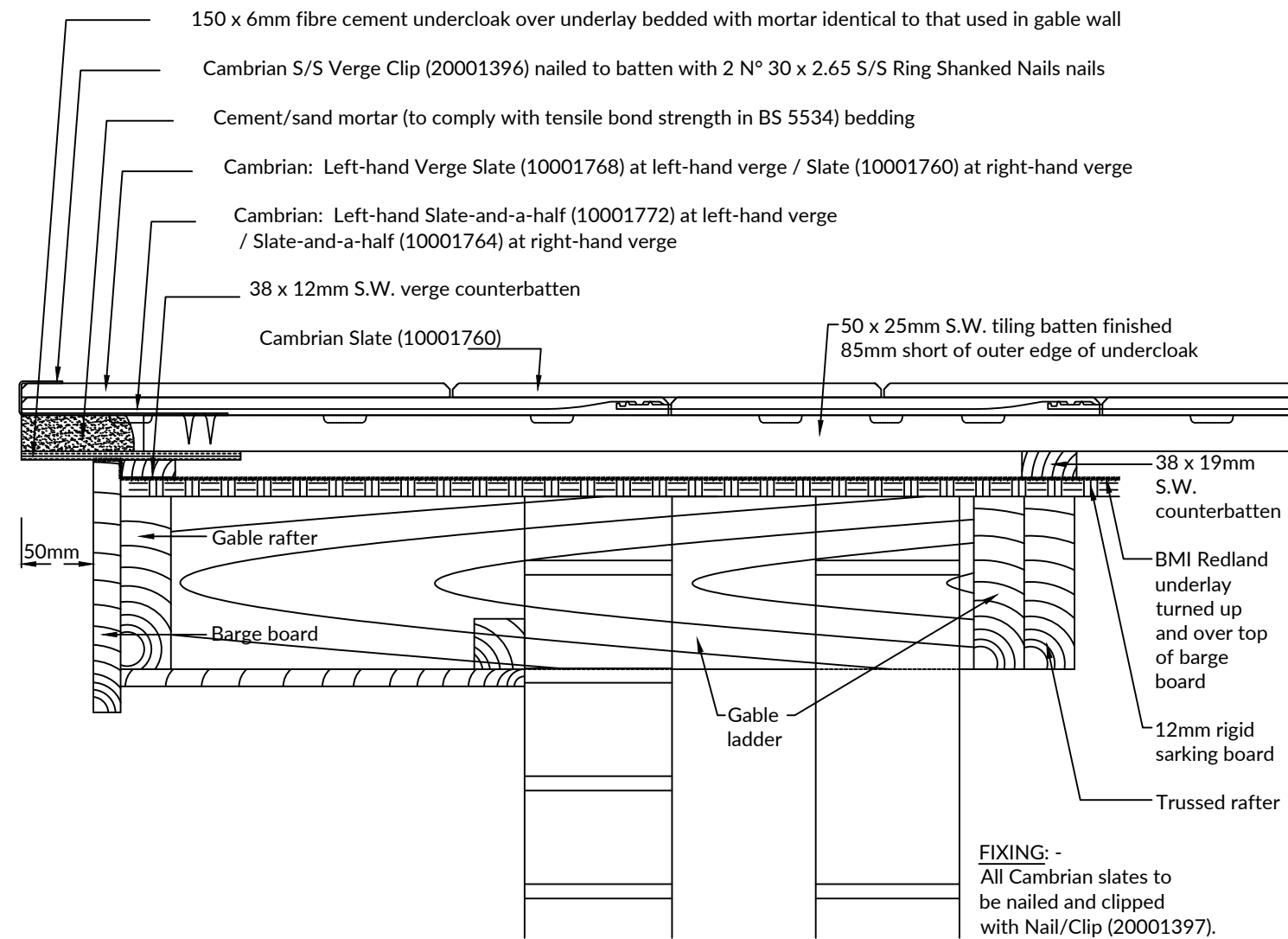

**450 OVERHANGING MORTAR BEDDED CLIPPED VERGE - RIGID SARKING**

- \* Ensure that wall and gable ladder are constructed level with top of rafters.
- \* Ensure that rigid sarking board and counterbattens are properly fixed, that rigid sarking board finishes at barge board, and that BMI Redland Underlay is turned up and over top of barge board. Ensure that verge counterbatten is 6mm less thick than main counterbattens.
- \* Ensure that barge board is level with topside of verge counterbatten.
- \* Fix 150 x 6mm fibre cement undercloak of approved colour, to verge counterbatten, with 25mm galvanised clout nails, ensuring that undercloak projects 50mm from barge board.
- \* Finish tiling battens 85mm short of outer edge of undercloak, and fix through undercloak, verge counterbatten and sarking to gable rafter.
- \* Fix slates to battens, with verge clips (20001396) twice nailed at every course, with 30 x 2.65mm S/S ring shanked nails.
- \* Fix Cambrian Left Hand Verge Slates (10001768) and Left Hand Verge Slate-and-a-Halves (10001772) at left hand verges. Fix Cambrian Slates (10001760) and Slate-and-a-Halves (10001764) at right hand verges.
- \* Bed edge of verge tiles on 75mm wide bed of mortar as clause 290, ensuring that mortar is not displaced or cracked by mechanical fixing of tiles, and does not contact ends of tiling battens.



BMI Group UK Limited  
[bmigroup.com/uk](http://bmigroup.com/uk)  
 T: +44 (0) 330 123 4585  
 E: [technical.redland@bmigroup.com](mailto:technical.redland@bmigroup.com)

<b>Drawing Title:</b>	Overhanging Mortar Bedded Verge - Rigid Sarking				
<b>System:</b>	Cambrian				
<b>Dwg. No:</b>	CA00VGK4	<b>Date:</b>	09 May 2022	<b>Scale</b>	NTS

This drawing has been prepared for general information purposes only. This details drawing is to recommend the correct procedure for installing BMI products. All other building details are indicative and are not to be used for building construction. (Do not scale- use figured dimensions only)

© This drawing and the design therein is the exclusive property of BMI Group UK Limited. It should not be copied or reproduced without consent and shall only be used in reference to materials or goods supplied by them.



**BMI Redland Cambrian Ambi-Dry Verge System (10002828) Comprising: -**  
 PVC-U Ambi-Dry Interlocking Verge Unit  
 S/S Ambi-Dry Verge Clip nailed to batten with 25mm galvanised clout nail

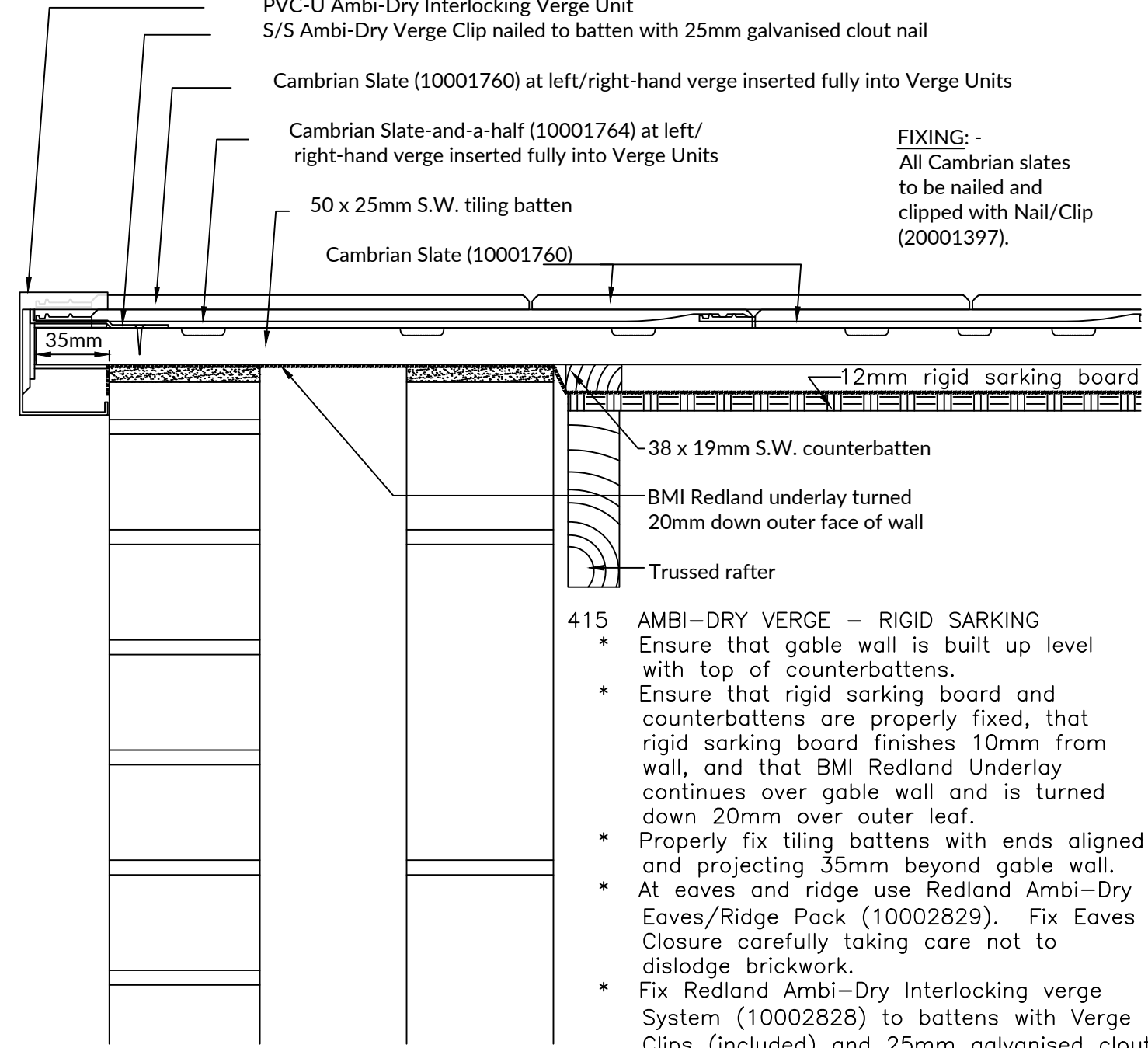

**FIXING: -**  
 All Cambrian slates to be nailed and clipped with Nail/Clip (20001397).

- 415 AMBI-DRY VERGE – RIGID SARKING**
- \* Ensure that gable wall is built up level with top of counterbattens.
  - \* Ensure that rigid sarking board and counterbattens are properly fixed, that rigid sarking board finishes 10mm from wall, and that BMI Redland Underlay continues over gable wall and is turned down 20mm over outer leaf.
  - \* Properly fix tiling battens with ends aligned and projecting 35mm beyond gable wall.
  - \* At eaves and ridge use Redland Ambi-Dry Eaves/Ridge Pack (10002829). Fix Eaves Closure carefully taking care not to dislodge brickwork.
  - \* Fix Redland Ambi-Dry Interlocking verge System (10002828) to battens with Verge Clips (included) and 25mm galvanised clout nails.
  - \* Fix Cambrian: Slates (10001760) and Slate-and-a-Halves (10001764) to left hand and right hand verges, inserted fully into Verge Units.



BMI Group UK Limited  
[bmigroup.com/uk](http://bmigroup.com/uk)  
 T: +44 (0) 330 123 4585  
 E: [technical.redland@bmigroup.com](mailto:technical.redland@bmigroup.com)

<b>Drawing Title:</b>	Ambi-Dry Verge - Rigid Sarking				
<b>System:</b>	Cambrian / Ambi-Dry Verge				
<b>Dwg. No:</b>	CA00VGK5	<b>Date:</b>	09 May 2022	<b>Scale</b>	NTS

This drawing has been prepared for general information purposes only. This details drawing is to recommend the correct procedure for installing BMI products. All other building details are indicative and are not to be used for building construction. (Do not scale- use figured dimensions only)

© This drawing and the design therein is the exclusive property of BMI Group UK Limited. It should not be copied or reproduced without consent and shall only be used in reference to materials or goods supplied by them.



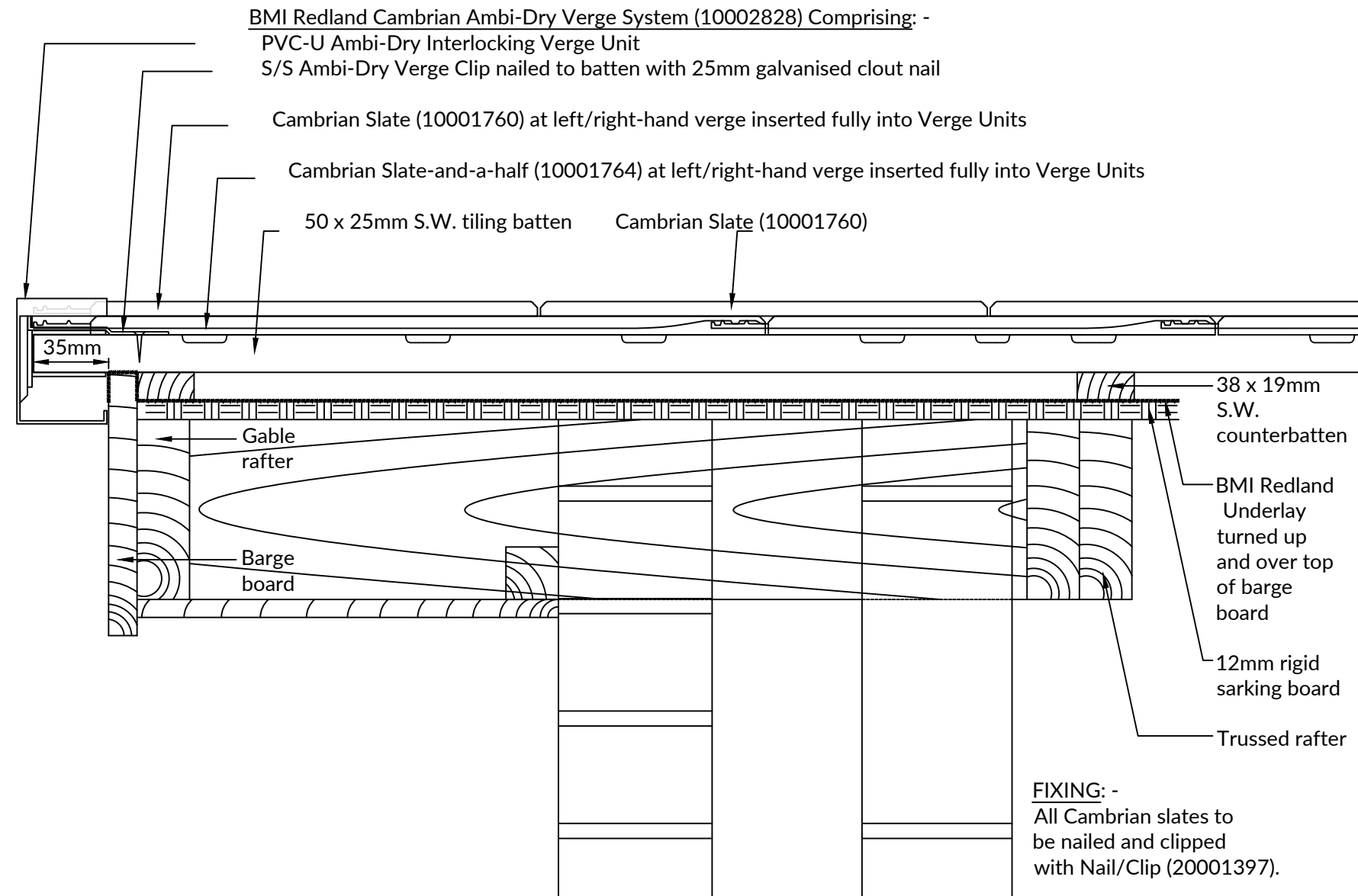

**415 OVERHANGING AMBI-DRY VERGE - RIGID SARKING**

- \* Ensure that gable wall and gable ladder are constructed level with top of rafters.
- \* Ensure that rigid sarking board, counterbattens and barge board are properly fixed, that barge board is flush with topside of counterbattens, that rigid sarking board finishes at barge board, and that BMI Redland Underlay is turned over barge board and 20mm down outer face.
- \* Properly fix tiling battens with ends aligned and projecting 35mm beyond barge board.
- \* At eaves and ridge use Redland Ambi-Dry Eaves/Ridge Pack (10002829).
- \* Fix Redland Ambi-Dry Interlocking verge System (10002828) to battens with Verge Clips (included) and 25mm galvanised clout nails.
- \* Fix Cambrian: Slates (10001760) and Slate-and-a-Halves (10001764) to left hand and right hand verges, inserted fully into Verge Units.



BMI Group UK Limited  
[bmigroup.com/uk](http://bmigroup.com/uk)  
 T: +44 (0) 330 123 4585  
 E: [technical.redland@bmigroup.com](mailto:technical.redland@bmigroup.com)

<b>Drawing Title:</b>	Overhanging Ambi-Dry Verge - Rigid Sarking				
<b>System:</b>	Cambrian / Ambi-Dry Verge				
<b>Dwg. No:</b>	CA00VGK6	<b>Date:</b>	09 May 2022	<b>Scale:</b>	NTS

This drawing has been prepared for general information purposes only. This details drawing is to recommend the correct procedure for installing BMI products. All other building details are indicative and are not to be used for building construction. (Do not scale- use figured dimensions only)

© This drawing and the design therein is the exclusive property of BMI Group UK Limited. It should not be copied or reproduced without consent and shall only be used in reference to materials or goods supplied by them.