



At the centre of business.

66 Wellington
Street West
TD Bank Tower

TORONTO
DOMINION
CENTRE

Where business is going.

 Cadillac
Fairview



66 Wellington Street West TD Bank Tower

1.3 MILLION
TOTAL RENTABLE
SQ. FT.



BEST IN CLASS
PROPERTY
MANAGEMENT



CERTIFIED
LEED
PLATINUM



For Toronto-Dominion Centre to maintain and continually strengthen its leadership position, an ongoing program of property evaluation, enhancement and revitalization is vitally important.

In just the last 5 years, over \$200 million has been invested in advanced building system technologies,

retail and common area renovations, plaza revitalization, fire and safety upgrades and more in the TDC complex.

Once you get here, you know you've arrived.



The first and largest of the TD Centre towers, TD Bank Tower challenged Canadian architecture to be bolder and better and introduced the modern workplace to Canadian business. At 56 storeys and 1.3 million sq. ft., this LEED Platinum EB:O&M building anchors the Toronto-Dominion Centre and Toronto's financial core.

Changing with the times.

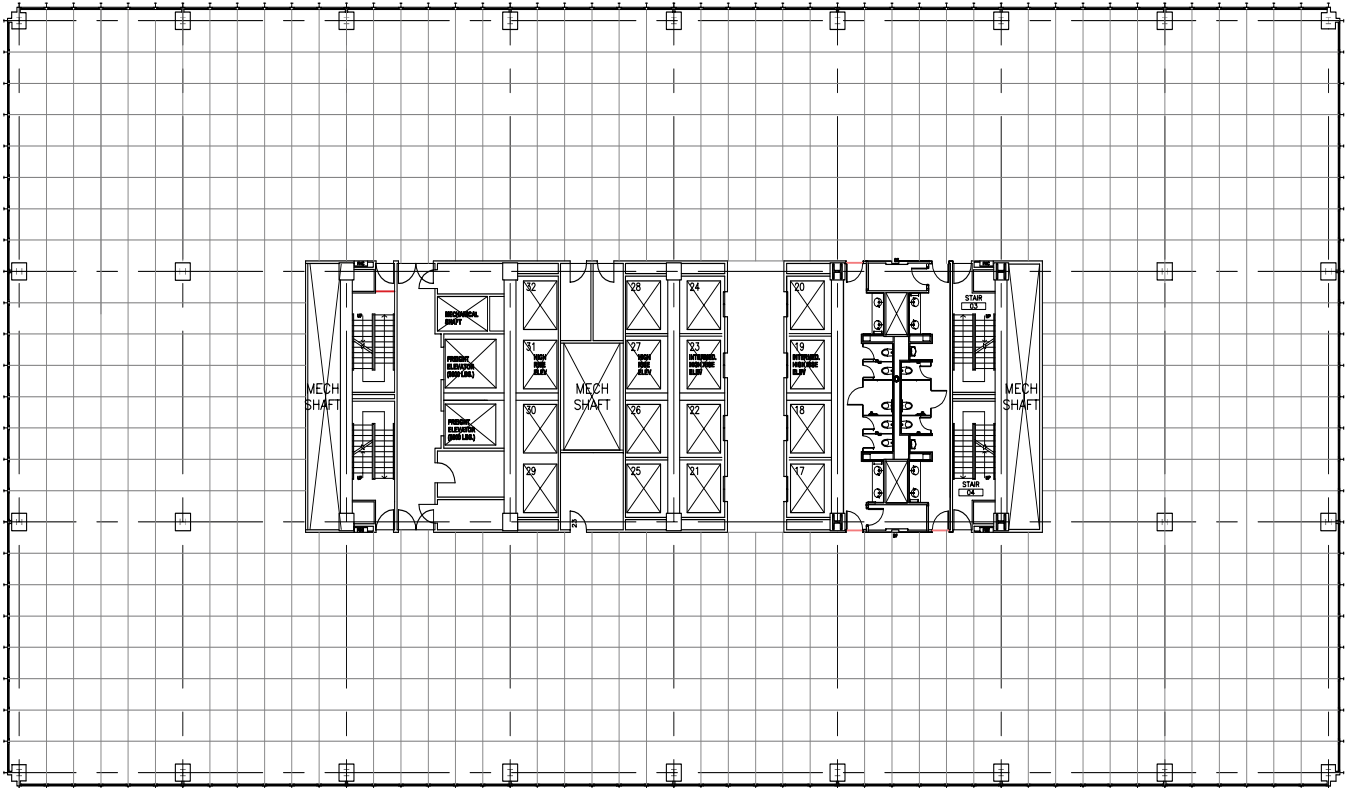

Date Built/Renovated
1967/2004

Total Rentable Area
1,332,667 square feet

Number of Floors
55

Elevators
Passenger 32

8 low rise 700 fpm
8 mid low rise 1,000 fpm
8 mid high rise 1,200 fpm
8 high rise 1,400 fpm

Freight 2
Parking shuttle 3

Planning Module
5'x5'

Ceiling Height
9'

Glazing
Full height (9'x5')

Parking
1,046 stalls on two levels

Floor Loading
75 psf including partition allowance

Back-up Power
Emergency diesel generator – 1,750 kW

Security/Life Safety
24/7 Security Ops Centre,
24/7 manned lobby security
Fully sprinklered, on-site emergency response team including paramedics and AEDs

Fire and smoke detection, voice notification

Power
Carma web enabled power metering

2 watts lighting, 2 watts tenant power, additional power of up to 4 watts available

HVAC
Enwave Deep Lake Water Cooling
Digital Building Control System (DDC)

Fresh air at 30 cfm/150 sf (20 cfm/100 sf) exceeds ASHRAE standards

6 air changes per hour – VAV interior system combined with perimeter induction
36 perimeter zones per floor, 18 interior VAV zones per floor

Access
Path connected, direct subway access, barrier free building access, barrier free washrooms



**LEED EB:O&M
PLATINUM,
BOMA Best
Certified**

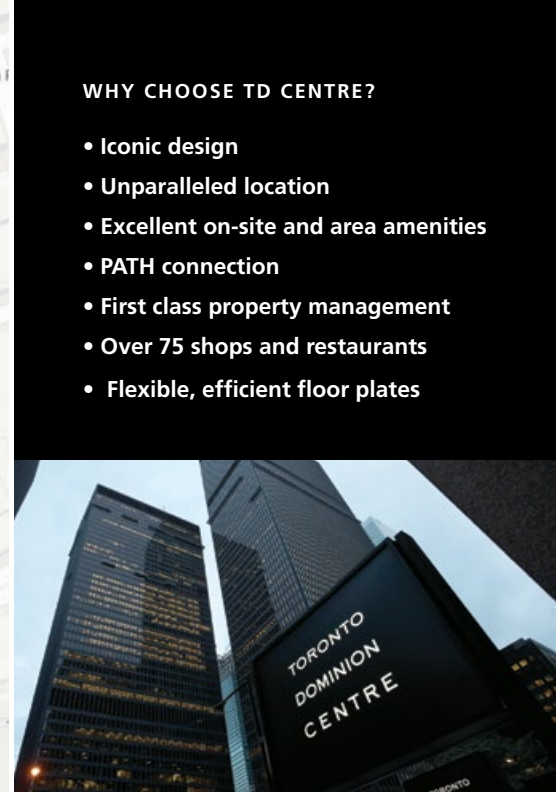
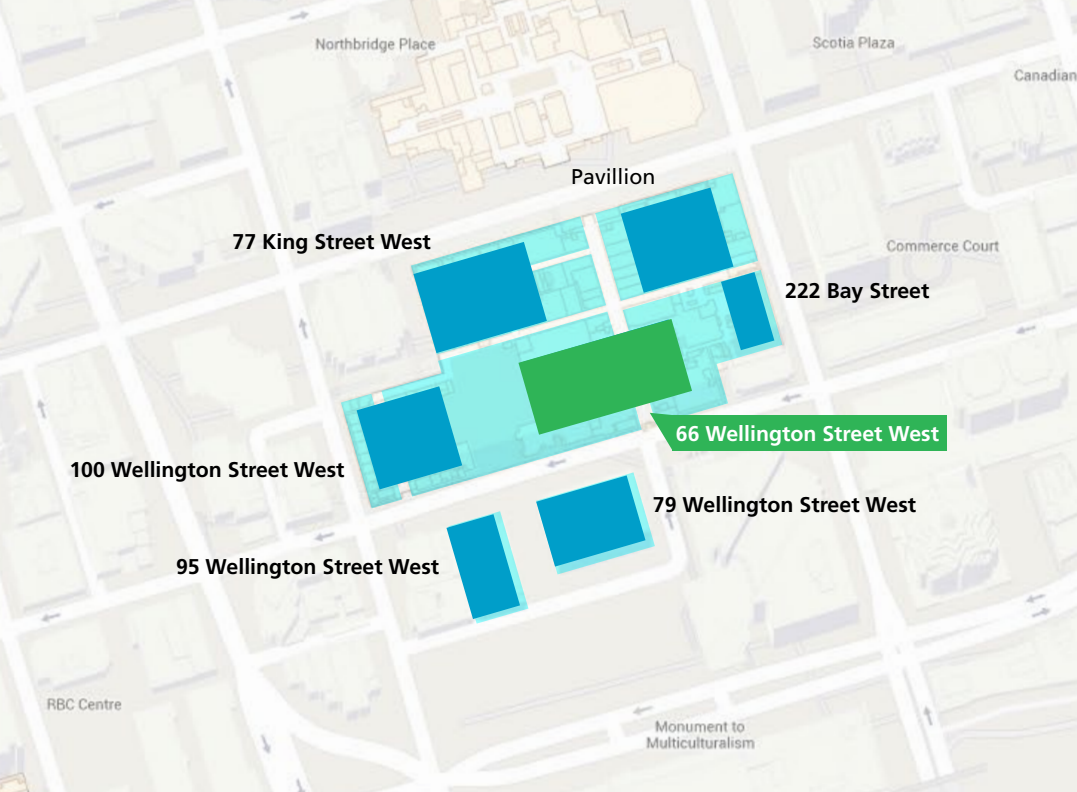

WHY CHOOSE TD CENTRE?

- Iconic design
- Unparalleled location
- Excellent on-site and area amenities
- PATH connection
- First class property management
- Over 75 shops and restaurants
- Flexible, efficient floor plates

FOR LEASING INFORMATION PLEASE CONTACT:

John Knechtel
 Vice President, Leasing
 Phone: 416-869-2285
 john.knechtel@cadillacfairview.com

Adam Hall
 Director of Leasing
 Phone: 416-869-2277
 adam.hall@cadillacfairview.com

FOR MORE INFORMATION PLEASE GO TO:

www.tdcentreleasing.com

Select Tenants Include

- TD Bank
- McCarthy Tétrault LLP
- AGF Management
- Weir Foulds LLP

Building Amenities

- Over 75 shops and restaurants on-site
- Canoe Restaurant on 54th Floor
- PATH connected and direct subway access
- Flexible, efficient floor plates

Additional Rent (2015 Estimates)

Realty taxes	\$14.20/sq. ft.
Operating costs	\$16.10/sq. ft.
Hydro	\$1.10/sq. ft.
Total	\$31.40/sq. ft.

Complex Size

TD Bank Tower/ 66 Wellington St. W.	1,333,000 sq. ft.
TD North Tower/ 77 King St. W.	974,000 sq. ft.
TD West Tower/ 100 Wellington St. W.	515,000 sq. ft.
TD South Tower/ 79 Wellington St. W.	693,000 sq. ft.
Ernst & Young Tower/ 222 Bay St.	487,331 sq. ft.
95 Wellington St. W.	328,000 sq. ft.

Total Size 4,330,331 sq. ft.

Typical Floor Size 19,000 sq. ft.

Parking Available at TD Centre

Underground	1 stall/3,500 sq. ft. leased
Monthly cost	\$422.27 unreserved \$643.60 reserved



Six Magnificent Towers. One Great Place to Work.

Located in the heart of Toronto's financial district, Toronto-Dominion Centre says to your clients, employees and the marketplace that you have arrived. It also says a lot about how you view the future and your place in it.

TDC. Where Business Is Going.

