

Searching for docs, meds, etc.

Searching for providers, specialists, hospitals, meds, or even symptoms is just a click (or two) away



When you need care, it's important to find the right care and to know how much it'll cost. That's why we make it easy to search for whatever you need. Let's walk through searching for care together, so you know exactly what to do when you need support.

But first, visit hioscar.com/member to access and log into your account.



If you don't have an Oscar account already, don't worry. Just click **'Create an account'** and verify your email address.

You can also use the **Oscar app** to log in.



Now it's time to search for care

Once you're signed into your Oscar account, use the search bar at the top of your browser to start searching. You can look for providers, specialists, hospitals/facilities, meds, procedure, condition or even symptoms. Follow along as we search for each of these things.

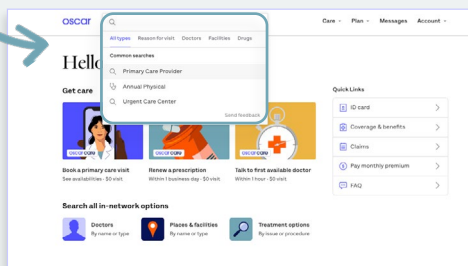

Here's how to search for a provider or specialist

1. Enter the kind of provider you're looking for right into the search bar.
2. We've got filters so you can search by gender, language, distance, and more. (Yay!)
3. Then, just click on a provider profile and check them out. (If a provider doesn't show up in your search, it means they don't take Oscar.)
4. Find a provider you like and book an appointment!

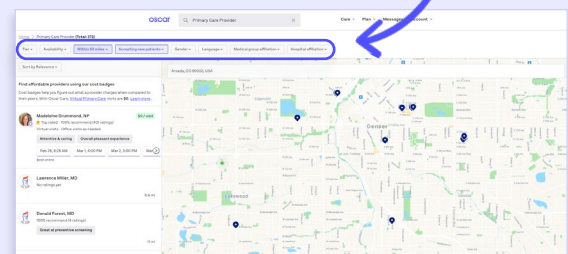

oscar

Want more info on a provider? Here's everything you'll find in a provider profile:



THE ABOUT SECTION

is where you'll find the provider's specialties, availability after hours, hospital affiliation, and background.

THE SEARCH BAR

is the place to look for providers, specialists, hospitals/facilities, and meds. You can even search by symptoms you may have.

THE COST ESTIMATE SECTION

will show you some common services for each provider and an estimate of what you might expect to pay.

THE LOCATION SECTION

is where to look for information about where the provider is located. It also includes other things like their email address, website, wheelchair accessibility, fax number, and more!

Sander Florman, MD
Gastroenterologist

[About](#) [Locations \(2\)](#) [Ratings](#) [Cost estimates](#)

Provider information

Specialties	Gastroenterologist, Transplant Nephrologist, General Gastroenterologist
Languages	English, Spanish
Available after hours?	Information not available
Gender	Male
Hospital affiliation	Mount Sinai Hospital

[Show all](#)

Similar providers

Explore providers similar to this one.

	Saurabh Mehandru, MD No rating
--	--

Quick Info

In-network
1 Gustave L Levy Pl
New York, NY 10029
[Switch office \(2\)](#)

Phone (212) 241-8035

Status Accepting new patients

Availability predictions
Next 2 days Next 7 days Next 14 days
Call this provider to book.

[Save for later](#)

See a problem? [Suggest an edit](#)

This profile's data [Learn more](#)

THE RATINGS SECTION

is where to see what other patients think of a provider.

THE QUICK INFO SECTION

is where you'll find some helpful info about the provider. Like if they're taking new patients and their address and phone number.

Quick Tip



If you need care quickly (*and it's not an emergency*), you can always use Virtual Urgent Care* for \$0. It's available 24/7 and you can connect with a provider in as little as 15 minutes. Just request a call or messaging consult through your online account or the Oscar app. It's best for things like sore throats, rashes, UTI's, and prescription refills.

*Virtual Urgent Care offerings are not available in US territories or internationally. If you have an HSA-compatible high-deductible health plan or a Secure plan, you won't be eligible for \$0 visits. Prescriptions, visits and services may be limited per provider discretion.



Here's how to search for:



An in-network facility, urgent care, or hospital

1. Enter the kind of facility you're looking for into the search bar.
2. Narrow your search by distance.
3. Then, just click on a facility that interests you and check out all the details about the facility to find one that's right for you.

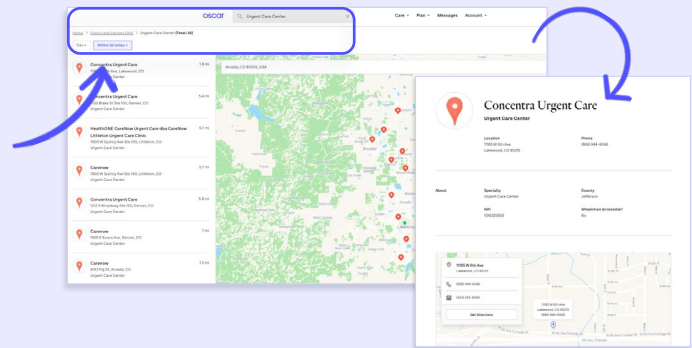

Good to know — if you search for a specific place and it doesn't show up in your search, it's not in-network!

Meds covered by your plan

1. Enter the med right into the search bar.
2. See if it's covered!
3. If it's covered, use the drop down menu to select the dosage.
4. Then, you'll be able to see the supply and cost.
5. If the Rx isn't covered, it's likely that we cover a generic version (and we'll show you options in your search results).

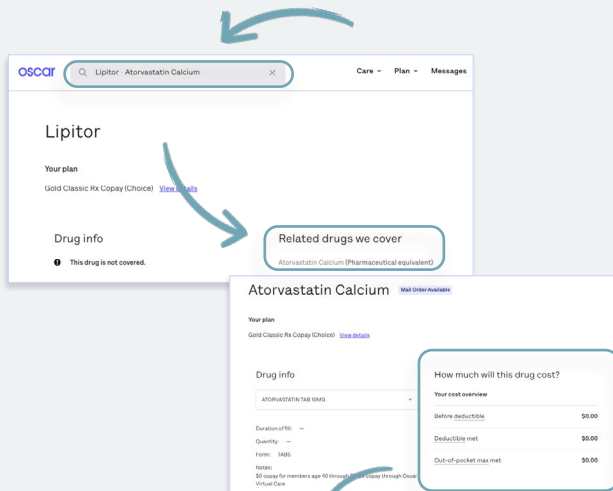

Not knowing what your meds will cost is never fun, neither is getting a surprise bill. That's why we make it easy for you to find out the cost of meds before you start taking a prescription.

Care by symptoms or health concern

1. Type your symptom or health concern right into the search bar.
2. Then, choose how you'd like to get the care you need.
3. That's all.

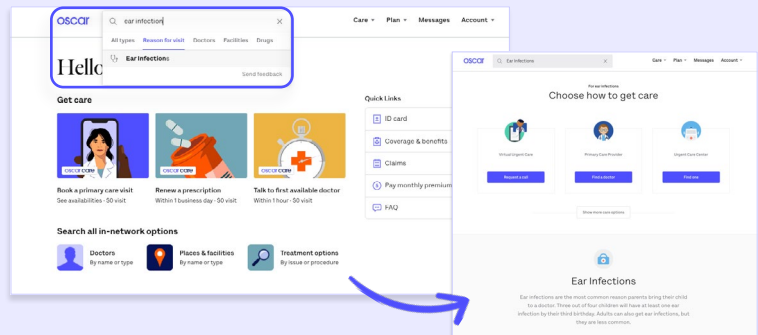

There's always Oscar Primary Care

Not sure where to start when searching for care?

With Oscar Primary Care* you can choose a high-quality, primary care provider as your long-term health care partner. See your provider virtually (*without having to go anywhere*) and they'll help make sure you get whatever you need — labs, imaging, meds, specialist visits, etc. (*Oh, and visits are always \$0.*)

Learn more by visiting the “Virtual Primary Care” section under the member resources tab. Or just tap “Book a primary care visit” on your account page.



Now you know how to
search for care. Go you!

*Oscar Primary Care providers are employed by Oscar Medical Group, not Oscar Insurance Company or its insurance plan affiliates. Oscar Primary Care is only available to members 18 years of age and older. Prescriptions, visits and services may be limited at the provider's discretion and Oscar Primary Care is not intended to be used in conjunction with another primary care consultation. Oscar Care in-person visits in conjunction with your virtual visit may have a copayment. Due to medical licensing laws, you must be in your home state at the time of your virtual visit.