



# Persona Homes

by Home Group

## LANGUARD VIEW

DOVERCOURT

### Oakley

(Plot 13)

2-bedroom homes

*A perfect starter home with more than you would expect!*

The open plan living space includes a modern kitchen with a full range of integrated appliances and is a great space to relax or entertain. The large storage cupboard that gives you the flexibility to keep clutter to a minimum or create a working from home space. Upstairs there are two double bedrooms and a bright and modern bathroom. This home comes with allocated parking.



Contact us:

**T: 0800 030 8888**

**E: [contactus@yourpersonahome.com](mailto:contactus@yourpersonahome.com)**

**W: [yourpersonahome.com](http://yourpersonahome.com)**

Low Road, Dovercourt, Essex, CO12 3TQ.

# Plot 13

## Ground floor

Kitchen/living/dining 3.50m x 8.78m

## First floor

Main bedroom 3.49m x 3.42m

Bedroom 2 4.49m x 3.74m

Bathroom 1.9m x 2.19m

Total floor area 80.44m<sup>2</sup>

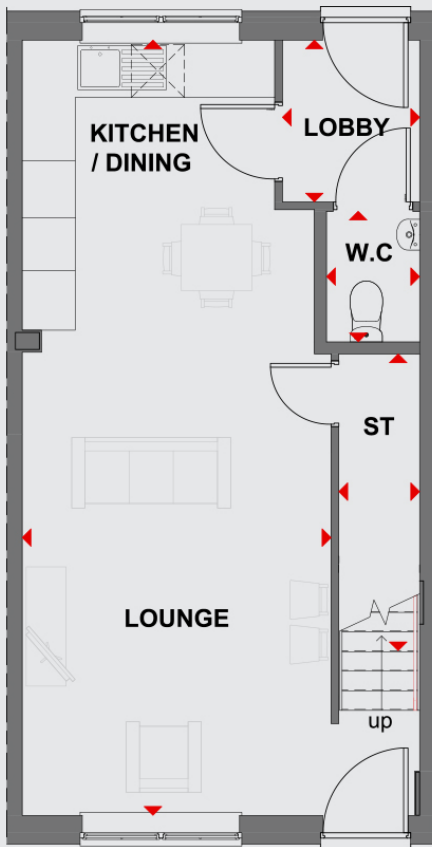

Ground floor

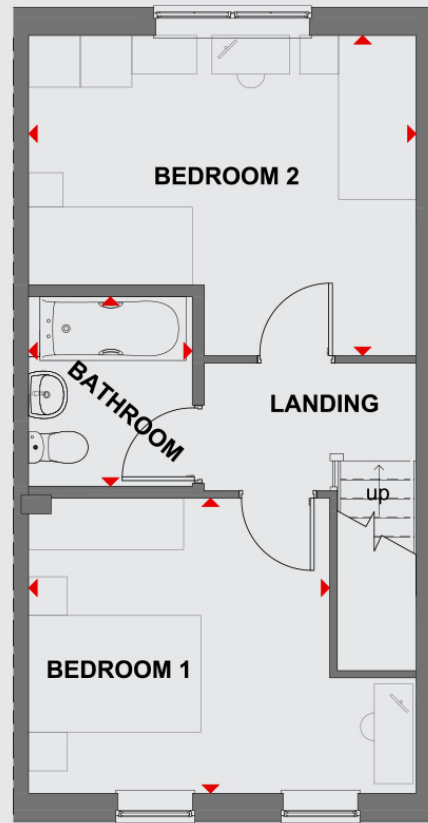

First floor



Any floor plans are a general outline of the layout of the property for guidance only. All measurements are approximate and may vary and any intending purchasers should not rely on them as statements of fact or representations of fact but must satisfy themselves by inspection or otherwise as to their accuracy. Dimensions shown are not intended to be relied upon for installation of appliances or items of furniture or otherwise. CGI's and images are for illustrative purposes only. Specifications are subject to change. Images are indicative only and may be of previous developments.\*Journey times and distances taken from google.com/ maps and are correct before going to print. All times and distances listed are approximate and may vary depending on time of travel.



# Persona Homes

by Home Group

## LANGUARD VIEW

DOVERCOURT

### Oakley

(Plots 8, 9, 10, 12, 14, 15 and 16)

2-bedroom homes

*A perfect starter home with more than you would expect!*

The open plan living space includes a modern kitchen with a full range of integrated appliances and is a great space to relax or entertain. The large storage cupboard that gives you the flexibility to keep clutter to a minimum or create a working from home space. Upstairs there are two double bedrooms and a bright and modern bathroom. This home comes with allocated parking.



Contact us:

**T: 0800 030 8888**

**E: [contactus@yourpersonahome.com](mailto:contactus@yourpersonahome.com)**

**W: [yourpersonahome.com](http://yourpersonahome.com)**

Low Road, Dovercourt, Essex, CO12 3TQ.

Plots 8, 9, 10, 12, 14, 15 and 16

## Ground floor

Kitchen/living/dining 3.50m x 8.78m

## First floor

Main bedroom 3.49m x 3.42m

Bedroom 2 4.49m x 3.71m

Bathroom 1.9m x 2.19m

Total floor area 80.44m<sup>2</sup>

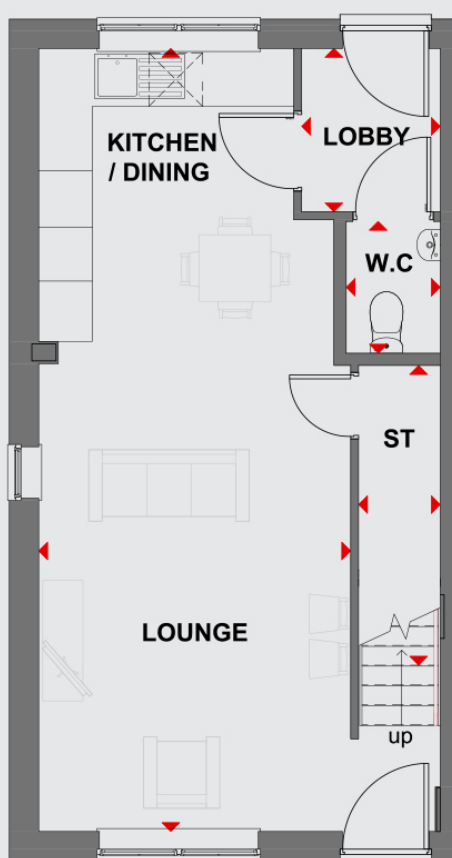

Ground floor

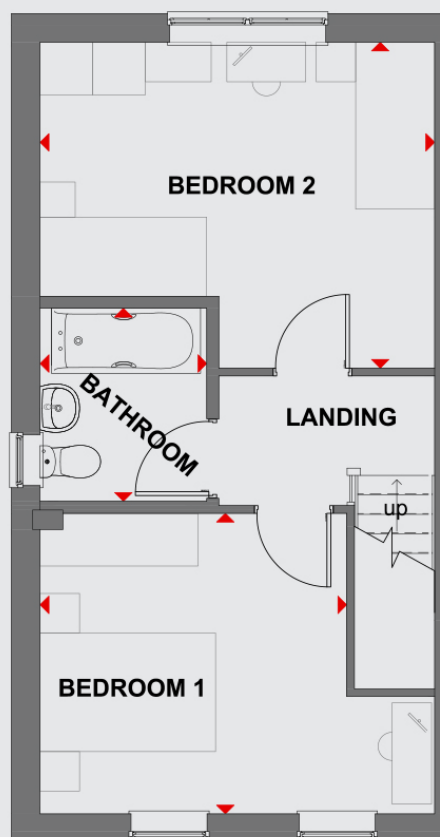

First floor



Any floor plans are a general outline of the layout of the property for guidance only. All measurements are approximate and may vary and any intending purchasers should not rely on them as statements of fact or representations of fact but must satisfy themselves by inspection or otherwise as to their accuracy. Dimensions shown are not intended to be relied upon for installation of appliances or items of furniture or otherwise. CGI's and images are for illustrative purposes only. Specifications are subject to change. Images are indicative only and may be of previous developments.\*Journey times and distances taken from [google.com/maps](https://www.google.com/maps) and are correct before going to print. All times and distances listed are approximate and may vary depending on time of travel.



# Persona Homes

by Home Group

## LANGUARD VIEW

DOVERCOURT

### Oakley

(Plots 43 and 44)

2-bedroom homes

*A perfect starter home with more than you would expect!*

The open plan living space includes a modern kitchen with a full range of integrated appliances and is a great space to relax or entertain. The large storage cupboard that gives you the flexibility to keep clutter to a minimum or create a working from home space. Upstairs there are two double bedrooms and a bright and modern bathroom. This home comes with allocated parking.



Contact us:

**T: 0800 030 8888**

**E: [contactus@yourpersonahome.com](mailto:contactus@yourpersonahome.com)**

**W: [yourpersonahome.com](http://yourpersonahome.com)**

Low Road, Dovercourt, Essex, CO12 3TQ.

## Plots 43 and 44

### Ground floor

Kitchen/living/dining 3.50m x 8.78m

### First floor

Main bedroom 3.49m x 3.44m

Bedroom 2 4.49m x 3.69m

Bathroom 1.93m x 2.18m

Total floor area 80.44m<sup>2</sup>

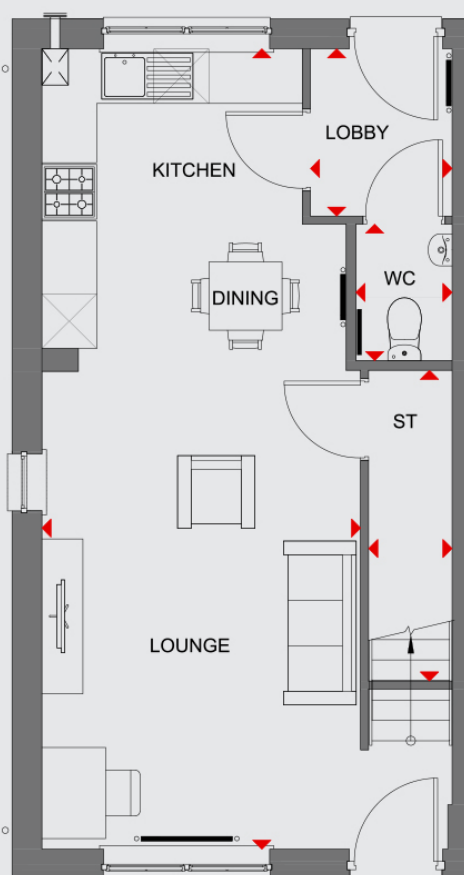

Ground floor

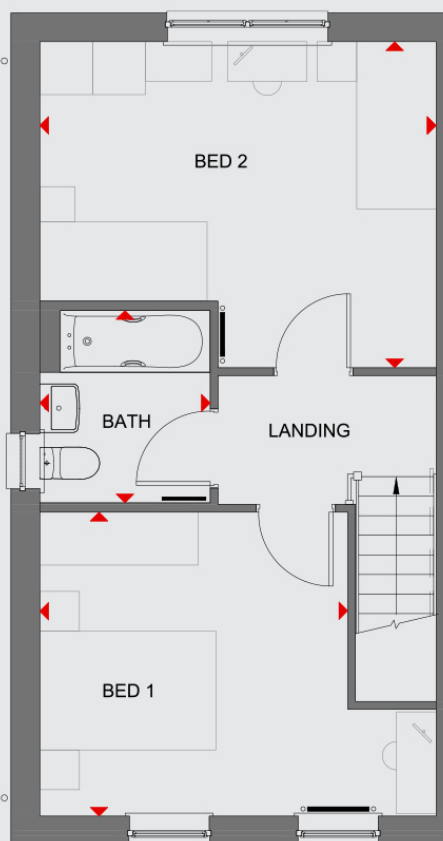

First floor



Any floor plans are a general outline of the layout of the property for guidance only. All measurements are approximate and may vary and any intending purchasers should not rely on them as statements of fact or representations of fact but must satisfy themselves by inspection or otherwise as to their accuracy. Dimensions shown are not intended to be relied upon for installation of appliances or items of furniture or otherwise. CGI's and images are for illustrative purposes only. Specifications are subject to change. Images are indicative only and may be of previous developments.\*Journey times and distances taken from [google.com/maps](https://www.google.com/maps) and are correct before going to print. All times and distances listed are approximate and may vary depending on time of travel.