

LIV GOLF IS BACK

Apr 26 - 28, 2024

The Grange Golf Club, Adelaide

HOSPITALITY THAT MAKES HISTORY

LIV Golf Adelaide has already earned legend status thanks to last season's Watering Hole in One. History will happen again this year... and it'll happen all over the course.

We've created world-class hospitality at every point, from the ring of raucous terraces round the Watering Hole to the platinum theatres on the 18th. Each venue gives you a prime vantage point for the next amazing shot, and creates fan experiences that golf has never seen before.



GOLF, BUT LOUDER

A new kind of golf. A new way to watch it.

LIV Golf combines a unique team format with hospitality to wow your friends and clients.



FASTER

Our five-hour days fit everyone's schedule and our shotgun starts mean instant action on every hole.



CLOSER

You can walk the course whenever you want, and you'll find the players behind ropes, not walls.

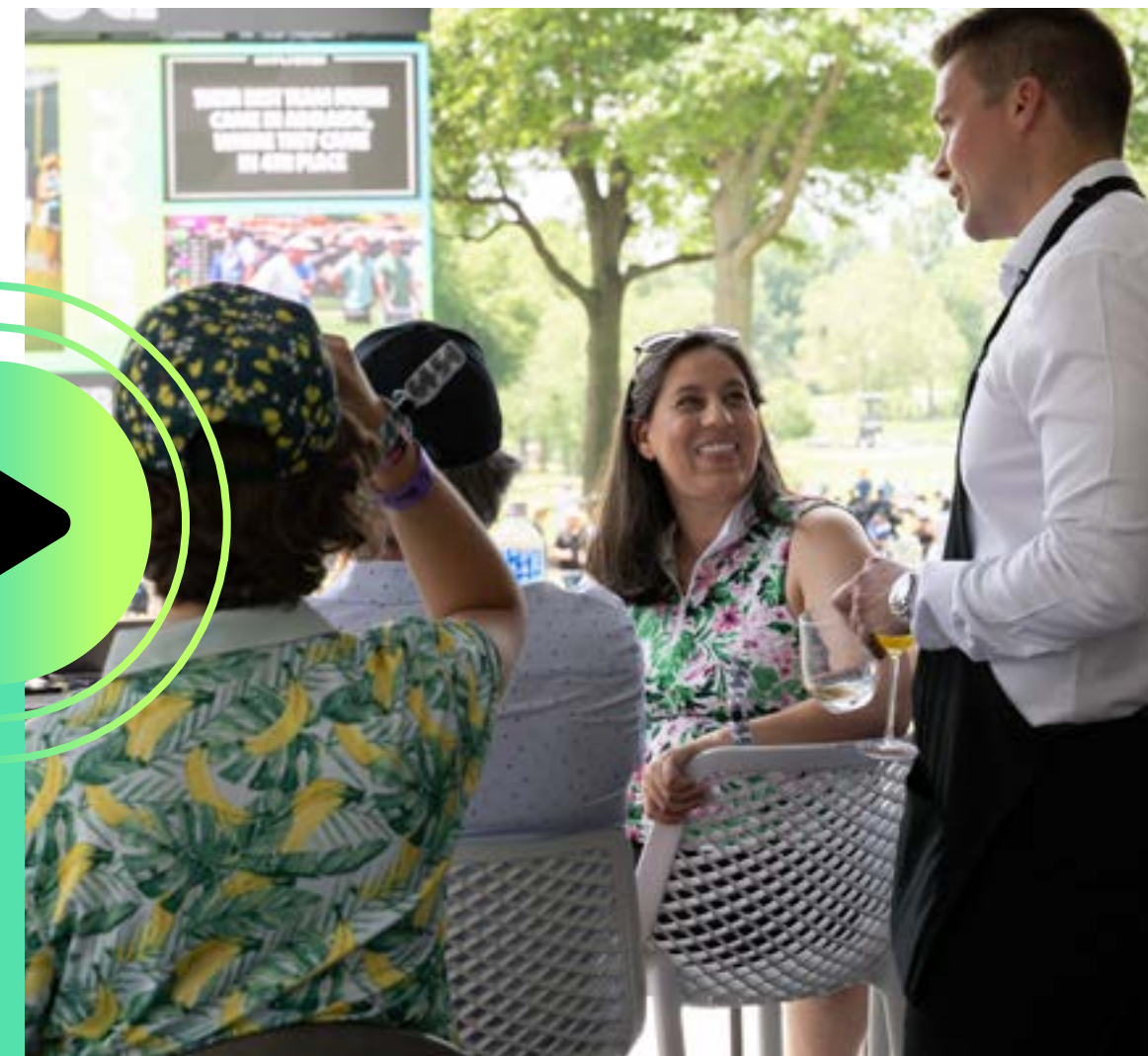

FRIENDLIER

Every venue has a friendly vibe, so you can network, mingle and entertain your guests from start to finish.



LOUDER

You'll enjoy live DJs in the party venues and get access to headline concerts wherever you are.

LIV GOLF CLASSICS

Wherever you want to watch, we've got the perfect spot.



CLUB 54

Ultra-platinum luxury
on the crucial 18th.



GALLERY CLUB

Premium views
at a perfect price.



BIRDIE SHACK

Centre of the course,
middle of the party.



BAROSSA

Prime views of the
14th and 16th green.

WATERING HOLE FAVORITES

One hole. Four venues. A place for every fan.



CELLAR DOOR

Unrivalled extravagance
over the flag.



BEACH CLUB

Platinum party
on the green.



THE GARDEN

Spectacular views
of the tee box.



SHARK SHACK

The loudest venue
of them all.

KEY

-  **INFORMATION CENTRE**
-  **VIEWING PLATFORM**
-  **DISABILITY ACCESS**
-  **DISABILITY ACCESS HUB**
-  **DISABILITY ACCESS PARKING**
-  **PUBLIC TOILETS**
-  **DISABILITY ACCESS TOILETS**
-  **PUBLIC CATERING**
-  **HYDRATION STATION**
-  **TV SCREEN / LEADERBOARD**
-  **MEDICAL / FIRST AID**
-  **CROSSING POINTS**

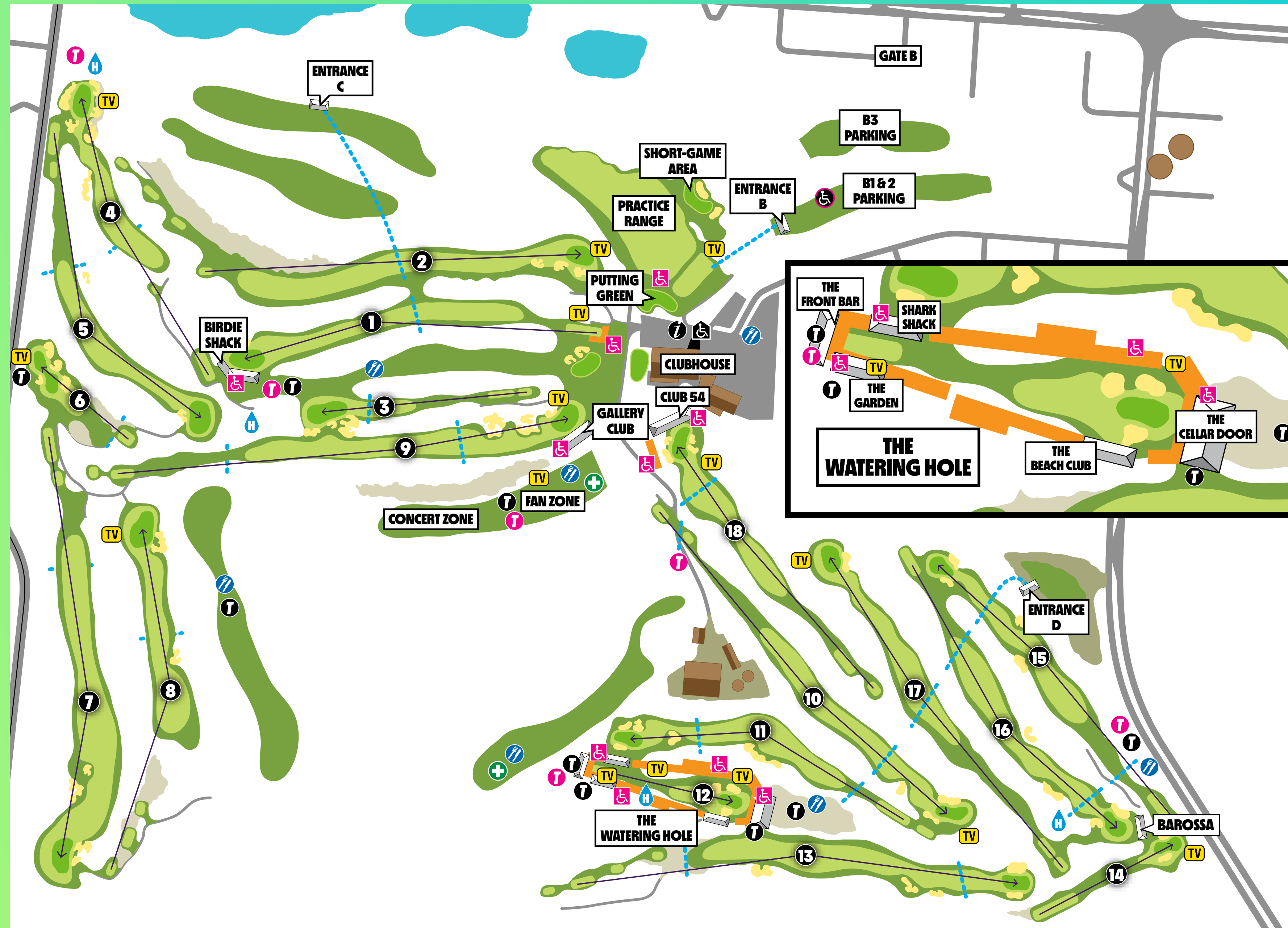

CLUB 54

Club 54 is a climate-controlled destination over the crucial 18th green which gives you the very best of everything.

See the players warm up in a private area on the range with your own hand-made drink, then watch the action in a luxury enclosed lounge with open-air viewing terrace. You'll be directly behind the green and you'll enjoy a chef-led, multi-course menu brimming with local delights.

A 5-star experience for your clients. An unforgettable moment with your friends.

Price

Starting from \$1,131 (One Day)

All ticket prices displayed are quoted in AUS dollars. All pricing is subject to change at any time without notice.



LOCATION

A prime vantage point over the crucial 18th green.

DINING

Enjoy classic South Australian foods all day with a chef-led, multi-course menu. Breakfast, morning and afternoon tea all included.

DRINKS

Find all your favourite refreshments in our fully open bar: wine, beer, spirits, soft drinks and barista-crafted coffee.

INCLUDED EXTRAS

- Air conditioned ultra-premium space.
- Exclusive access to Club 54 open-air viewing area overlooking the driving range.
- Interior bathrooms.
- TV screens throughout.
- Course access.

VIP PARKING

One pass for 2-4 tickets, two passes for 5 or more tickets.

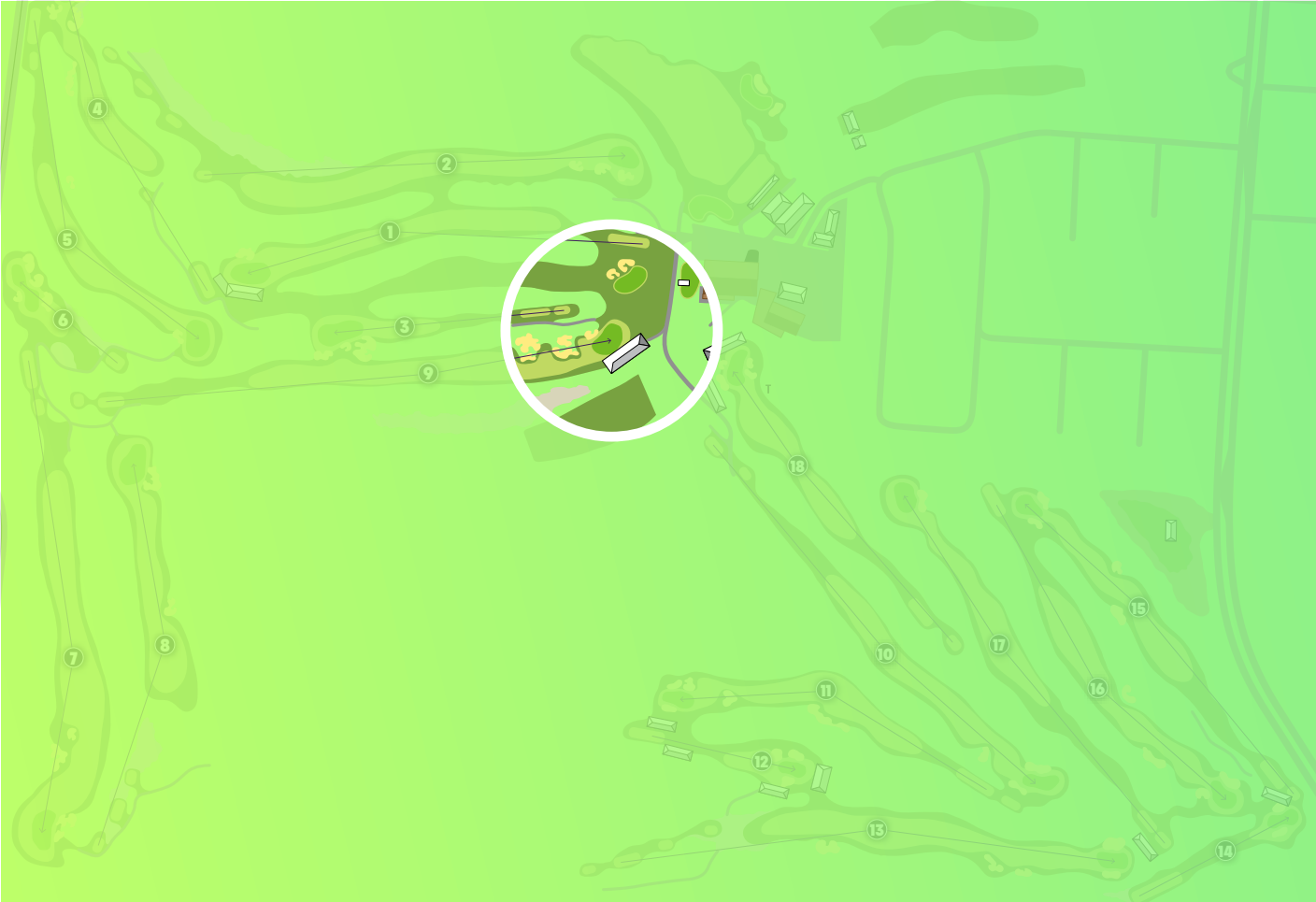

LIV GOLF
GALLERY CLUB

KEY

-  **VIEWING DECK**
-  **REFRESHMENTS - ALL ACCESS**
-  **SPECTATOR TOILETS**

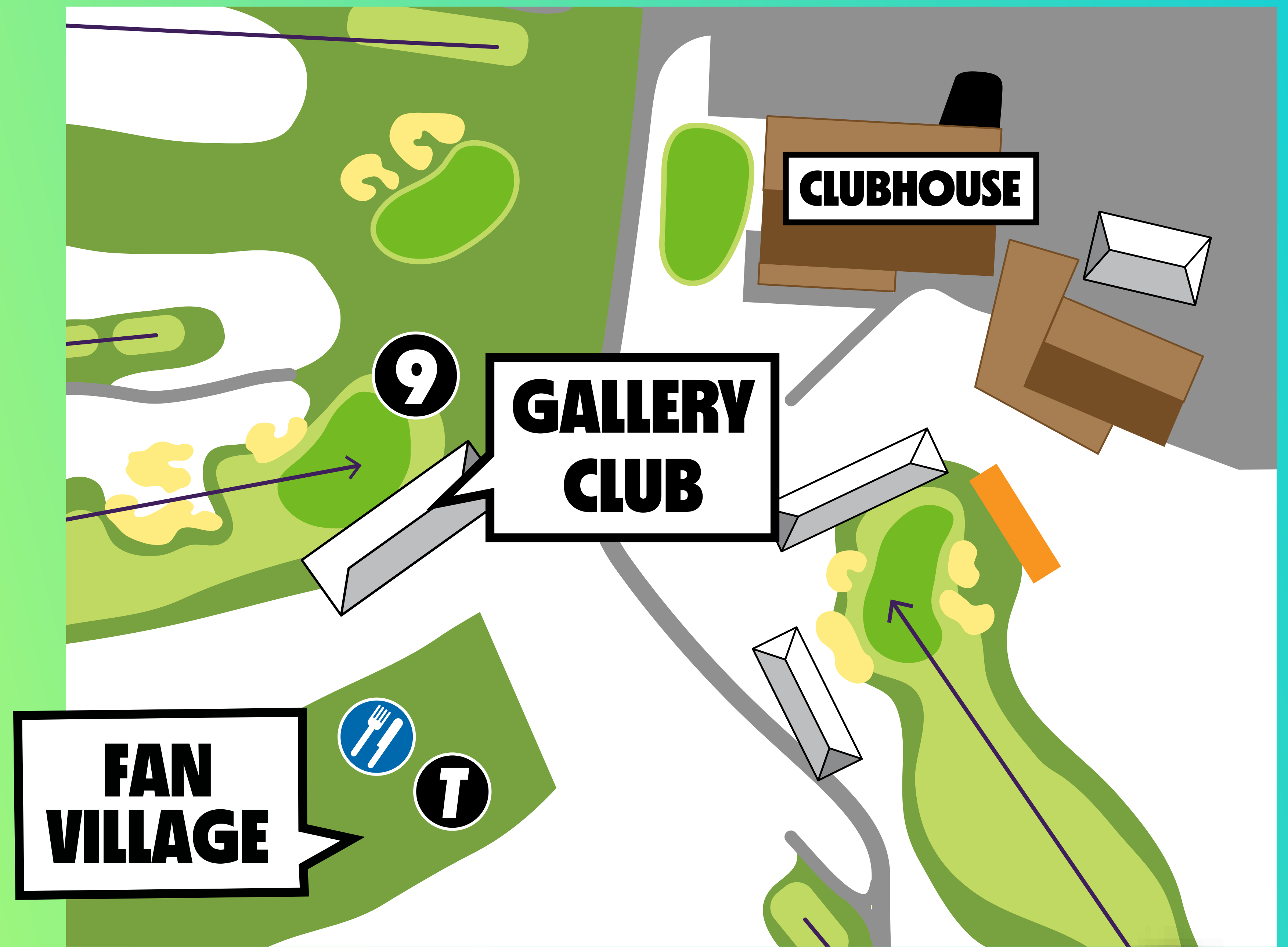

GALLERY CLUB

The Gallery Club is a premium hospitality venue at the main intersection of The Grange. It's right next to the electric Fan Village and its prices are perfect for larger groups.

You and your guests will be right over the 9th green, and you'll enjoy every shot in a covered open-air space. There'll be unlimited wine, beer and soft drinks, with quick-bite options to graze all day. And if you fancy getting closer to the action, you can go down and follow the players hole to hole.

Price

Starting from \$536 (One Day)

All ticket prices displayed are quoted in AUS dollars. All pricing is subject to change at any time without notice.



LOCATION

Perfect views over the 9th green with easy access to the festival atmosphere in the Fan Village.

DINING

Sample South Australian delights throughout the day with a luxury grazing menu, lovingly curated by our chefs.

DRINKS

Our beverage package includes wine, beer, and soft drinks - a perfect pour for every palate.

INCLUDED EXTRAS

- Open-air space with balcony.
- TV screens throughout.
- Course access.

GALLERY CLUB SKYBOX

Our semi-private Skyboxes give you the best of the Gallery Club and add an extra touch of luxury.

You'll enjoy the same great food, drinks and view, but now you get an all-inclusive bar and reserved seats, as well as a dedicated wait service in the main, covered section of the Club.

So you can go down to the course and mingle with other guests, without losing your vantage point - or spend the entire day at your table and have everything brought to you.

Price

Starting from \$5,992 (One Day)
Capacity of 8 people per Skybox

All ticket prices displayed are quoted in AUS dollars. All pricing is subject to change at any time without notice.

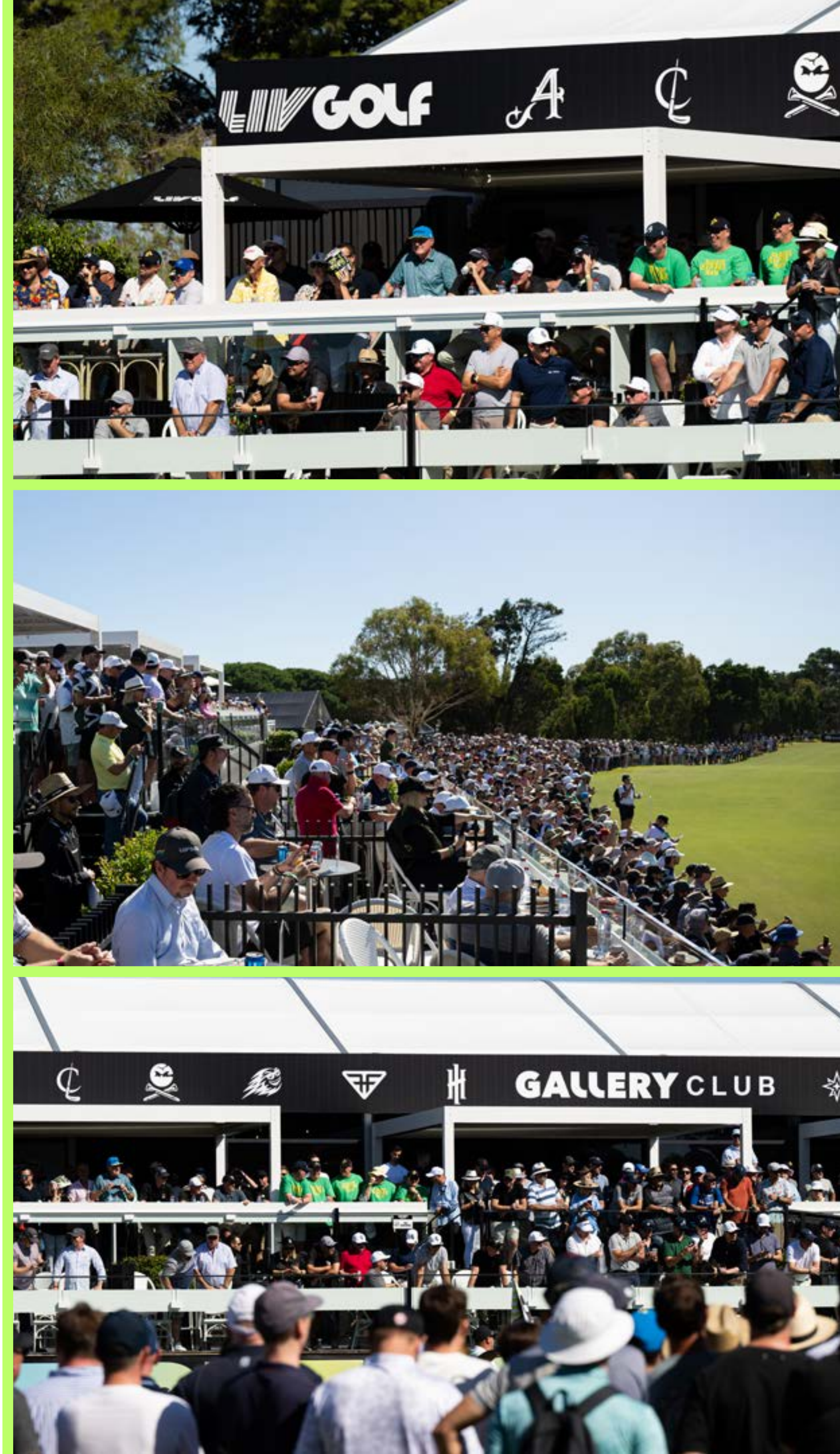

LOCATION

Elevated views of the 9th green with easy access to Fan Village .

DINING

Taste the best of South Australian cuisine with premium local produce, brought to you throughout the day.

DRINKS

On top of the beer, wine and soft drink options, you can now choose cocktails from the all-inclusive bar.

INCLUDED EXTRAS

- Semi-private area to entertain up to 8 guests.
- Personal host service.
- Open-air with balcony.
- TV screens throughout.
- Course access.
- 3 parking passes.



GOLF **BIRDIE SHACK**

KEY



REFRESHMENTS - ALL ACCESS



SPECTATOR TOILETS

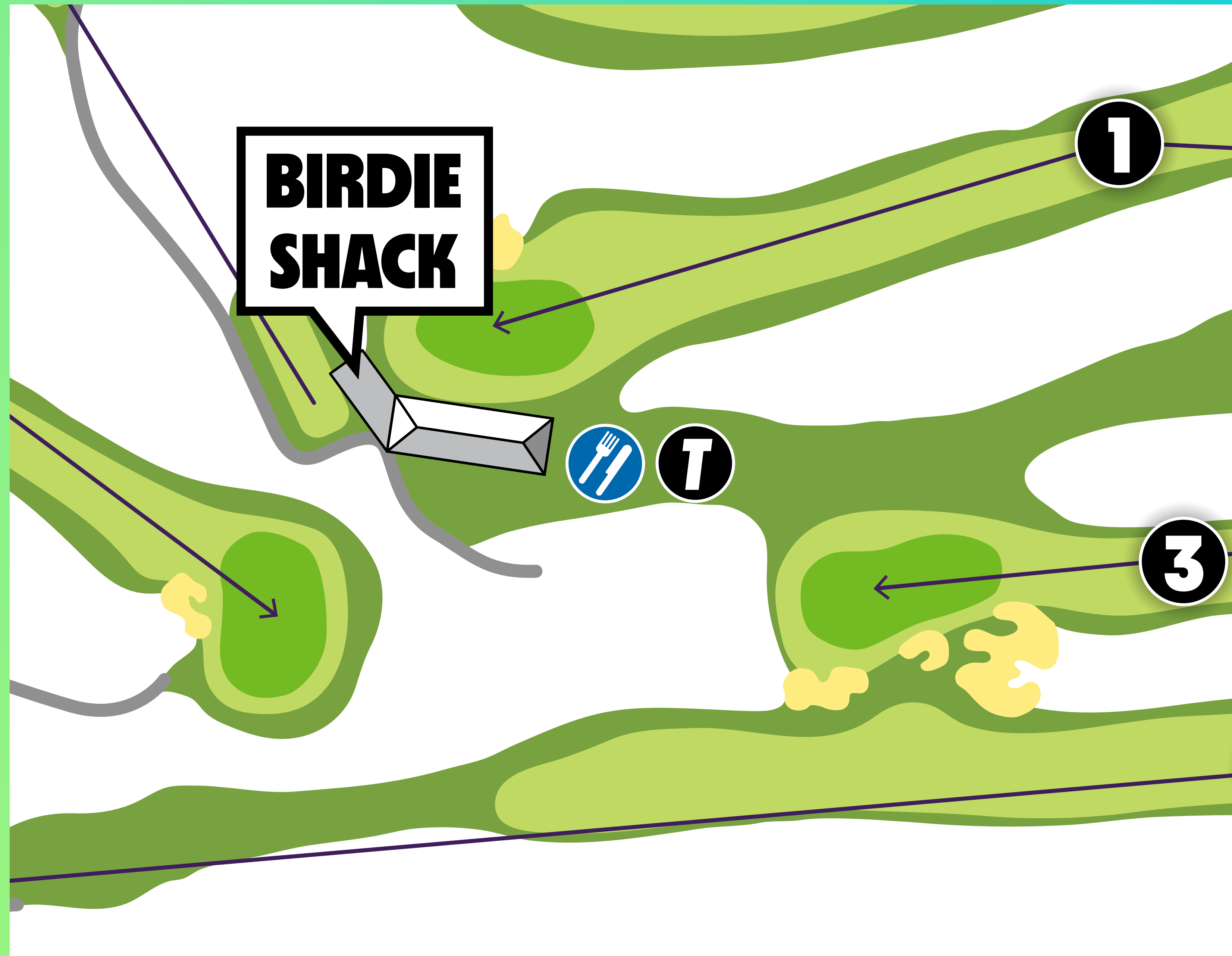

BIRDIE SHACK

Our events bring you golf, but LOUDER - and the Birdie Shack is as loud as anywhere. This vibrant open-air enclosure on the 1st green and 4th tee box puts you and your friends in the middle of the party, with live DJs all day and three drinks included (beer, wine, or soft drinks).

So, you can sing, chant and share great vibes with your tribe. Everyone around you will be doing the same.

Price

Starting from \$391 (One Day)

All ticket prices displayed are quoted in AUS dollars. All pricing is subject to change at any time without notice.



LOCATION

Direct views of the 1st green and 4th tee box, with the 5th green slightly beyond.

DINING

A wide selection of premium food vendors can be found in the surrounding precinct.

DRINKS

You'll find three (3) drinks included with each ticket, and you'll have access to a dedicated cash bar within the venue.

STYLE

Syndicated open-air facility with balcony.

INCLUDED EXTRAS

- TV screens throughout.
- Course access.

BAROSSA

New for 2024, Barossa takes its name from South Australia's idyllic wine region and it's infused with the noise and colour that made LIV Golf Adelaide so memorable last season.

You'll enjoy prime views of the 14th and 16th green, as well as outgoing views of the 15th tee, from the highest vantage point on the whole course. The atmosphere is warm and relaxed, and you'll find a wide range of drinks available for purchase.

Price

Starting at \$304 (One Day)

All ticket prices displayed are quoted in AUS dollars. All pricing is subject to change at any time without notice.



LOCATION

Premium on-course location on course with views over the 14th and 16th greens, and the 15th tee.

STYLE

Syndicated open-air facility with viewing platform.

INCLUDED EXTRAS

- Ground entry pass.
- DJ & party atmosphere.
- Large TV screens.

THE WATERING HOLE



THE WATERING HOLE

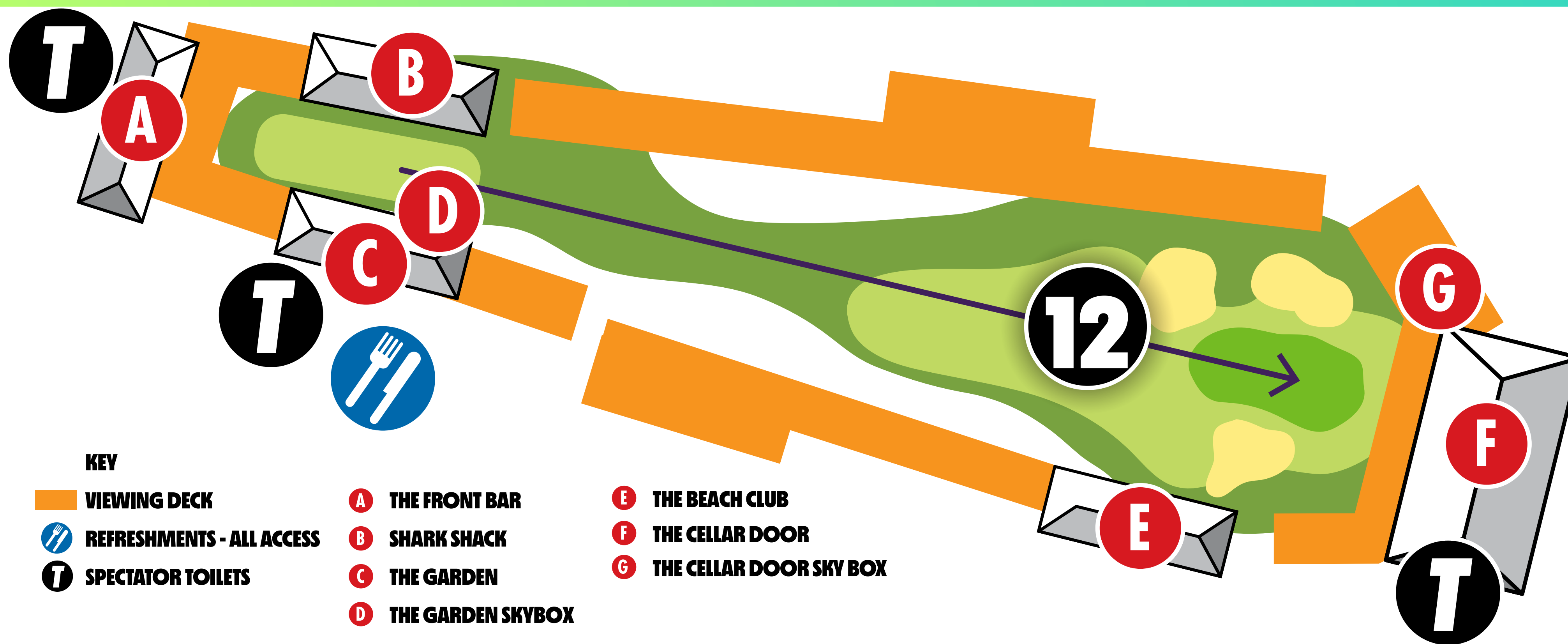
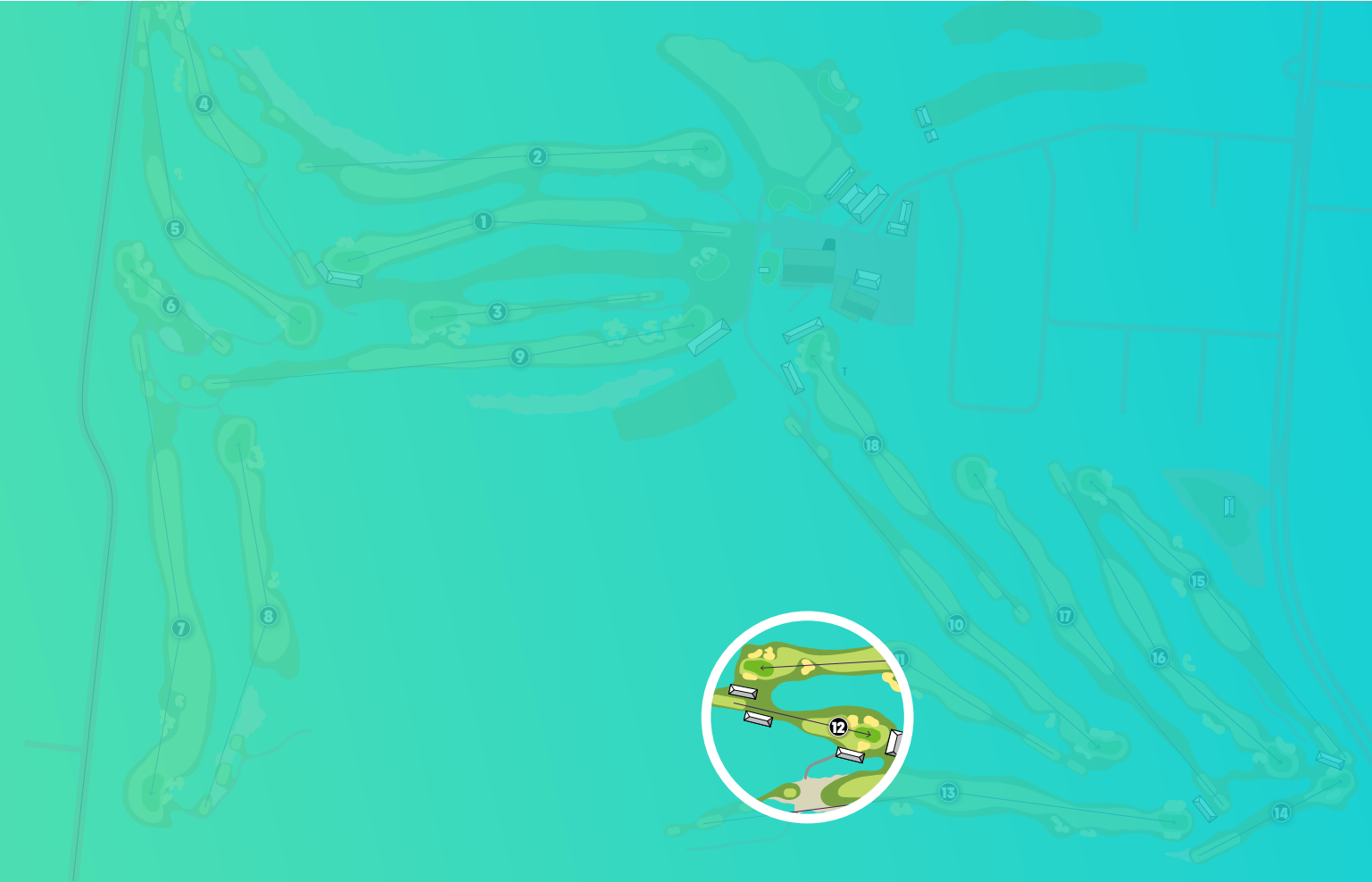

SHARK SHACK

Shark Shack is the beating heart of the Watering Hole, the place where the hardest revellers congregate. With a live DJ and three drinks per ticket-holder, this is a joint where you can really bring the noise.

But it's not just about the great vibes and the lively tribe. Shark Shack is an ideal spot to watch golf, with prime views of the 12th tee as well as the 11th and 12th greens.

Price

\$474 (One Day)

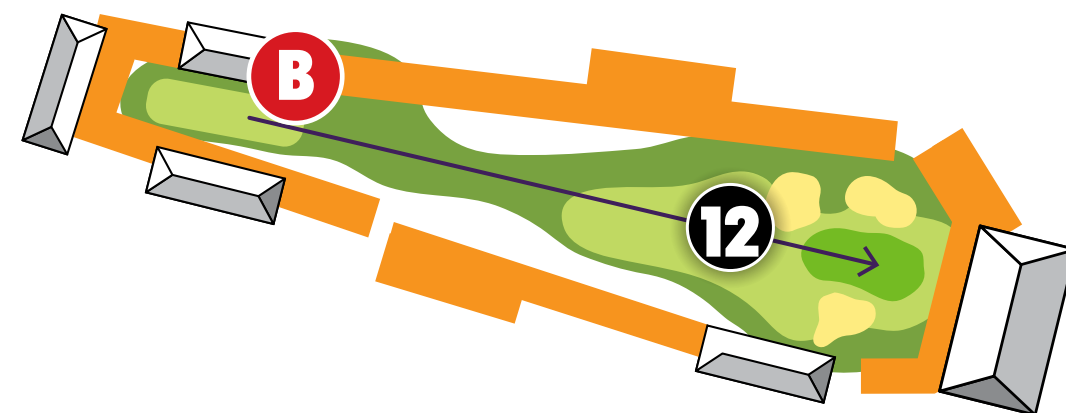

All ticket prices displayed are quoted in AUS dollars. All pricing is subject to change at any time without notice.



LOCATION

Prime views of the 12th tee and 11th green on either side of the facility.

DRINKS

Three (3) drinks included in your package, and a dedicated cash bar in the venue to keep you topped up.

STYLE

Syndicated open-air facility with balcony.

INCLUDED EXTRAS

- TV screens throughout.
- Course access.

THE GARDEN

Situated alongside the tee box on the Watering Hole, this open-air venue gives you live music in a vibrant atmosphere with beer, wine or soft drinks included.

You're right in the thick of things here, so you can enjoy the vibe, chat to those around you or simply focus on the action. The party is all around you, and the golf is front and centre.

Price

Starting at
\$589 (One Day)

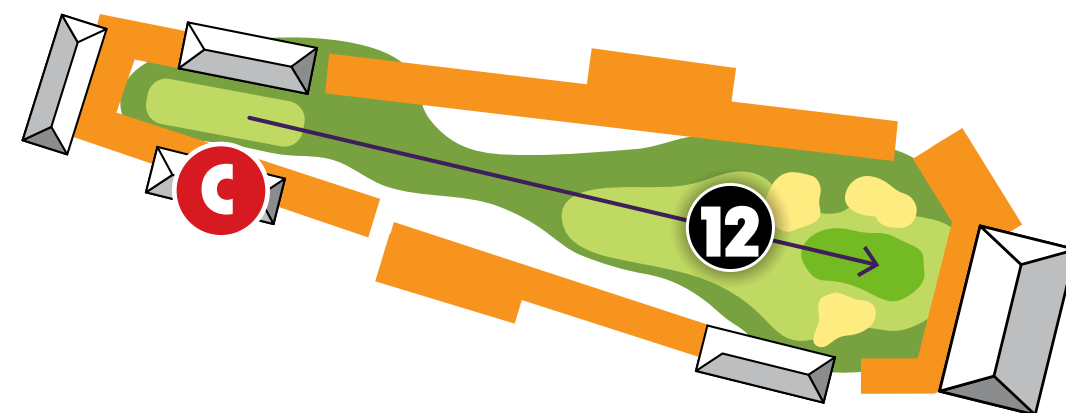

All ticket prices displayed are quoted in AUS dollars. All pricing is subject to change at any time without notice.



LOCATION

Spectacular scenes overlooking the Watering Hole tee box, even closer than in 2023.

DINING

Discover the best of South Australian cuisine with a selection of delicious light bites throughout the day.

DRINKS

Choose from beer, wines and soft drinks in our premium all-day beverage package.

STYLE

Contemporary lounge furnishing with balcony access.

INCLUDED EXTRAS

- Pod coffee and premium teas.
- TV screens throughout.
- Course access.

THE GARDEN SKYBOX

Our semi-private Skyboxes create your own little space within The Garden, so you can add an extra touch of luxury to the party. You'll have your own dedicated wait staff and all-inclusive bar (including spirits).

Your seats are reserved, so you can roam the course or socialise in the club, knowing your dedicated spot will be there when you get back.

Price

Starting at \$6,640 (One Day)
Capacity of 8 people per Skybox

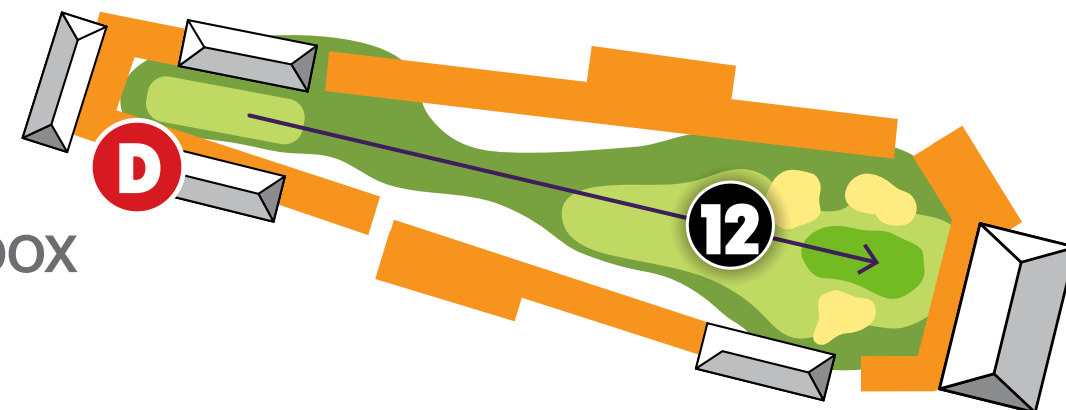

All ticket prices displayed are quoted in AUS dollars. All pricing is subject to change at any time without notice.



LOCATION

Spectacular scenes overlooking the Watering Hole, even closer to the tee box than in 2023.

DINING

Taste, savour, repeat: our waiters will bring you premium South Australian foods throughout the day.

DRINKS

The bar is filled with beer, wine, soft drinks and spirits. So you can choose your favourite drop, and top up whenever you want.

STYLE

Contemporary lounge furnishing with balcony access.

INCLUDED EXTRAS

- Semi-Private area with personal waiting service for 8 guests.
- Air conditioned space with balcony .
- TV screens throughout.
- Course access.

THE BEACH CLUB

This luxury open-air venue is perched right over the flag on the 12th, and it's inspired by the blissful beach houses along Adelaide's golden coastline.

You'll catch every shot from a bird's eye terrace, featuring an all-inclusive bar and light bites all day. Whether you're coming to win new clients, impress old ones or simply treat your friends to a different kind of golf day, this is the place to do it.

Price

Starting at
\$630 (One Day)

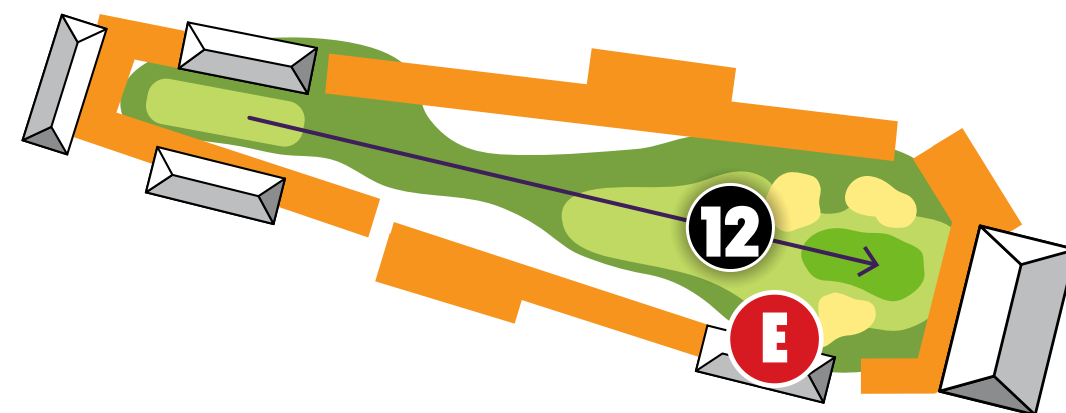

All ticket prices displayed are quoted in AUS dollars. All pricing is subject to change at any time without notice.



LOCATION

Spectacular scenes overlooking the Watering Hole green and 13th fairway.

DINING

A premium menu of classic South Australian dishes, perfectly spread throughout the day.

DRINKS

Your choice of wine, beer, spirits and soft drinks, and as many top-ups as you want.

STYLE

Contemporary lounge furnishing with balcony access.

INCLUDED EXTRAS

- Pod coffee and premium teas.
- TV screens throughout.
- Course access.

THE CELLAR DOOR

The Cellar Door is an ultra-premium climate-controlled venue for those who want to really live it up. You'll be on top of the green, just metres from the action, with a multi-course menu and fully open bar.

This is the very top end of the Watering Hole, where you can join the party while also savouring classic hospitality.

Price

Starting at
\$1,188 (One Day)

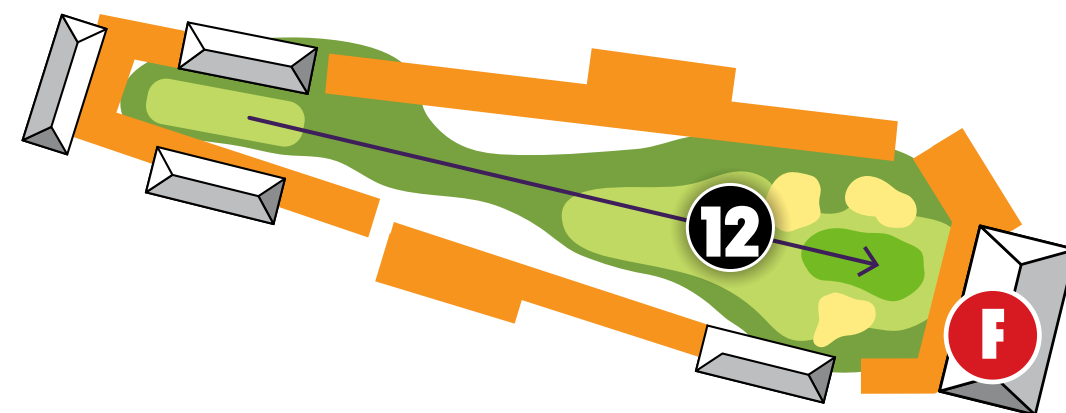

All ticket prices displayed are quoted in AUS dollars. All pricing is subject to change at any time without notice.



LOCATION

Perfect scenes overlooking the 12th green.

DINING

A chef-curated, multi-course menu brimming with South Australian classics. Served throughout the day, perfect for leisurely grazing.

Breakfast, morning and afternoon tea all included.

DRINKS

A premium all-day bar offering beer, wine, spirits and soft drinks. All the drinks you love, as often as you like.

STYLE

Contemporary lounge furnishing with balcony access.

INCLUDED EXTRAS

- Light breakfast on arrival.
- Barista coffee with morning and afternoon service.
- Internal bathrooms.
- TV screens throughout.
- Course Access.

THE CELLAR DOOR SKYBOX

Our semi-private Skyboxes give you a unique reserved viewing area within Cellar Door, with the best seats reserved for your party of 6, along with dedicated wait service.

You'll enjoy all the benefits of Cellar Door - the semi-private viewing area, the fully open bar, the multi-course menu - and take them up a notch. This is elite luxury with a couple of extra stars on top.

Price

Starting at \$7,488

Capacity of 6 people per Skybox

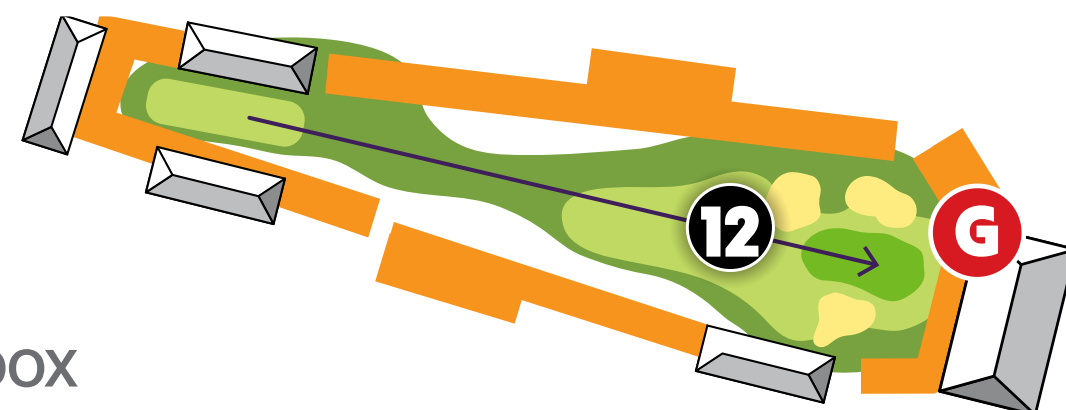

All ticket prices displayed are quoted in AUS dollars. All pricing is subject to change at any time without notice.



LOCATION

Spectacular scenes overlooking The Watering Hole green.

DINING

A multi-course menu of local seasonal fare, carefully curated by our resident chefs.

DRINKS

A premium all-day bar offering all your favourite wines, beers, spirits and soft drinks.

PARKING

2 parking passes per day.

INCLUDED EXTRAS

- Semi-Private area with personal waiting service for 6 guests.
- Barista coffee with morning and afternoon service.
- Internal bathrooms.
- TV screens throughout.
- Course access.

PRIVATE SUITES

PRIVATE SUITES

PRIVATE SUITES

PRIVATE

Want to host a big meeting, a company outing or a party for all your favourite people? Try one of our private hospitality suites for size.

You'll have a vast private area with your own personal wait service, who'll happily treat you to a range of premium beverages, including South Australian wines and spirits mixed by your own bartender.

You'll also enjoy food throughout the day, with canapés adapted to every dietary need.

Starting at 30 tickets.

Contact adelaide@livgolf.com to enquire about this bespoke offering

LOCATION

The ultimate viewing experience over the Watering Hole or 18th green.

DINING

Enjoy a luxury lunch that lasts all day, with light bites inspired by Adelaide and its melting pot of culinary cultures.

DRINKS

All your favourite drinks, served the way you want, with a personal bartender at your service throughout the day.

PARKING

Includes 5 VIP parking passes per day.

INCLUDED EXTRAS

- Private area with personal waiting service.
- Balcony access with exceptional course viewing.
- Large TV screens.



CHEER THE LOCAL HEROES RIPPER GC



**WE ARE PUMPED TO BE
RETURNING TO AUSTRALIA TO
BE AT THE BIGGEST PARTY ON
THE LIV GOLF CALENDAR.**

CAMERON SMITH





A C         S 

GOLF

Enquiries: adelaide@livgolf.com

