

# SIDE BY SIDE MODE TO SEE INSTRUCTOR & PRESENTATION AT THE SAME TIME

If you are joining the Zoom call via desktop or laptop computer, we recommend you enable Zoom's Side-by-Side mode.

You can turn on Side-by-Side mode by going into your video settings next to the camera icon – which is in the bottom left corner of the Zoom window. Click “Share Screen” and then check the box next to “Side-by-Side mode.”

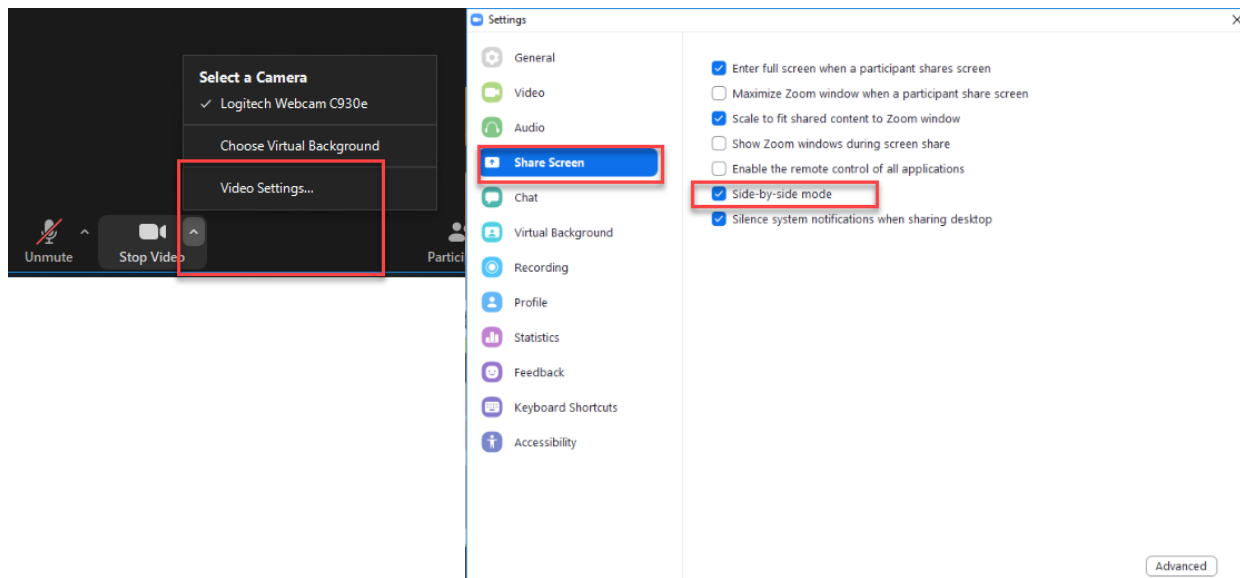

Use the slider to adjust size of screen share and videos

You can also turn it on at top of screen while someone is sharing: select VIEW OPTIONS, then SIDE BY SIDE MODE.

You are viewing Cynthia Parrott's screen

View Options

- Zoom Ratio Fit to Window
- Request Remote Control
- Exit Full Screen
- ✓ Side-by-side mode
- Stop Participant's Sharing

Training page 1 SRS PSR DAY 2 - Occupational Medicine Intro 2.0 Test 0-5-20 - Word

Microsoft Word Ribbon: Font, Paragraph, Styles, Layout, References, Send To Mobile, View, Help



is: **IWC** = Initial Work Comp Visit (Initial e.g. NOV or CON)  
**WCV** = Work Comp Visit (Follow up e.g. RCK)

from outside SRSMG to schedule a **New Workers' Compensation** **are, please STOP.** This includes outside physician's offices, and nurse case managers.  
 to (858) 262-6306 to speak with Occupational Health Services or screening.

**MAP FOR SUCCESS – 7 EASY STEPS**



slider

Cynthia Parrott

Jean Frazier