

# EBBA CONSOLE

## Assembly Instructions

URBAN OUTFITTERS

### TOOLS REQUIRED BUT NOT INCLUDED:

Phillips head screwdriver, hammer

### WARNINGS:

Do not throw away packing materials and carton until after assembly. Assemble all parts on a clean smooth surface

### CARE INSTRUCTIONS:

Avoid direct exposure to sunlight. Do not place overheat or air conditioning vents. Adjust levelers so that the furniture sits flat on uneven floors.

Blot spills do not rub, with a clean white cloth.

Do not use harsh chemicals.

Before cleaning any part test a small spot in a hidden area.

You may need to re-tighten all bolts after initial use.

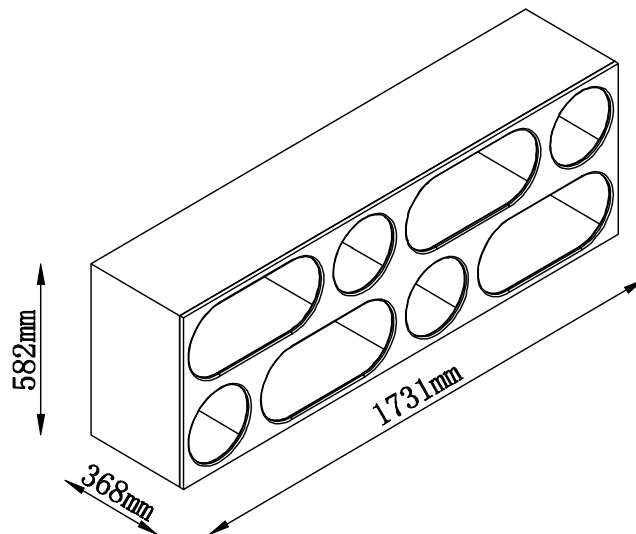

### PARTS INCLUDED

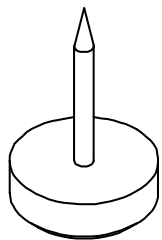

(A) Nylon glide  
x 4

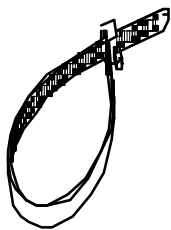

(B) Nylon strip  
x 1

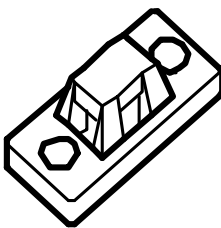

(C) Bracket  
x 2

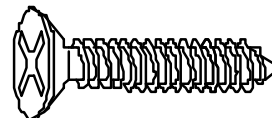

(D) Screw  
[M3 x 32mm] x 2

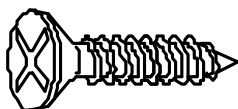

(E) Screw  
[M3 x 19mm] x 2

### STEP 1

Lay the Console out onto a clean smooth surface such as carpet or cardboard. Use a hammer to tap the nylon glides (A) into the base of the bookshelf as shown. Determine the desired orientation of the console prior to attaching the nylon glides (A).

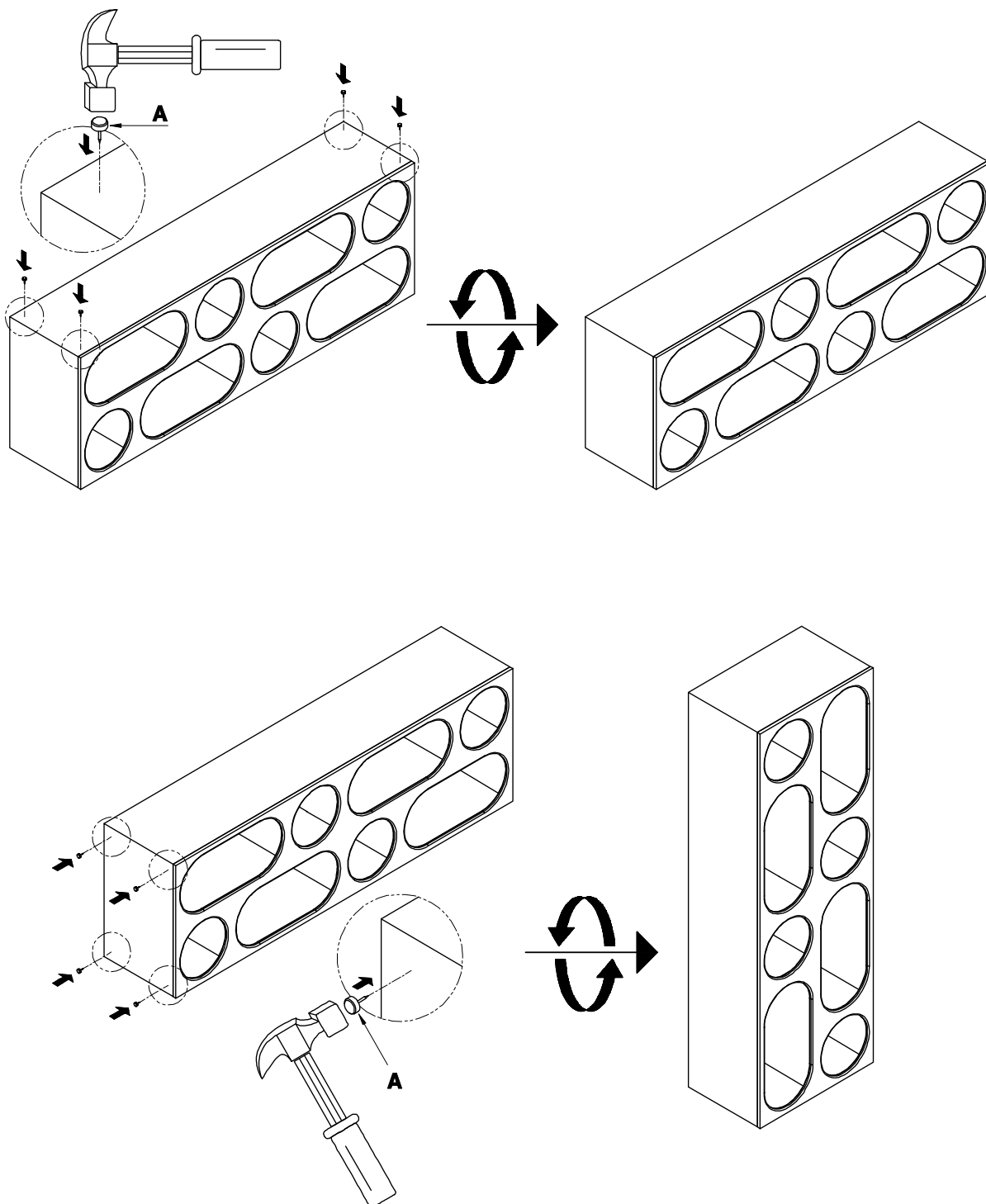

### STEP 2

- Align the Anti Tip Brackets (E) to the Top back of the Case. Insert Screws (F) and tighten completely. Do not over-tighten.
- Contact your local hardware store to purchase the correct anchors for your wall-type.
- Align the bracket to the wall and make sure they line up with the brackets on the back of the case from step (a).
- Screw the bracket to the wall using the correct anchors.
- Slide the case to the wall leaving a little bit of room between the case and the wall.
- Feed the Nylon Strap through both brackets as shown and pull tight.

### NOTE:

Anti-tip hardware should be installed in either console orientation to prevent tipping hazard

