

ARLO BOOKSHELF

Assembly Instructions

URBAN OUTFITTERS

TOOL REQUIRED – ALLEN KEY

Do not throw away packing materials and carton until after assembly. Assemble all parts on a clean smooth surface

CARE INSTRUCTIONS:

Avoid direct exposure to sunlight. Do not place over heat or Air conditioning vents. Adjust levelers so that the furniture sits flat on uneven floors.

Blot spills do not rub, with a clean white cloth. Do not use harsh chemicals.

Before cleaning any part test a small spot in a hidden area. You may need to re-tighten all bolts after initial use.

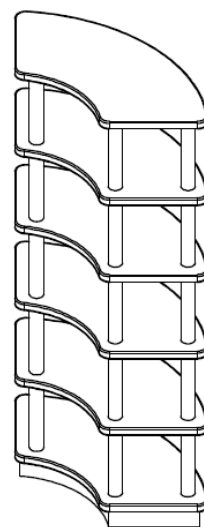

Parts:

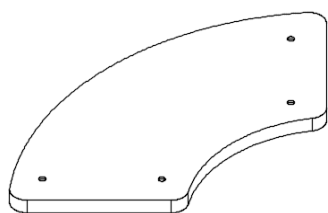

(A) Top 1x
(Wrapped in green tape)

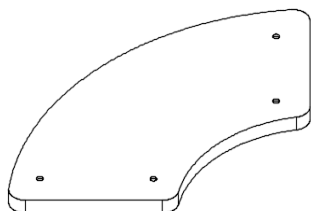

(B) Shelves 4x

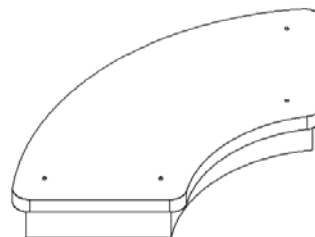

(C) Bottom 1x



(D) Top Leg 4x
(Wrapped in green tape)



(E) Leg 16x



(F) Washer 4x

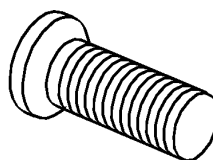

(G) Allen Bolt 4x
M6x45

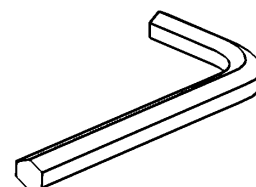

(H) Allen Key 1x
M4

ARLO BOOKSHELF

Assembly Instructions

URBAN OUTFITTERS

1. Lay the Top Shelf (A) (the one with insert nuts in the bottom) upside down onto a clean smooth surface such as carpet or cardboard. Align Top Legs (D) and turn clockwise to tighten. Repeat the same step for next 4 Shelves (B) and Leg (E) as shown in below sketch one by one. Align Bottom Shelf (C), Insert Allen Bolts (G) with Washer (F) through bottom shelf into legs then tighten with Allen Key (H).

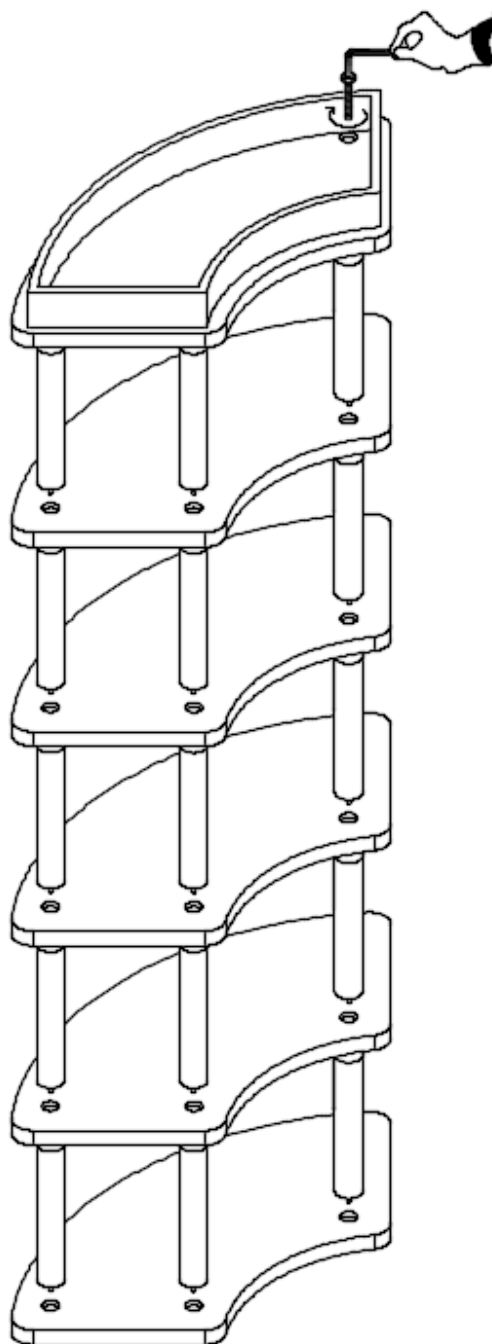
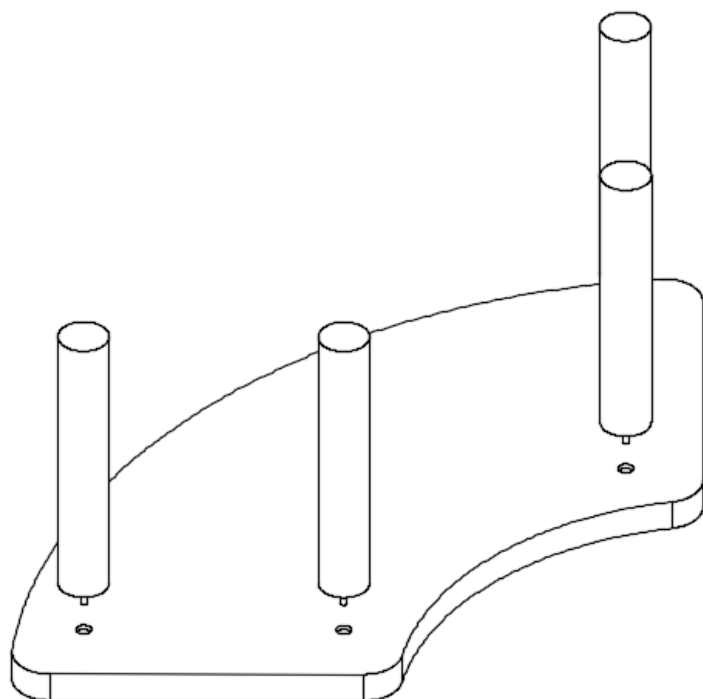

2. With help stand the Bookshelf upright.

ARLO BOOKSHELF

Assembly Instructions

URBAN OUTFITTERS

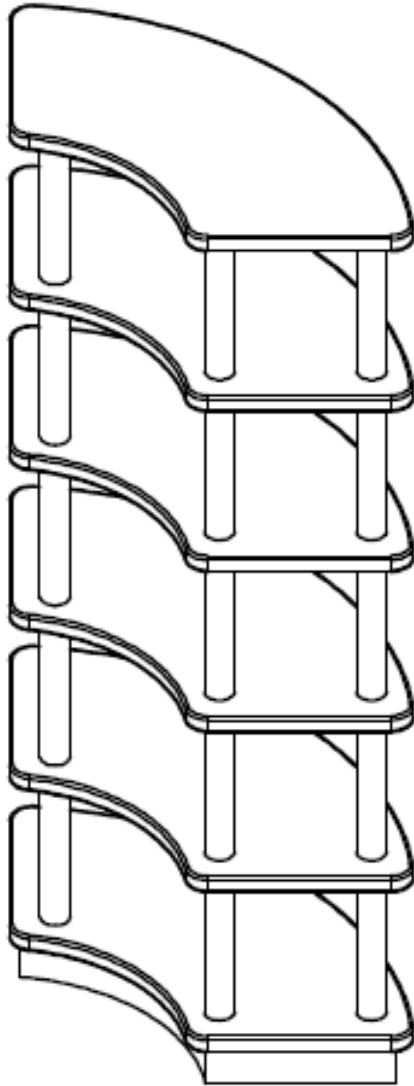

ARLO BOOKSHELF

Assembly Instructions

URBAN OUTFITTERS

