

Mason Mirror Cabinet

Assembly Instructions

URBAN OUTFITTERS

TOOLS REQUIRED BUT NOT INCLUDED:

Phillips head screwdriver driver, Pencil, Level

WARNINGS:

Do not throw away packing materials and carton until after assembly.

Ensure all parts are present prior to assembly.

Contact customer service immediately if parts are missing.

Assemble all parts on a clean smooth surface.

CARE INSTRUCTIONS:

Avoid direct exposure to sunlight.

Do not place over heat or air conditioning vents.

Adjust levelers so that the furniture sits flat on uneven floors.

Blot spills with a clean white cloth, do not rub.

Do not use harsh chemicals.

Before cleaning any part test a small spot in a hidden area.

You may need to re-tighten all bolts after initial use.

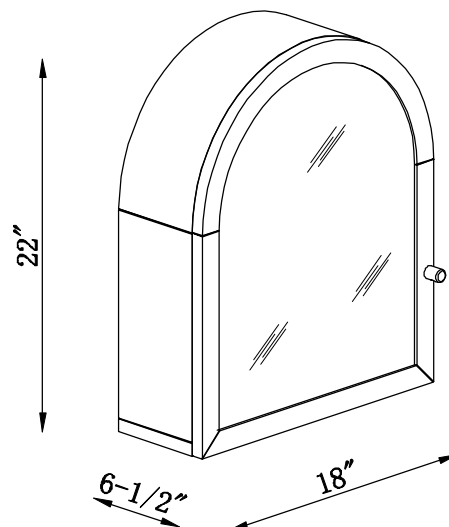

PARTS INCLUDED:

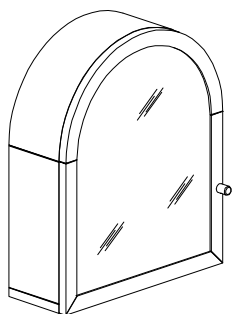

(A) Cabinet
x1

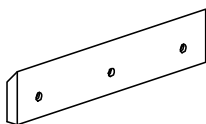

(B) Cleat
x1



(C) Wall Anchor
x3



(D) Machine Screw
x3

Mason Mirror Cabinet

Assembly Instructions

URBAN OUTFITTERS

STEP 1

Determine the position of the cabinet (A) on the wall. Use the below diagram to place the cleat (B) on the wall accordingly. Ensure the cleat (B) is level.

Wood or Stud installation:

Insert the screws (D) through the cleat (B) into the wall. Tighten the screws (D) with a Phillips head screwdriver, one at a time. Do not over-tighten.

Drywall installation:

Use a pencil to mark the position of the holes in the cleat on the wall. Insert anchors (C) into the wall at the marked locations with a Phillips head screwdriver and a hammer (not included). Place the cleat (B) on the wall aligning the holes in the cleat with the anchors (C) in the wall. Insert screws (D) through cleat (B) and into the anchors (C), then tighten with a Phillips head screwdriver, one at a time. Do not over-tighten.

The included hardware is intended for attachment to drywall or wooden studs within walls, contact your local hardware store to find the correct anchor for alternative wall-types such as stone or brick.

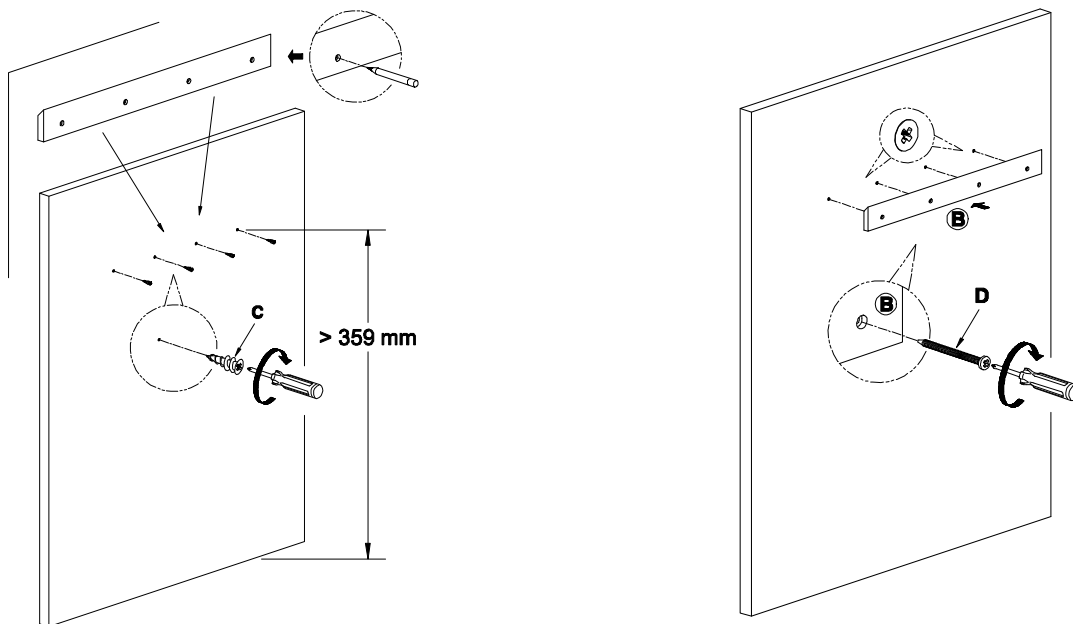

STEP 2

With help, hang the cabinet (A) onto the cleat (B).

