

MARGOT HALF CIRCLE MIRROR

URBAN OUTFITTERS

Assembly Instructions

TOOLS REQUIRED BUT NOT INCLUDED:

Screwdriver, Drill, Hammer, Level, Pencil

WARNINGS:

Do not throw away packing materials and carton until after assembly.
Assemble all parts on a clean smooth surface

CARE INSTRUCTIONS:

Avoid direct exposure to sunlight. Do not place overheat or air conditioning vents. Adjust levelers so that the furniture sits flat on uneven floors. Blot spills do not rub, with a clean white cloth.
Do not use harsh chemicals.
Before cleaning any part test a small spot in a hidden area.
You may need to re-tighten all bolts after initial use.



PARTS INCLUDED:



A) Half Circle Mirror

[15.9 x 1 x H 9.8"] x1

or

[40.5 x 2.5 x H25 cm] x1

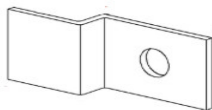

B) Z hook

[0.4 x 0.98 x 0.16"] x2

or

[1 x 2.5 x 0.4 cm] x2



C) Screw

[D 0.35 / 0.19 x 2.32"] x2

or

[D 8.9/4.8 x 59 mm] x2



D) Plastic Anchor

[D 0.35 " x 1.4" Bolt] x2

or

[D 9 x 36 mm] x2

MARGOT HALF CIRCLE MIRROR

Assembly Instructions

URBAN OUTFITTERS

STEP 1:

Place the Half-circle mirror (A) on the wall in its desired location. Ensure the Half-circle mirror (A) is level and mark the location of the mounting hooks in the rack on the wall. Pre-drill holes for the plastic anchors (D) at the marked hole locations using a drill and use a hammer to tap them into the wall.



STEP 2:

Place the Z-hooks (B) over the plastic anchors (D) and insert screws (B) as shown. Tighten with a Phillips head screw driver.

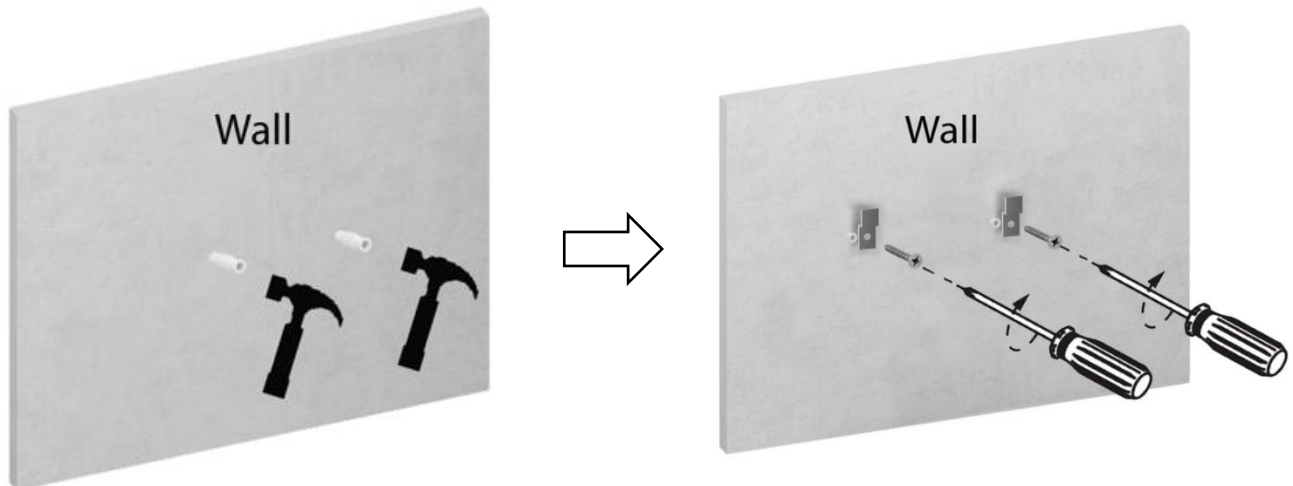

MARGOT HALF CIRCLE MIRROR

Assembly Instructions

URBAN OUTFITTERS

STEP 3:

Hang the mirror on the Z hooks to complete the installation.

