

Eloise Toilet Paper Shelf

Assembly Instructions

URBAN OUTFITTERS

TOOLS REQUIRED BUT NOT INCLUDED:

Drill, Phillips head screwdriver, Hammer, Pencil

WARNINGS:

Do not throw away packing materials and carton until after assembly.
Ensure all parts are present prior to assembly.
Contact customer service immediately if parts are missing.
Assemble all parts on a clean smooth surface.

CARE INSTRUCTIONS:

Avoid direct exposure to sunlight.
Do not place over heat or air conditioning vents.
Adjust levelers so that the furniture sits flat on uneven floors.
Blot spills with a clean white cloth, do not rub.
Do not use harsh chemicals.
Before cleaning any part test a small spot in a hidden area.
You may need to re-tighten all bolts after initial use.

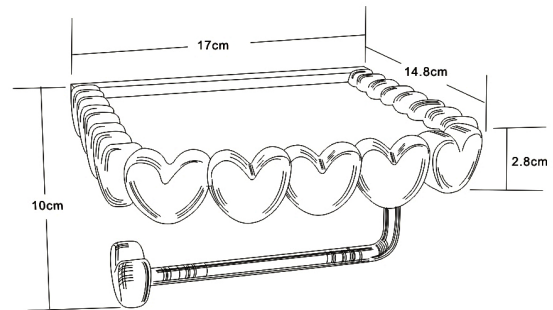

PARTS INCLUDED:

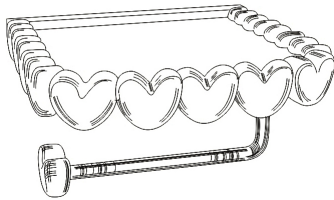

(A) Shelf
[6.69" x 5.83" x 3.93"]
or
[17 x 14.8 x 10 cm]



(B) Plastic Anchor
[D0.35 " x 1.38 "] x2
or
[D9 x 35 mm] x2



(C) Screw
[D0.27 " x 1.38 "] x2
or
[D7 x 35 mm] x2

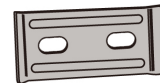

(D) Metal Hardware
[D2.08 " x 0.86"] x2
or
[L53 x W22 mm] x2

Eloise Toilet Paper Shelf

Assembly Instructions

URBAN OUTFITTERS

STEP 1

Place the Shelf (A) on the wall in a chosen location. Ensure the Shelf (A) is level and mark the corresponding locations for the metal hardware (D). Use the dimensions in the below diagram as reference.

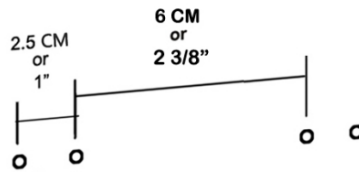

STEP 2

Wood or Stud installation:

Insert the screws (C) through the metal hardware (D) then, use a Phillips head screwdriver to fasten the metal hardware (D) tightly to the wall at the marked locations. Ensure the metal hardware is aligned and level.

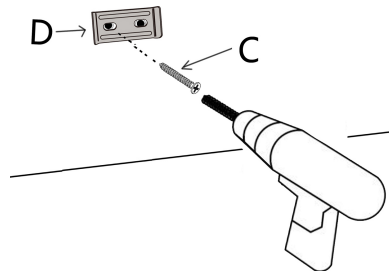

Drywall installation:

Insert anchors (B) into the wall at the marked locations using a drill and a hammer as shown. Insert the screws (C) through the metal hardware (D) and into the anchors (B) then, use a Phillips head screwdriver to fasten the metal hardware (D) tightly to the wall. Ensure the metal hardware is aligned and level.

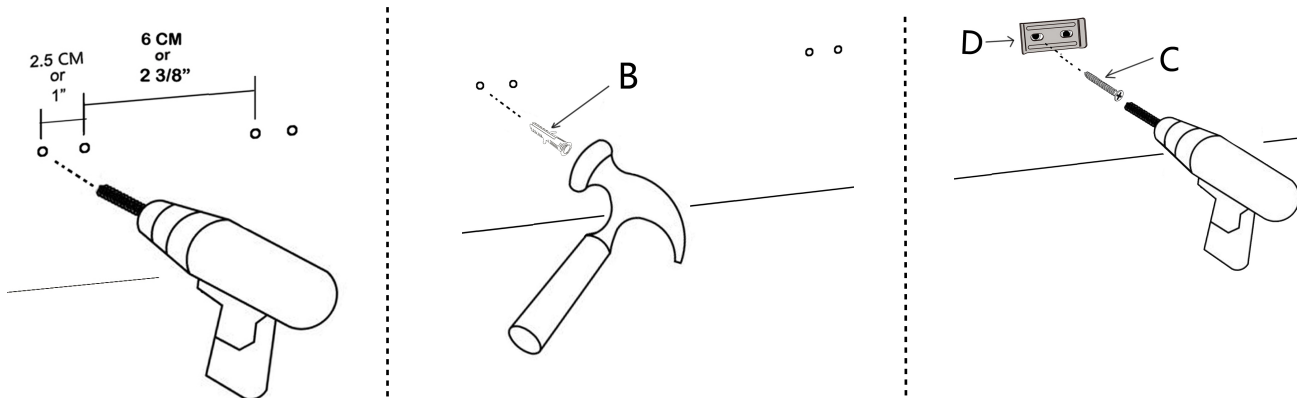

STEP 3

Gently hang the shelf (A) on the metal hardware (D). If the shelf (A) slopes downward, tighten the screws (C).

