

LUCIE CORNER SHELF

Assembly Instructions

URBAN OUTFITTERS

TOOLS REQUIRED BUT NOT INCLUDED

Hammer, Phillips head screwdriver, Level, Pencil

WARNINGS:

At least two people recommended for assembly
Do not throw away packing materials and carton until after assembly.
Ensure all parts are present prior to assembly.
Contact customer service immediately if parts are missing.
Assemble all parts on a clean smooth surface

CARE INSTRUCTIONS:

Avoid direct exposure to sunlight.
Do not place overheat or air conditioning vents.
Adjust levelers so that the furniture sits flat on uneven floors.
Blot spills with a clean white cloth, do not rub.
Do not use harsh chemicals.
Before cleaning any part test a small spot in a hidden area.
You may need to re-tighten all bolts after initial use.

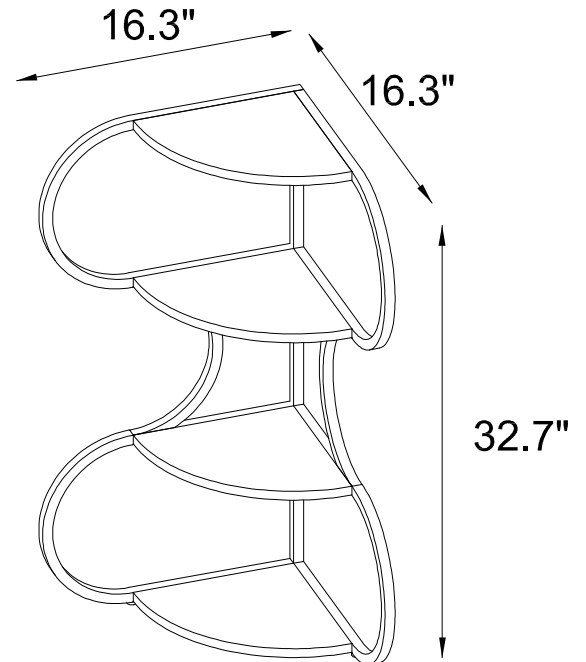

PARTS INCLUDED:

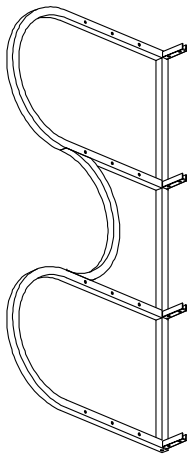

A) Metal Left Frame

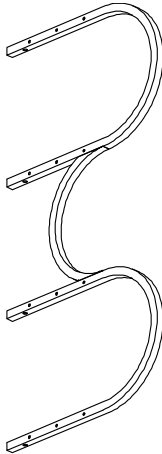

B) Metal Right Frame

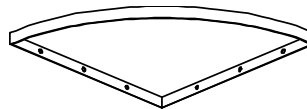

C) Metal Shelf x 4

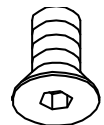

D) Bolt [M5xL10mm]
x 20



E) Drywall Anchor x8



F) Wall Screw [4x32] x8



G) Allen Key (3mm)

STEP 1

Lay down all the parts on the clean carpet or cardboard for assembly. Align metal left frame (A) with metal right frame (B). Insert bolts (D), and partially tighten with Allen key (G). Once all bolts are inserted and partially tightened, fully tighten the bolts.

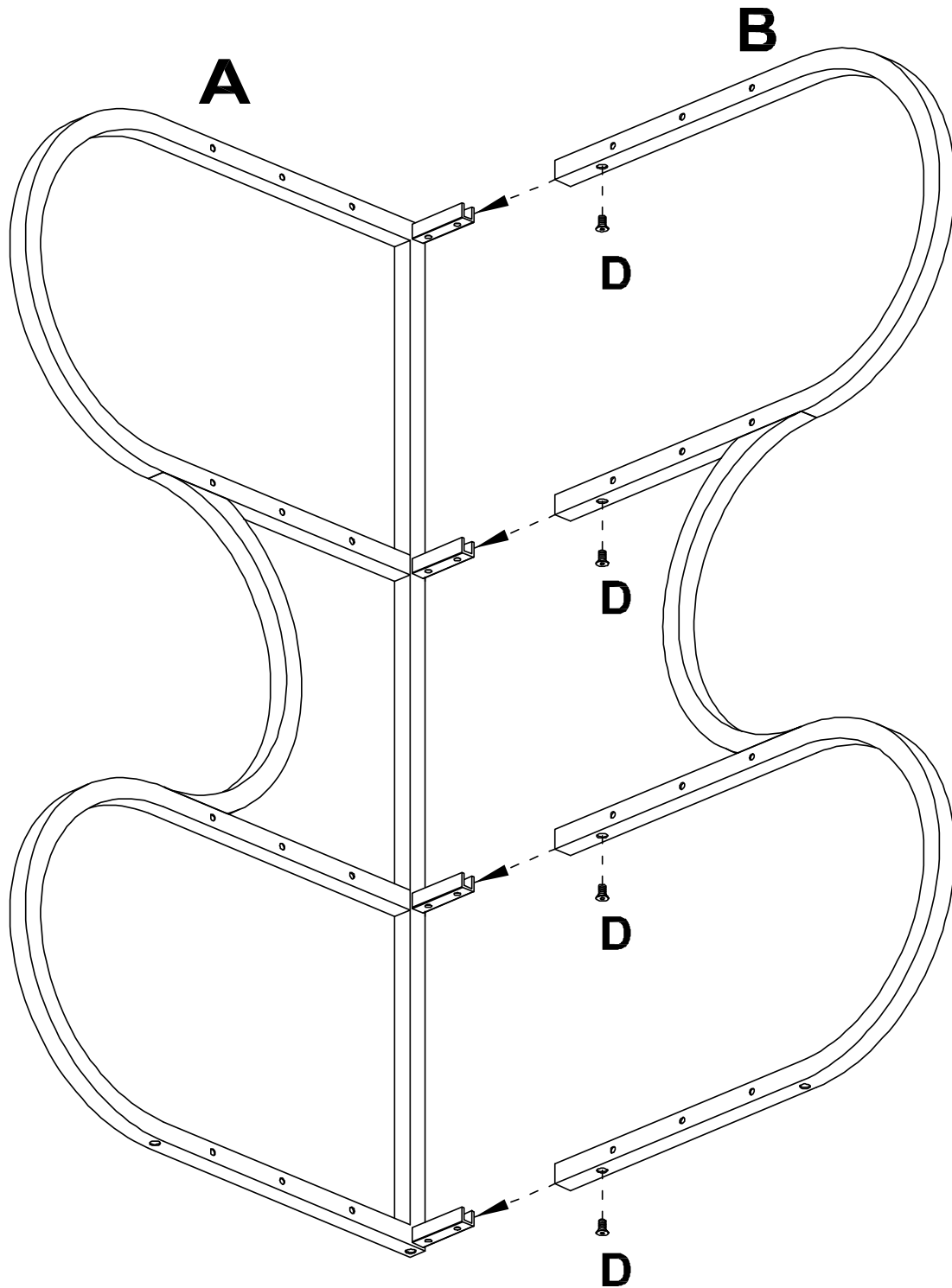

STEP 2

Insert metal shelf (C) with assemble metal frame. Insert bolts (D) on each shelf, and partially tighten with Allen key (G). Once all bolts are inserted and partially tightened, fully tighten the bolts. .

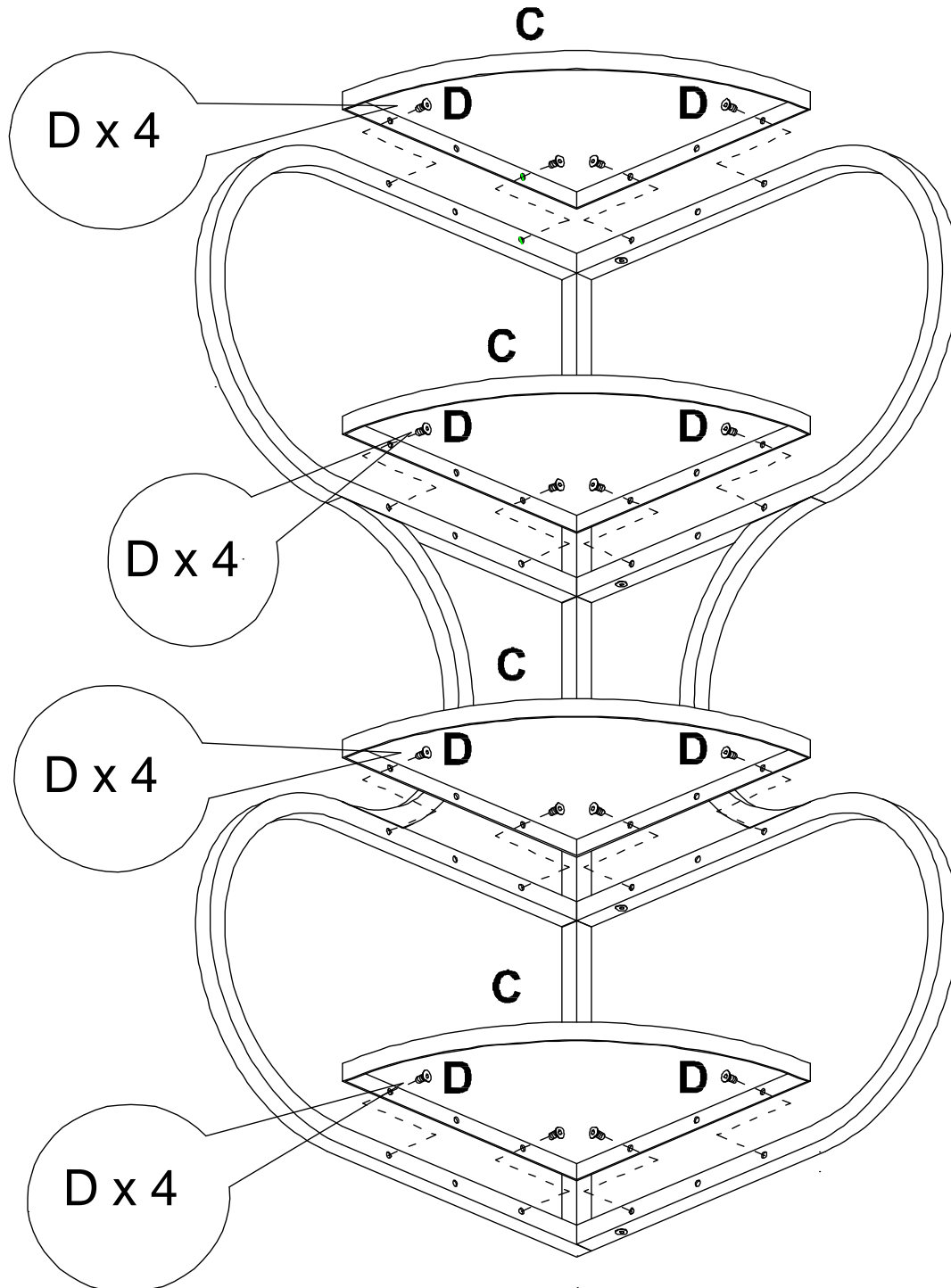

STEP 3

Place the shelf on the wall in a preferred location. Ensure the Shelf (A) is level and mark the location for the screw holes on the wall.

Wood or Stud installation:

Insert the screws (F) through the specified holes in the shelf. Use a Phillips head screwdriver to fasten the screws (C) directly into the wall at the marked locations.

Drywall installation:

Insert anchors (E) into the wall at the marked locations using a drill and a hammer (not included). Insert screws (F) through the specified holes in the shelf and into the anchors, then tighten with a phillips head screwdriver (not included).

The included hardware is intended for attachment to drywall or wooden wall surfaces, contact your local hardware store to find the correct anchor for alternative wall-types such as stone or brick.

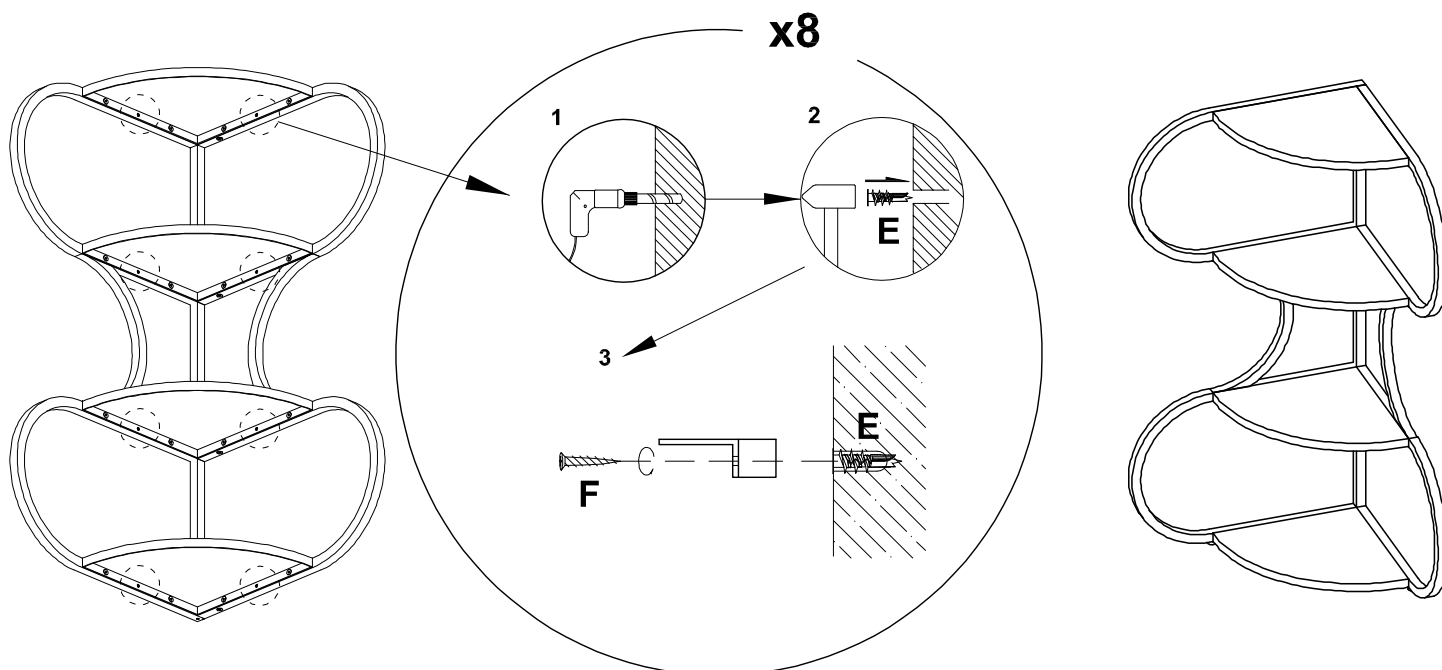

Warning: Young children may be injured by tipping furniture and the use of a tipping restraint is highly recommended. The tipping restraint is only a deterrent it is not a substitute for proper adult supervision.