

Stacie Wall Shelf

URBAN OUTFITTERS

Assembly Instructions

TOOLS REQUIRED BUT NOT INCLUDED:
Phillips head screwdriver driver, Pencil, Level

WARNINGS:

Do not throw away packing materials and carton until after assembly.
Ensure all parts are present prior to assembly.
Contact customer service immediately if parts are missing.
Assemble all parts on a clean smooth surface.

CARE INSTRUCTIONS:

Avoid direct exposure to sunlight.
Do not place over heat or air conditioning vents.
Adjust levelers so that the furniture sits flat on uneven floors.
Blot spills with a clean white cloth, do not rub.
Do not use harsh chemicals.
Before cleaning any part test a small spot in a hidden area.
You may need to re-tighten all bolts after initial use.

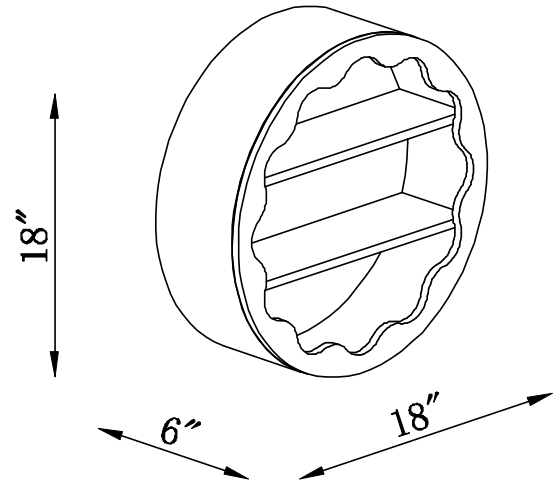

PARTS INCLUDED:

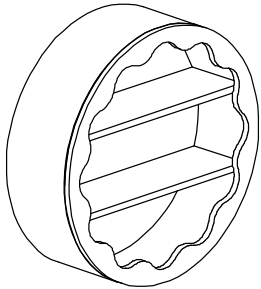

(A) Shelf
x1

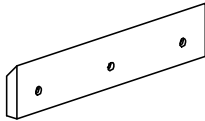

(B) Cleat
x1



(C) Wall Anchor
x3



(D) Machine Screw
x3

Stacie Wall Shelf

Assembly Instructions

URBAN OUTFITTERS

STEP 1

Determine the position of the shelf (A) on the wall. Use the below diagram to place the cleat (B) on the wall accordingly. Ensure the cleat (B) is level and use a pencil to mark the location of the screw holes on the wall.

Wood or Stud installation:

Place the cleat (B) on the wall aligning the holes in the cleat with the marks on the wall. Insert the screws (D) through the cleat (B) into the wall. Tighten the screws (D) with a Phillips head screwdriver, one at a time. Do not over-tighten.

Drywall installation:

Insert anchors (C) into the wall at the marked locations. Place the cleat (B) on the wall aligning the holes in the cleat with the anchors (C) in the wall. Insert screws (D) through cleat (B) and into the anchors (C), then tighten with a Phillips head screwdriver, one at a time. Do not over-tighten.

The included hardware is intended for attachment to drywall or wooden studs within walls, contact your local hardware store to find the correct anchor for alternative wall-types such as stone or brick.

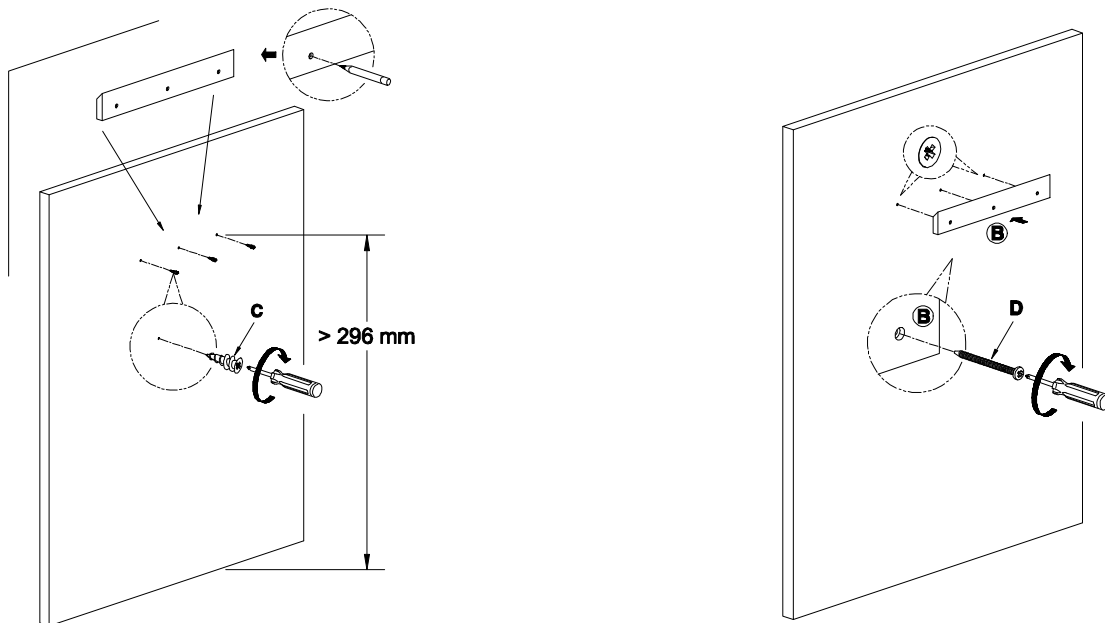

STEP 2

With help, hang the shelf (A) onto the cleat (B).

