

TOOLS REQUIRED BUT NOT INCLUDED:

N/A

WARNINGS:

Do not throw away packing materials and carton until after assembly. Assemble all parts on a clean smooth surface

CARE INSTRUCTIONS:

Avoid direct exposure to sunlight. Do not place overheat or air conditioning vents. Adjust levelers so that the furniture sits flat on uneven floors.

Blot spills do not rub, with a clean white cloth.

Do not use harsh chemicals.

Before cleaning any part test a small spot in a hidden area.

You may need to re-tighten all bolts after initial use.

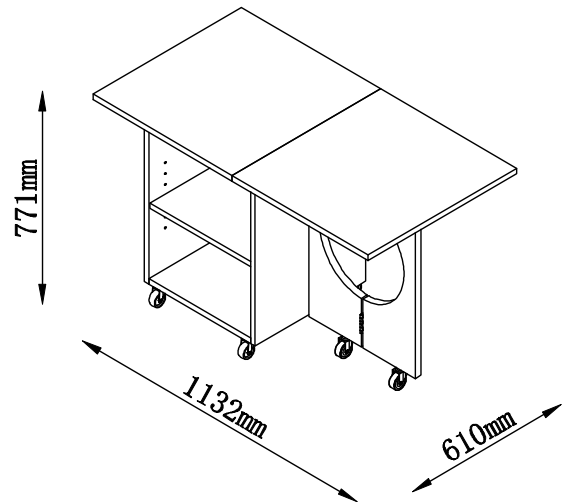

PARTS INCLUDED

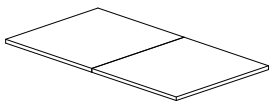

(A) Top Panel
x1



(B) Side Panel
x1

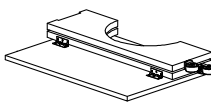

(C) Side Panel
x1

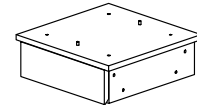

(D) Drawer Box
x1

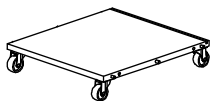

(E) Bottom Panel
x1

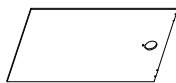

(F) Back Panel
x1

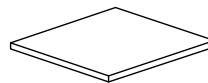

(G) Shelf
x1

HARDWARE LIST



(H) Hex key
x 1

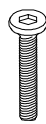

(I) Bolt
[M6 x 28mm] x12



(J) Spring washer
[M6] x12



(K) Flat washer
[M6] x12



(L) Cam bolt
x4



(N) Cam lock
x4



(O) Grub screw
x4



(P) Shelf pin
x4



(M) Screw
[3,5 x 12mm] x4

STEP 1

With help lay the parts out onto a clean smooth surface such as carpet or cardboard. Remove the drawer from the Drawer Box (D).

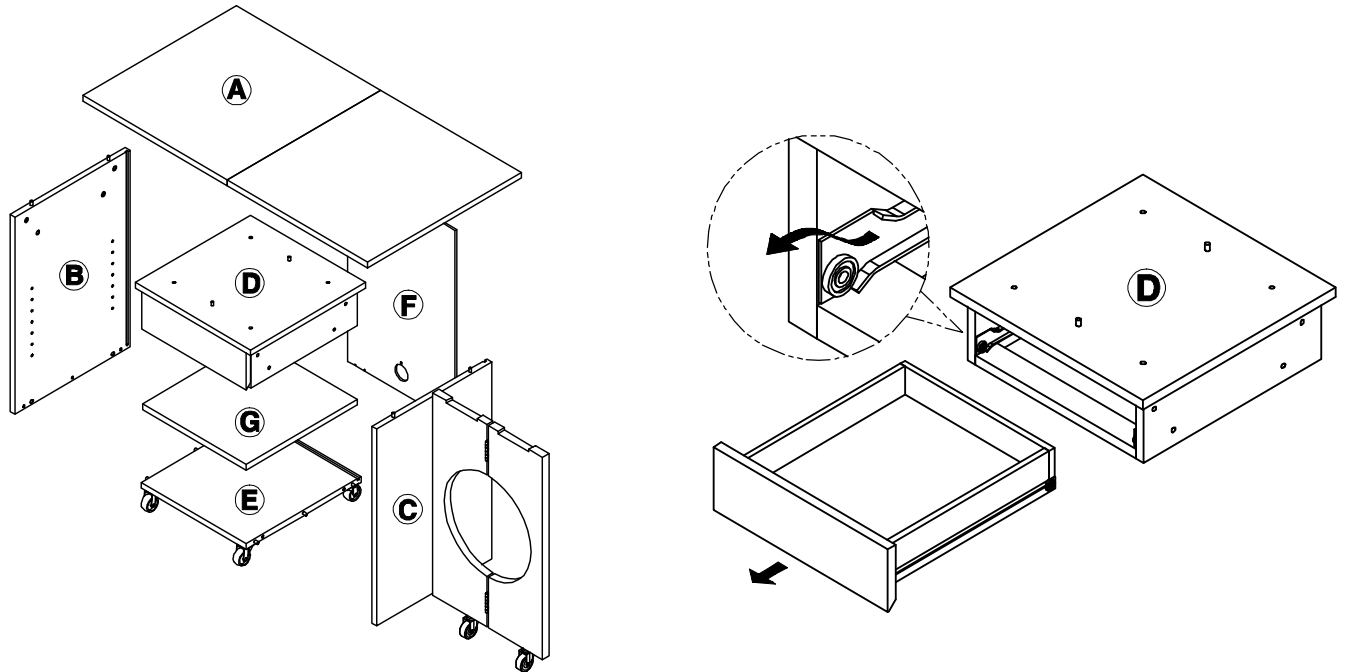

STEP 2

Insert the Cam Bolts (L) to the Side Panels (B&C) as shown and tighten with a Phillips head screwdriver (not included). Do not over tighten. Align the Bottom Panel (E) to the Side Panel (B) and insert Cam Lock (M) as shown. Press the Bottom Panel firmly into place. Insert Grub Screw (N) and tighten with the supplied Hex Key (H).

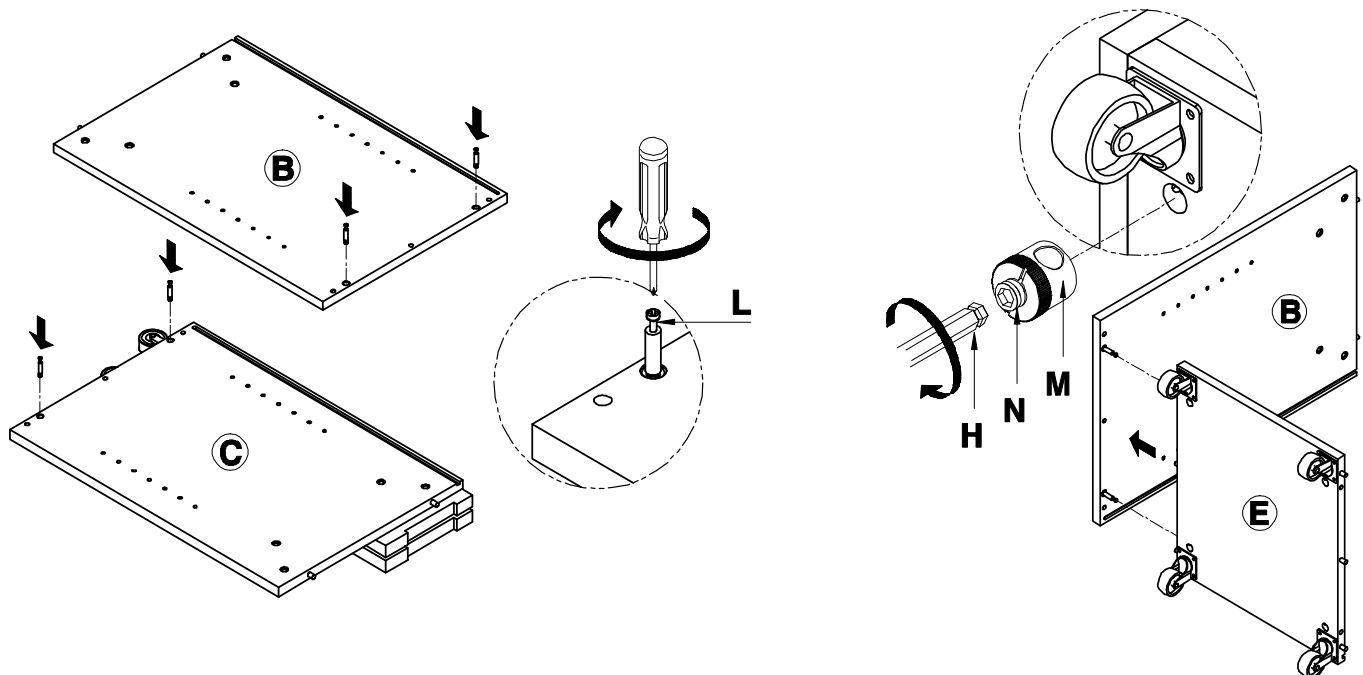

STEP 3

Slide the Back Panel (F) into the partially assembled desk as shown. Repeat step (2) to attach Side Panel (C).

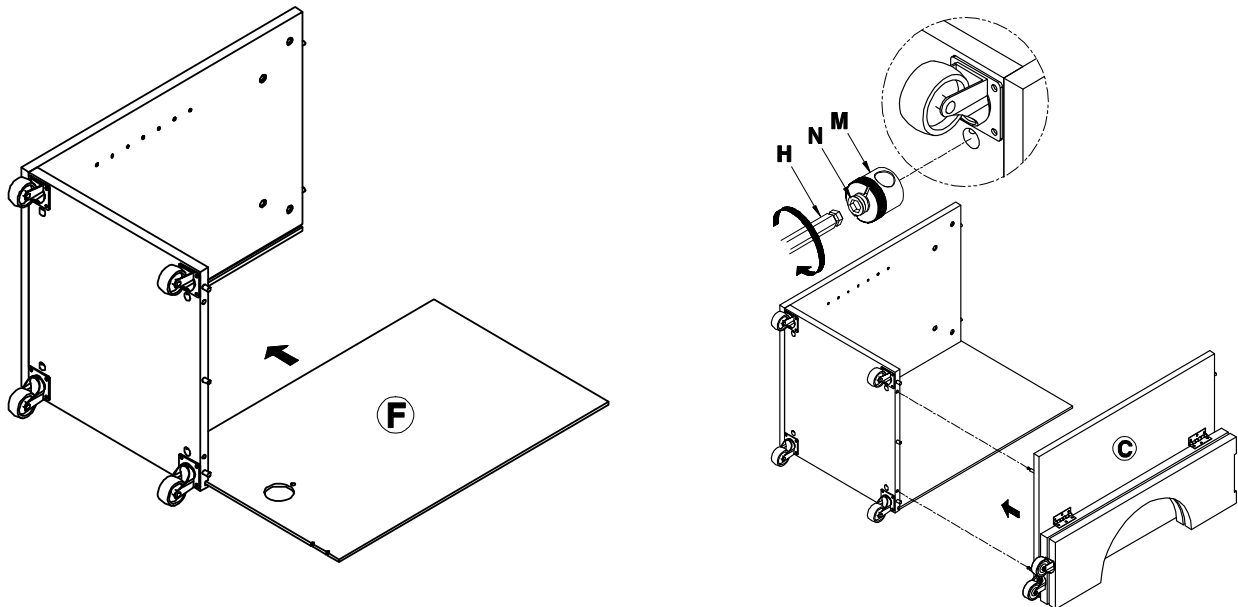

STEP 4

Place the Drawer Box (D) onto the Side Panels (B&C) and press firmly into place. Insert Flat Washer (K), Spring Washer (J) and Bolt (I) as shown. Tighten with supplied Hex Key (H). With help, stand the case upright and open the flip panel as shown.

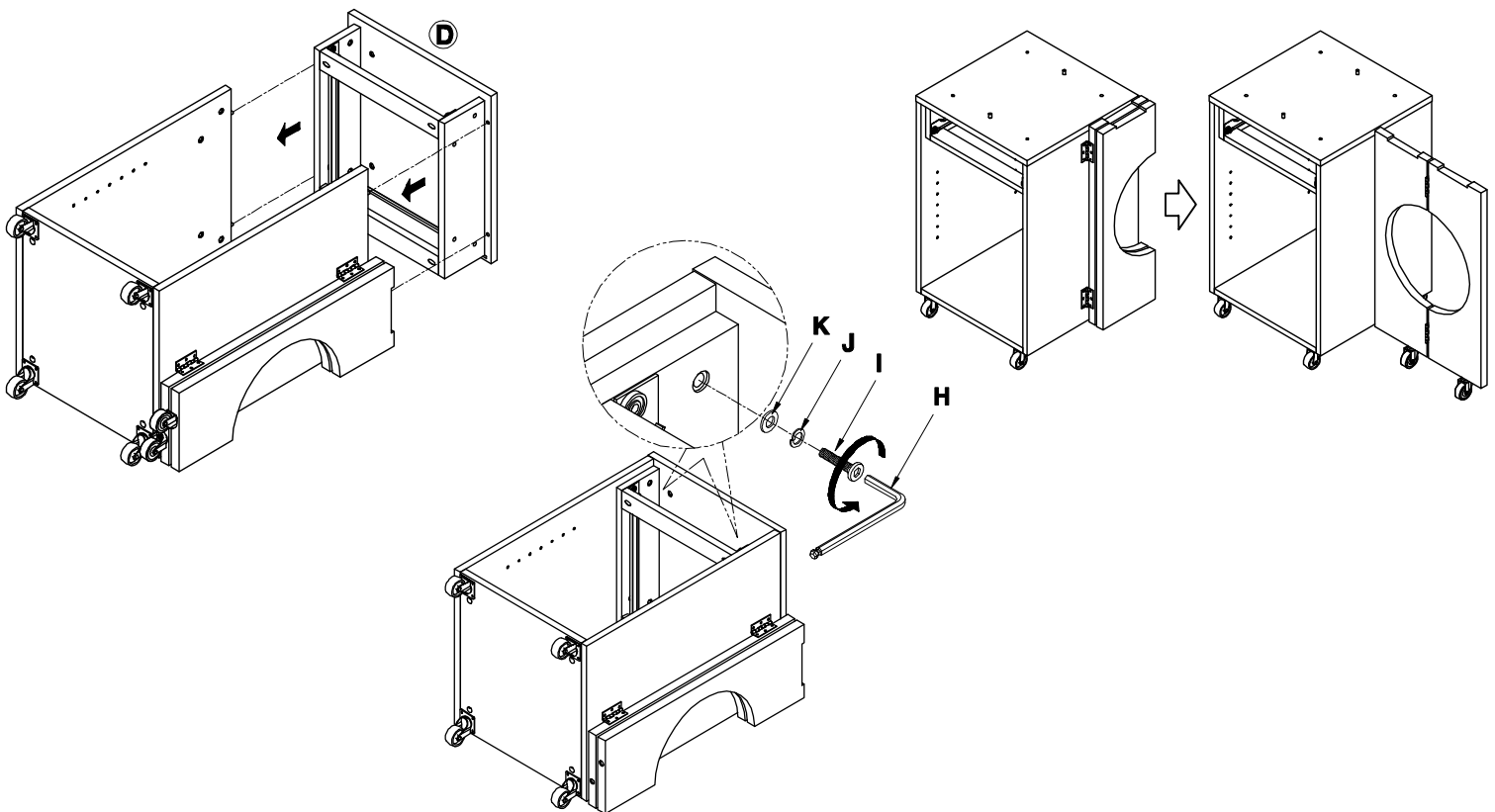

STEP 5

Place the Top Panel (A) onto the case as shown. Insert the Flat Washer (K), Spring Washer (J) and Bolt (I). Tighten with supplied Hex Key (H). Do not over-tighten. Use the cleats attached to the bottom of the Top Panel (A) to lock the flip panel into place.

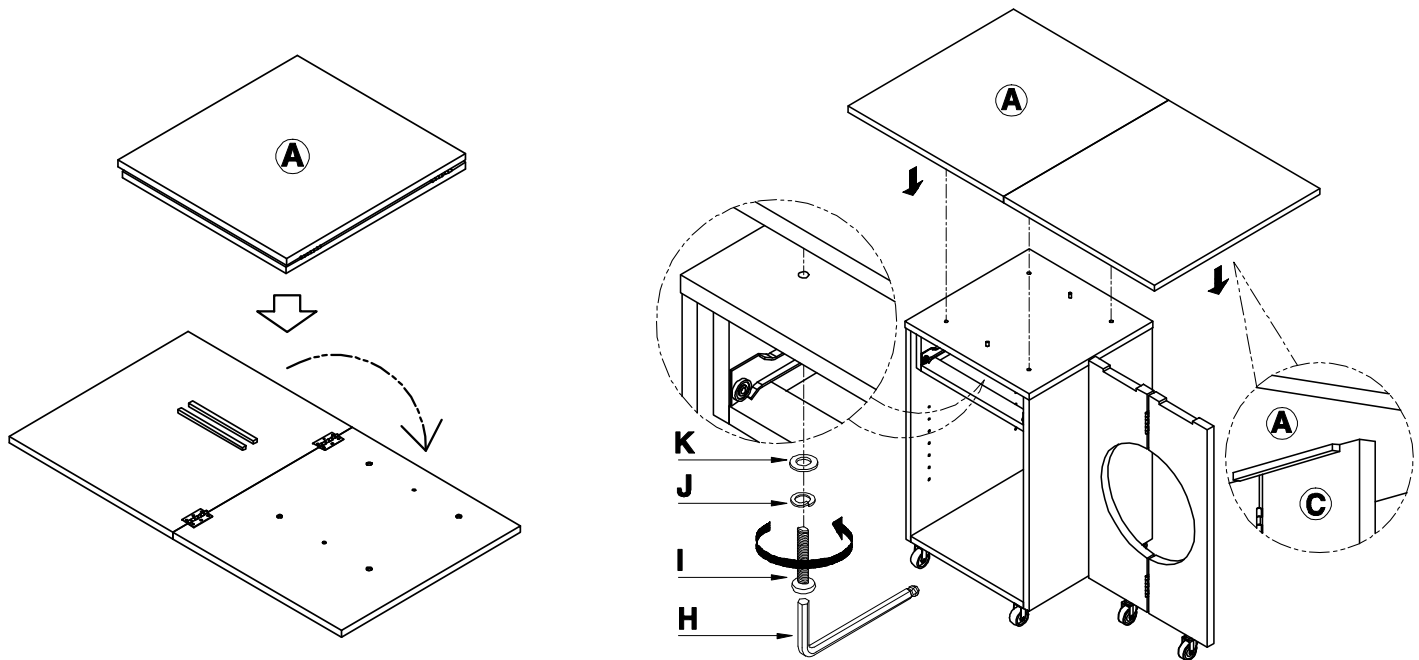

STEP 6

Insert the Shelf Pins (O) into the Side Panels (B&C) and press firmly into place. Place the shelf (G) onto the shelf pins. Use the screws (P) as shown to fix the shelf in place if desired.

