

CELESTE MIRROR

Assembly Instructions

URBAN OUTFITTERS

TOOLS REQUIRED BUT NOT INCLUDED:

Phillips head screw driver

WARNINGS:

Do not throw away packing materials and carton until after assembly.

Ensure all parts are present prior to assembly.

Contact customer service immediately if parts are missing.

Assemble all parts on a clean smooth surface.

CARE INSTRUCTIONS:

Avoid direct exposure to sunlight.

Do not place over heat.

Do not use harsh chemicals.

Clean with Soft dry cloth.

Before cleaning any part test a small spot in a hidden area.

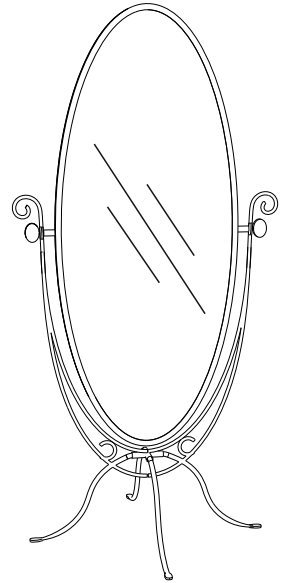

PARTS INCLUDED:

[29"L x 27"W x 57"H]

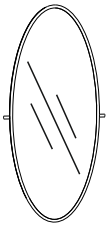

(A) Mirror



(B) Knob x2

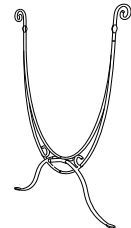

(C) Base

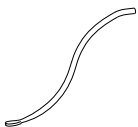

(D) Left Leg

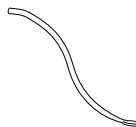

(E) Right Leg



(F) Screw
[6 x 6 x 15 mm] x4

CELESTE MIRROR

Assembly Instructions

URBAN OUTFITTERS

STEP 1

Lay the parts down on a clean surface such as carpet or cardboard. Insert the left and right legs (D & E) as shown. Insert the screws (F) as shown and tighten with a phillips head screwdriver.

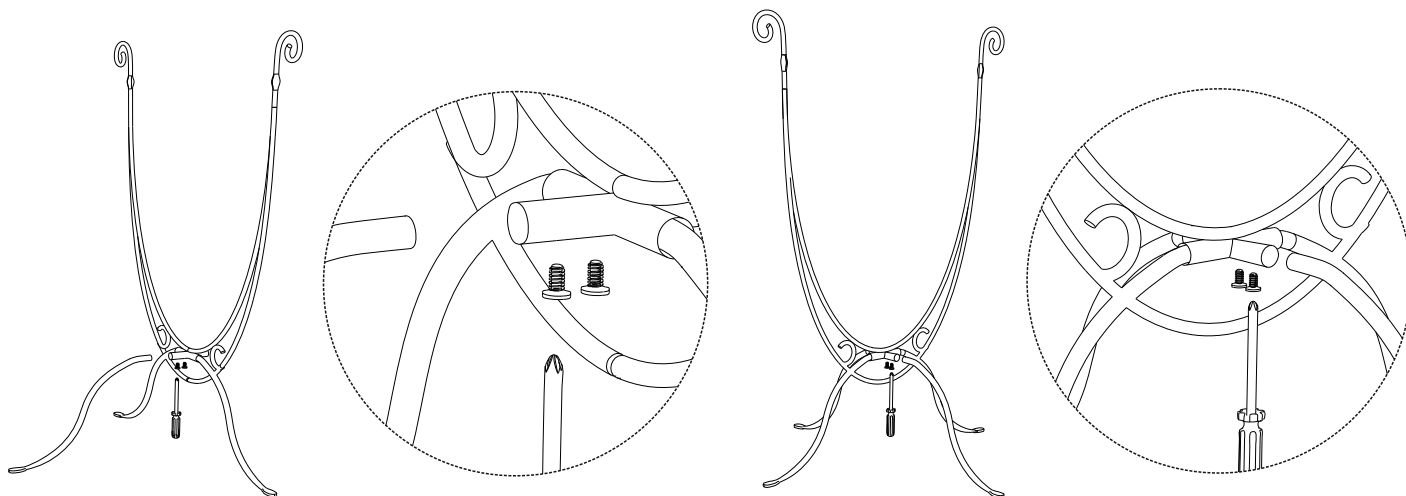

STEP 2

Hang the mirror (A) on the metal base (C) then, screw the knobs (B) through the metal base (C) into the mirror to secure it and complete assembly.

