

MABELLE QUEEN BED

URBAN OUTFITTERS

Assembly Instructions

TOOLS REQUIRED BUT NOT INCLUDED:

Phillips Head Screwdriver

Do not throw away packing materials and carton until after assembly.
Assemble all parts on a clean smooth surface

CARE INSTRUCTIONS:

Avoid direct exposure to sunlight. Do not place over heat or Air conditioning vents.
Adjust levelers so that the furniture sits flat on uneven floors.
Blot spills do not rub, with a clean white cloth.
Do not use harsh chemicals.
Before cleaning any part test a small spot in a hidden area.
You may need to re-tighten all bolts after initial use.

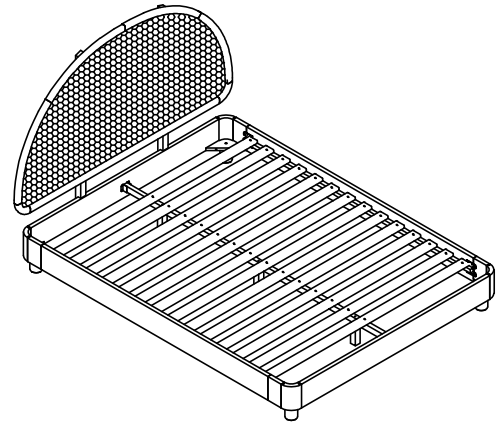

PARTS INCLUDED

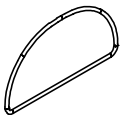

(A) Head board
Quantity: 1pc

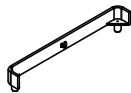

(B) Head board
Quantity: 1pc

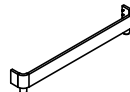

(C) Foot board
Quantity: 1pc



(D) Side rails
Quantity: 2pcs

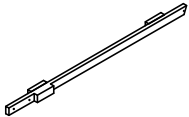

(E) Head board post
Quantity: 2pcs

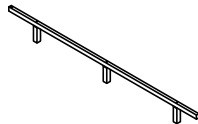

(F) Middel rail
Quantity: 1pc

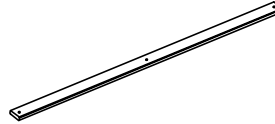

(G) Slats
Quantity: 14pcs

HARDWARE LIST



(1) Bolt
M8 x 20mm
Quantity: 8pcs



(2) Bolt
M6 x 35
Quantity: 8pcs



(3) Allen key
Quantity: 1pc

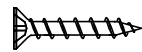

(4) Screw
M4 x 30mm
Quantity: 42pcs

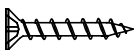

(5) Screw
M4 x 40mm
Quantity: 2pcs

MABELLE QUEEN BED

URBAN OUTFITTERS

Assembly Instructions

STEP 1. With help, align the side rails (D) to the headboard (B) and Foot board (C) as shown. Insert bolt (1) and tighten with hex key (3).

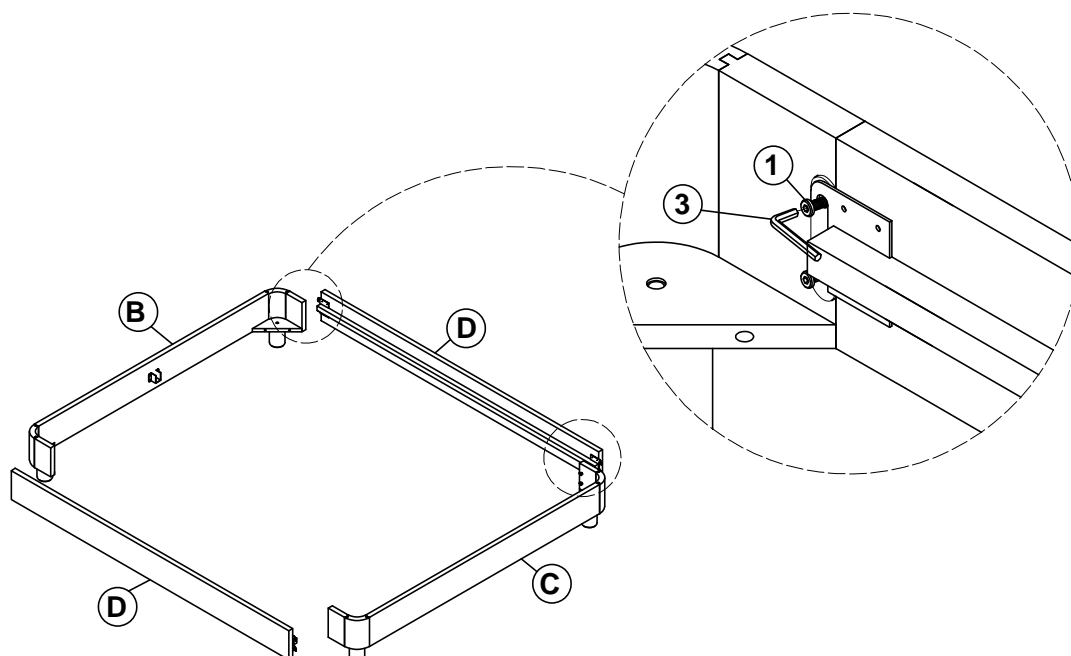

STEP 2. Align the headboard posts (E) with the back of the headboard (A). Insert bolt (2) and tighten with hex key (3).

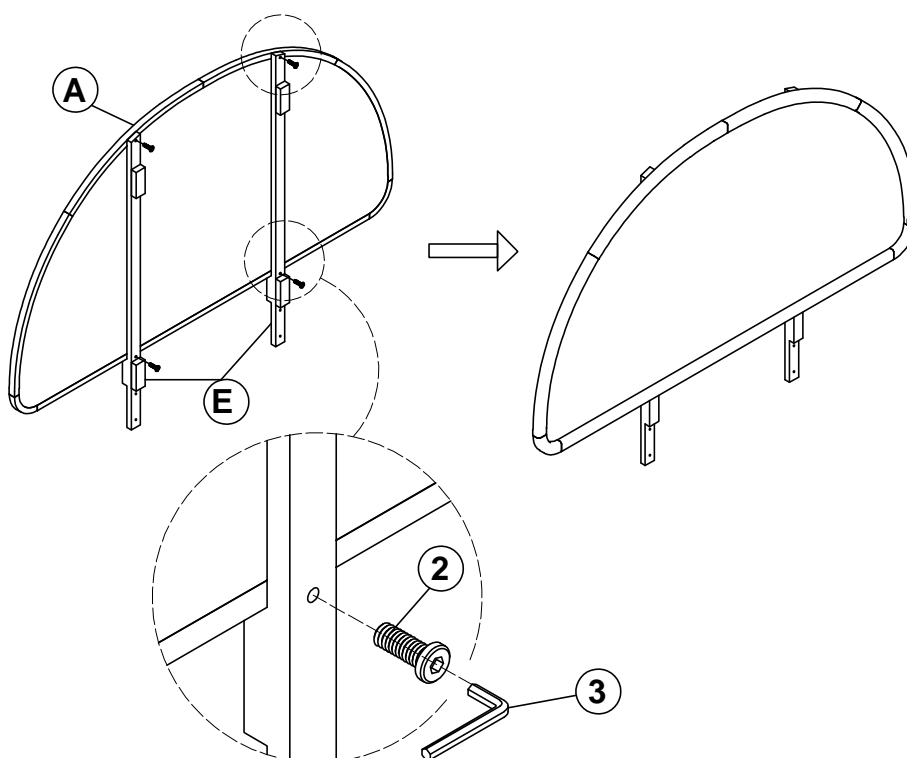

MABELLE QUEEN BED

URBAN OUTFITTERS

Assembly Instructions

STEP 3. With help align the assembled headboard to the bed frame as shown. Insert bolts (2) and tighten with hex key (3).

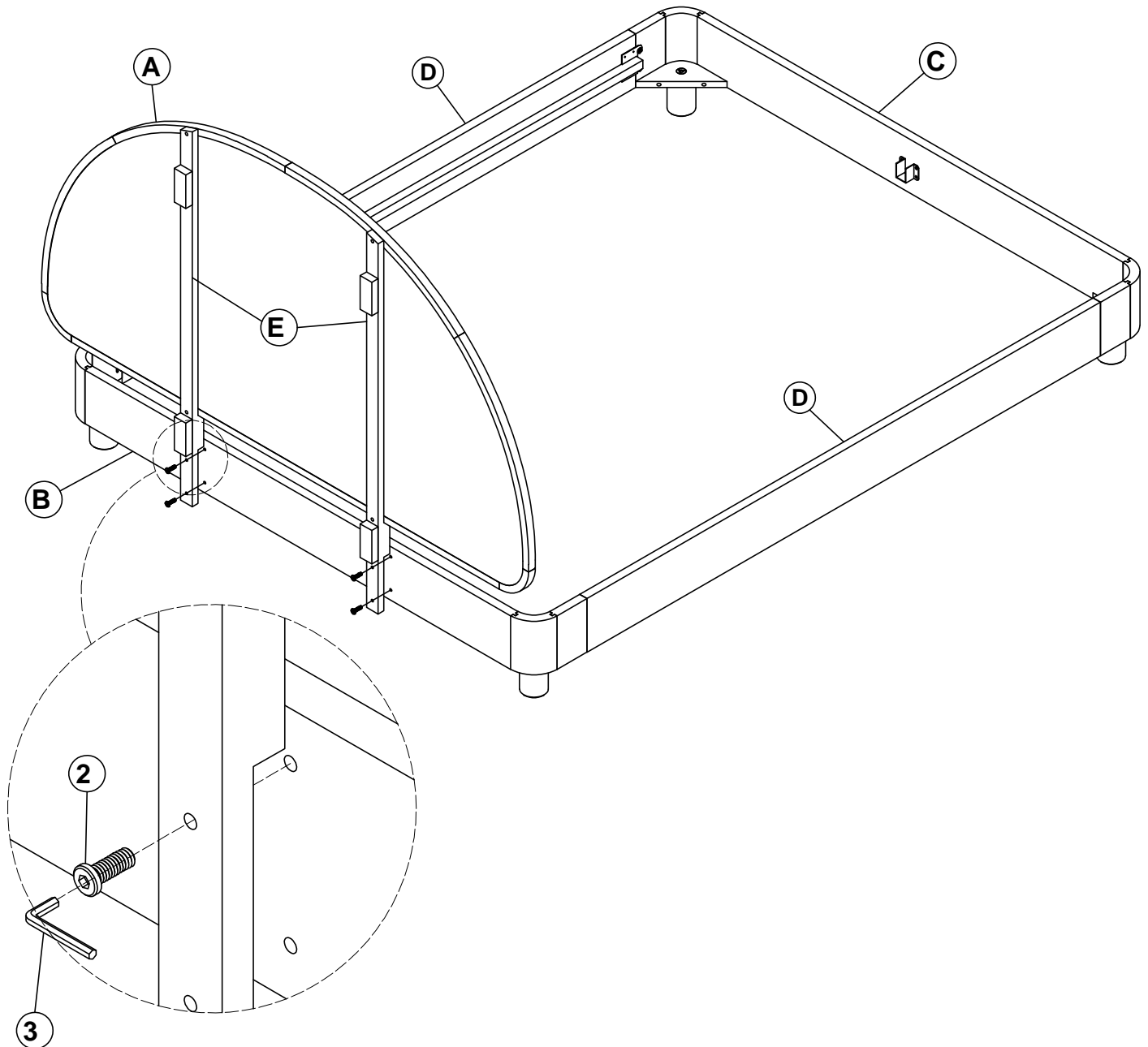

MABELLE QUEEN BED

URBAN OUTFITTERS

Assembly Instructions

STEP 4. Align the middle rail (F) as shown and press firmly into place.

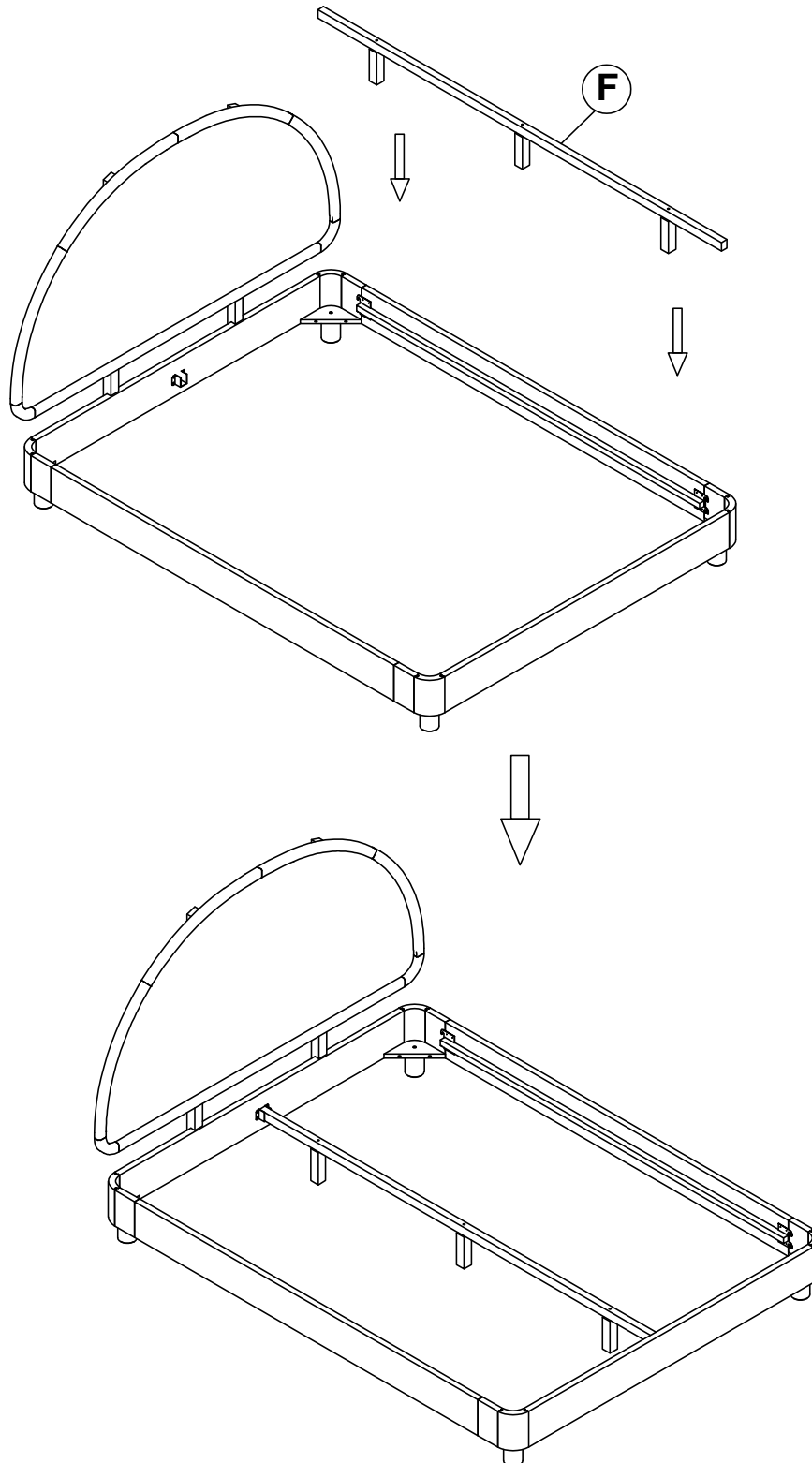

MABELLE QUEEN BED

URBAN OUTFITTERS

Assembly Instructions

STEP 5. Insert the screw (5) into the middle rail as shown. Tighten with screwdriver (not included). Do not over-tighten.

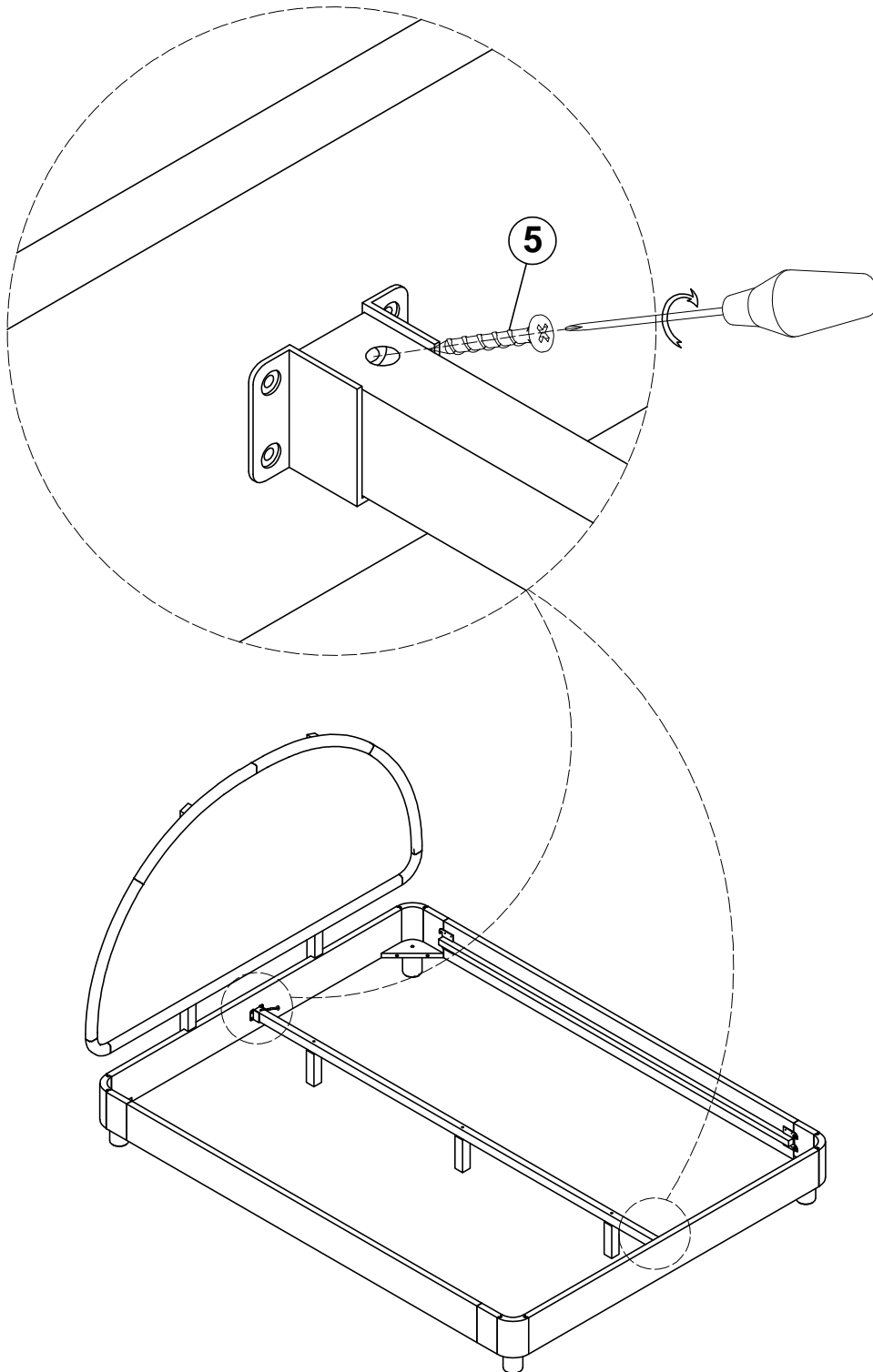

MABELLE QUEEN BED

URBAN OUTFITTERS

Assembly Instructions

STEP 6. Lay the Slats (G) into the frame.

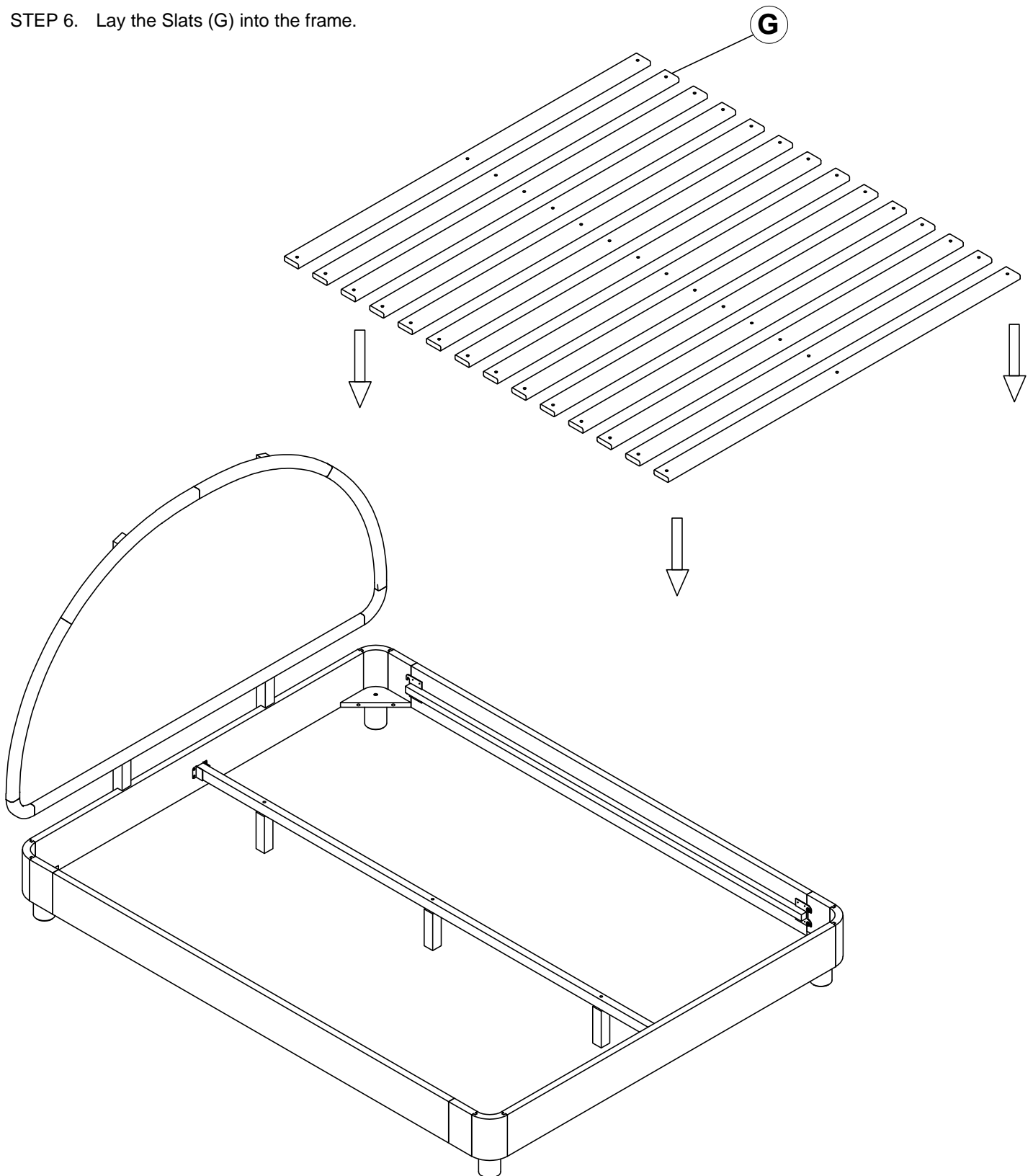

MABELLE QUEEN BED

Assembly Instructions

URBAN OUTFITTERS

STEP 7. Insert screws (4) into the slats as shown. Tighten with screwdriver (not included). Do not over-tighten.

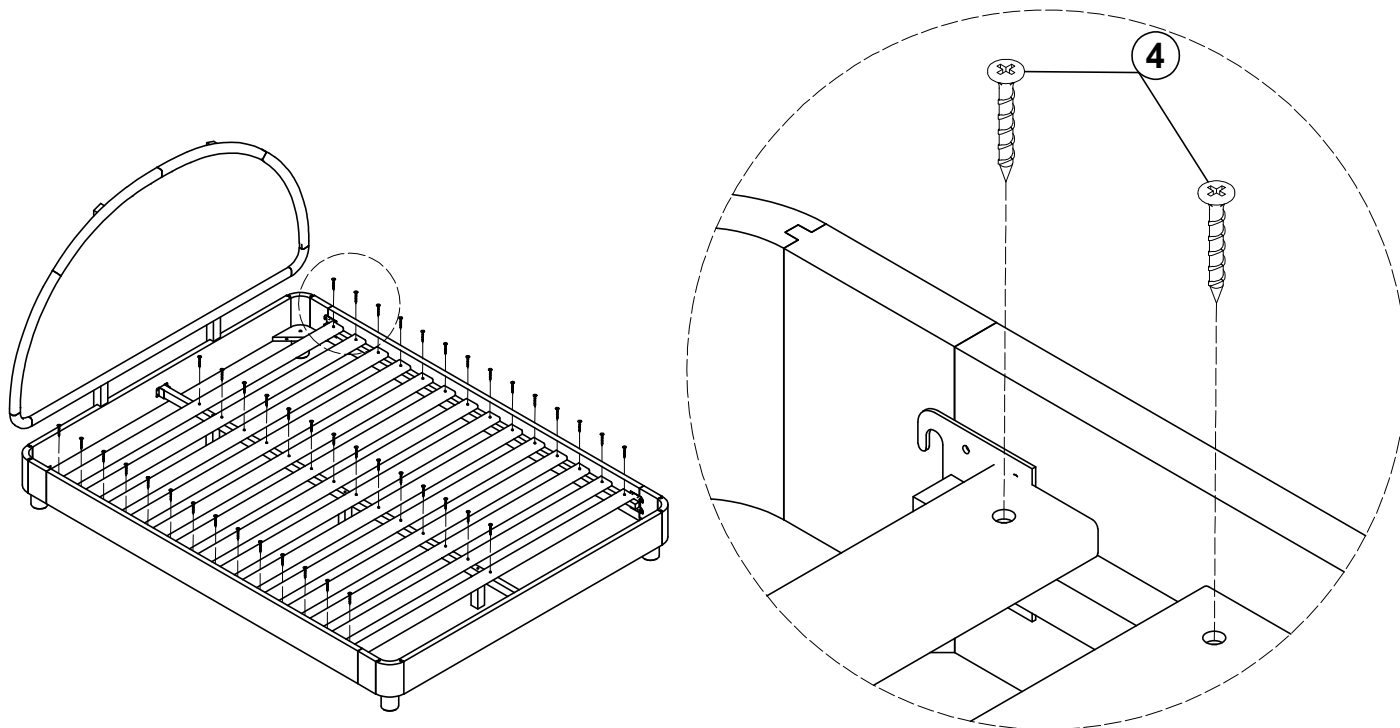

STEP 8.

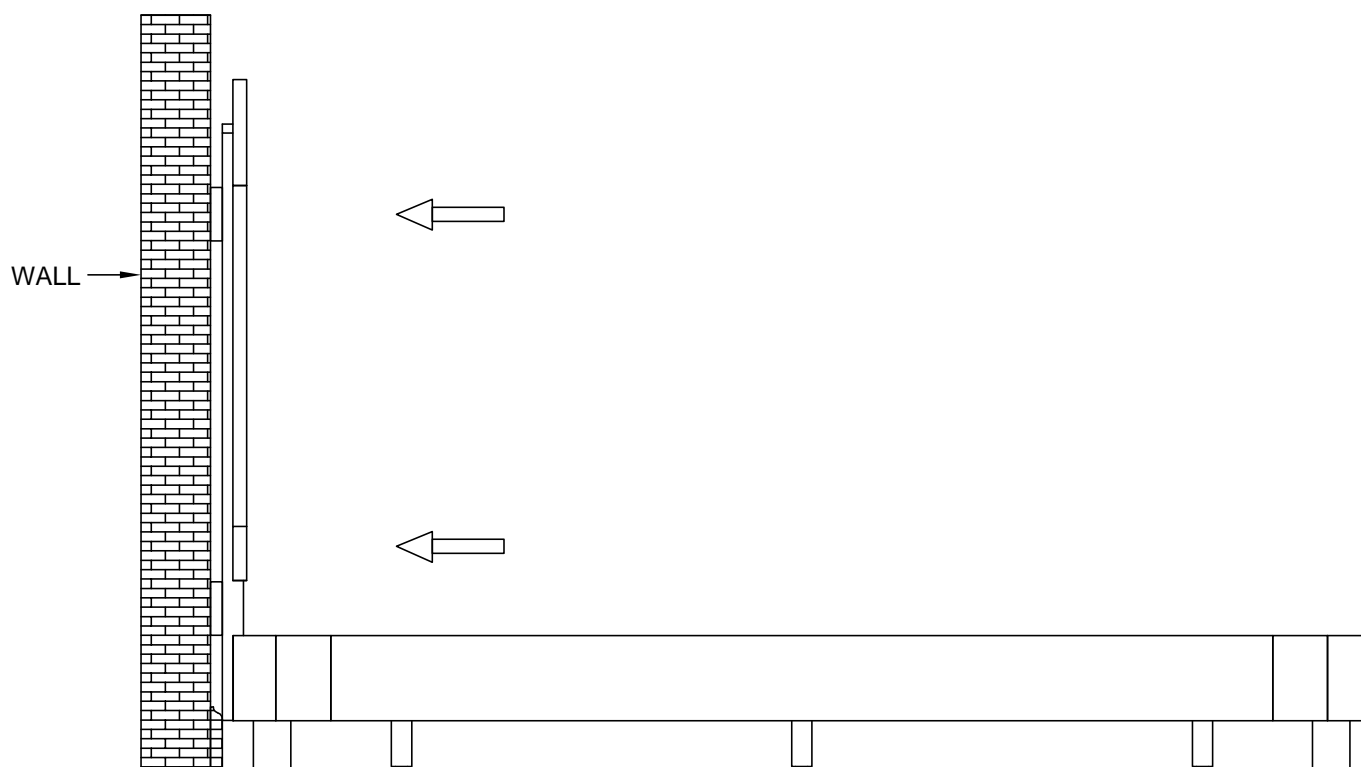

MABELLE QUEEN BED

URBAN OUTFITTERS

Assembly Instructions

FINISH

