

ASTRID COFFEE TABLE

Assembly Instructions

URBAN OUTFITTERS

TOOLS REQUIRED BUT NOT INCLUDED: N/A

Do not throw away packing materials and carton until after assembly. Assemble all parts on a clean smooth surface

CARE INSTRUCTIONS:

Avoid direct exposure to sunlight. Do not place over heat or Air conditioning vents. Adjust levelers so that the furniture sits flat on uneven floors.

Blot spills do not rub, with a clean white cloth. Do not use harsh chemicals.

Before cleaning any part test a small spot in a hidden area. You may need to re-tighten all bolts after initial use.

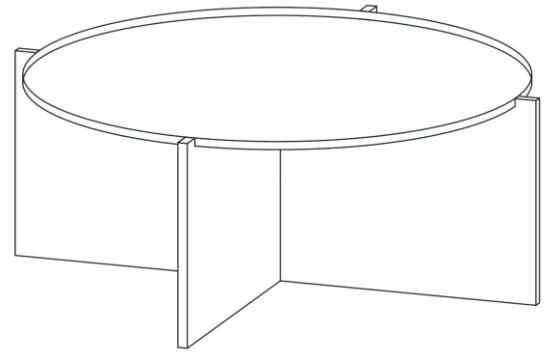

PARTS INCLUDED



(A) Bolt
[M10 x 6mm] x4

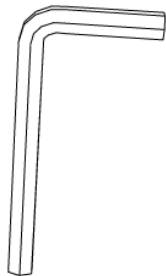

(B) Allen Wrench
x1

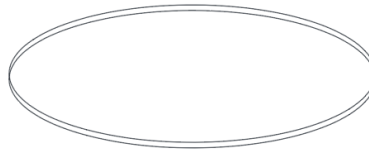

(C) TOP
1x

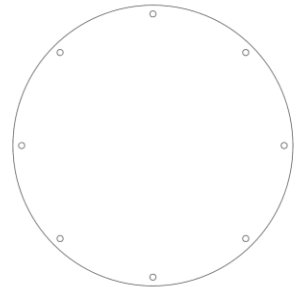

(D) Mounting plate
x1

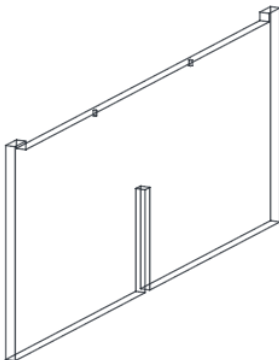

(E) Base panel
x1

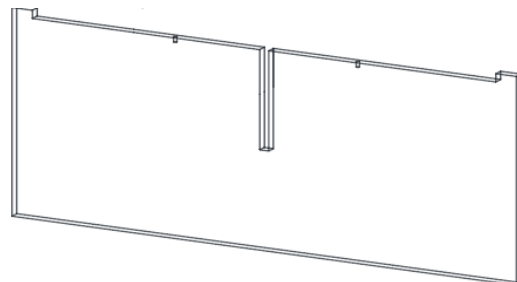

(F) Base panel
x1

ASTRID COFFEE TABLE

Assembly Instructions

URBAN OUTFITTERS

STEP 1

Slide Base Panel (E) into Base Panel (F) as shown.

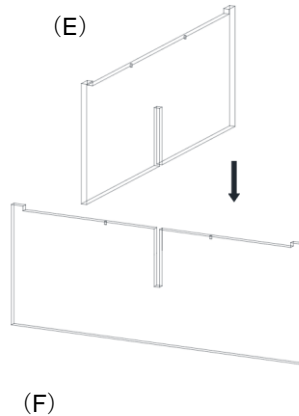

STEP 2

Align the Metal Plate (D) with Base. Insert Bolt (A) into the Base Panels through Metal Mounting Plate (D) as shown. Tighten with Allen Wrench (B). Do not overtighten.

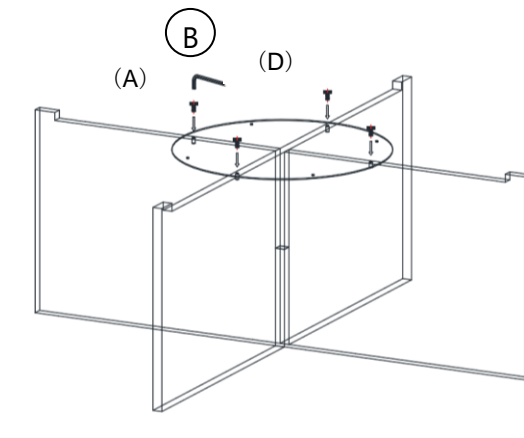

STEP 3

Lay the Top (C) over onto a clean smooth surface such as carpet or cardboard. Align the assembled Base. Insert Bolts (A) through Mounting Plate (D). Tighten using Allen Wrench (B). Do not overtighten.

