

Lantern Stand

URBAN OUTFITTERS

Assembly Instructions

TOOLS REQUIRED BUT NOT INCLUDED:

Phillips Head Screwdriver

WARNINGS:

Do not discard packing materials and the carton until assembly is complete.

Ensure all parts are present prior to assembly.

Contact customer service immediately if any parts are missing.

Assemble all parts on a clean, smooth surface.

Use a MAX 60W Type A bulb or 13 Watt LED.

Do not use a bulb that exceeds the specified wattage.

CARE INSTRUCTIONS:

Avoid direct exposure to sunlight.

Blot spills with a clean, white cloth; do not rub.

Do not use harsh chemicals.

Before cleaning any part, test a small spot in a hidden area.

Do not over-tighten the parts.

The parts may loosen after initial use; re-tighten as necessary.

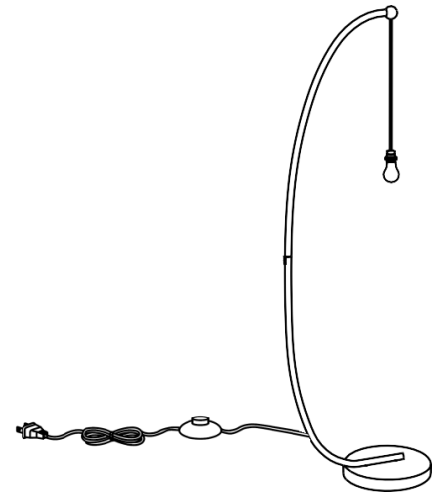

PARTS INCLUDED:



(C) Base

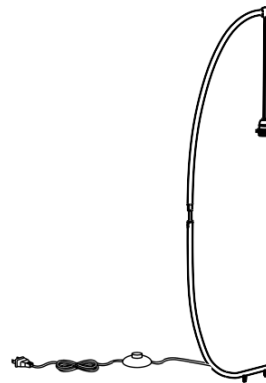

(B) Stem

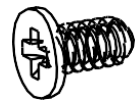

(A) Screw
[330 x 20 mm] x2



(D) Wrench
[150 x 20 mm]

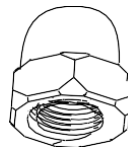

(E) Nut
[150 x 20 mm]

Lantern Stand

Assembly Instructions

URBAN OUTFITTERS

STEP 1

As you unpack and prepare for assembly, place the contents on a carpeted or padded flat surface area.

STEP 2

Pull the slack wire from the bottom of the stem (B) and insert the top half of the stem (B) into the bottom half. Insert screws (C) and tighten with a Phillips head screwdriver.

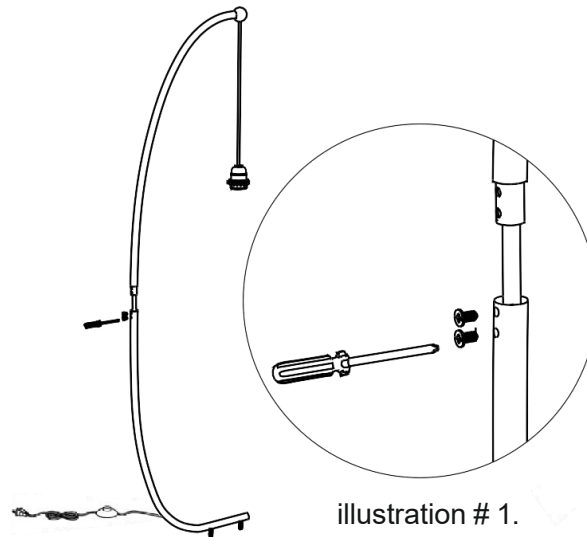

STEP 3

Insert the assembled stem (B) into the base (A). Screw the nuts (E) onto the stem (A) posts sticking through the bottom of the metal base using the wrench (D). Screw the recommended bulb into the socket OR use the socket to attach a UOH Paper Lantern or Star Pendant. Plug in the lamp, and use the switch attached to the chord to turn on and off the lamp.

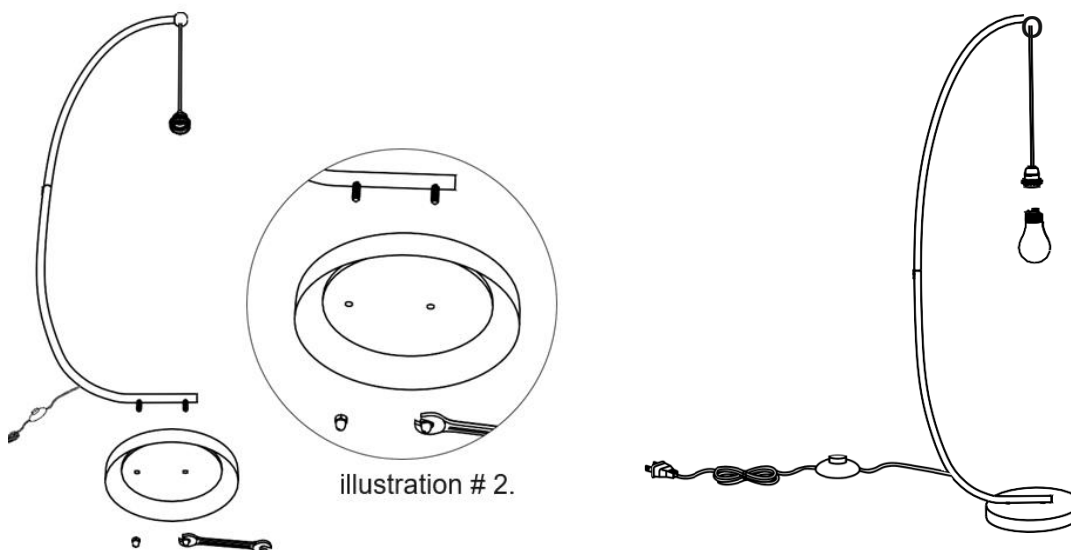

Use a MAX 60W Type A bulb or 13 Watt LED. Do not use a bulb that exceeds the specified wattage.