

# TABITHA DESK

## Assembly Instructions

URBAN OUTFITTERS

### TOOLS REQUIRED BUT NOT INCLUDED:

Phillips head screwdriver

Do not throw away packing materials and carton until after assembly. Assemble all parts on a clean smooth surface

### CARE INSTRUCTIONS:

Avoid direct exposure to sunlight. Do not place over heat or Air conditioning vents. Adjust levelers so that the furniture sits flat on uneven floors. Blot spills do not rub, with a clean white cloth. Do not use harsh chemicals. Before cleaning any part test a small spot in a hidden area. You may need to re-tighten all bolts after initial use.

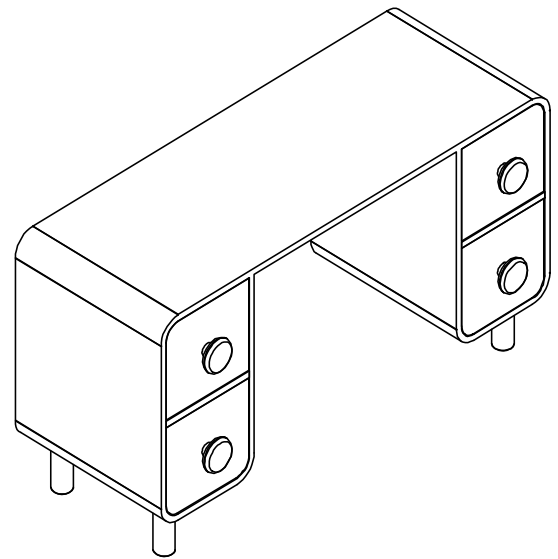

### PARTS INCLUDED

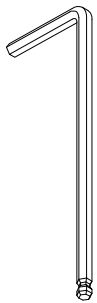

(C) Hex key  
1x

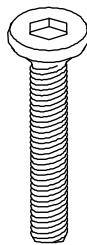

(D) Bolt  
[1/4" x 7/8"] x12



(E) Spring washer  
[1/4"] x12

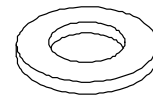

(F) Flat washer  
[1/4"] x12

### TIP KIT



(G) Nylon strip

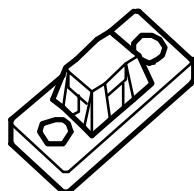

(H) Bracket  
x2

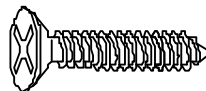

(I) Screw  
[M3 x 32mm] x2



(J) Screw  
[M3 x 19mm] x2

# TABITHA DESK

## Assembly Instructions

URBAN OUTFITTERS

### STEP 1

With help lay the Desk (A) over onto a clean smooth surface such as carpet or cardboard. Align the Legs (B) as shown and insert Flat Washer (F), Spring washer (E), and Bolt (D). Tighten with supplied Hex Key (C). Do not over tighten. Carefully stand the cabinet upright without leaning it on the legs as this can cause damage.

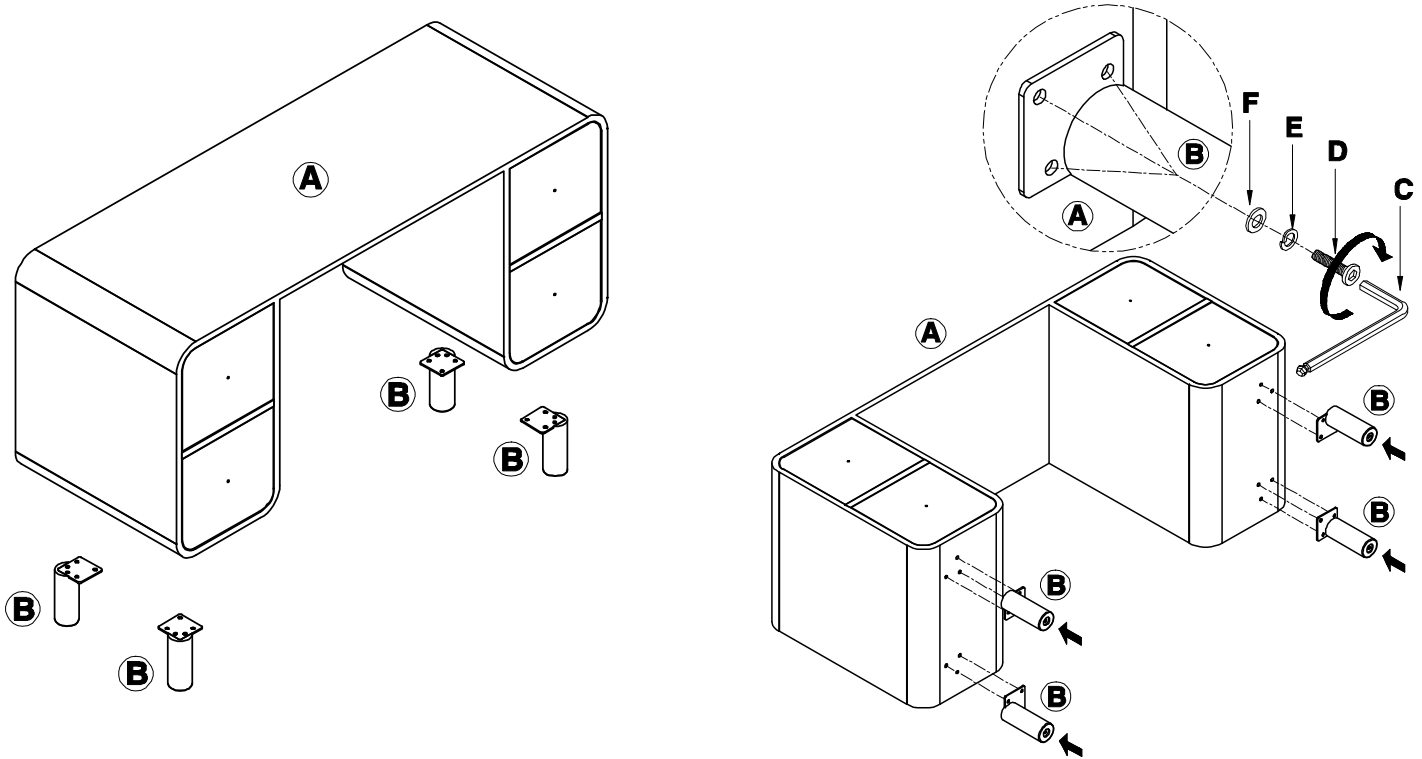

### STEP 2

Unscrew the Drawer pull installed inside the Drawer with a Philips Head Screwdriver (not included). Attach the Drawer pull to the Drawer front and insert the original Machine Screw to secure with a Phillips Head Screwdriver. Do not over tighten.

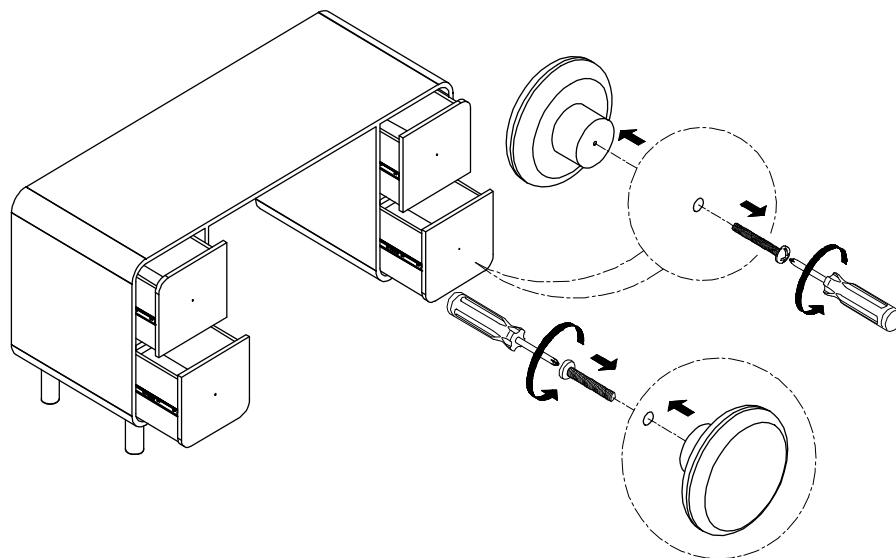

# TABITHA DESK

## Assembly Instructions

URBAN OUTFITTERS

### STEP 3

Turn the adjustable feet so the Desk sits flat on the ground.

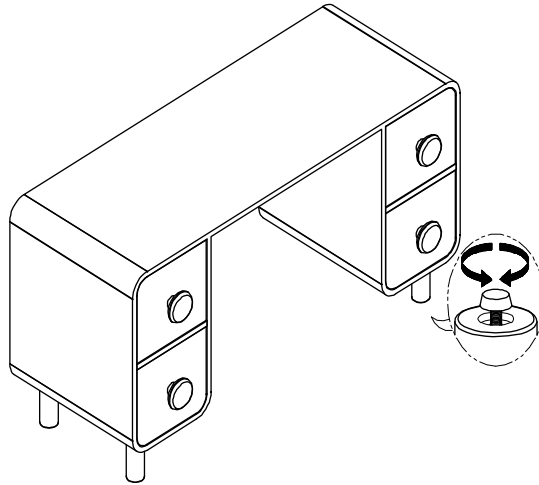

### STEP 4

Align the Anti Tip Brackets (H) to the Top back of the Desk. Insert Screws (I) and tighten completely. Do not over tighten.

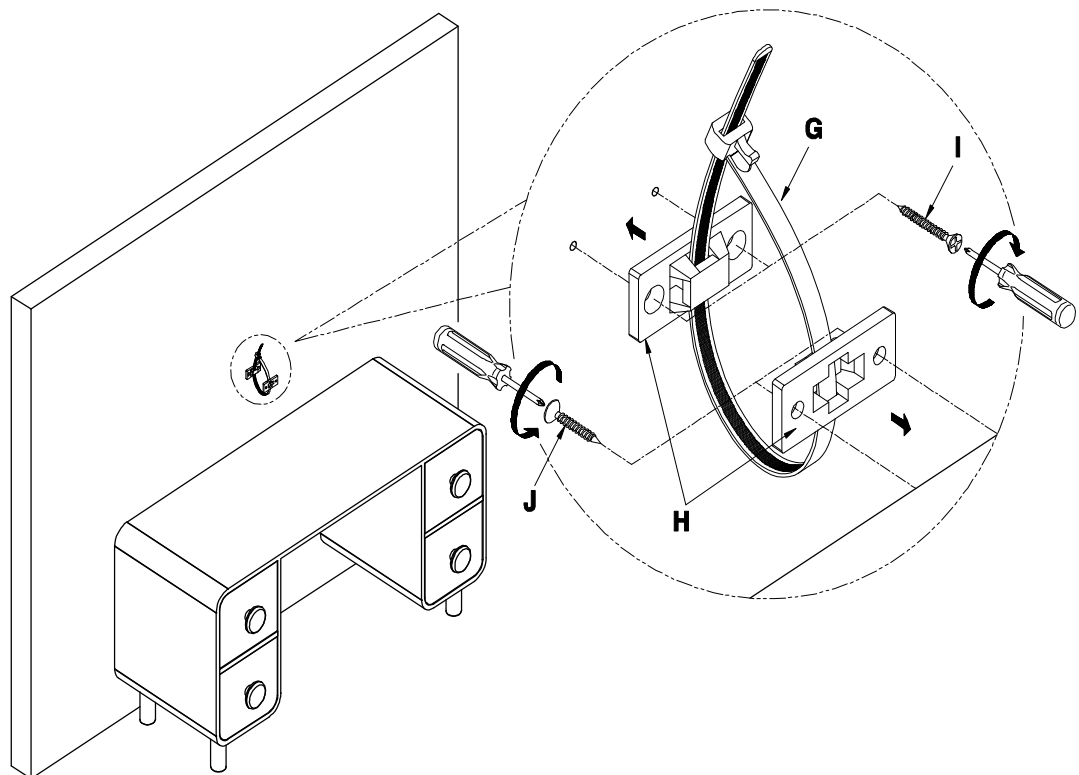

### STEP 5

Contact your local hardware store to purchase the correct anchors for your wall-type.

Align the brackets to the wall and make sure they line up with the brackets on the back of the case from step 1. Screw the brackets to the wall using the correct anchors.

Slide the case to the wall. Leaving a little bit of room between the case and the wall.

Feed the Nylon Strap through both brackets and pull tight.