

# Layered Headboard

## Assembly Instructions

URBAN OUTFITTERS

### TOOLS REQUIRED BUT NOT INCLUDED:

Phillips head screwdriver, Hammer, Pencil

Do not throw away packing materials and carton until after assembly.  
Assemble all parts on a clean smooth surface

### CARE INSTRUCTIONS:

Avoid direct exposure to sunlight. Do not place over heat or air conditioning vents. Adjust levelers so that the furniture sits flat on uneven floors.  
Blot spills do not rub, with a clean white cloth.  
Do not use harsh chemicals.  
Before cleaning any part test a small spot in a hidden area.  
You may need to re-tighten all bolts after initial use.

### PARTS INCLUDED :

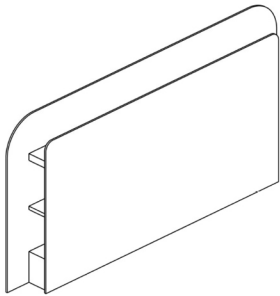
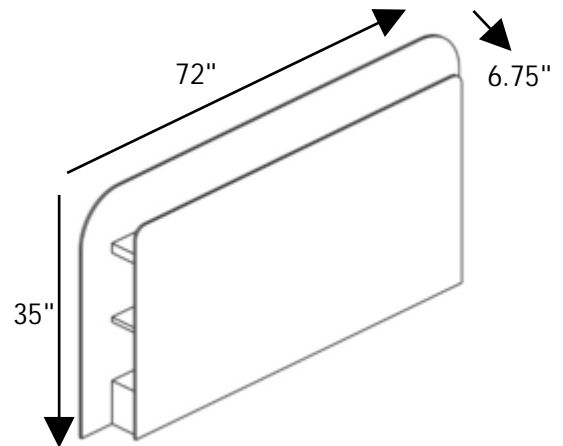

(A) Headboard  
x1



(B) Nylon strip  
x1

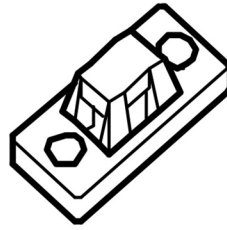

(C) Bracket  
x2

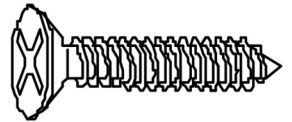

(D) Screw  
[M3 x 32mm] x2

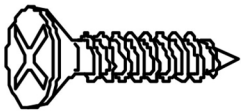

(E) Screw  
[M3 x 19mm] x2

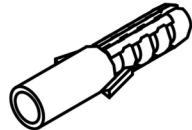

(F) Wall Anchor  
[M3 x 32mm] x2

### STEP 1

- a) Align the Anti Tip Bracket (C) to the top back of the Headboard (A). Insert Screws (E) and tighten completely. Do not over-tighten.
- b) Determine the desired location of the headboard and with help, slide it into place.
- c) If you are not attaching to drywall or a stud, contact your local hardware store to purchase the correct anchors for your wall-type.
- d) Align the second Anti Tip Bracket (C) to the wall and make sure it lines up with the bracket on the back of the Headboard from step (A). Mark the location of the second bracket (C) on the wall.
- e) Remove the headboard (A) from the wall the wall and align the wall bracket (A) to the mark from step (D). Attach the wall bracket to the wall using wall anchors (F) and screws (E) or alternate anchors and screws for non drywall or stud installations.
- f) Slide the case back against the wall leaving a little bit of room between the case and the wall.
- g) Feed the Nylon Strap (B) through both brackets as shown and pull tight to attach.

