

# Everly Media Unit

URBAN OUTFITTERS

## Assembly Instructions

### NO ADDITIONAL TOOLS REQUIRED

#### WARNINGS:

Do not throw away packing materials and carton until after assembly.  
Ensure all parts are present prior to assembly.  
Contact customer service immediately if parts are missing.  
Assemble all parts on a clean smooth surface.

#### CARE INSTRUCTIONS:

Avoid direct exposure to sunlight.  
Do not place over heat or air conditioning vents.  
Adjust levelers so that the furniture sits flat on uneven floors.  
Blot spills with a clean white cloth, do not rub.  
Do not use harsh chemicals.  
Before cleaning any part test a small spot in a hidden area.  
You may need to re-tighten all bolts after initial use.

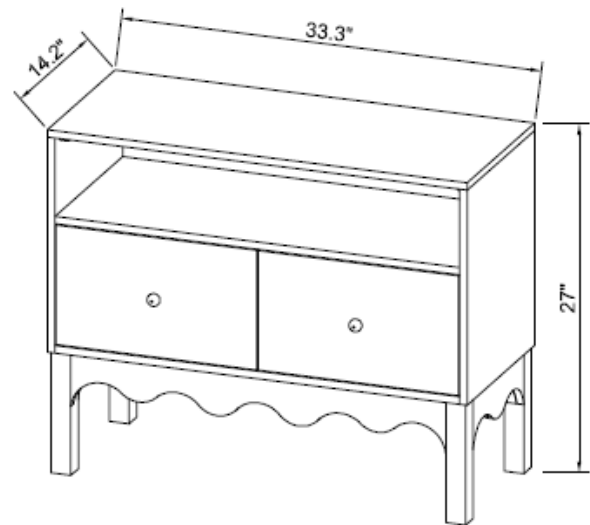

### PARTS INCLUDED

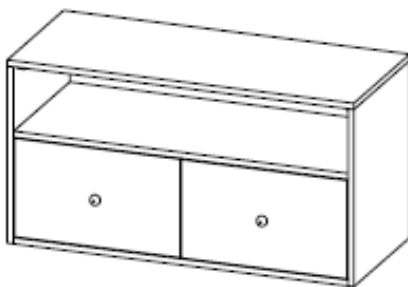

(A) MEDIA UNIT  
x1



(B) SIDE  
x2



(C) LEGS  
x2



(D) ROUND HEAD ALLEN BOLT  
[M6 X 35MM] x16



(E) WASHER  
[M6 X 20MM] x16



(F) ALLEN KEY  
[4MM] x1

EXCLUSIVE AND CONFIDENTIAL PROPERTY OF URBAN OUTFITTERS, INC.

© 2017 UO, Inc. All rights reserved, including all applicable copyright, design and patent rights.  
Any unauthorized reproduction, adaptation, distribution or other infringement will be prosecuted.

### STEP 1

With help, lay the media unit (A) over onto a clean smooth surface. Align the sides (B) with the sides of the media unit (A) and insert the bolts (D) and washer (E) as shown. Partially tighten the bolts (D) with the Allen key (F).

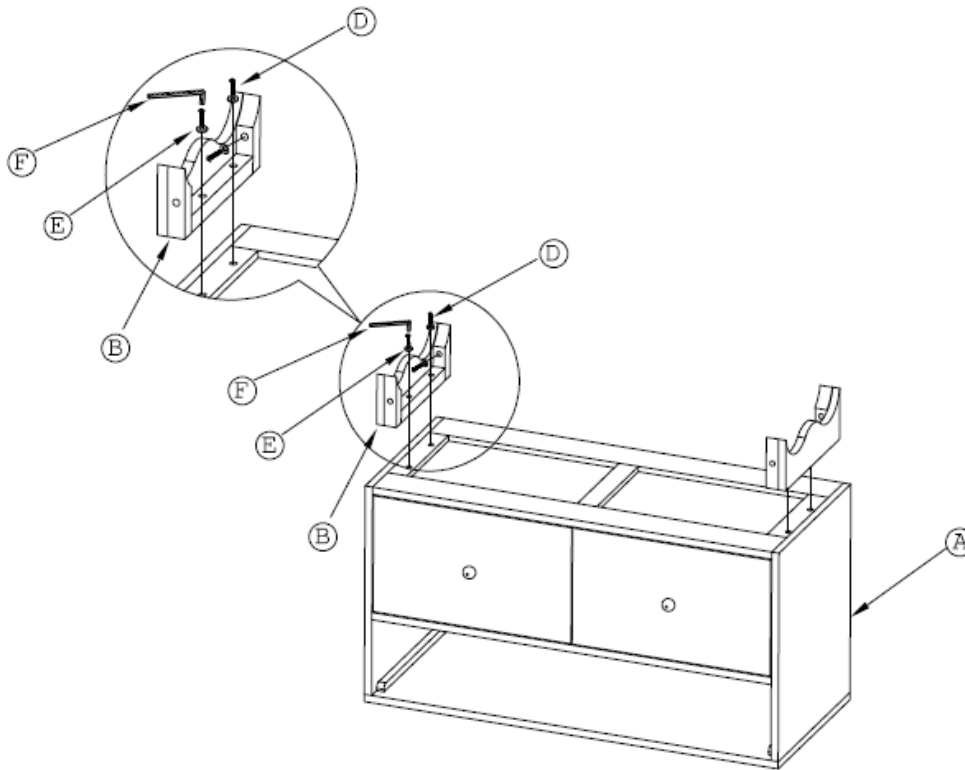

### STEP 2

Align the legs (C) with the front and back of the media unit (A) and insert the bolts (D) and washers (E) as shown. Partially tighten the bolts (D) with the Allen key (F). Once all bolts are partially tightened, fully tighten the bolts. With help, flip the media unit (A) upright.

