

Ebba 3 Drawers Dresser

URBAN OUTFITTERS

Assembly Instructions

TOOLS REQUIRED BUT NOT INCLUDED:
Phillips Head Screwdriver

WARNINGS:

Do not throw away packing materials and carton until after assembly. Assemble all parts on a clean smooth surface

CARE INSTRUCTIONS:

Avoid direct exposure to sunlight. Do not place overheat or air conditioning vents. Adjust levelers so that the furniture sits flat on uneven floors.

Blot spills do not rub, with a clean white cloth.

Do not use harsh chemicals.

Before cleaning any part test a small spot in a hidden area. You may need to re-tighten all bolts after initial use

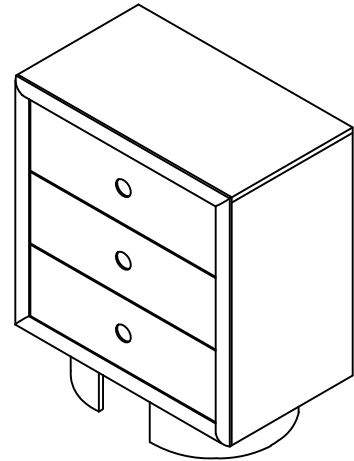

PARTS INCLUDED

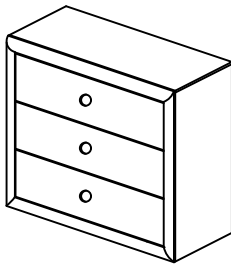

A) Dresser
x1

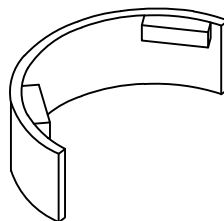

B) Left Leg
x1

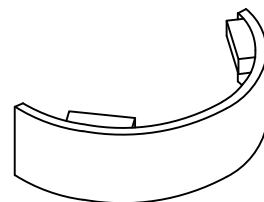

C) Right Leg
x1

HARDWARE LIST

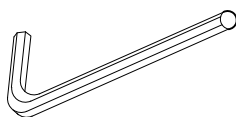

1) Allen Wrench
[M4] x1

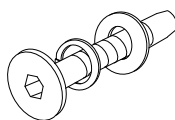

2) Bolt
[M6 x 60mm] x12

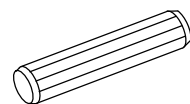

3) Wood Dowel
[M10 x 30mm] x4

Ebba 3 Drawers Dresser

Assembly Instructions

URBAN OUTFITTERS

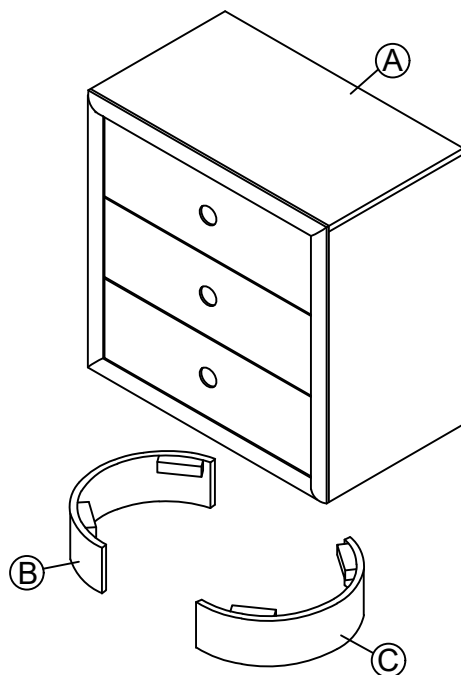

STEP 1

Insert wood dowel (3) to left and right leg (B & C) as per diagram shown. Align and fasten left and right leg (B & C) to dresser (A) with bolt (2) and tighten with Allen wrench (1).

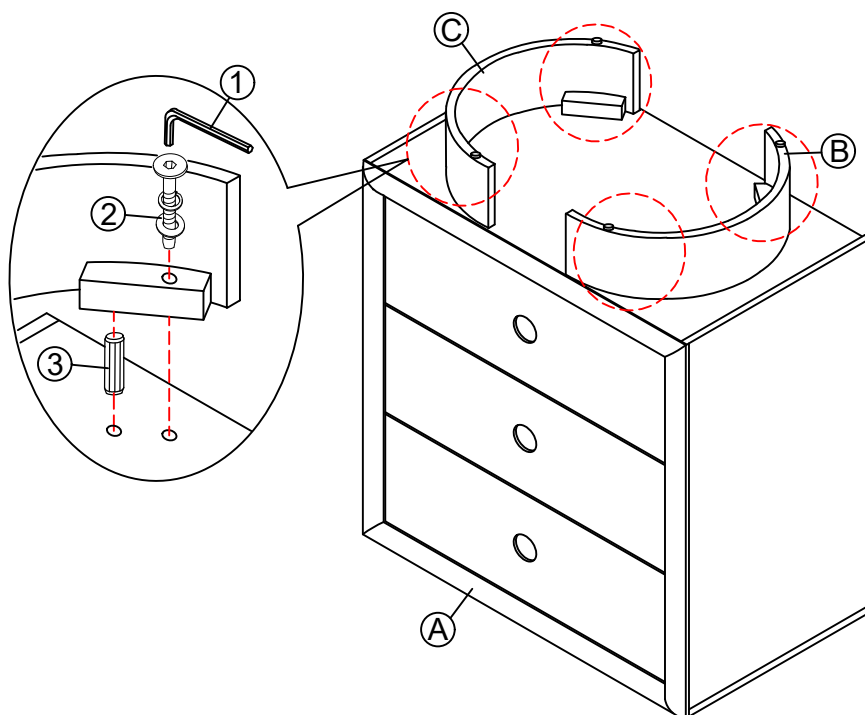

Ebba 3 Drawers Dresser

URBAN OUTFITTERS

Assembly Instructions

STEP 2

Adjust leveler to touch the floor.

