

# Ryan Mirror Clothing Rack

URBAN OUTFITTERS

## Assembly Instructions

TOOLS REQUIRED BUT NOT INCLUDED: N/A

### WARNINGS:

Do not throw away packing materials and carton until after assembly.  
Assemble all parts on a clean smooth surface

### CARE INSTRUCTIONS:

Avoid direct exposure to sunlight. Do not place over heat or Air conditioning vents. Adjust levelers so that the furniture sits flat on uneven floors.  
Blot spills do not rub, with a clean white cloth. Do not use harsh chemicals.  
Before cleaning any part test a small spot in a hidden area. You may need to re-tighten all bolts after initial use.

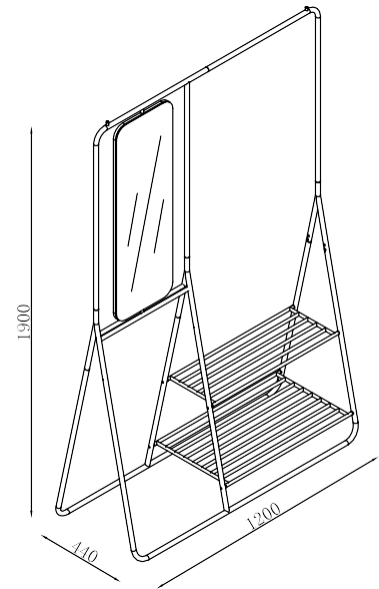

## PARTS INCLUDED

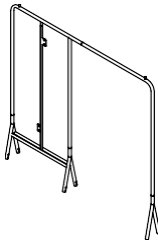

A) Top Frame x1

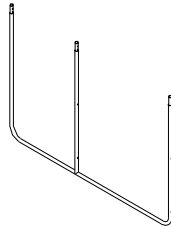

B) Bottom Frame x2

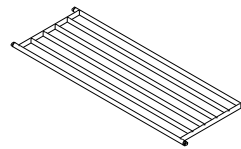

C) Small Shelf x1

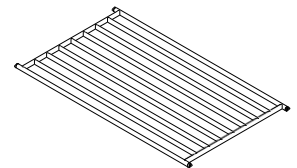

D) Large Shelf x1



E) Mirror x1

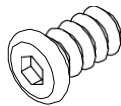

F) Bolt  
[M6x12mm] x16

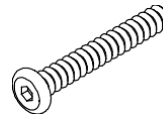

G) Bolt  
[M6x35mm] x8

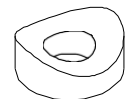

H) Spacer x8

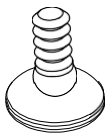

I) Leveler x4

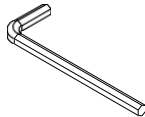

J) Allen Wrench x1

EXCLUSIVE AND CONFIDENTIAL PROPERTY OF URBAN OUTFITTERS, INC.

© 2017 UO, Inc. All rights reserved, including all applicable copyright, design and patent rights. Any unauthorized reproduction, adaptation, distribution or other infringement will be

# Ryan Mirror Clothing Rack

URBAN OUTFITTERS

## Assembly Instructions

### STEP 1

Screw Levelers (I) into Bottom Frame (B) as shown in the drawing below.

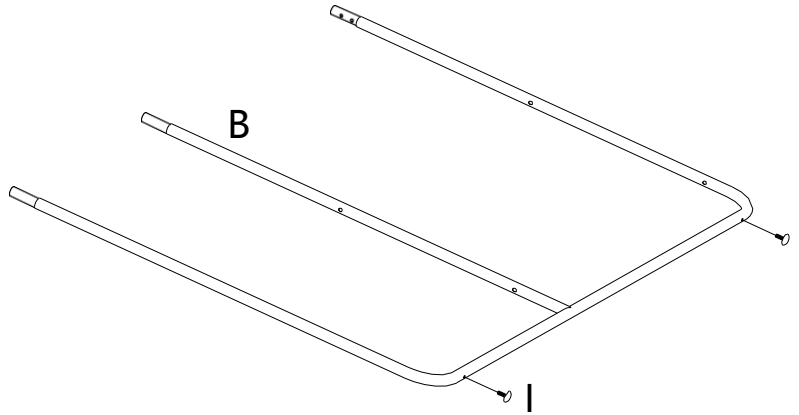

### STEP 2

Insert Bottom Frames (B) into the Top Frame (A) and secure with Bolt (F) as shown in below picture. Tighten with supplied Allen Key (J) to secure.

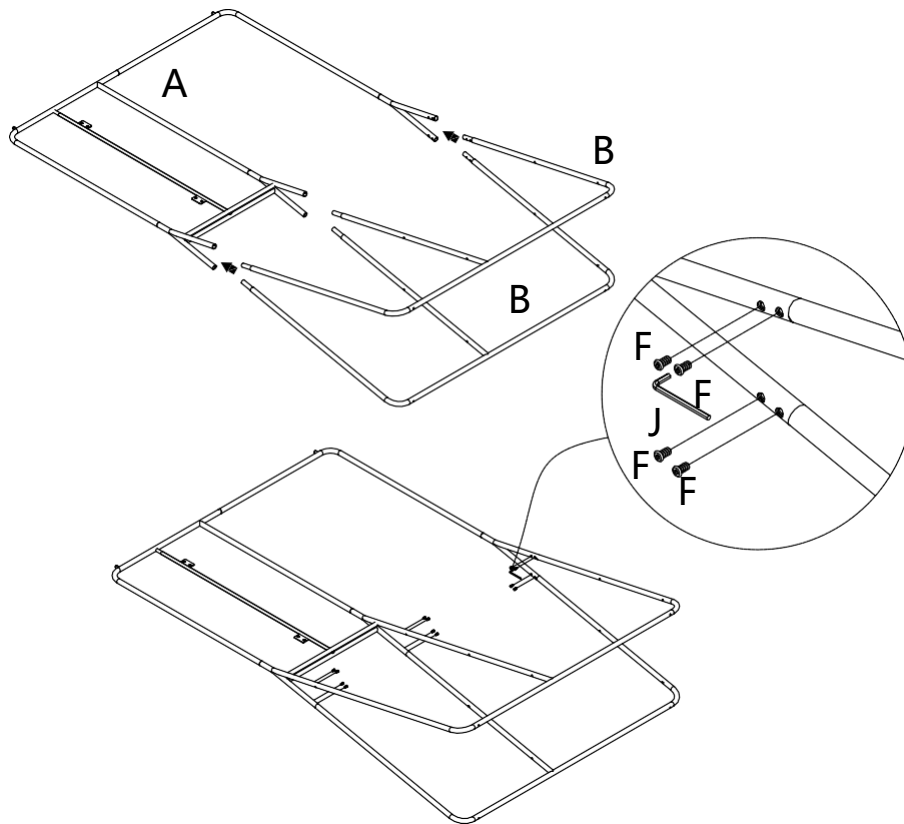

EXCLUSIVE AND CONFIDENTIAL PROPERTY OF URBAN OUTFITTERS, INC.

© 2017 UO, Inc. All rights reserved, including all applicable copyright, design and patent rights. Any unauthorized reproduction, adaptation, distribution or other infringement will be

# Ryan Mirror Clothing Rack

## Assembly Instructions

URBAN OUTFITTERS

### STEP 3

Assemble Small and Large Shelves (C&D) to frame with Bolt (G) as shown in below pictures. Tighten with supplied Allen Key (J) to secure.

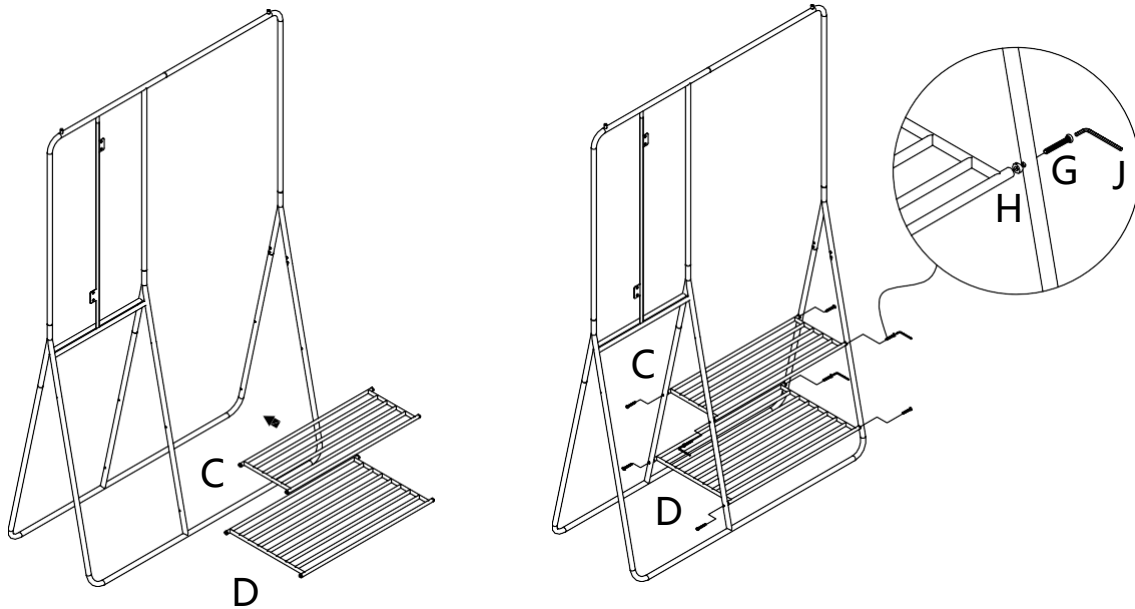

### STEP 4

Assemble Mirror (E) to frame with Bolt(F) as shown in below pictures. Tighten with supplied Allen Key (J) to secure.

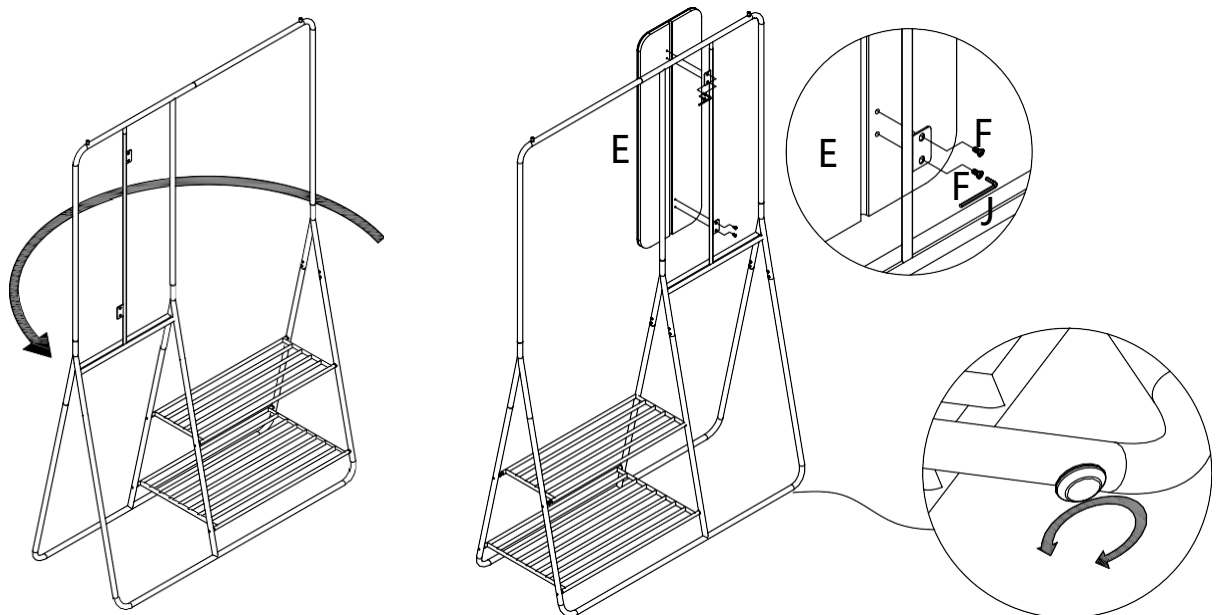

EXCLUSIVE AND CONFIDENTIAL PROPERTY OF URBAN OUTFITTERS, INC.

© 2017 UO, Inc. All rights reserved, including all applicable copyright, design and patent rights. Any unauthorized reproduction, adaptation, distribution or other infringement will be