

# Mallard & Trout Drawer Pull / Knob

URBAN OUTFITTERS

## Assembly Instructions

### TOOLS REQUIRED BUT NOT INCLUDED:

Drill, Phillips head screwdriver, Pencil

### WARNINGS:

Do not discard packing materials and the carton until assembly is complete. Ensure all parts are present prior to assembly.

Contact customer service immediately if any parts are missing.

Assemble all parts on a clean, smooth surface.

**Screws attaching hooks / knobs to packaging not intended for installation.**

### CARE INSTRUCTIONS:

Avoid direct exposure to sunlight.

Blot spills with a clean, white cloth; do not rub.

Do not use harsh chemicals.

Before cleaning any part, test a small spot in a hidden area.

Do not over-tighten the parts.

The parts may loosen after initial use; re-tighten as necessary.

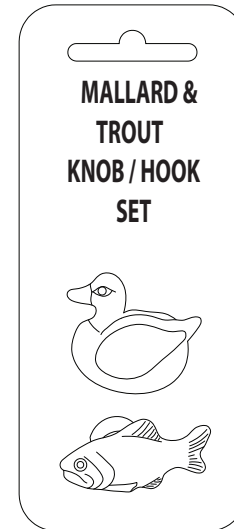

### PARTS INCLUDED:

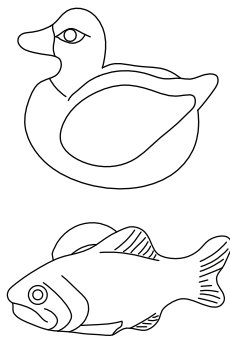

(A) Pull / Knob  
x1

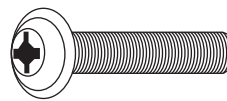

(B) Machine Screw  
(for knob installation)  
[0.16"Ø x 1.6" L]  
or  
[4mm Ø, 40mm L]  
x1

## Assembly Instructions

### Knob Installation:

#### STEP 1 (AS NECESSARY)

Determine a location for the pull / knob (A) and use a pencil to mark the location. Use existing holes if available. If necessary, use a drill bit the same size or no greater than 1/32" or 1 mm larger than the machine screw (B) to make a hole in the door or drawer at the marked location.

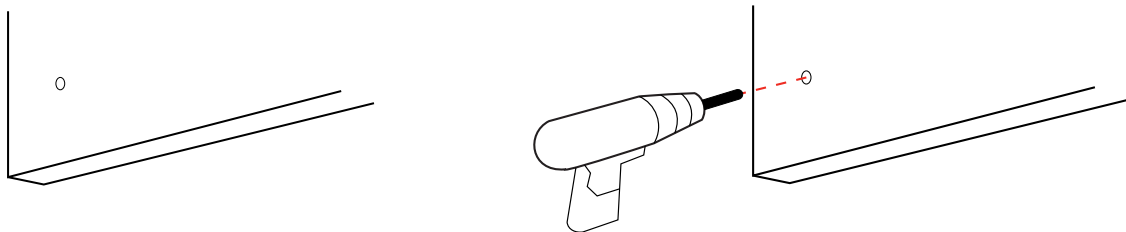

#### STEP 2

Use a Phillips head screw driver to fasten the pull / knob (A) to the door or drawer with the machine screw (B).

**Do not over-tighten the machine screw (B).**

