

# ASHER SINGLE SHADE FLUSH MOUNT

URBAN OUTFITTERS

## Assembly Instructions

TOOLS REQUIRED BUT NOT INCLUDED:  
Phillips head screwdriver, Wire Cutters

### WARNINGS:

Do not throw away packing materials and carton until after assembly.  
Ensure all parts are present prior to assembly.  
Contact customer service immediately if parts are missing.  
Assemble all parts on a clean smooth surface.

**Use a MAX 60W Type A bulb.**

**A licensed professional electrician should install direct wire fixtures.**

### CARE INSTRUCTIONS:

Avoid direct exposure to sunlight.  
Do not place over heat or air conditioning vents.  
Adjust levelers so that the furniture sits flat on uneven floors.  
Blot spills with a clean white cloth, do not rub.  
Do not use harsh chemicals.  
Before cleaning any part test a small spot in a hidden area.  
You may need to re-tighten all bolts after initial use.

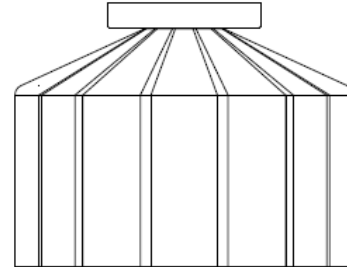

### PARTS INCLUDED:



(A) Wire Nuts x3

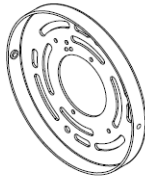

(B) Mounting Plate

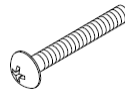

(C) Mounting Screws  
[8#-32TX25mm] x2

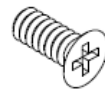

(D) Canopy Screws  
[5/32-32T\*10mmL] x2

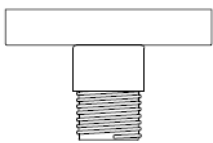

(E) Lamp Body



(F) Plastic Washer  
[D52xT1.0mm] x2

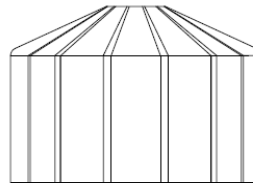

(G) Glass Shade



(H) Socket Ring

## Assembly Instructions

### STEP 1

Carefully unpack the product. Ensure power to the existing wires is disconnected then insert the wires through the center opening of the Mounting Plate (B). Attach the Mounting Plate (B) to the electrical box using the two Mounting Screws (C). Tighten each screw until the Mounting Plate (B) is firmly secured to the electrical box.

### STEP 2

Carefully inspect the wire's fixtures:

- Neutral fixture wire = white
- Hot fixture wire = black
- Ground wire = green or bare copper
  - a) Wrap the ground wire of the junction box around the ground screw on the mounting plate and secure the screw
  - b) Attach the remaining ground wire from the junction box to the fixture ground wire with a wire nut and wrap the connection with electrical tape.
  - c) Attach the hot fixture wire from the pendant to the hot junction box wire.
  - d) Fasten each together with a wire nut and wrap the connection with electrical tape.

**DO NOT REVERSE THE HOT AND NEUTRAL CONNECTIONS OR SAFETY WILL BE COMPROMISED**

### STEP 3

Place the Lamp Body (E) onto the Mounting Plate (B) and attach with Canopy Screws (D) using a Phillips head screwdriver.

### STEP 4

Place a washer (F) above and below the Lamp Shade (G) then, place the Lamp Shade (G) onto the Lamp Body (E). Screw the socket ring (H) onto the Lamp Body (E) clockwise until tight. Do not over tighten the socket ring (H).

### STEP 5

Insert the specified light bulb into the socket. **DO NOT EXCEED THE SPECIFIED WATTAGE.**

### STEP 6

Reconnect the main electrical supply from the fuse box/circuit breaker and test fixture, enjoy your new lamp.

**Use a MAX 60W Type A bulb. Do not use bulb that exceeds recommended wattage.**

