

Nori Dining Table

URBAN OUTFITTERS

Assembly Instructions

TOOLS REQUIRED BUT NOT INCLUDED:

Phillips head screwdriver

WARNINGS:

Do not discard packing materials and the carton until assembly is complete.

Ensure all parts are present prior to assembly.

Contact customer service immediately if any parts are missing.

Assemble all parts on a clean, smooth surface.

CARE INSTRUCTIONS:

Avoid direct exposure to sunlight.

Blot spills with a clean, white cloth; do not rub.

Do not use harsh chemicals.

Before cleaning any part, test a small spot in a hidden area.

Do not place over heat or air conditioning vents.

Do not over-tighten the parts.

The parts may loosen after initial use; re-tighten as necessary.

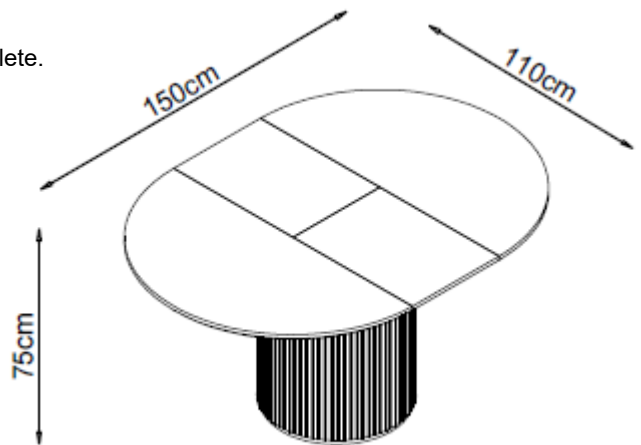

PARTS INCLUDED:

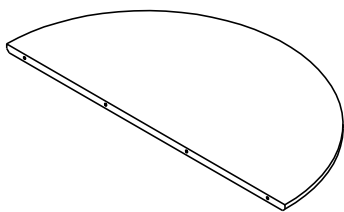

1) Top Panels x 2

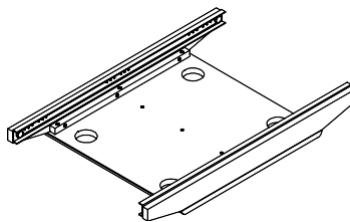

2) Top Frame x 1

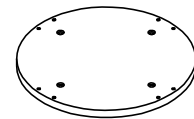

3) Middle Frame x 1

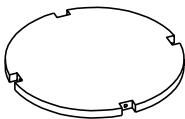

4) Bottom Frame x 1

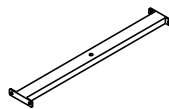

5) Post x 4

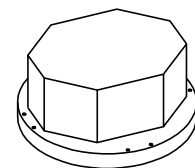

6) Base x 1

Nori Dining Table

Assembly Instructions

URBAN OUTFITTERS

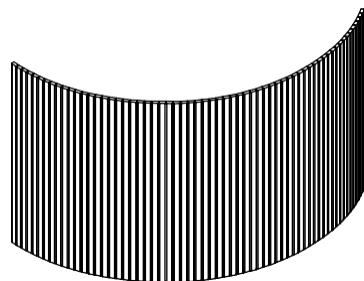

7) Ribbed Panel x 1

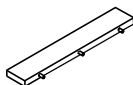

8) Support x 1

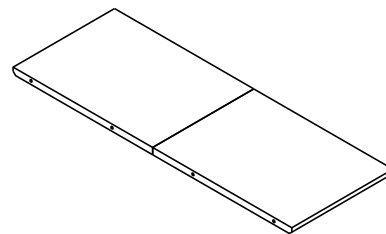

9) Stretcher x 1

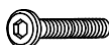

A) Bolt
(D 0.47 / 0.24 x 1.38") x 8
or
(D 12 x 35 mm)



B) Spring Washer
(D 0.47 / 0.24 x 0.08") x 4
or
(D 12 / 6 x 2 mm)



C) Flat Washer
(D 0.63 / 0.24 x 0.08") x 4
or
(D 16 / 6 x 2 mm)

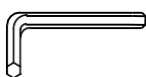

D) Allen Key
(D 0.16 x 2.32") x 1
or
(D 4 x 59 mm)



E) Bolt
(D 0.47 / 0.24 x 0.79") x 16
or
(D 12/6 x 20 mm)



F) Screw
(D 0.39 / 0.16 x 0.59") x 16
or
(D 10/4 x 15 mm)

Nori Dining Table

Assembly Instructions

URBAN OUTFITTERS

STEP 1

Place the top panels (1) upside down on a clean smooth surface. Place the top frame (2) upside down on the top panels (1) aligning the holes in each, as shown. Use a Phillips head screwdriver to attach the top panels (1) to the top frame (2).

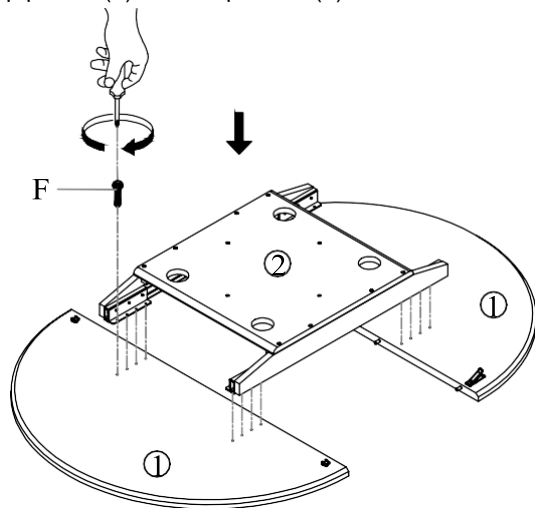

STEP 2

Place the middle frame (3) on the top frame (2) and insert bolts (A), spring washers (B), and flat washers (C), as shown. Tighten the bolts (A) using the Allen key (D). With help, carefully push top panels (1) together.

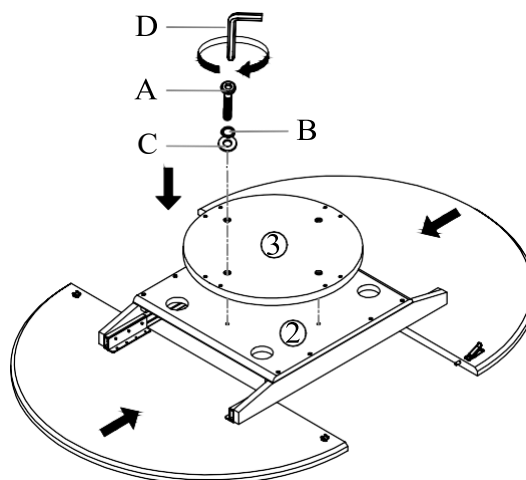

STEP 3

One at a time, align the posts (5), base (6) and bottom frame (4), as shown. Attach each post (5) to the base (6) with bolts (E), then bottom frame (4) with bolts (A), using Allen Key (D).

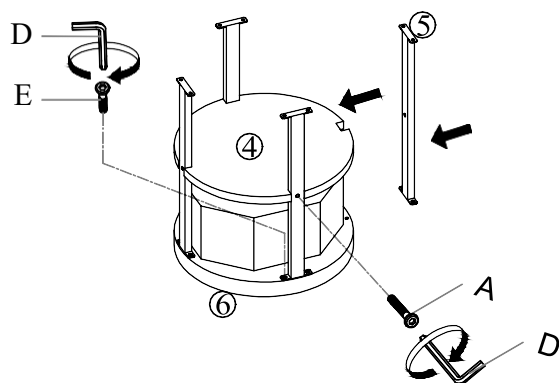

STEP 4

With help, carefully flip the partially assembled base onto the bottom of the previously assembled top, aligning the holes in each, as shown. Attach the posts (5) to the middle frame (3) with bolts (E), using Allen key (D). Engage the hook-locks as shown to secure the top panels (1).

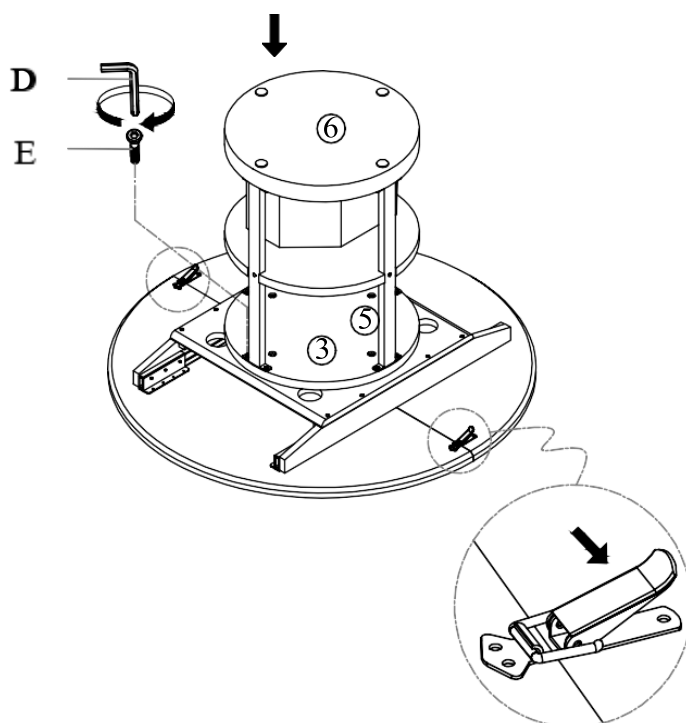

Nori Dining Table

Assembly Instructions

URBAN OUTFITTERS

STEP 5

Ensure the ribbed panel (7) is parallel to one of the posts (5). Wrap the ribbed panel (7) around the partially assembled base, aligning the Velcro strips on each of the parts.

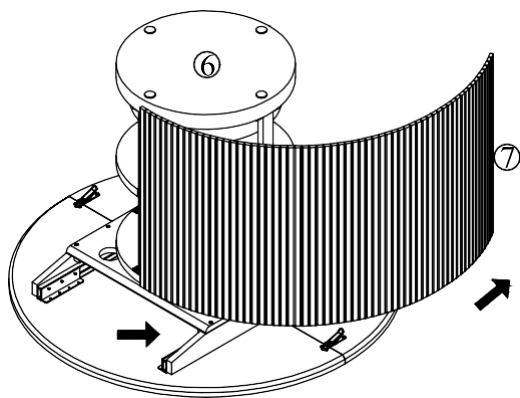

STEP 6

With help, flip the furniture upright. Disengage the hook locks to pull to open the top panels (1) then, insert the support (8) as shown.

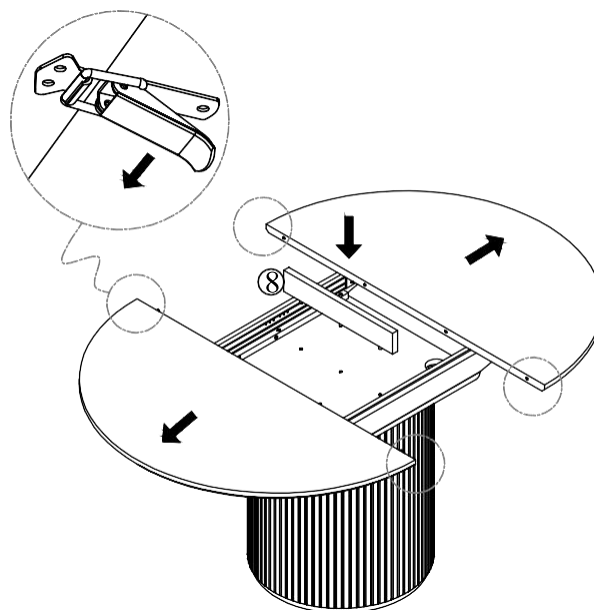

STEP 7

Place the stretcher (9) between the top panels (1). Ensure the posts and holes in each are aligned then, with help, push the top panels (1) back together.

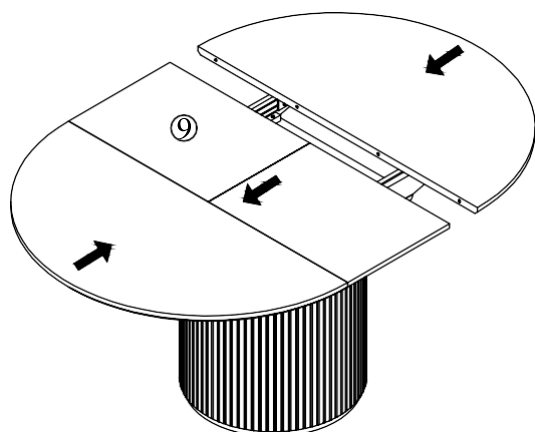

STEP 8

Engage the hook-locks as shown below to secure the top panels (1).

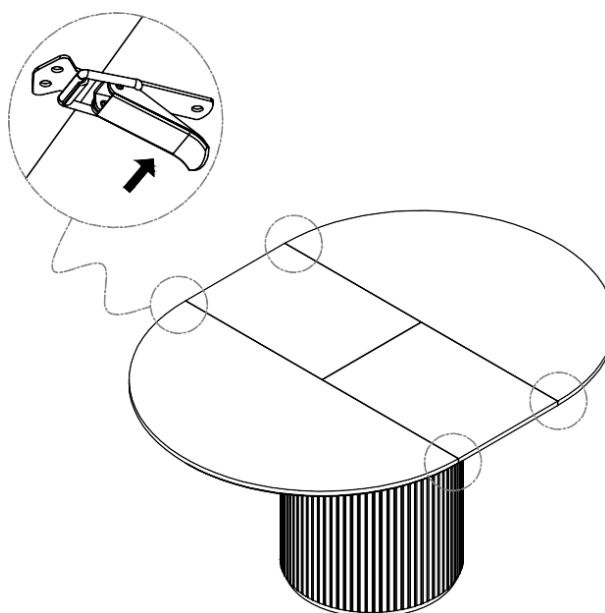

Nori Dining Table

URBAN OUTFITTERS

Assembly Instructions

STEP 9 (optional)

The stretcher (9) can be removed and stored, as shown below:

