

IMARI COFFEE TABLE

URBAN OUTFITTERS

Assembly Instructions

TOOLS REQUIRED BUT NOT INCLUDED: PHILLIPS HEAD SCREWDRIVER

Do not throw away packing materials and carton until after assembly.
Assemble all parts on a clean smooth surface

CARE INSTRUCTIONS:

Avoid direct exposure to sunlight. Do not place over heat or Air conditioning vents.
Adjust levelers so that the furniture sits flat on uneven floors.
Blot spills do not rub, with a clean white cloth.
Do not use harsh chemicals.
Before cleaning any part test a small spot in a hidden area.
You may need to re-tighten all bolts after initial use.

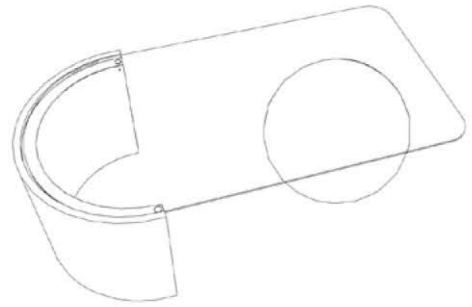

PARTS INCLUDED

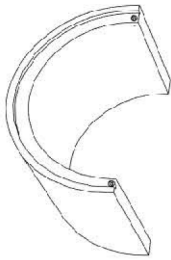

(A) Arc Base
1x

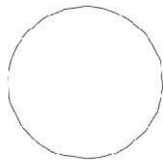

(B) Round Base
1x

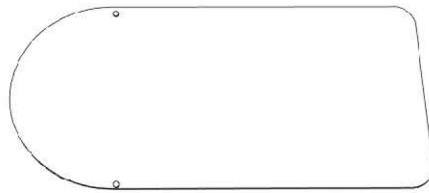

(C) Glass Top
1x



(D) Cam Bolt
2x

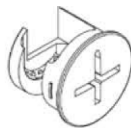

(E) Cam Lock
2x

IMARI COFFEE TABLE

URBAN OUTFITTERS

Assembly Instructions

STEP 1. With help lay the Glass Top (C) over onto a clean smooth surface. Screw in Cam Bolts (D) as shown.

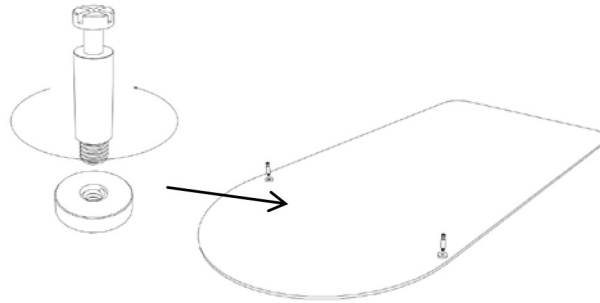

STEP 2. With help align the Glass Top (C) over the Arc Base (A) and Round Base (B) as shown. Press the Cam Bolts (D) into the base.

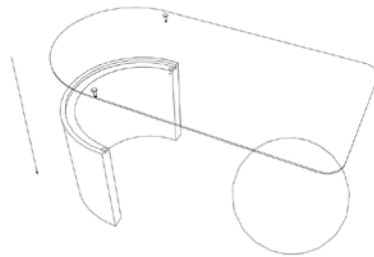

STEP 3. Insert the Cam Locks (E) into the holes on the inside of the Arc Base as shown. Turn Cam Locks (E) clockwise with a screwdriver to lock them.

