

GILLIAN CABINET

Assembly Instructions

URBAN OUTFITTERS

TOOLS REQUIRED BUT NOT INCLUDED:

Phillips head screwdriver, level, pencil

WARNINGS:

Do not throw away packing materials and carton until after assembly. Assemble all parts on a clean smooth surface

CARE INSTRUCTIONS:

Avoid direct exposure to sunlight. Do not place overheat or air conditioning vents. Adjust levelers so that the furniture sits flat on uneven floors.

Blot spills do not rub, with a clean white cloth

Do not use harsh chemicals.

Before cleaning any part test a small spot in a hidden area.

You may need to re-tighten all bolts after initial use.

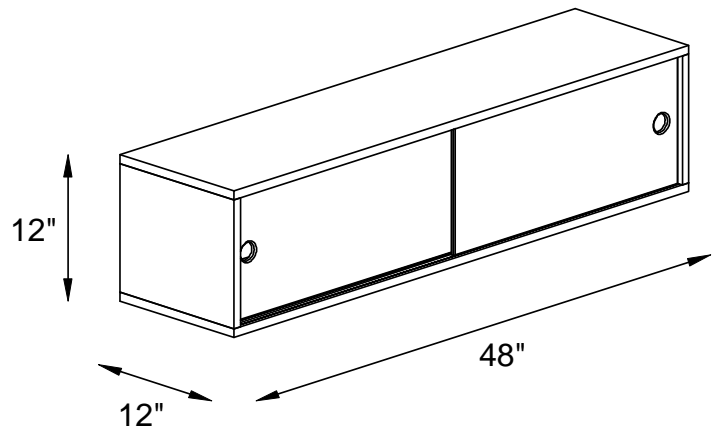

PARTS INCLUDED

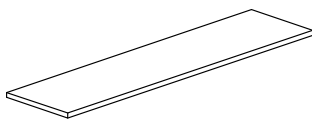

(A) Top Panel
x1

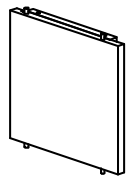

(B) Side Panel
x1

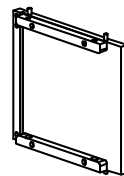

(C) Side Panel
x1

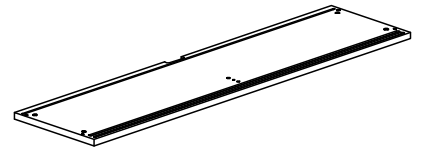

(D) Bottom Panel
x1

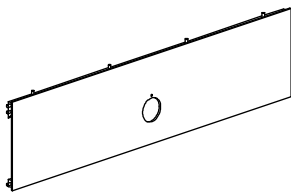

(E) Back Panel
x1

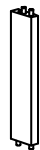

(F) Center Rail
x1

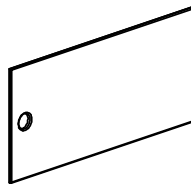

(G) Door
x1

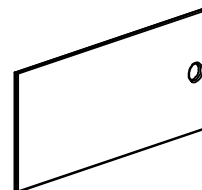

(H) Door
x1

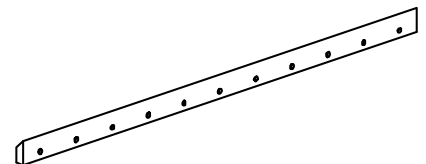

(I) Cleat
x1

HARDWARE LIST



(J) Hex key
x 1

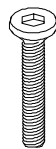

(K) Bolt
[1/4" x 1"] x8



(L) Spring washer
[1/4"] x8



(M) Flat washer
[1/4"] x8

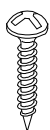

(N) Screw
[M4 x 30mm] x8



(O) Metal Anchor
[M15 x 28mm] x11



(P) Machine Screw
[M8 x 35mm] x11

STEP 1

With help lay the Parts out onto a clean smooth surface such as carpet or cardboard. Align the Back Panel (E) with the Side Panels (B&C) and press firmly into place as shown.

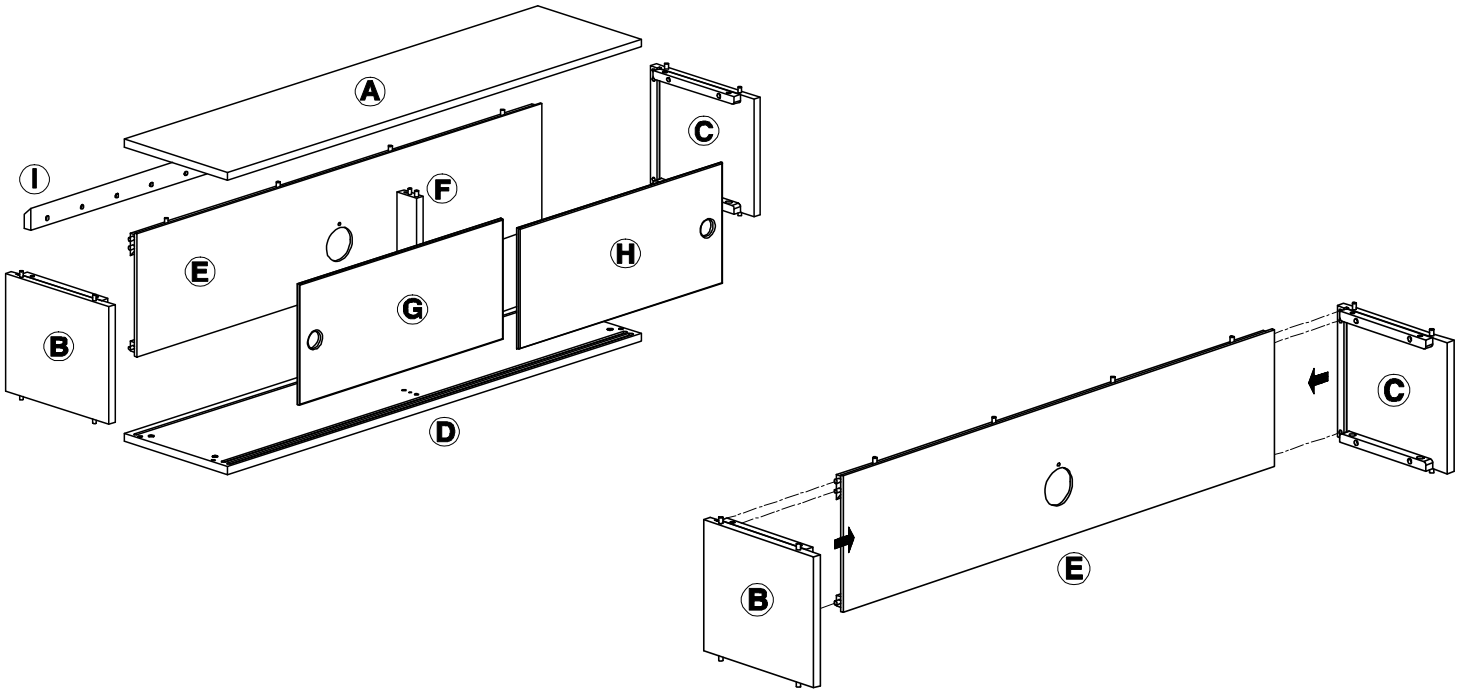

STEP 2

Align the Back Panels (E) and Side Panels (B&C) with the Bottom Panel (D) and press firmly into place. Insert Flat Washer (M), Spring Washer (L) and Bolt (K) as shown. Tighten with supplied Hex Key (J). Do not over-tighten. Locate the holes in the Back Panel (E), insert screws (N) and tighten with a Phillips head screwdriver (not provided).

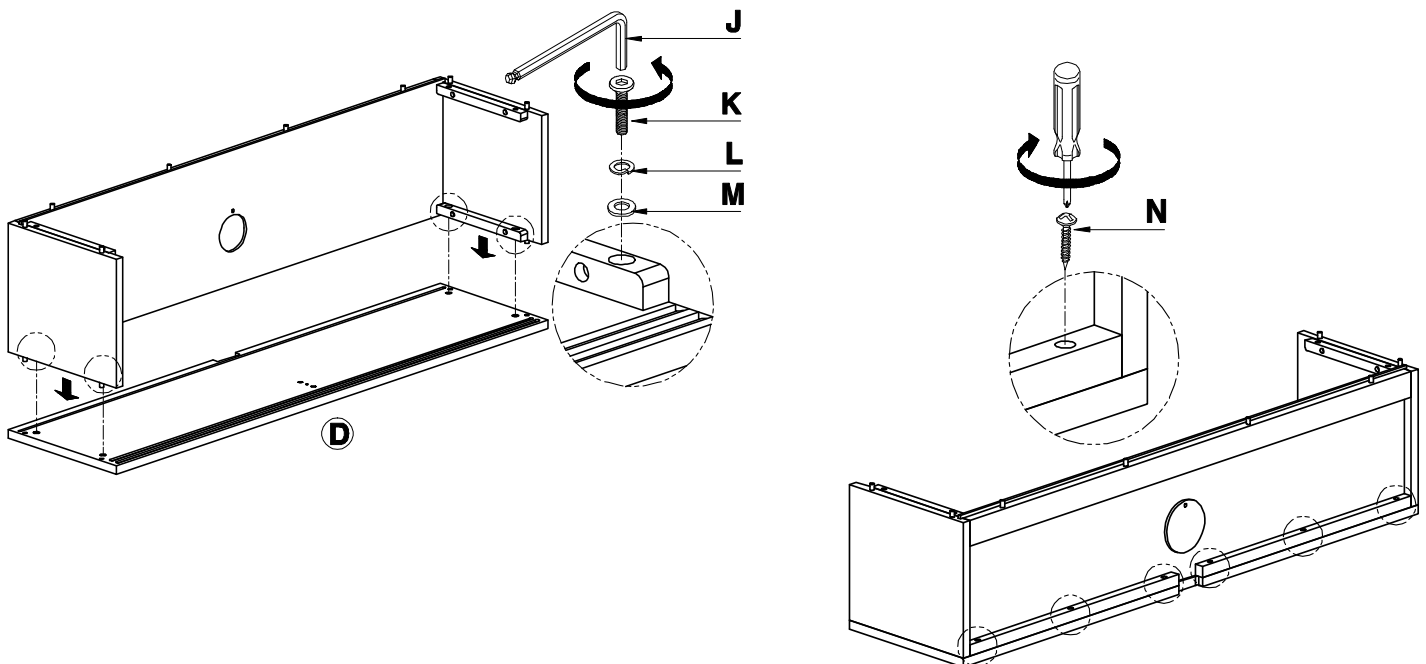

STEP 3

Align the Center Rail (F) to the Bottom Panel (D) and press firmly into place. Place the Top Panel (A) on top of the partially assembled case as shown. Insert the Flat Washer (M), Spring Washer (L), and Bolt (K) through the side panels as shown. Tighten with supplied Hex Key (J). Do not over-tighten. Roll the cabinet onto its back and insert the Screws (N) through the hole in the Bottom Panel (D) and the hole in Center rail (F). Make sure they are in the center of each section and tighten with a Phillips head screwdriver (not included).

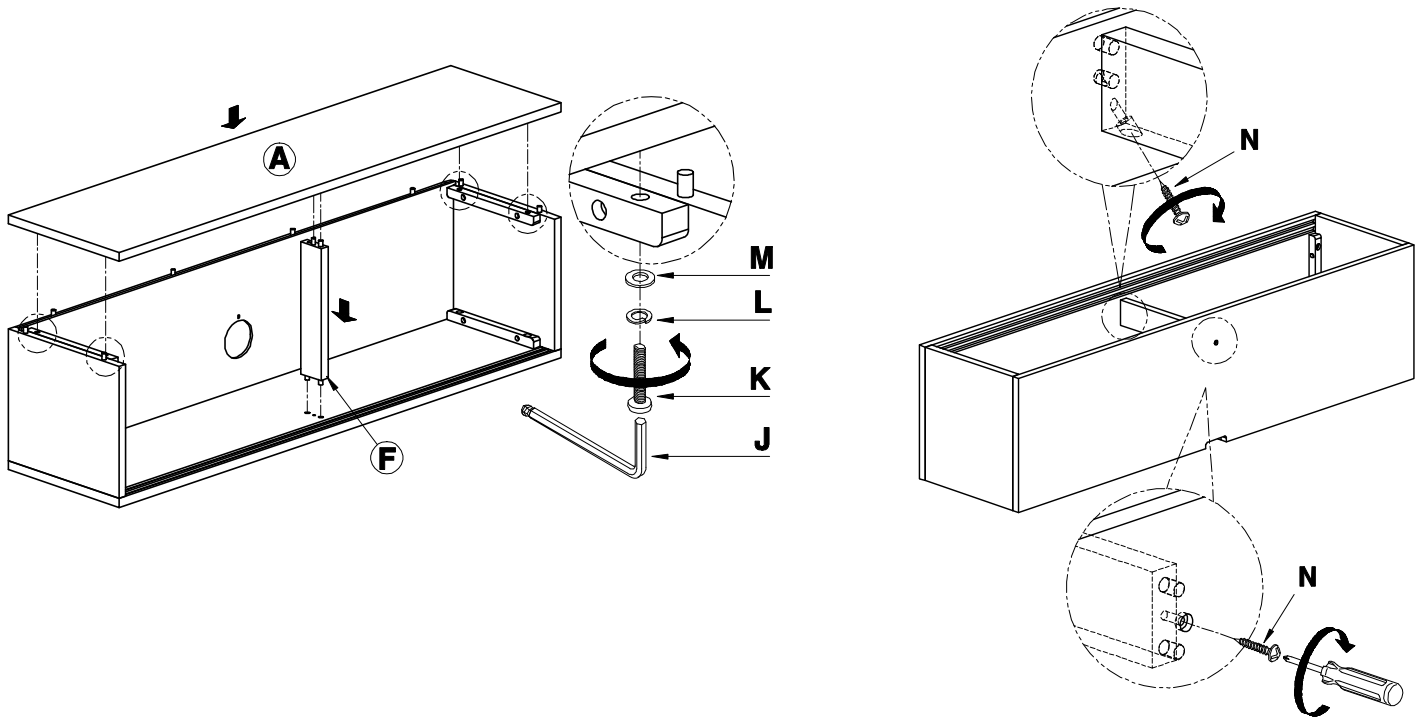

STEP 4

Roll the case back onto its base. Align and insert the Doors (G) and (H) as shown below.

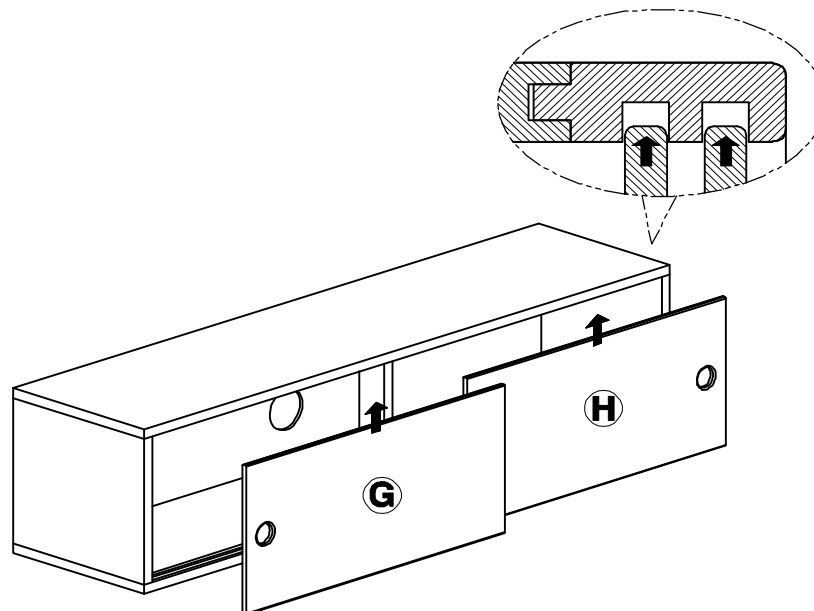

STEP 5

Place the cleat on the wall in its desired location. Ensure the cleat is level and mark the location of the screw holes. If attaching to drywall, screw Metal anchors (O) into the wall at the marked hole locations, then screw Machine screws (P) through the cleat into Metal anchors (O). If screwing into studs, no anchor is required.

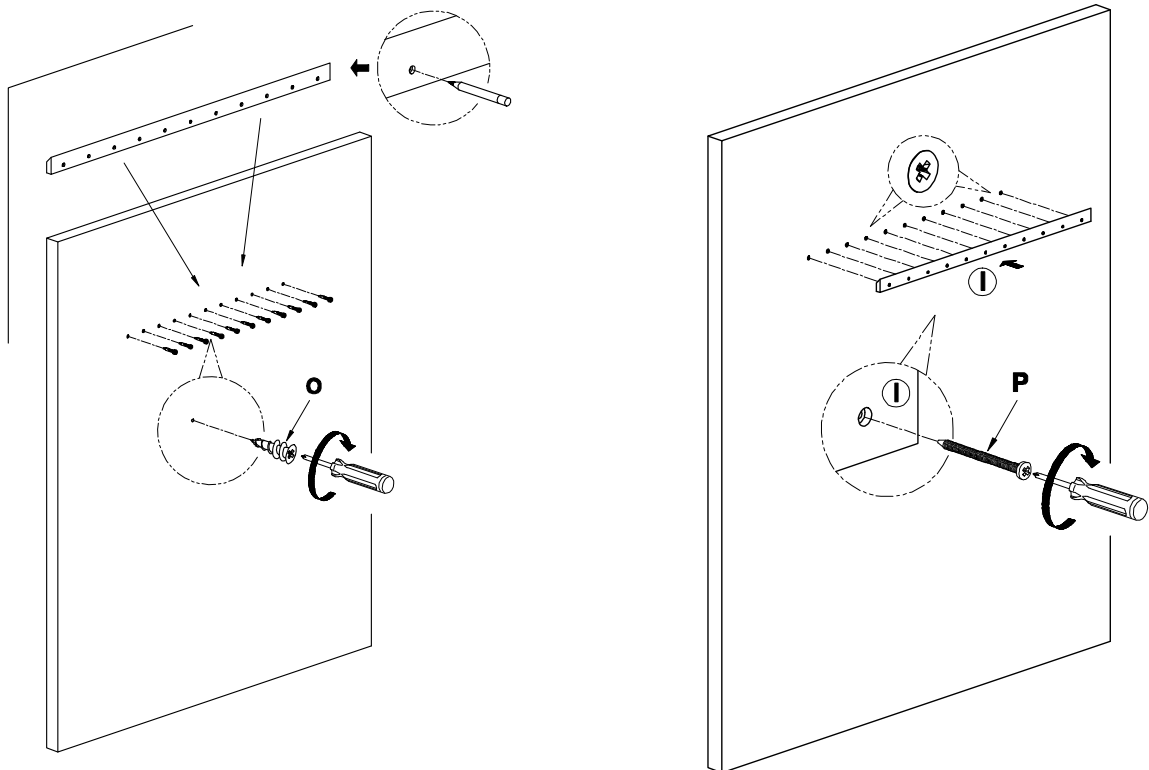

STEP 6

With help hang, the Cabinet onto Wooden French Cleat (I) to complete assembly.

