

# MABELLE 5 DRAWER CHEST

URBAN OUTFITTERS

## Assembly Instructions

### TOOLS REQUIRED BUT NOT INCLUDED:

Phillips Head Screw Driver

Do not throw away packing materials and carton until after assembly.  
Assemble all parts on a clean smooth surface

### CARE INSTRUCTIONS:

Avoid direct exposure to sunlight. Do not place over heat or Air conditioning vents.  
Adjust levelers so that the furniture sits flat on uneven floors.  
Blot spills do not rub, with a clean white cloth.  
Do not use harsh chemicals.  
Before cleaning any part test a small spot in a hidden area.  
You may need to re-tighten all bolts after initial use.

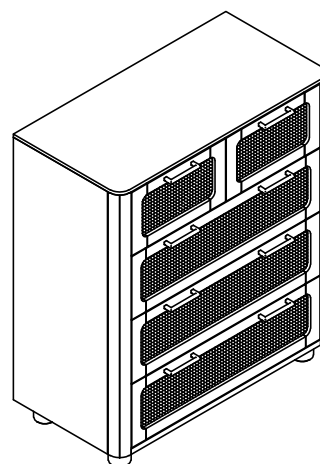

## PARTS INCLUDED



(A) Legs  
Quantity: 4pcs

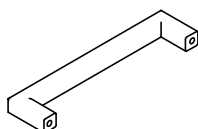

(B) Handle  
Quantity: 8pcs

## HARDWARE LIST

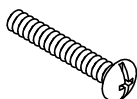

(1) Bolt  
M4 x 25mm  
Quantity: 16pcs

## TIP KIT

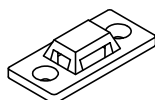

(2) Bracket  
Quantity: 4pcs



(3) Nylon strip  
M4 x 20mm  
Quantity: 2pcs



(4) Screw  
M4 x 20mm  
Quantity: 4pcs



(5) Screw  
M4 x 35mm  
Quantity: 4pcs



(6) Wall plug  
4 x L40  
Quantity: 4pcs

# MABELLE 5 DRAWER CHEST

URBAN OUTFITTERS

## Assembly Instructions

---

STEP 1. Pull the top drawers out and locate the hardware inside.

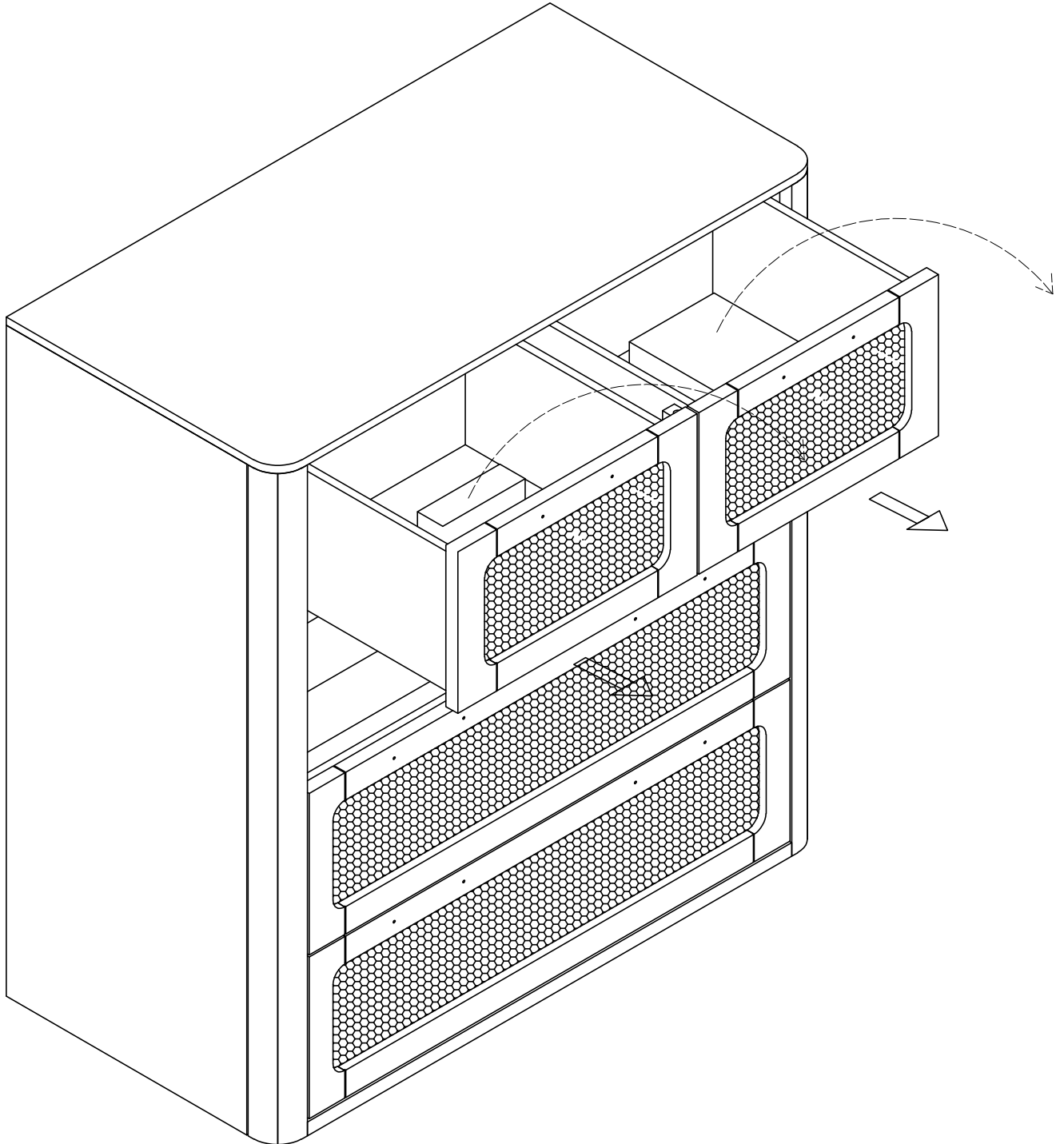

# MABELLE 5 DRAWER CHEST

URBAN OUTFITTERS

## Assembly Instructions

---

STEP 2. With help, lay the chest over and screw in the feet clockwise as shown.

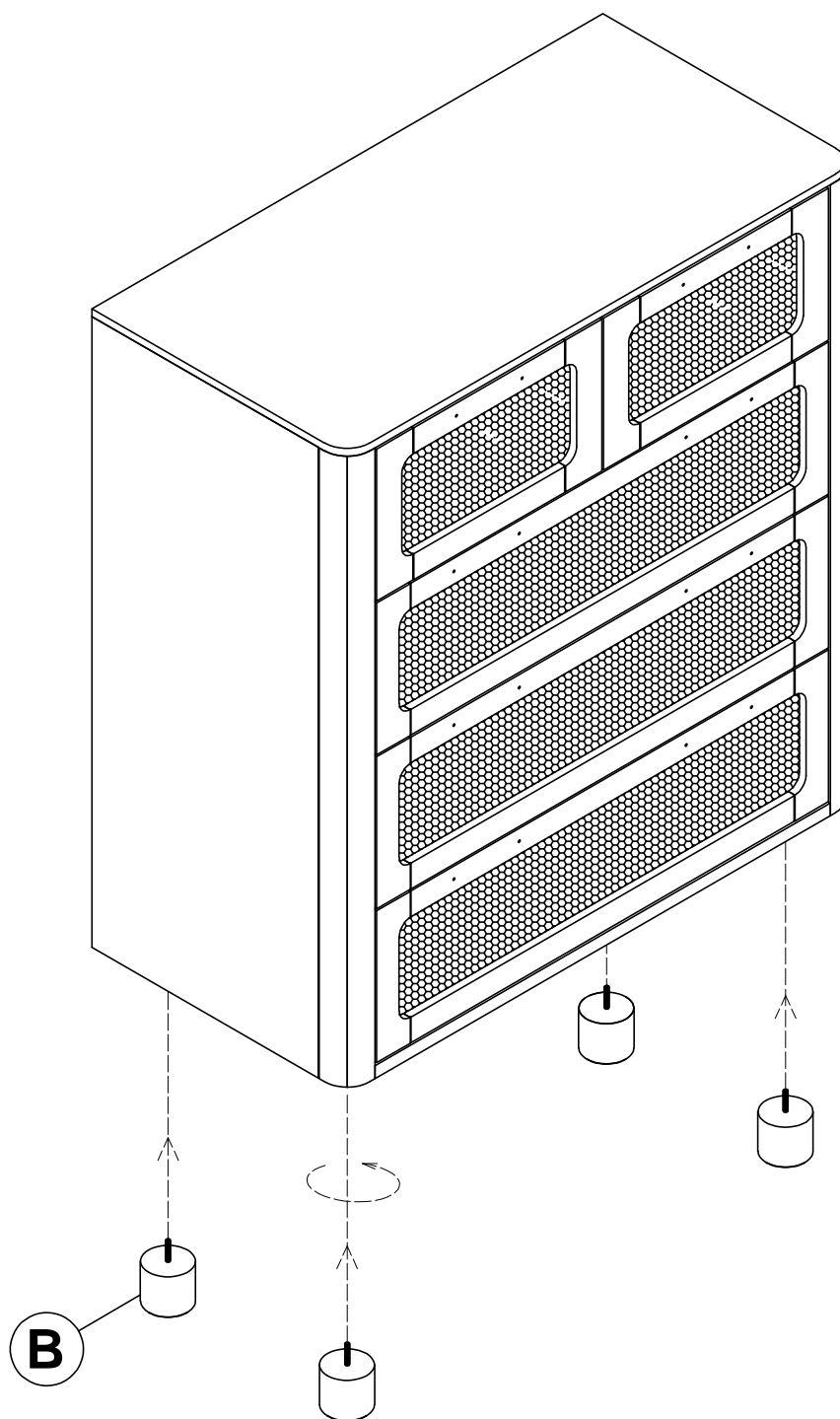

# MABELLE 5 DRAWER CHEST

URBAN OUTFITTERS

## Assembly Instructions

---

STEP 3. Align the handles (B) as shown. Insert the screws (1) from the back and tighten with screwdriver (not provided).

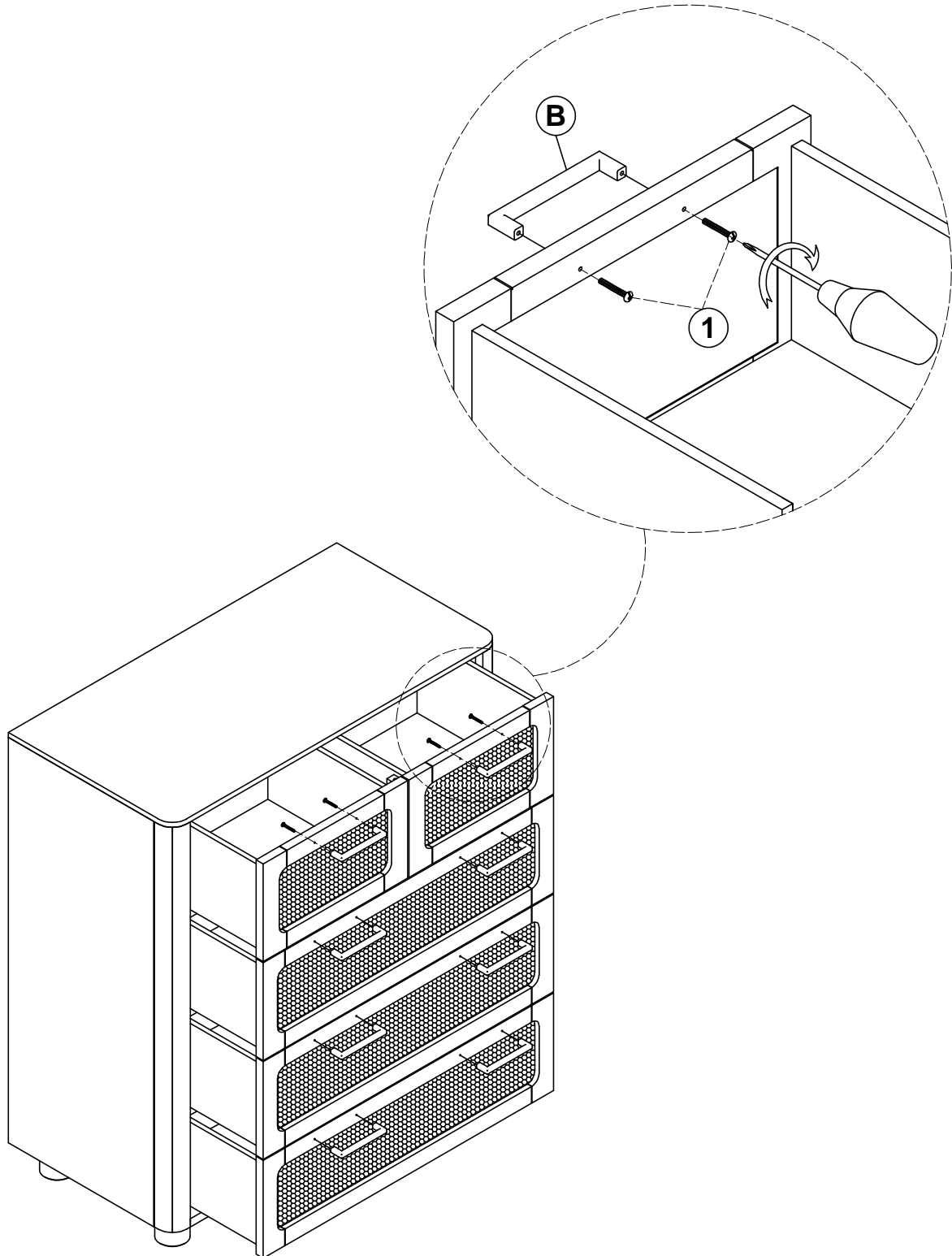

# MABELLE 5 DRAWER CHEST

URBAN OUTFITTERS

## Assembly Instructions

---

STEP 4. Align the anti tip brackets (2) to the top back of the case. Insert screws (4) and tighten completely. Do not over-tighten.

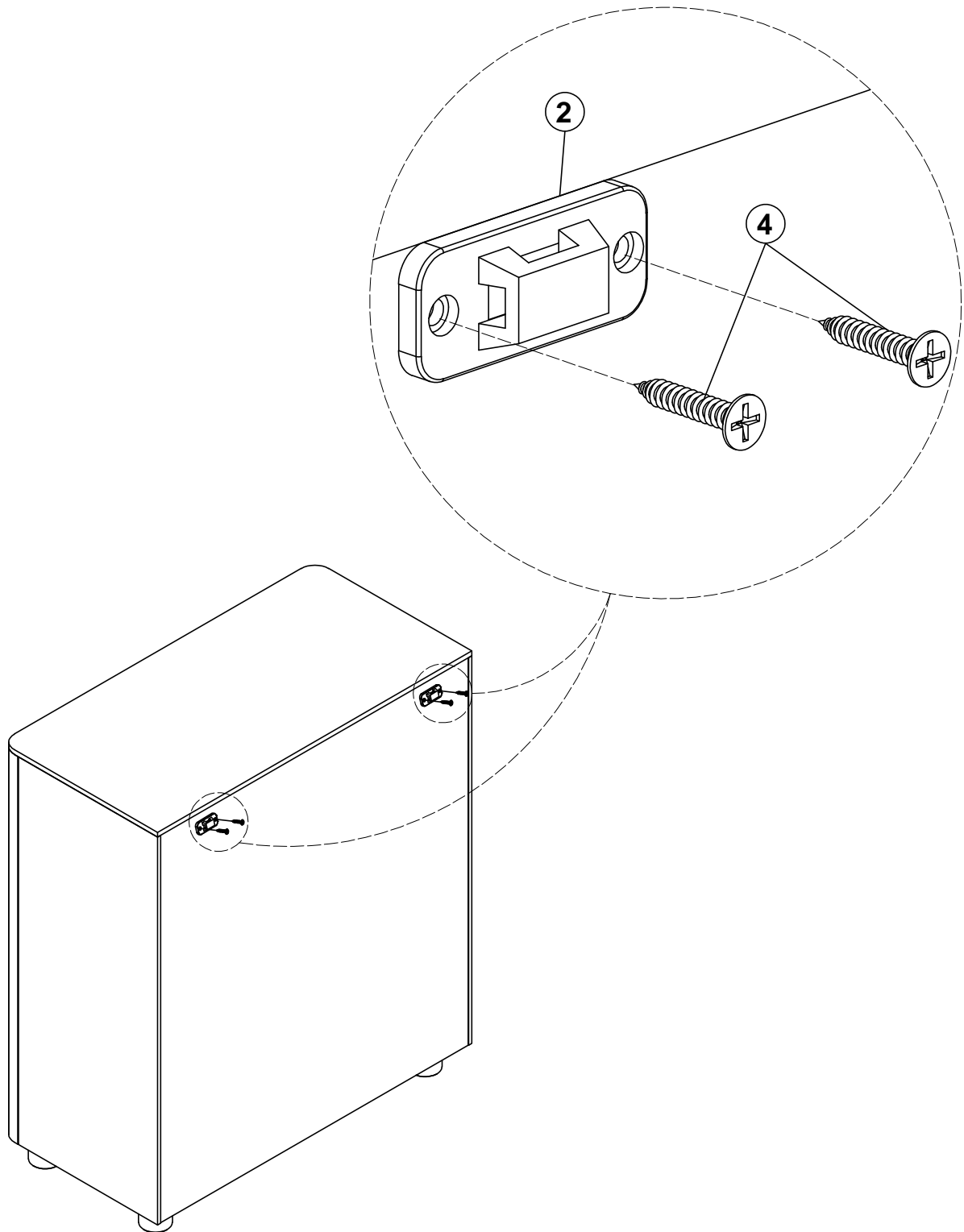

# MABELLE 5 DRAWER CHEST

URBAN OUTFITTERS

## Assembly Instructions

STEP 5. Contact your local hardware store to purchase the correct anchors for your wall-type.

Align the brackets to the wall and make sure they line up with the brackets on the back of the case from step 1.

Screw the brackets to the wall using the correct anchors.

Slide the case to the wall. Leaving a little bit of room between the case and the wall.

Feed the Nylon Strap through both brackets and pull tight.

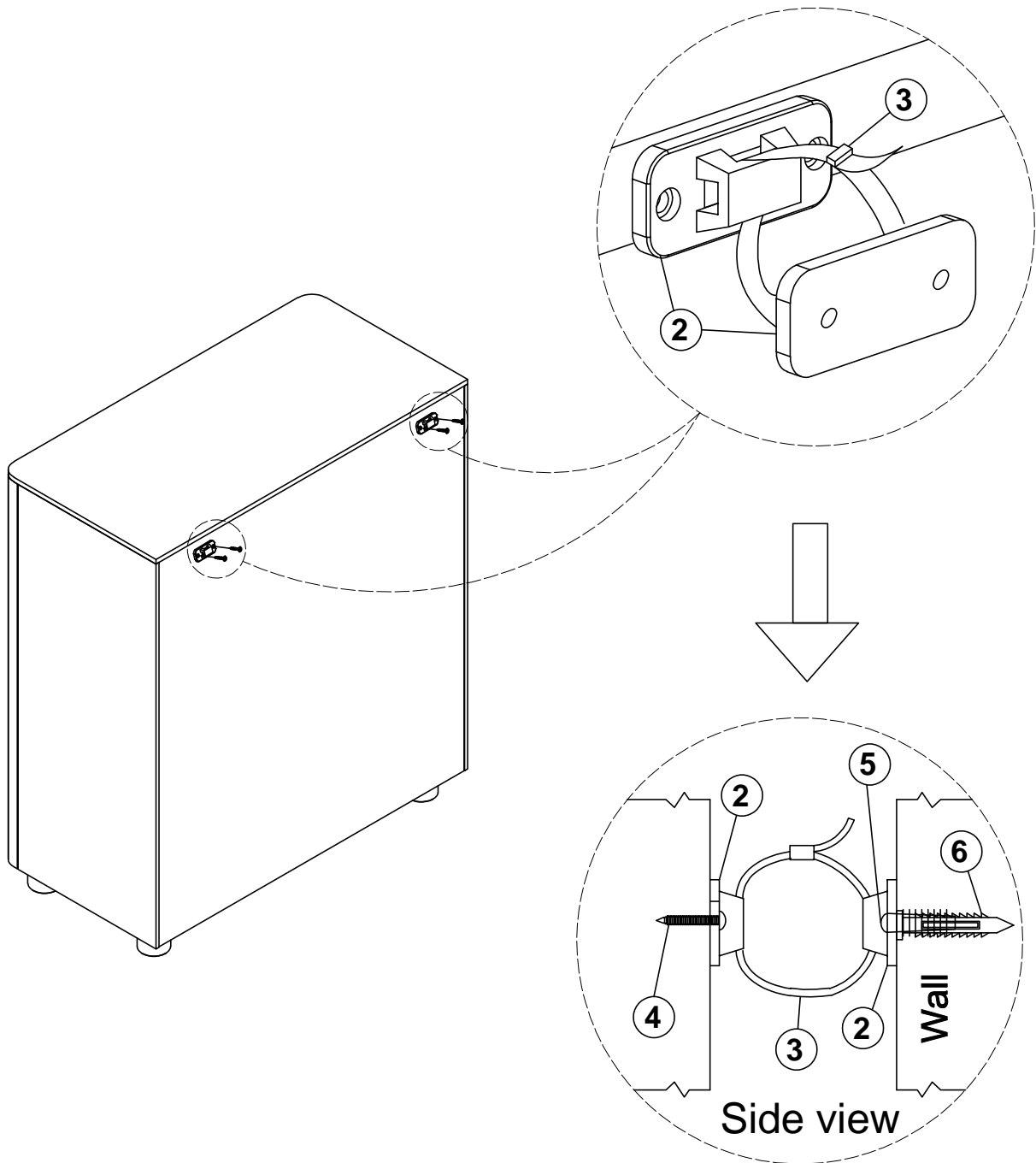

# MABELLE 5 DRAWER CHEST

URBAN OUTFITTERS

Assembly Instructions

FINISH

