

NOVA COFFEE TABLE

Assembly Instructions

URBAN OUTFITTERS

TOOLS REQUIRED BUT NOT INCLUDED:

Do not throw away packing materials and carton until after assembly.

Assemble all parts on a clean smooth surface

CARE INSTRUCTIONS:

Avoid direct exposure to sunlight. Do not place over heat or Air conditioning vents.

Adjust levelers so that the furniture sits flat on uneven floors.

Blot spills do not rub, with a clean white cloth.

Do not use harsh chemicals.

Before cleaning any part test a small spot in a hidden area.

You may need to re-tighten all bolts after initial use.

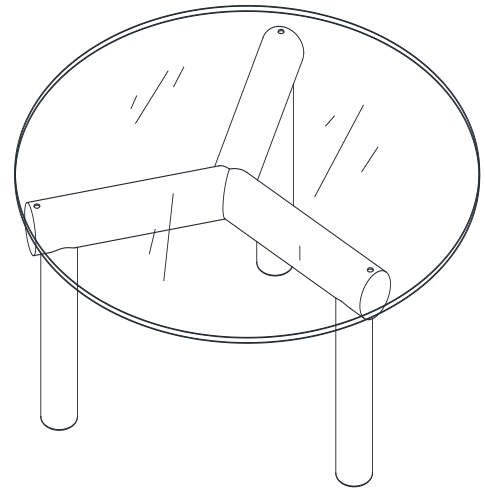

PARTS INCLUDED

A

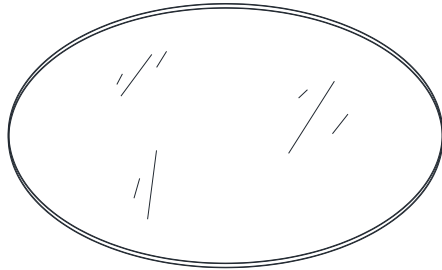

Glass table top 1X

B

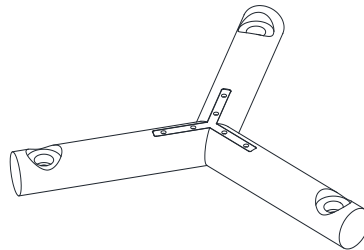

Frame leg 1X

C

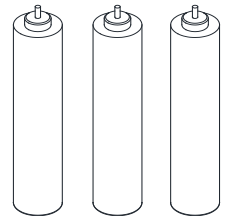

Legs 3X

STEP 1

With help lay the Frame leg (B) and Legs (C) over onto a clean smooth surface such as carpet or cardboard. Locate the holes in the Frame Leg and insert legs. Screw in clockwise to tighten.

Once complete carefully stand the Leg Frame upright without leaning it on the legs as this can damage them. Carefully lay the Glass Table Top (A) down onto the Leg Frame to complete assembly.

You may need to adjust the levelers in the legs to accommodate for uneven flooring.

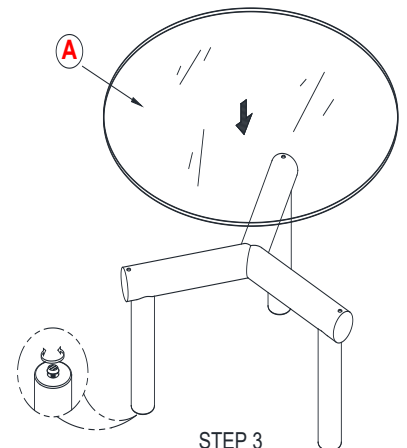
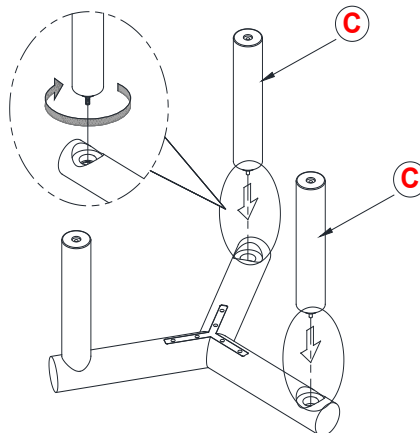
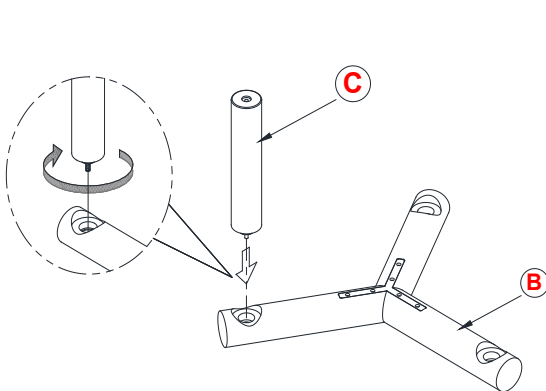

STEP 3