

MARGOT SQUARE MIRROR

URBAN OUTFITTERS

Assembly Instructions

TOOLS REQUIRED BUT NOT INCLUDED:

Screwdriver, Drill, Hammer, Level, Pencil

WARNINGS:

Do not throw away packing materials and carton until after assembly.
Assemble all parts on a clean smooth surface

CARE INSTRUCTIONS:

Avoid direct exposure to sunlight. Do not place overheat or air conditioning vents. Adjust levelers so that the furniture sits flat on uneven floors. Blot spills do not rub, with a clean white cloth.
Do not use harsh chemicals.
Before cleaning any part test a small spot in a hidden area.
You may need to re-tighten all bolts after initial use.



PARTS INCLUDED:



A) Square Mirror

[15.9 x 3.9 x H22"] x1
or
[40.5 x 10x H56 cm] x1

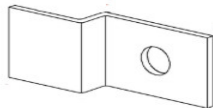

B) Z hook

[0.4 x 0.98 x 0.16"] x2
or
[1 x 2.5 x 0.4 cm] x2



C) Screw

[D 0.35 / 0.19 x 2.32"] x2
or
[D 8.9/4.8 x 59 mm] x2



D) Plastic Anchor

[D 0.35 " x 1.4" Bolt] x2
or
[D 9 x 36 mm] x2

MARGOT SQUARE MIRROR

Assembly Instructions

URBAN OUTFITTERS

STEP 1:

Place the Square mirror (A) on the wall in its desired location. Ensure the square mirror (A) is level and mark the location of the mounting hooks in the rack on the wall. Pre-drill holes for the plastic anchors (D) at the marked hole locations using a drill and use a hammer to tap them into the wall.

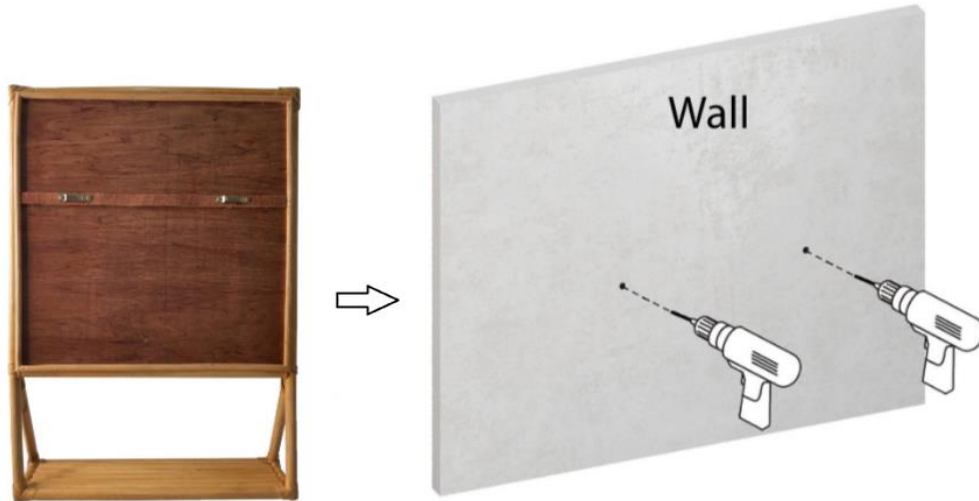

STEP 2:

Place the Z-hooks (B) over the plastic anchors (D) and insert screws (B) as shown. Tighten with a Phillips head screw driver.

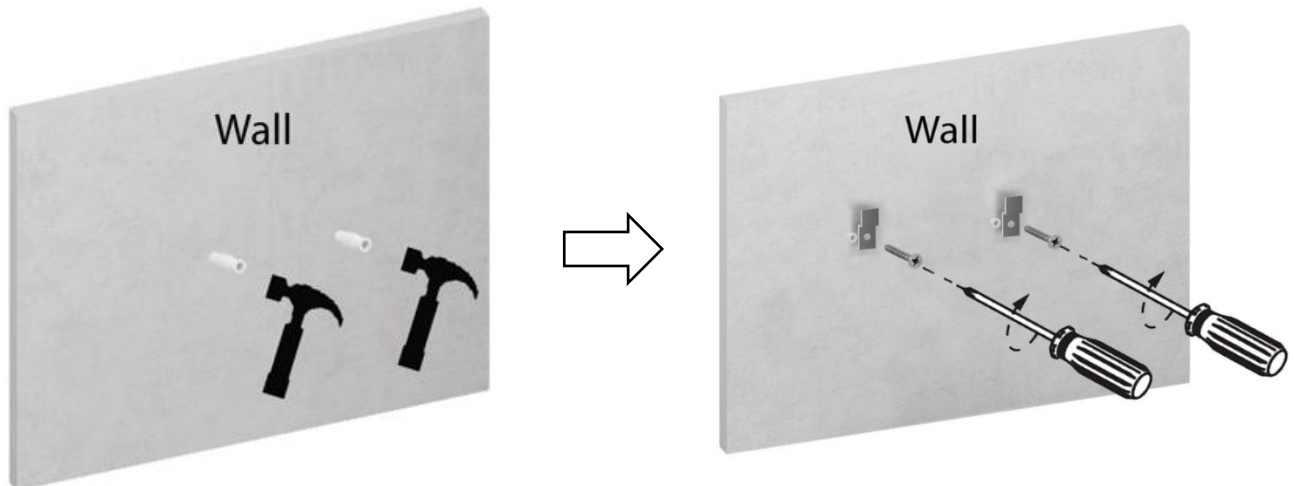

MARGOT SQUARE MIRROR

Assembly Instructions

URBAN OUTFITTERS

STEP 3:

Hang the mirror on the Z hooks to complete the installation.

