

Apple Hook / Furniture Knob

URBAN OUTFITTERS

Assembly Instructions

TOOLS REQUIRED BUT NOT INCLUDED:

Drill, Phillips head screwdriver, Pencil

WARNINGS:

Do not discard packing materials and the carton until assembly is complete.

Ensure all parts are present prior to assembly.

Contact customer service immediately if any parts are missing.

Assemble all parts on a clean, smooth surface.

CARE INSTRUCTIONS:

Avoid direct exposure to sunlight.

Blot spills with a clean, white cloth; do not rub.

Do not use harsh chemicals.

Before cleaning any part, test a small spot in a hidden area.

Do not over-tighten the parts.

The parts may loosen after initial use; re-tighten as necessary.

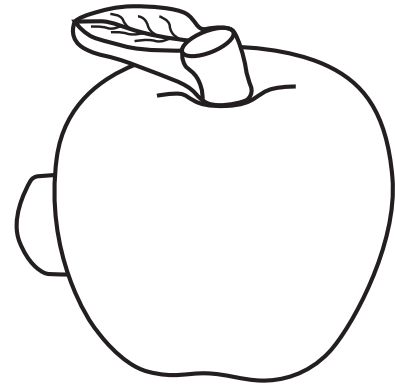

PARTS INCLUDED:

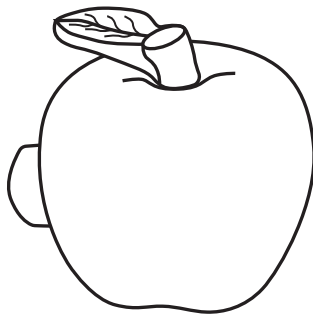

(A) Hook / Knob
x1

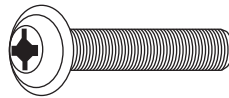

(B) Machine Screw
(for knob installation)
[0.16"Ø x 1.6" L]
or
[4mm Ø, 40mm L]
x1

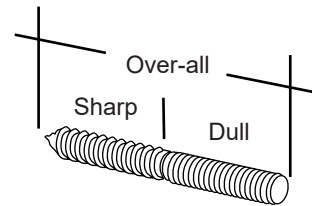

(C) Double sided screw (for hook installation)
[0.16"Ø x 1" L Sharp / .6 Dull; 1.6" over-all]
or
[4mm Ø, 24 mm L Sharp / 16 Dull; 40mm over-all]
x1



(D) Wall Anchor (for hook installation)
[0.35"Ø x 1.38" L]
or
[9Ø x 35 mm]
x1

Knob Installation:

STEP 1 (AS NECESSARY)

Determine a location for the hook / knob (A) and use a pencil to mark the location. Use existing holes if available. If necessary, use a drill bit the same size or no greater than 1/32" or 1 mm larger than the machine screw (B) to make a hole in the door or drawer at the marked location.

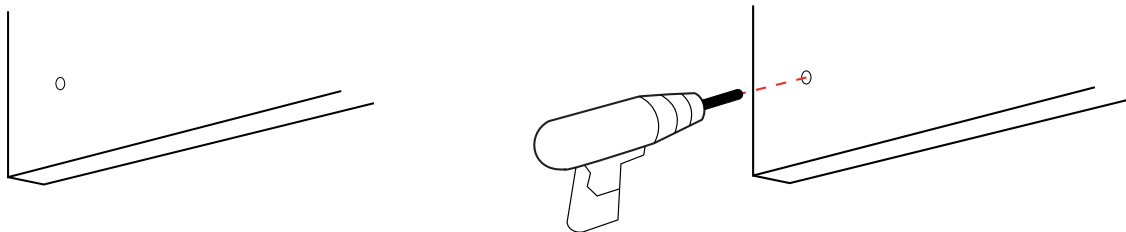

STEP 2

Use a Phillips head screw driver to fasten the hook / knob (A) to the door or drawer with the machine screw (B).

Do not over-tighten the machine screw (B).

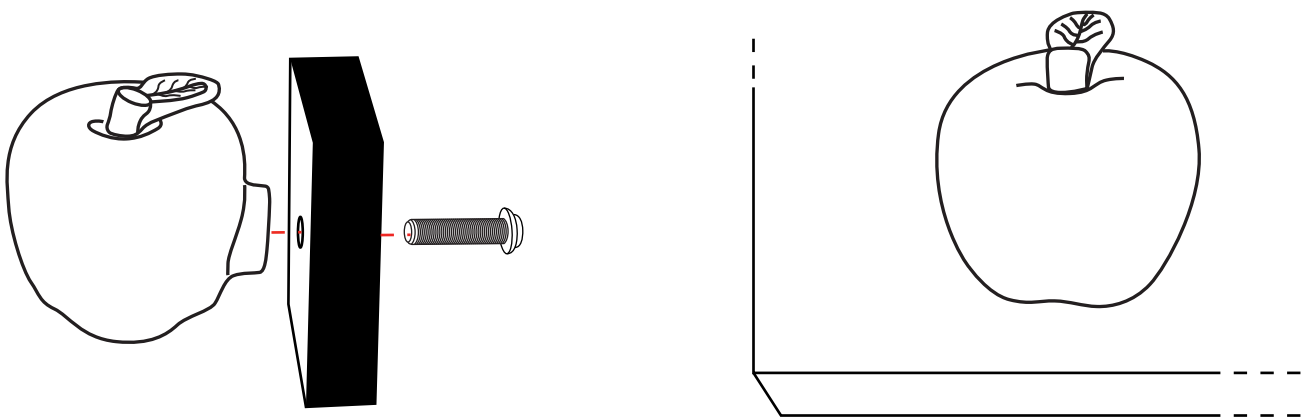

Hook Installation:

STEP 1

Screw the dull end of the double sided screw (C) into the back of the Hook (A).

Do not over-tighten the double sided screw (C).

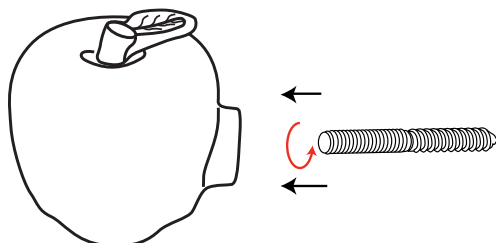

STEP 2

Use a pencil to mark the wall at the chosen location of the hook (A).

Stud installation:

Pre-drill a hole for the double sided screw (C) in the wall at the marked location. Use a drill bit ~ 1/16" or 1.5mm smaller than the double sided screw (C) to make the hole. Carefully screw the assembled hook (A) into the wall clockwise to finish the installation.

Do not over-tighten the hook (A).

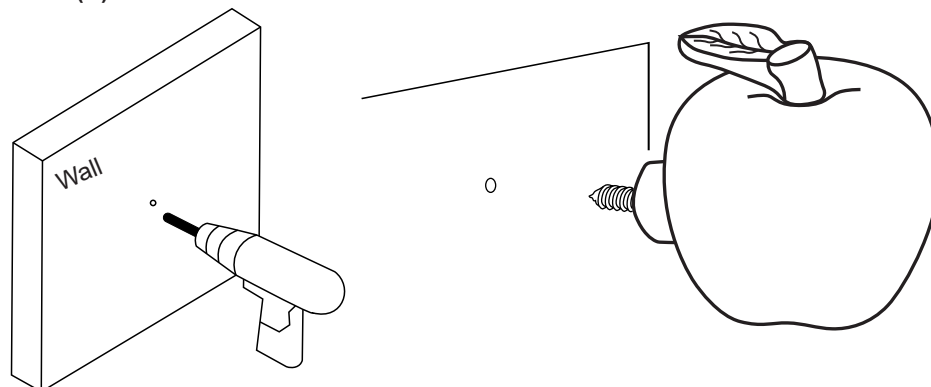

Drywall installation:

Pre-drill a hole for the anchor (D) in the wall at the marked location and insert anchor (D) into the hole using a hammer. Use a drill bit 1/32" or 1mm smaller than the anchor (D) to make the hole. Screw the assembled hook (A) into the anchor (D) clockwise to finish the installation.

Do not over-tighten the hook (A).

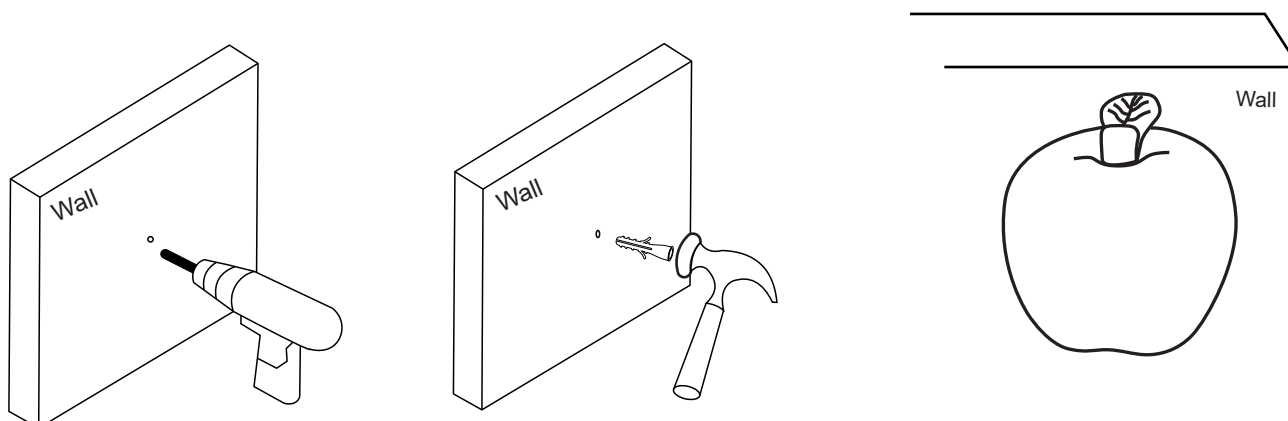

The included hardware is intended for attachment to drywall or wooden wall surfaces, contact your local hardware store to find the correct anchor for alternative wall-types such as stone or brick.