

LUCIE ENTRYWAY STORAGE

Assembly Instructions

URBAN OUTFITTERS

TOOLS REQUIRED BUT NOT INCLUDED

Drill, Phillips head screwdriver, Hammer, Pencil

WARNINGS:

At least two people recommended for assembly
Do not throw away packing materials and carton until after assembly.
Ensure all parts are present prior to assembly.
Contact customer service immediately if parts are missing.
Assemble all parts on a clean smooth surface
Do not drag the table while moving.

CARE INSTRUCTIONS:

Avoid direct exposure to sunlight.
Do not place overheat or air conditioning vents.
Adjust levelers so that the furniture sits flat on uneven floors.
Blot spills with a clean white cloth, do not rub.
Do not use harsh chemicals.
Before cleaning any part test a small spot in a hidden area.
You may need to re-tighten all bolts after initial use.

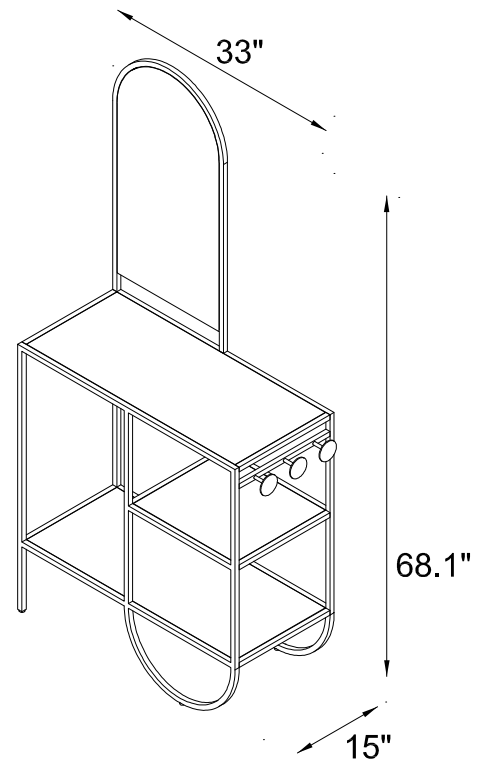

PARTS INCLUDED

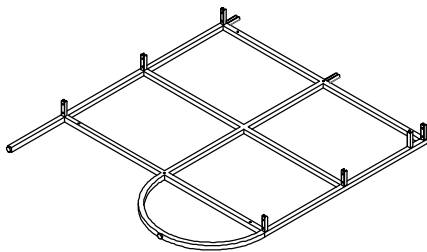

A) Metal Back Frame

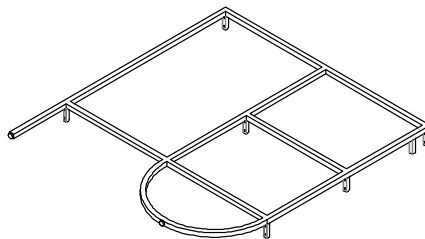

B) Metal Front Frame



C) Cross Rails x6



D) Knobs

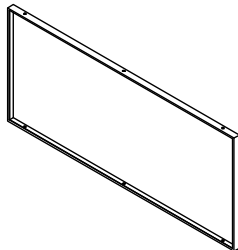

E) Top and Bottom Shelf x2

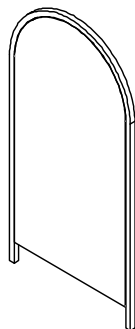

F) Mirror

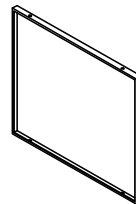

G) Middle Shelf



H) Bolt [M5xL10mm]
x 48

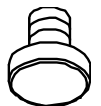

I) Adjustable Levelers
x 4



J) Allen Key

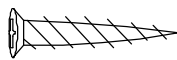

K) Wall Screw [4x32]
x2



L) Drywall Anchor x2

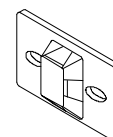

M) Anti-tip Kit



N) Nylon Strap

LUCIE ENTRYWAY STORAGE

Assembly Instructions

URBAN OUTFITTERS

STEP 1

Lay down all the parts on a clean carpet or cardboard for assembly. Remove plastic protective caps from metal back frame (A). Attach cross rails (C) and Knobs (D) to metal back frame (A) and insert bolts (H) as shown. Partially tighten bolts (H) with Allen key (J). Once all bolts are inserted and partially tightened, fully tighten the bolts. Screw adjustable levelers (I) into metal back frame (A).

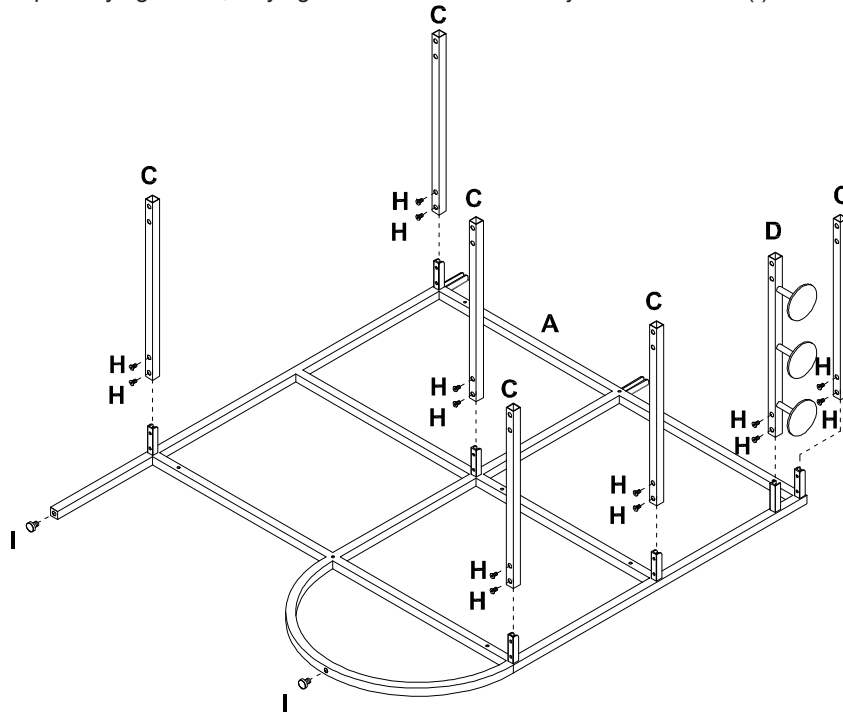

STEP 2

Align the shelves (E), and middle shelf (G) with metal back frame (A), then insert bolts (H) as shown. Partially tighten bolts (H) with Allen key (J). Once all bolts are inserted and partially tightened, fully tighten the bolts.

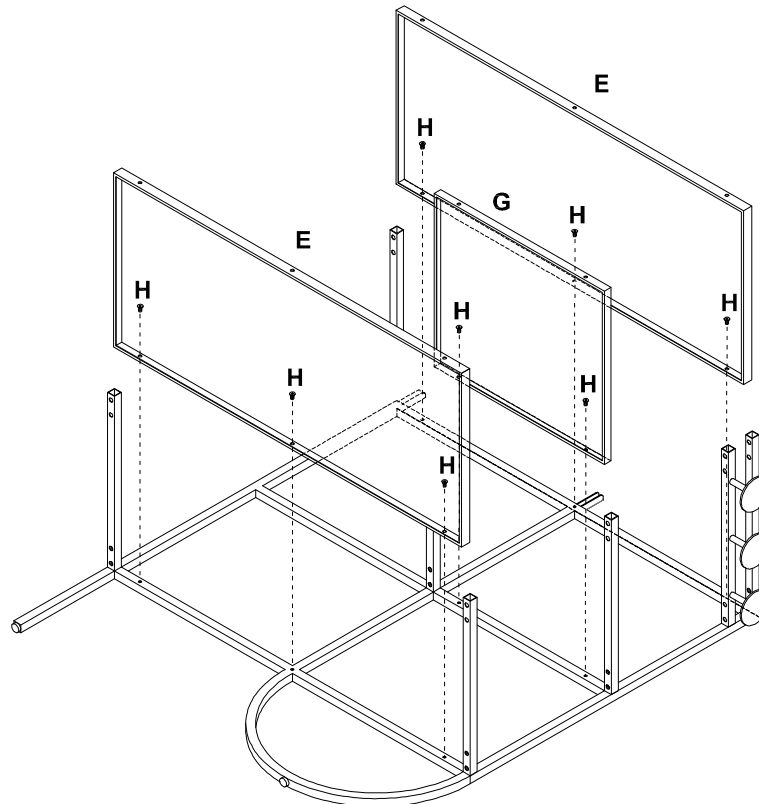

LUCIE ENTRYWAY STORAGE

Assembly Instructions

URBAN OUTFITTERS

STEP 3

Align metal front frame (B) with the partially assembled shelf and insert bolts (H) as shown. Partially tighten bolts (H) with Allen key (J). Once all bolts are inserted and partially tightened, fully tighten the bolts. Screw adjustable levelers (I) into metal front frame (B). With help, flip the shelf upright.

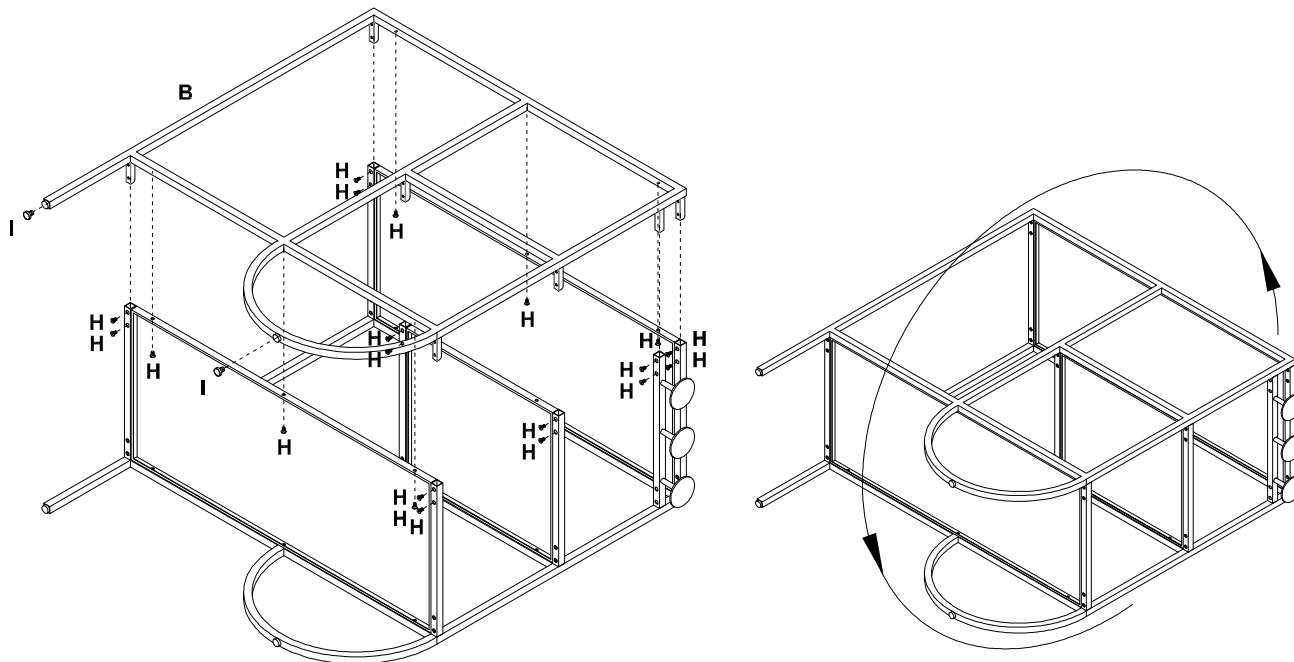

STEP 4

Attach mirror (F) to the partially assembled shelf and insert bolts (H) as shown. Partially tighten the bolts (H) with Allen key (J). Once all bolts are inserted and partially tightened, fully tighten the bolts.

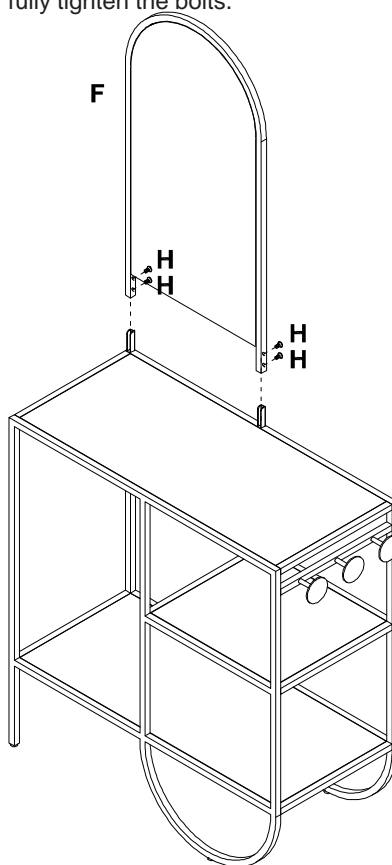

LUCIE ENTRYWAY STORAGE

Assembly Instructions

URBAN OUTFITTERS

STEP 5

Place the entryway storage against the wall in its desired location then, place the tip kit on the wall below the table top and mark the location of the hole in the anti tip bracket (M) on the wall.

Wood or Stud Installation:

Insert screws (K) through the anti-tip bracket (M) into the wall and tighten with a Phillips head screwdriver.

Drywall Installation:

Attach the drywall anchor (L) to the wall at the marked location using a drill and hammer. Insert screw (K) through the anti-tip bracket (M) into the drywall anchor (L) and tighten with a Phillips head screwdriver.

STEP 6

Feed the Nylon strap (N) through the anti-tip bracket (M) and around the entryway storage then, pull the nylon strap tight.

STEP 7

Adjust the levelers as necessary to accommodate uneven floors.

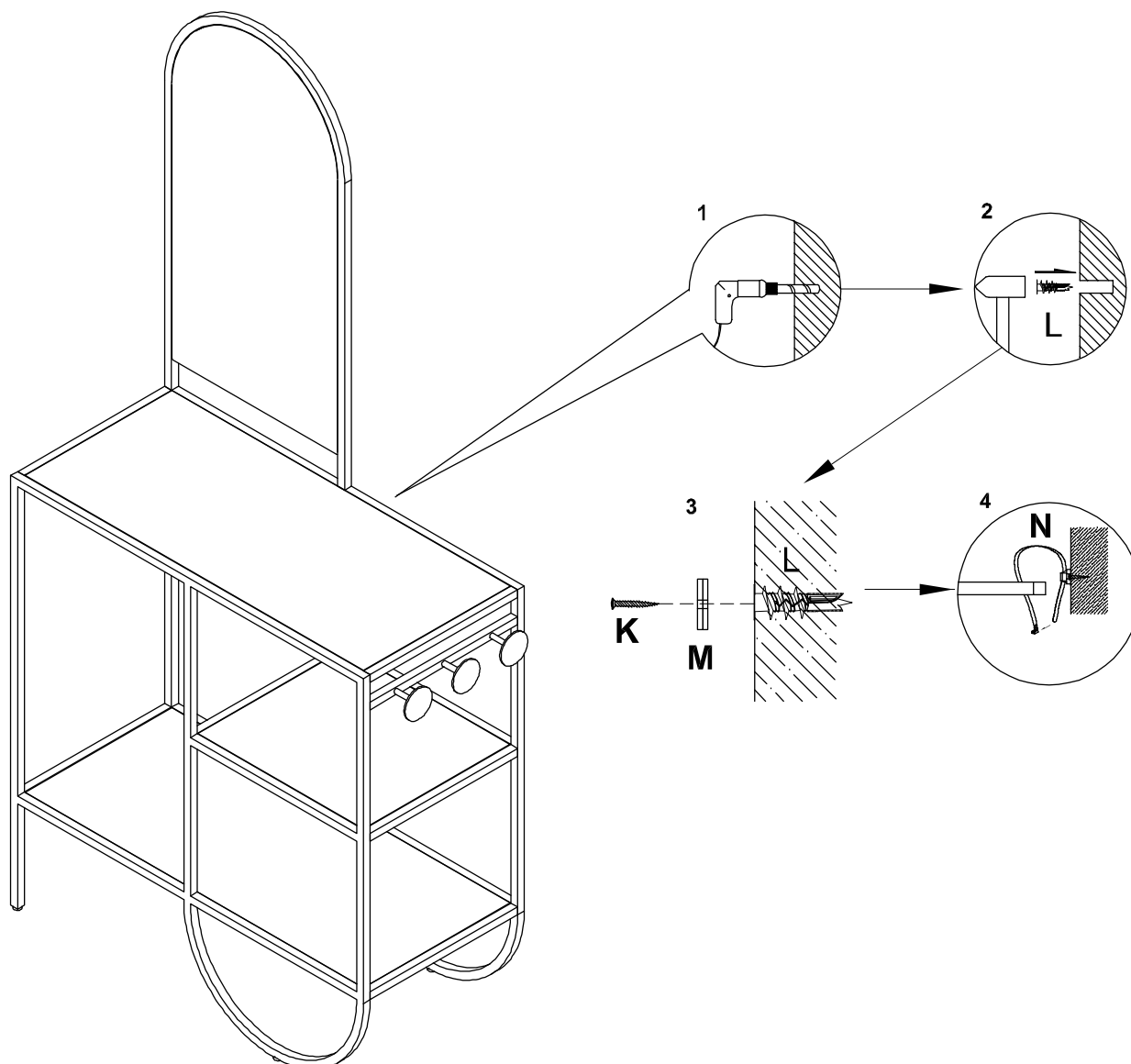

Warning: Young children may be injured by tipping furniture and the use of a tipping restraint is highly recommended. The tipping restraint is only a deterrent it is not a substitute for proper adult supervision.

EXCLUSIVE AND CONFIDENTIAL PROPERTY OF URBAN OUTFITTERS, INC. © 2017 UO, Inc.
All rights reserved, including all applicable copyright, design and patent rights.
Any unauthorized reproduction, adaptation, distribution or other infringement will be prosecuted.