

Vodafone TV

Quick Start Guide

Product Safety Information



Index

3	Box Contents
4	Quick Start Guide
12	Product Safety Information

Box Contents

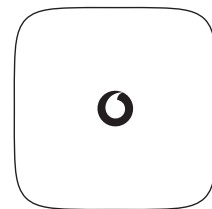

Vodafone TV

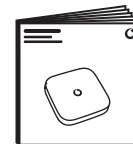

Quick Start Guide & Product Safety Information

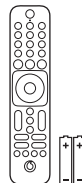

Remote Control Unit
with 2 AAA batteries



Ethernet Cable



HDMI Cable



Power Supply Unit

To access the user manual, go to:
<https://n.vodafone.ie/support/tv-hub.html>



Your Vodafone TV explained

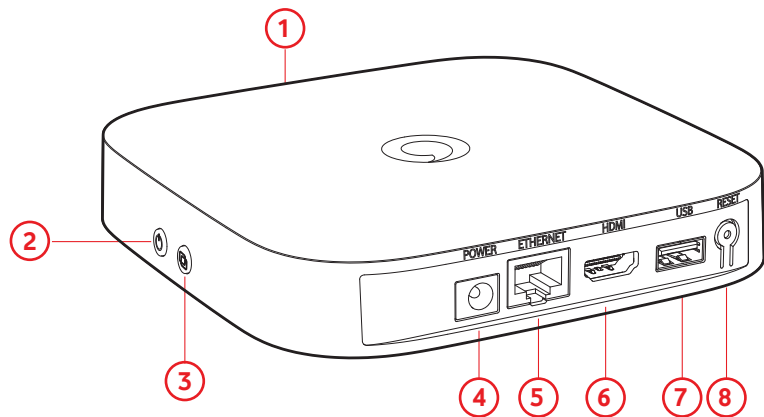

- 1** Front LED
- 2** Standby button
- 3** WPS button
- 4** Power adaptor port

- 5** Ethernet port
- 6** HDMI® port
- 7** USB port
- 8** Reset Button

Connect your Vodafone TV

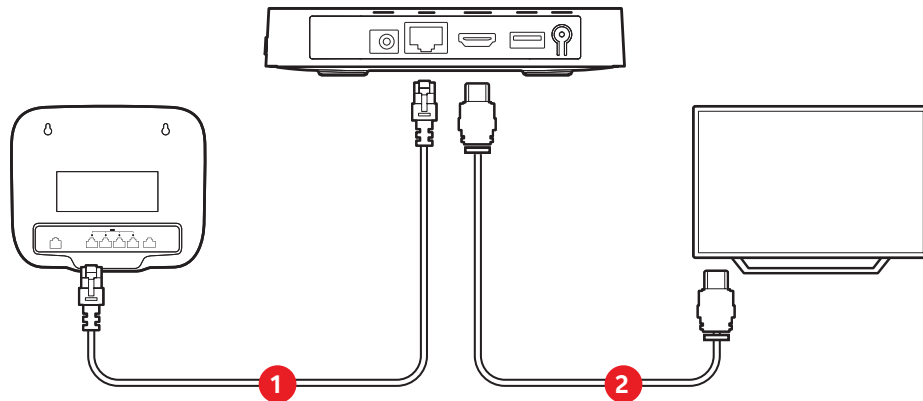

- 1** Connect the supplied ethernet cable to the "ETHERNET" port of your Vodafone TV and then to one of the free ethernet ports of your router. In case you would like to set up your Vodafone TV via Wi-Fi, please follow the first-time installation process on your TV screen.

- 2** Connect the supplied HDMI cable to the "HDMI" port on your Vodafone TV and then to an available HDMI port on your TV set. To get the best 4K UHD experience connect to the connector marked "ARC".

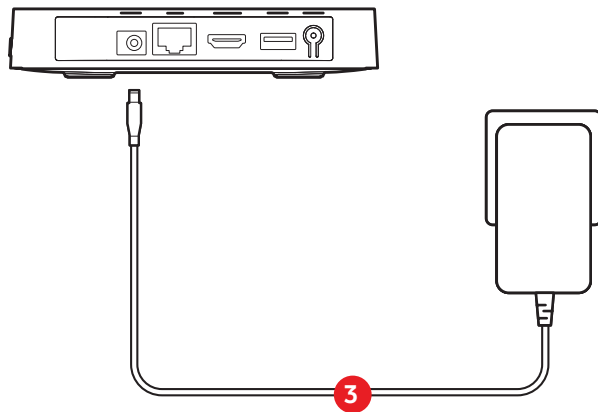

- 3** Connect the supplied power adapter with the "POWER" port of your Vodafone TV and with an electrical socket. The Vodafone TV will now boot up into the first installation process.

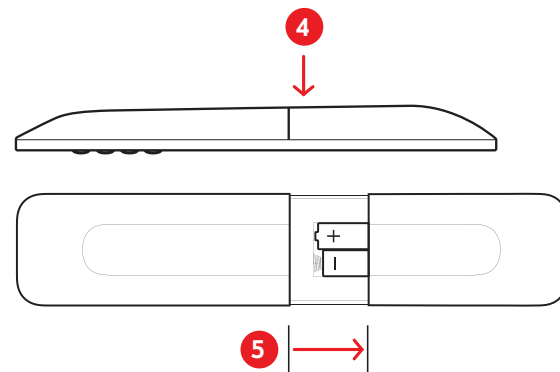

- 4** Please open the battery compartment at the back of your remote by pressing the cover downwards and place the batteries inside in order to use the remote control.
- 5** Place the supplied 2xAAA batteries in the remote control. The ring around the power button of the remote will

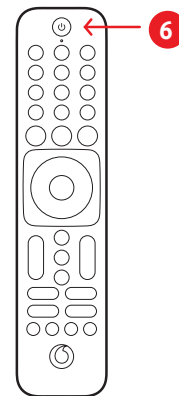

- blink and let you know it is ready to use.
- 6** Use the Power button on the remote control to switch on the Vodafone TV or set it back into standby mode.

LED states and their meaning

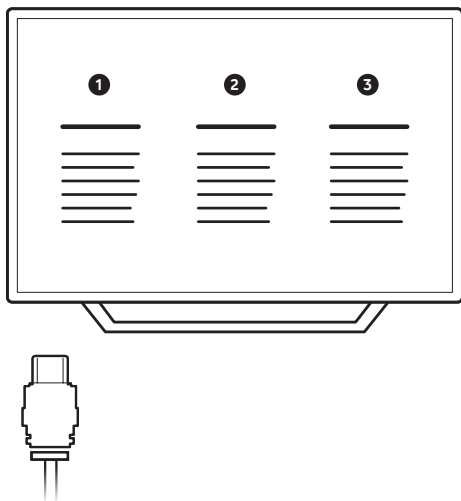

7 Ensure your TV is displaying the output of the previously selected HDMI source in step 2. For example if you plugged into the HDMI 1, you should have the output HDMI 1 displayed.

8 Now complete the first-time installation process by following the steps shown on your TV screen.

i To disable Wi-Fi, simply connect an Ethernet cable between your Vodafone TV and your router and select LAN connectivity in the your Vodafone TV settings menu.

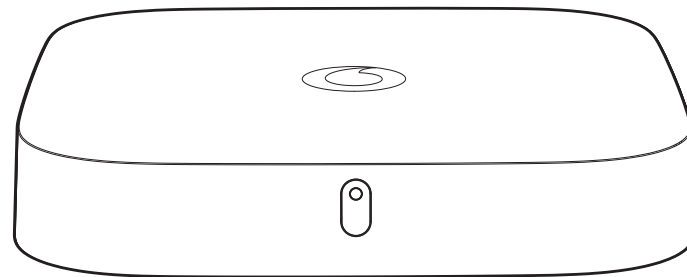

○ **Constant white light**

Device on

○ **Single white light blink**

Remote control button pressed

● **Constant red light**

Device in stand-by



Red light pulsing slowly

Firmware update or factory reset.



Fast flashing red light

Error

If you need help?



You'll find lots of helpful information at:
<https://n.vodafone.ie/support/tv-hub.html>



Or if you'd prefer, you can call us free from a landline or Vodafone mobile on
VF 1907

Calls from other mobiles are charged at your standard network rate.

Safety information, Regulations and Licenses



ATTENTION! READ INSTRUCTIONS BEFORE USE.

BEFORE ANY OPERATION IS PERFORMED, PLEASE READ THE PRODUCT'S OPERATING INSTRUCTIONS AND THE FOLLOWING SAFETY PRECAUTIONS CAREFULLY TO MINIMISE THE POSSIBILITY OF ACCIDENTS.

1.0 General

1.1 Why are we giving you these instructions

Your equipment is an electrical appliance running off the electricity in your home. You should therefore take all the necessary precautions in use to ensure complete safety when plugging the power supply unit into the mains or into your appliance. Make sure that the lead of the power supply is properly inserted into the appliance. If it is incorrectly connected this may cause a risk of fire or electric shock.

1.2 The components of your appliance

1. A power supply.
2. The appliance itself, and connection cables (if applicable).
3. A remote control

You must only use the power supply unit provided. Connect it to the mains following the instructions given below. As a precaution, in case of danger, the power supply unit acts as a cut-out for the 220V supply. It should be positioned near the appliance and be easily accessible.

1.3 The product label and markings

There is an identification label under the product, and markings directly on the product. Consult these for voltage and current information, as well as type of current your appliance is designed for.

2.0 Installation

2.1 Pre-requirements

Never open the power supply unit! There is a risk of electric shock. Any work on the appliance must be carried out by a qualified person. Unplug the appliance from the mains before installing or modifying connections to other equipment (television, VHS recorder, DVD player etc.) or before any cleaning of your appliance.

2.2 The installation environments

Optimising reception by reducing interference

Do not place the appliance near equipment likely to emit electromagnetic interference (e.g. loudspeakers). This can interfere with the working of your appliance and cause distortion of the sound and picture.

2.3 Power supply unit

Use only the power supply unit supplied with the appliance. Never use any other adapter; doing so may cause the appliance to malfunction. Never place objects on top of, walk on, or pass a wheeled appliance over the power supply unit.

You may damage it and cause a risk of fire or electric shock. Placing the power supply unit incorrectly may cause disconnection of the power supply to the unit and may cause a risk of fire or electric shock. Make sure that the power supply unit is out of reach of children or pets.

Before connecting the power supply unit to the appliance, we recommend connecting all the potential peripherals you want to connect (eg HDMI cable). Always plug the power supply unit into your appliance first, then the power supply into the mains socket.

Never connect your appliance to a socket that has come loose or is damaged or defective - you may receive an electric shock.

Never touch the power supply unit with damp or wet hands. You may get an electric shock. When you plug or unplug the power supply unit, always hold it by the transformer. A damaged lead is a potential source of fire or electric shock. **Never pull by the lead to unplug the appliance from the mains socket.**

You must connect the power supply unit to the appliance before plugging it into the mains socket. Make sure the lead is properly plugged into the socket on the appliance. If it is not properly plugged in, there is a risk of fire or electric shock when touching the appliance.

Never place objects on the mains lead, never pull on it and never bend it. This could cause a risk of fire or electric discharge. Always make sure the appliance is not standing on the mains lead or any other cable.

If there is any suspicious noise coming from the mains socket or mains lead, unplug the power supply unit from the mains socket with all necessary precautions - you may get an electric shock. Contact Vodafone.

2.4 The appliance

Install the appliance indoors, out the way of direct sunlight; ensure the appliance always avoids extreme temperatures. Use the appliance in an environment where the following conditions apply:

- Ambient temperature: between **0 °C and 45 °C**,
- Ambient humidity: between **20% and 90%**,
- Altitude: **2000 metres** maximum.

Install the appliance and the power supply unit in a dry and ventilated place. Protect them from moisture and dust.

Connect the appliance to the power supply according to product marking and documentation, and the information on the product label. Only use the power supply unit and the cables supplied with the appliance.

Software updates will be performed automatically on your device, provided it remains connected to an active power outlet and has access to the internet (via Wi-Fi or network cable to the Gateway).

Keep the appliance and power supply unit away from sources of heat such as radiators or gas/electric heaters. Do not place incandescent objects such as candles on the appliance.

Do not place any object such as a piece of fabric or paper over the appliance. If you place your appliance in a compartment, leave a minimum space of 10 cm on either side and 20 cm in front of and behind the appliance. To avoid short-circuits (with a risk of fire or electric shock), keep your appliance away from any damp. Do not place any object containing a liquid (such as a vase) on the appliance. If any liquid meets your appliance (drops, splashes), it will damage it and may cause irremediable breakdown. If liquid does enter the appliance, unplug it immediately from the mains and contact Vodafone.

If placed in direct contact with a heat-sensitive piece of furniture, product may alter its colour or surface.

Apparatus connected to the protective earthing of the building installation through the MAINS connection or through other apparatus with a connection to protective earthing – and to a television distribution system using coaxial cable, may in some circumstances create a fire hazard.

The Ethernet port is intended to be connected to indoor cable circuits that are exclusively located within the building where the appliance is installed, and that are not earthed to a different earthing network.

3.0 Using the appliance

3.1 The appliance

If there is a thunderstorm, we advise you to unplug the aerial and mains lead. Even if the appliance and the television are disconnected from the mains, they may still be damaged by lightning.

Avoid any mechanical shocks: do not use the appliance if it is damaged. Always place your appliance on a flat surface where there is no danger of being jolted.

Clean the appliance, the mains unit or adapter only with a soft, dry cloth. Never use detergents or chemical additives.

3.2 The batteries or rechargeable batteries and the remote control

Your appliance is delivered with a remote control and its batteries. Before replacing the batteries of your remote control, read the label in the battery compartment of the remote control. It tells you what type of batteries (voltage, size) to buy as replacement.

The batteries or rechargeable batteries (battery block or installed batteries) must not be exposed to excessive heat such as the sun, a fire or similar sources.

In all cases, keep the remote control out of the reach of children: the batteries more likely to be swallowed by a child. Do not therefore leave the remote control unattended.

WARNING: Danger of fire or explosion if batteries are not replaced correctly. Replace them only with the same type of batteries as initially supplied.

To recycle batteries, see section “Batteries”.

3.3 Ancillary equipment (if applicable)

All the connections are indicated in the documentation delivered with your appliance; you must read it before using the appliance.

Only hand-tighten connectors; do not use any tools. You are likely to damage the connectors if you tighten them too hard. This can cause distortion of the image and sound and lead to loss of signal.

If your appliance is equipped with a USB port: when connecting a USB peripheral device, respect the way of insertion and never use force. You may damage your peripheral device and/or the appliance.

4.0 Environment

Preservation of the environment is an essential concern of Vodafone. The desire of Vodafone is to operate systems that consider the environment and consequently it has decided to integrate environmental performances in the life cycle of its products, from manufacturing to shipping, use and disposal.

Packaging

European standards require packaging to be recycled. It must not be disposed of with regular household waste. There are local provisions for the separation and recycling of this material.



The circled arrow sign means that the packaging is recyclable and cannot be disposed of with regular household waste.



The logo with the three arrows shown on the plastic parts means that it can be recycled and cannot be disposed of with your regular household waste. To facilitate recycling, respect the separation rules defined locally for this type of waste.

The product



The crossed-out wheeled bin on the product or its accessories means that the product belongs to the family of electrical and electronic equipment. European regulations require you to dispose of such products selectively:

- At collection points available in your area (disposal centre, selective collection, etc.).
- At points of sale when purchasing similar equipment.

In this way, you can participate in the re-use and upgrading of Waste of Electrical and Electronic Equipment, which can have effects on the environment and human health.

Batteries

If your product contains batteries, they must be disposed of at appropriate collection points and not with household waste.

4.1 Power consumption

To reduce the consumption of your appliance, we recommend that you put it on stand-by when you are not using it, by pressing the on/off button on the Remote control. Please note that in Standby mode the device will continue to use energy, even if the display appears to be deactivated. If you do not intend to use your appliance for a long period of time, we recommend that you switch it off completely and unplug it from the socket. In case the device is not connected to an active power outlet, the energy consumption will be reduced to zero. After the device is powered on, it may enter a maintenance mode during the boot-up process. This will cause a delay before the device is ready for normal use. Reducing energy consumption will directly lead to lower operating costs.

- Max power consumption: 12 W
- Average power consumption: 3.5 W
- Stand-by power consumption: < 2.0 W

To disable Wi-Fi, simply turn off the Wi-Fi switch in the product settings menu.

Deactivating the Energy saving mode or extending the pre-set time for the automatic TV turn off feature found under „Settings>>Device Preferences>>Energy Saver“ will result in increased power consumption.

Power consumption

- Active mode: 3.5 W
- Energy saving mode: 1.66 W

Total annual energy consumption (TEC): 17.86 kWh/year

COMMISSION REGULATION (EU) 2019/1782 of 1 October 2019 establishing the eco-design requirements applicable to external power supplies pursuant to Directive 2009/125/EC of the European Parliament and of the Council and repealing Regulation (EC) no 278/2009 of the Commission.

Values and details	
Model references power supply units	ADS-12BP-12 12012EPB-H
	NBS12G120100VK
Company name or registered trademark, number in the commercial register and address of the manufacturer	Sagemcom Broadband SAS FR10 440294510 CS 39000 92271 BOIS-COLOMBES CEDEX France
Input voltage	200-240 V AC
Mains frequency	50/60 Hz
Output Voltage	12,0 V DC
Output Current	1,0 A
Output power	12,0 W
Average performance in active mode	83,3 %
Low load performance (10%)	73,3 %
No-load energy consumption	0,075 W

5.0 CE marking



We declare that radio equipment of type DxiW377 VF complies with directive 2014/53/EU.

Accessories and technical information: Depending on the model purchased, your electrical equipment may include the following:

1. Power unit
2. Remote control and batteries (if applicable)
3. Ethernet cable and HDMI cable (if applicable)
4. The device itself.

The EU declaration of conformity can be found in the support section of the Vodafone website: **vodafone.com/dxiw377_ie/ec-declaration**, or can be obtained from the following address:

Vodafone

Vodafone S.à r.l.,
15 rue Edward Steichen,
L-2540 Luxembourg,
Grand-Duché de Luxembourg

The frequency bands used, and the maximum power radio frequencies transmitted into the product are as follows:

- 2400 – 2483.5 MHz: 100mW
- 5150 – 5350 MHz: 200mW
- 5470 – 5725 MHz: 1W

Restrictions

This radio equipment is subject to certain restrictions when offered for sale in the following markets: Belgium (BE), Bulgaria (BG), Czech Republic (CZ), Denmark (DK), Germany (DE), Estonia (EE), Ireland (IE), Greece (EL), Spain (ES), France (FR), Croatia (HR), Italy (IT), Cyprus (CY), Latvia (LV), Lithuania (LT), Luxembourg (LU), Hungary (HU), Malta (MT), Netherlands (NL), Austria (AT), Poland (PL), Portugal (PT), Romania (RO), Slovenia (SI), Slovakia (SK), Finland (FI), Sweden (SE), Northern Ireland (UK(NI)), Norway (NO), Switzerland (CH), Iceland (IS), Turkey (TR), Liechtenstein (LI).

Wi-Fi 5 GHz: The 5150-5350 MHz frequency band is limited to indoor use.

RF exposure

Your device contains a transmitter and a receiver. When it is ON, it receives and transmits RF energy. When your device is in use, the system handling your connection controls the power level at which your device transmits not to exceed the limits for exposure to radio waves recommended by international guidelines.

These guidelines were developed by the independent scientific organization ICNIRP and include safety margins designed to assure the protection of all persons, regardless of age or health. The guidelines use a unit of measurement known as the Specific Absorption Rate, or SAR. The SAR limit for wireless devices is 2 watts/kilogram (W/kg) and the highest SAR value for this device when tested complied with this limit.

Body worn operations: Important safety information regarding radio frequency radiation (RF) exposure.

To ensure compliance with RF exposure guidelines, the device must be used with a minimum of 20 cm separation from the body. Failure to observe these instructions could result in your RF exposure exceeding the relevant guidelines.

6.0 Licenses and trademarks

The terms HDMI and HDMI High-Definition Multimedia Interface, and the HDMI Logo are trademarks or registered trademarks of HDMI Licensing Administrator, Inc.

Manufactured under license from Dolby Laboratories. Dolby, Dolby Audio and the double-D symbol are trademarks of Dolby Laboratories Licensing Corporation.

Covered by one or more claims of the patents listed at **patentlist.hevcadvance.com**.



This product is licensed under the AVC patent portfolio license for the personal and non-commercial use of a consumer to: (i) encode video in compliance with the AVC standard („AVC-video”) and/or (ii) decode AVC video that was encoded by a consumer engaged in a personal and non-commercial activity and/or was obtained from a video provider licensed to provide AVC-video. No license is granted or shall be implied for any other use. Additional information may be obtained from MPEG LA, LLC see <http://www.mpegla.com>.

This product contains technology subject to certain intellectual property rights of Microsoft. Use or distribution of this technology outside of this product is prohibited without the appropriate license(s) from Microsoft. Content owners use Microsoft PlayReady™ content access technology to protect their intellectual property, including copyrighted content. This device uses PlayReady technology to access PlayReady protected content and/or WMDRM-protected content. If the device fails to properly enforce restrictions on content usage, content owners may require Microsoft to revoke the device's ability to consume PlayReady-protected content. Revocation should not affect unprotected content or content protected by other content access technologies.

Content owners may require you to upgrade PlayReady to access their content. If you decline an upgrade, you will not be able to access content that requires the upgrade.

Google and **Android TV** are trademarks of Google, LLC.

Wi-Fi® and Wi-Fi logo are registered trademarks of Wi-Fi Alliance.

Bluetooth® is a registered trademark of Bluetooth SIG, Inc.

All other brands and logos are trademarks or registered trademarks of their respective owners.



Together we can

© 2024 Vodafone Limited. All rights reserved to Vodafone or third party licensors and materials may not be used in any way or copied in whole or part without prior written permission of Vodafone Limited. Vodafone and the Vodafone logo are trademarks of Vodafone Group Plc or its associated companies.



254071151