

# QUICK START GUIDE

## 1. CHARGING AND WIRED CONNECTIONS

### 1.1 Charging the S.U. & controller

Charge the Surface Unit (S.U.) and the controller with the included micro-USB cables and the USB charger.

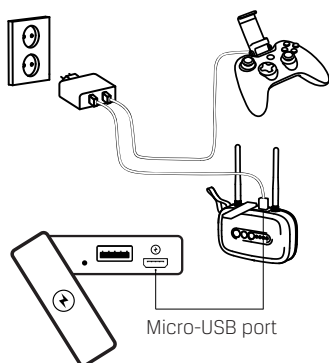

### 1.2 Charging the drone

Unscrew the cap on the right side of the drone. Connect the drone to the Blueye charger with the charging cable, and then connect the power supply to an electrical socket.

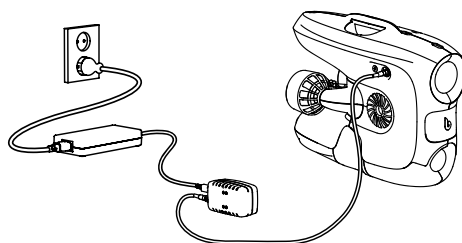

### 1.3 The Blueye Charger

Make sure the switch on the Blueye charger is set to the «drone» symbol.

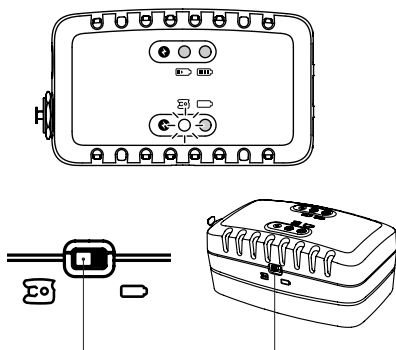

### 1.4 Connecting the Surface Unit

Connect the Surface Unit to the tether.

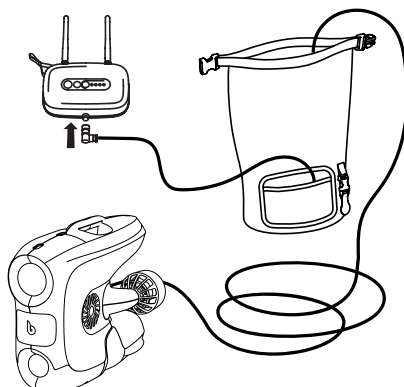

## 2. INSTALLATION AND WIRELESS CONNECTIONS

### 2.1 Open the Blueye App

Download and open the Blueye App.



iOS



Android

### 2.2 Power On the system

Power on the Surface Unit and drone.

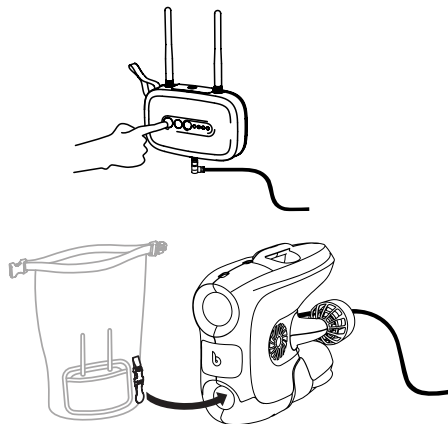

### 2.3 Connecting to the S.U. Wi-Fi

Connect your device to the Surface Unit Wi-Fi. Press the power button on the S.U. and open the Wi-Fi settings on your device.

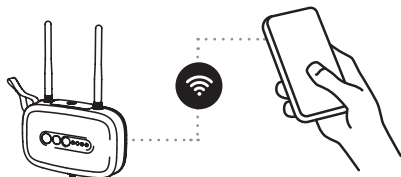

**SSID** ("Blueye\_XXXXXX")

**Password** (1234567890)

### 2.4 Connecting the controller

Connect the controller via Bluetooth. See next page for details on how to connect.

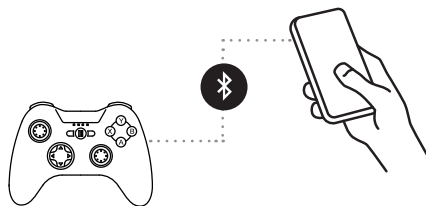

---

### 2.4.1 Set the controller in pairing mode

#### iOS Controller

Press and hold the power button **(1)** until all LEDs starts blinking red, then hold the Bluetooth button **(2)** for about 5 seconds until LEDs starts blinking at a faster rate.

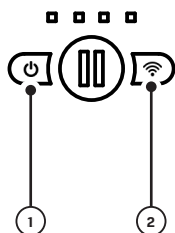

#### Android Controller

Press A button **(1)** and then the MODE button **(2)** at the same time until a blue LED starts blinking at a fast rate.

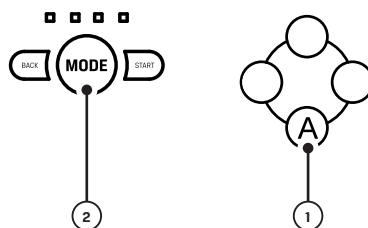

### 2.4.2 Select the controller

To connect the controller to a mobile device, go to Bluetooth settings and select the controller.

The name of the **iOS** controller is **Speedy Gaming Controller**.

The name of the **Android** controller is **PXN-9613**.

*The Android controller may appear as «00:11:22:33:FF:EE» first time you connect.*

*If the controller is not found or you are unable to connect, re-start the controller and turn Bluetooth off and on. Check if the device is listed under My devices/ Previously connected devices.*

---

### 2.5 Starting a dive

Launch the Blueye App. Press «Start Dive» and follow instructions in the App to calibrate the drone if needed.

### 2.7 Ending a dive

Ending a dive in the app: Press the drone icon in the top left corner and hit the «End Dive» button. Press the «Transfer video files» button to download captured media.

Power off the drone, Surface Unit, and rinse the drone in fresh water.

### 2.6 Deploying the drone

Deploy the drone and open the menu bar ☰ in the App to learn how to pilot the drone.

### 2.8 Support

For help and support visit **<http://support.blueye.no>**



Blueye Support



Quick Start Guide

*FOR MORE TIPS, TUTORIALS AND VIDEOS VISIT*  
**[WWW.BLUEYEROBOTICS.COM](http://WWW.BLUEYEROBOTICS.COM)**

