

PROFILE SPECS

T-Moldings are used to bridge the gap between floors of equal or slightly different height. While maintaining a 1/4" to 5/16" expansion gap.

Used with floors ranging from 2-5mm.

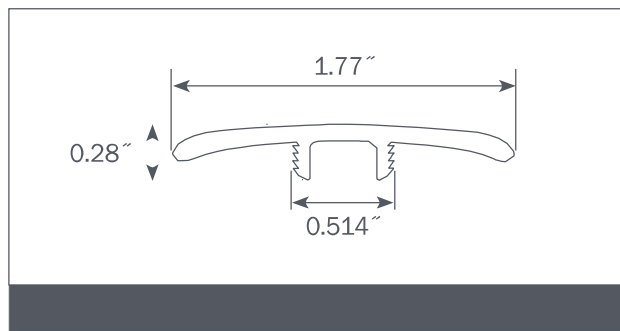

Surface: Ultra wear-resistant | **Core Material:** Rigid PVC

INSTALLATION GUIDE

1. Install the flooring leaving a 1-1/8" gap between the two floors for the t-molding installation.

3. Center the track between the flooring leaving a 5/16" spacing between the track and floor planks. Screw track to subfloor using included screws (or glue down with Mannington Triple Stick adhesive).

2. Measure and trim to fit.

4. Starting at one end, press the molding into the track inching along the length of the molding. *It will NOT snap in all at once.*
You may also use a rubber mallet.

PROFILE SPECS

T-Moldings are used to bridge the gap between floors of equal or slightly different height. While maintaining a 1/4" to 5/16" expansion gap.

Used with floors ranging from 6-8mm.

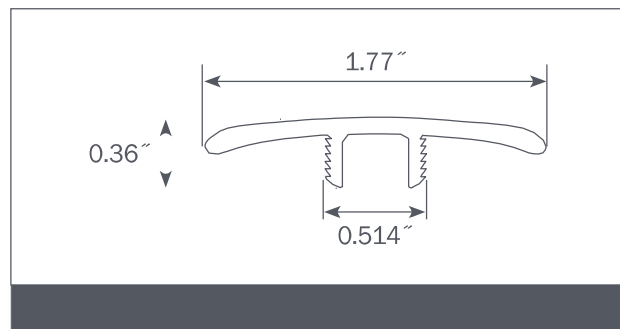

Surface: Ultra wear-resistant | **Core Material:** Rigid PVC

INSTALLATION GUIDE

1. Install the flooring leaving a 1-1/8" gap between the two floors for the t-molding installation.

3. Center the track between the flooring leaving a 5/16" spacing between the track and floor planks. Screw track to subfloor using included screws (or glue down with Mannington Triple Stick adhesive).

2. Measure and trim to fit.

4. Starting at one end, press the molding into the track inching along the length of the molding. *It will NOT snap in all at once.*
You may also use a rubber mallet.

PROFILE SPECS

Multipurpose reducers are used to bridge the gap between two floors of unequal heights. While maintaining a ¼" to 5/16" expansion gap.

Used with floors ranging from 2-5mm.

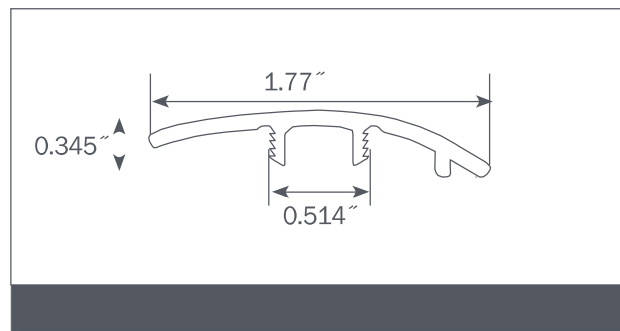

Surface: Ultra wear-resistant | **Core Material:** Rigid PVC

INSTALLATION GUIDE

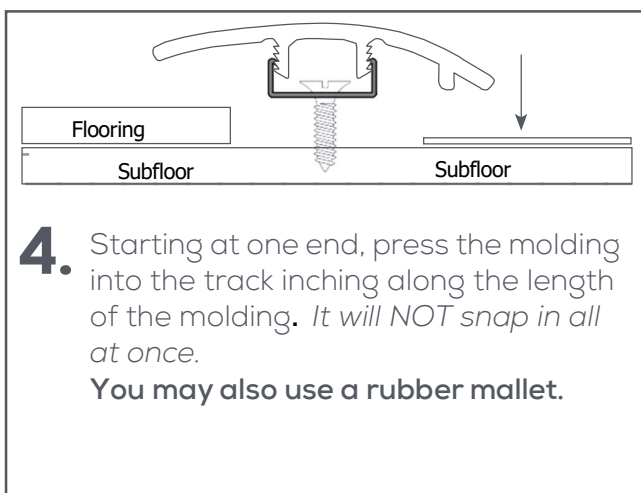
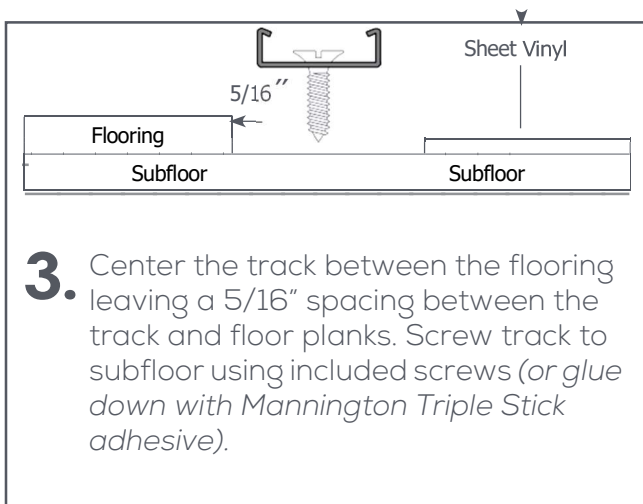
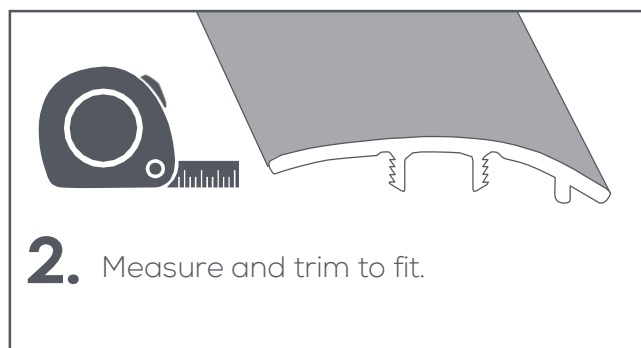
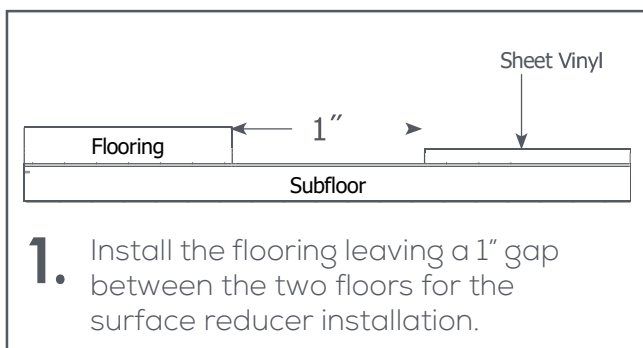

PROFILE SPECS

Multipurpose reducers are used to bridge the gap between two floors of unequal heights. While maintaining a ¼" to 5/16" expansion gap.

Used with floors ranging from 6-8mm.

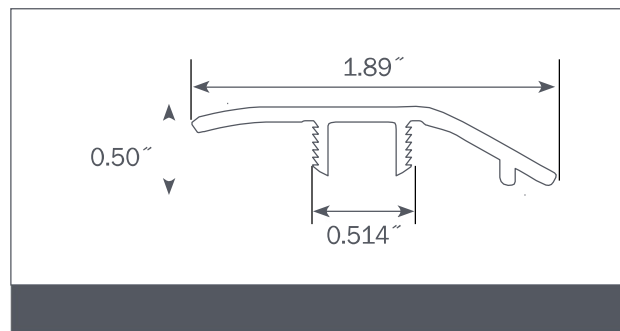

Surface: Ultra wear-resistant | **Core Material:** Rigid PVC

INSTALLATION GUIDE

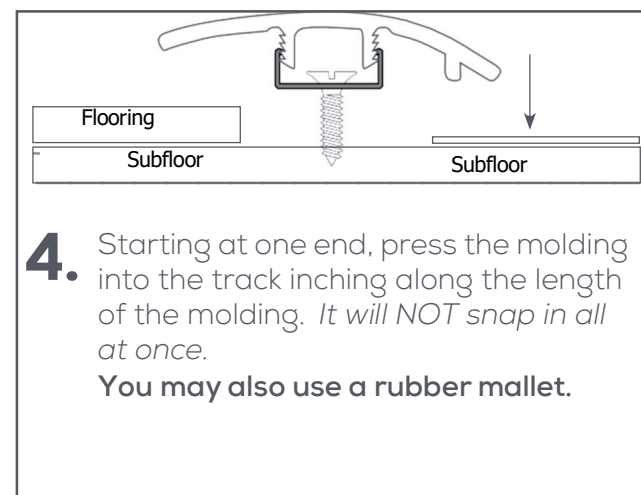
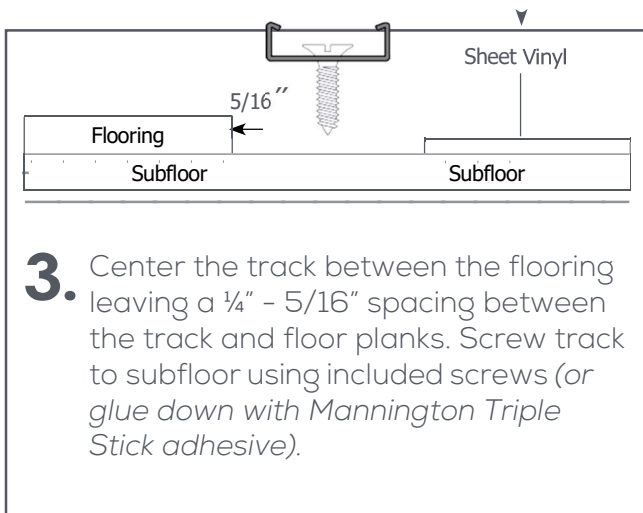
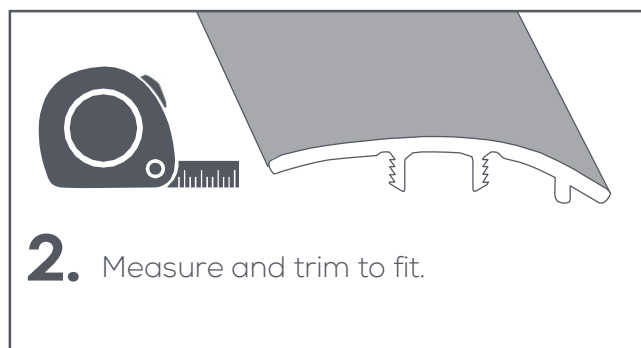
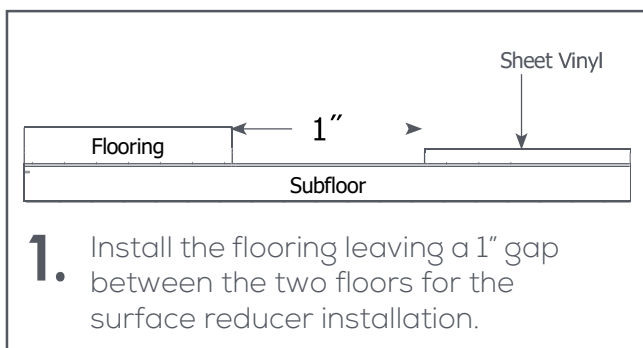

PROFILE SPECS

End caps are used to fill the gap between the floor and carpet, hearths or against sliding doors. While maintaining a 1/4" - 5/16" expansion gap on the Adura side.

Used with floors ranging from 2-5mm.

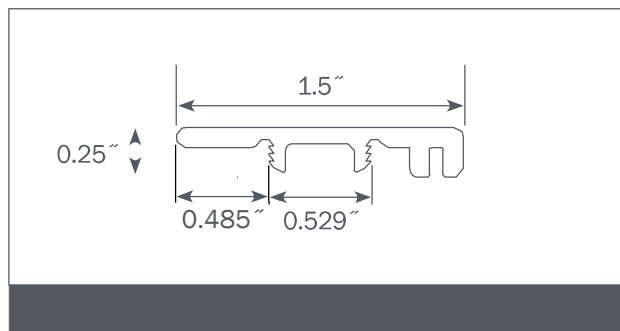

Surface Laminate: Wear resistant | **Core Material:** Rigid PVC

INSTALLATION GUIDE

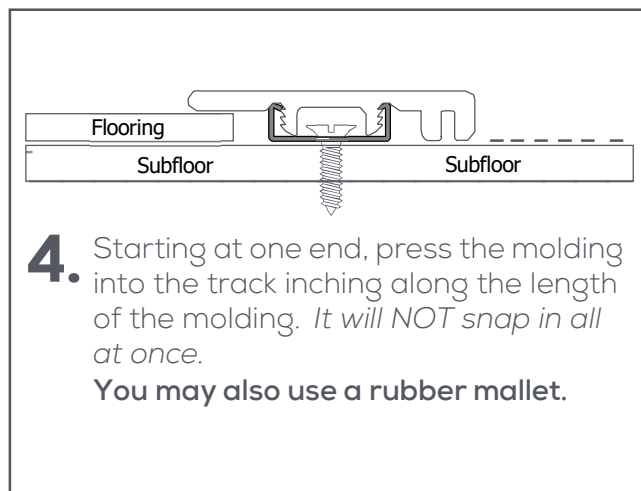
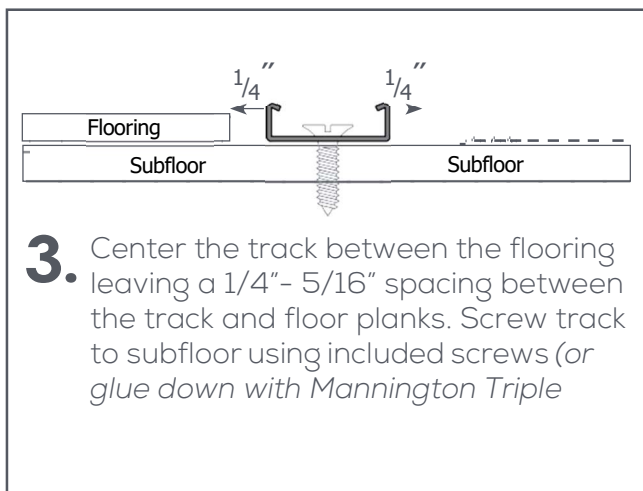
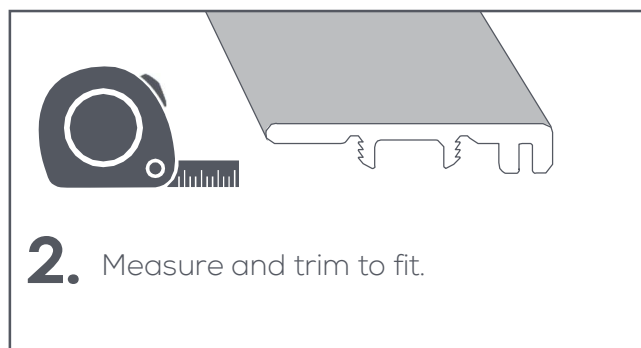
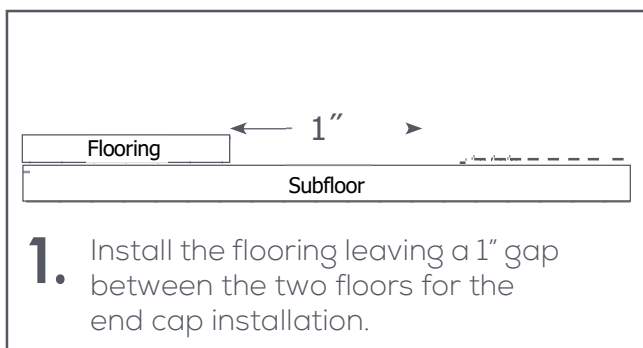

PROFILE SPECS

End caps are used to fill the gap between the floor and carpet, hearths or against sliding doors. While maintaining a 1/4" to 5/16" expansion gap on the Adura side.

Used with floors ranging from 6-8mm.

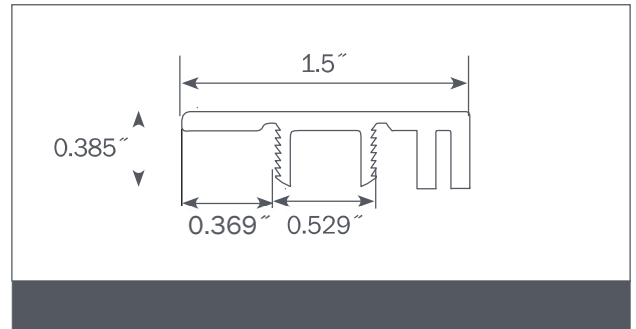

Surface: Wear resistant | **Core Material:** Rigid PVC

INSTALLATION GUIDE

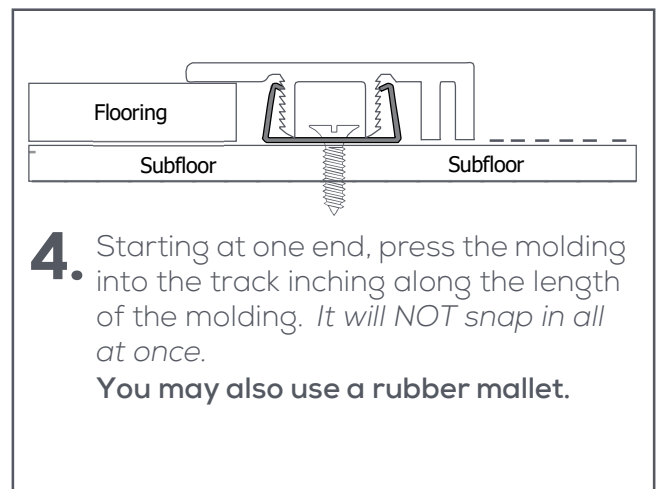
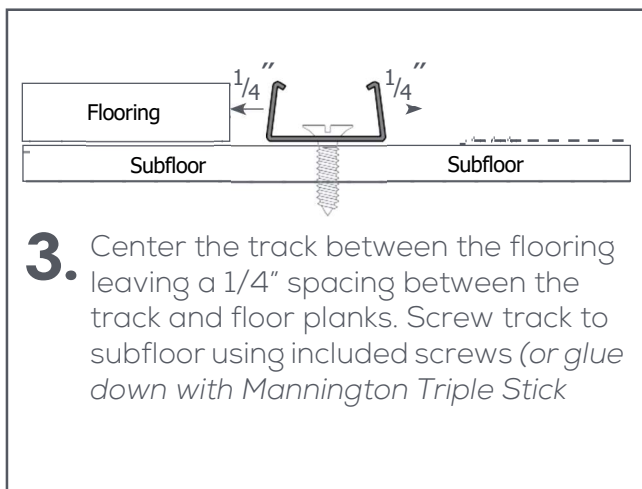
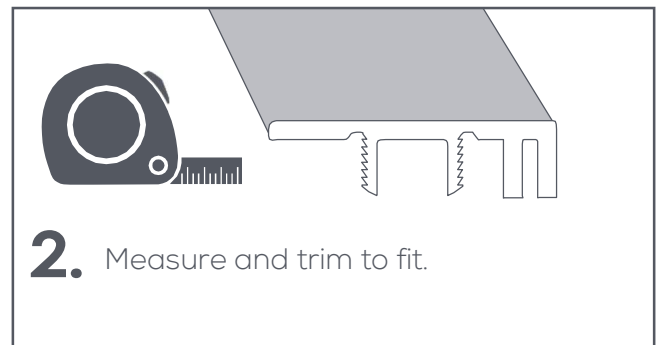
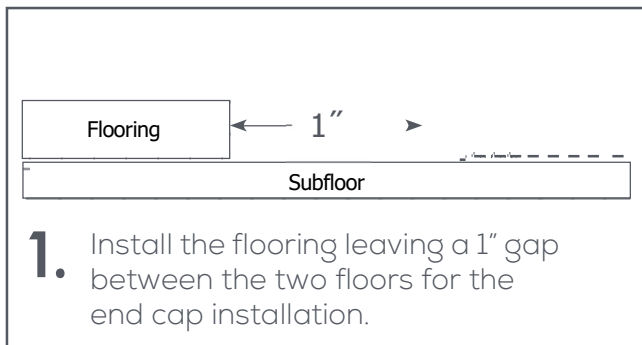

PROFILE SPECS

Stair noses are used to finish the end of a step.

** Use as an overlap stair nose on top step by installing enclosed shim directly to the underside of stair nose.*

** Adhere shim using MSS-20 or PVC cement*

Used with APEX/Max 8mm floors (+/- .5mm).

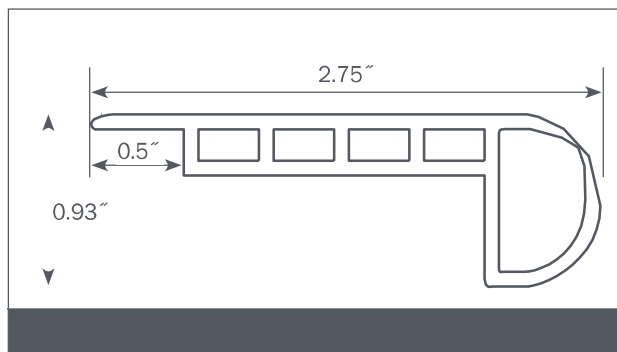

INSTALLATION GUIDE

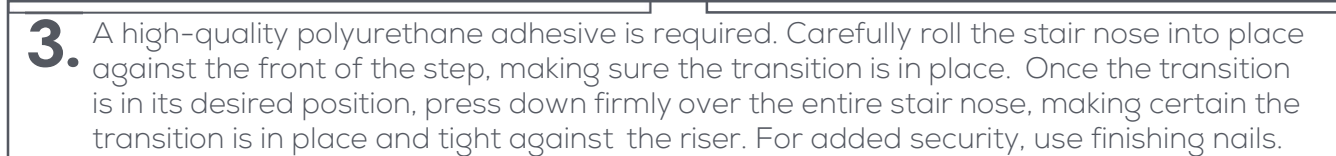
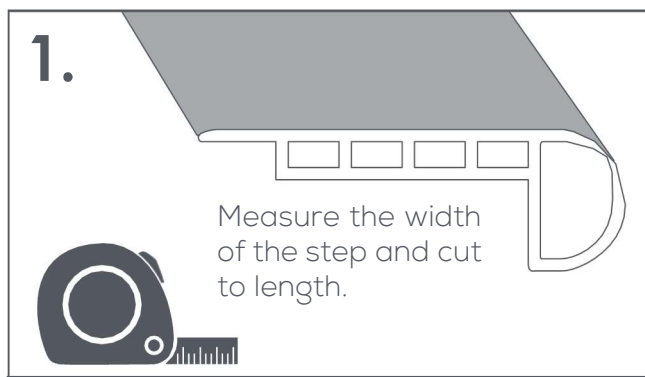

Let the adhesive cure according to directions.

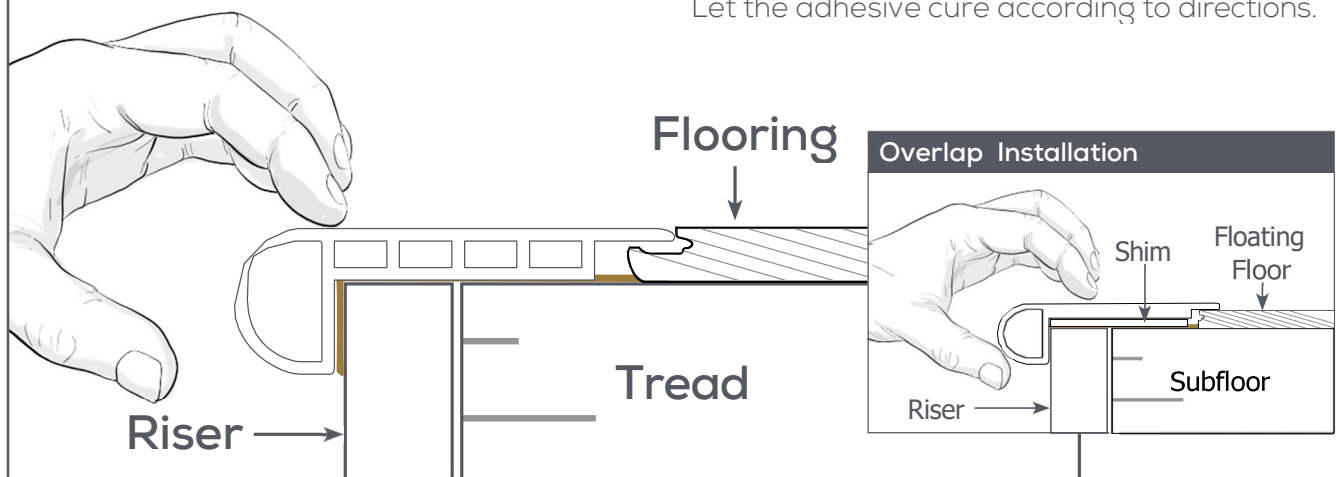

PROFILE SPECS

Stair noses are used to finish the end of a step.

** Use as an overlap stair nose on top step by installing enclosed shim directly to the underside of stair nose.*

** Adhere shim using MSS-20 or PVC cement.*

Used with SPC Rigid, Realta, and Essentials floors ranging from 4-6mm.

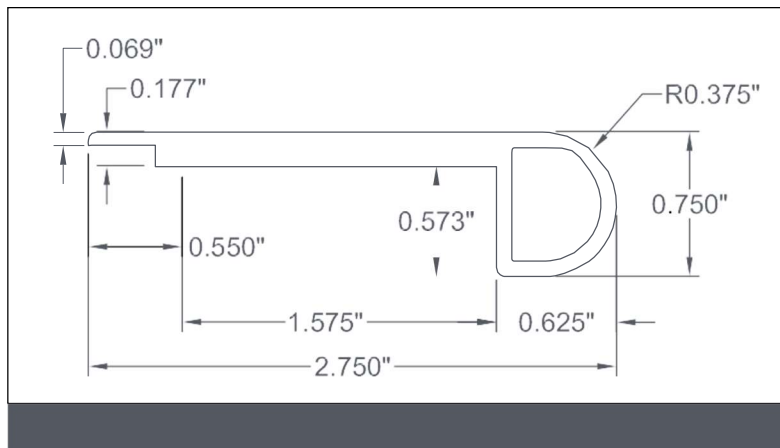

INSTALLATION GUIDE

1.

Measure the width of the step and cut to length.



2.

Apply a generous bead of Mannington Triple Stick adhesive along the underside of the stair

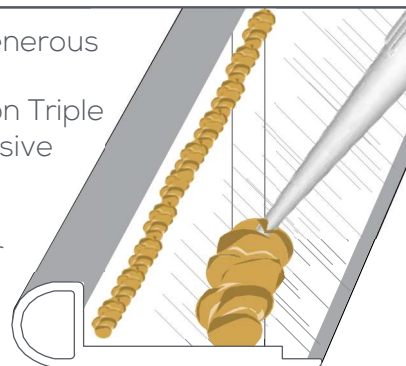

3.

A high-quality polyurethane adhesive is required. Carefully roll the stair nose into place against the front of the step, making sure the transition is in place. Once the transition is in its desired position, press down firmly over the entire stair nose, making certain the transition is in place and tight against the riser. For added security, use finishing nails.

Let the adhesive cure according to directions.

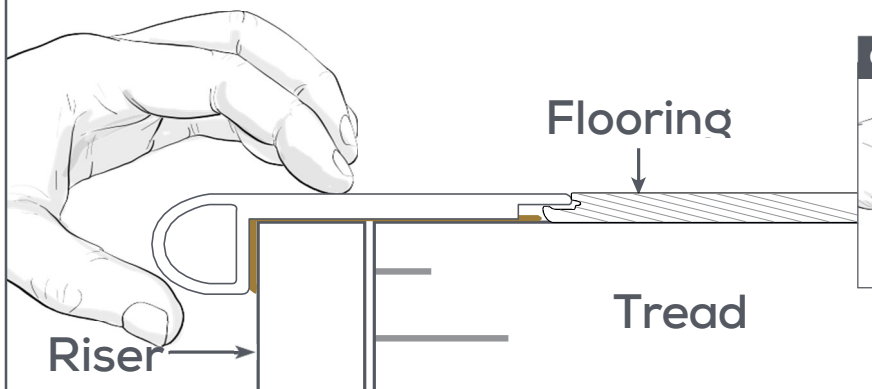

Overlap Installation

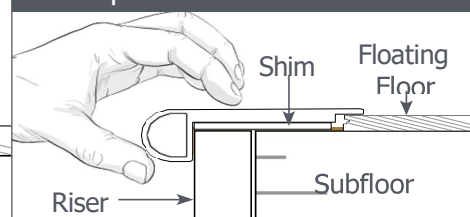

PROFILE SPECS

Stair noses are used to finish the end of a step.

Flex top-set only. Do not use the plastic shim with Adura Flex.

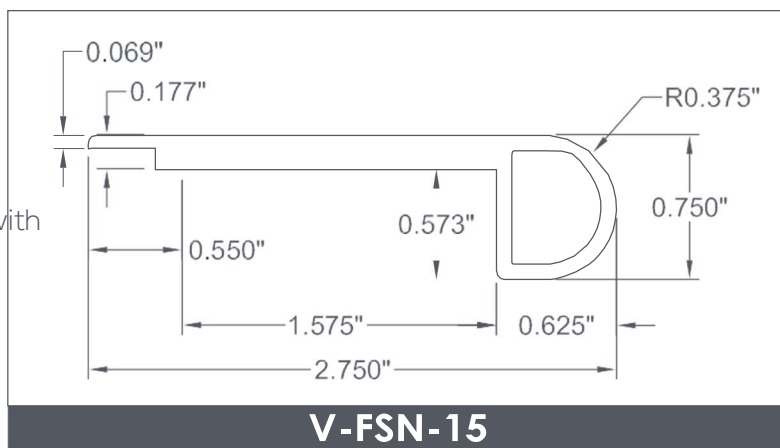

INSTALLATION GUIDE

1.

Measure the width of the step and cut to length.



2.

Apply a generous bead of Mannington Triple Stick adhesive along the underside of the stair

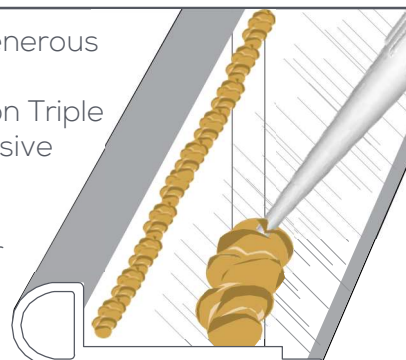

3.

A high-quality polyurethane adhesive is required. Carefully roll the stair nose into place against the front of the step, making sure the transition is in place. Once the transition is in its desired position, press down firmly over the entire stair nose, making certain the transition is in place and tight against the riser. For added security, use finishing nails.

Let the adhesive cure according to directions.

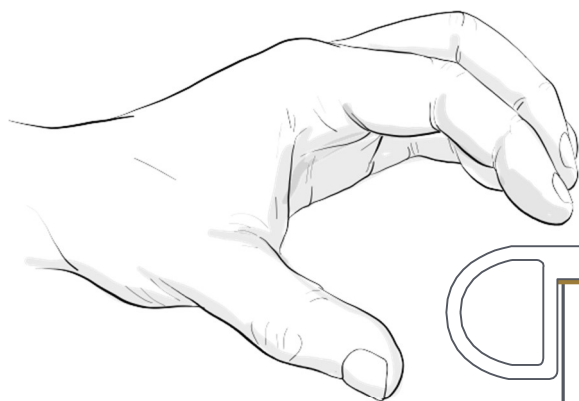

Riser

ADURA®Flex
Flooring

Tread/Subfloor