

VAULT PENDANT



ORDERING MANUAL ACOUSTIC TILE

ateljé Lyktan

For square Vault systems made of 1144 mm Light bars an acoustic tile from Ecophon is available as an accessory. The acoustic tile rests on the edge on top of the Light bar and is held in place by a white lacquered metal frame or small metal clips if the tiles are adjacent.

Metal frame, clips and acoustic tile are available as accessories.

Note that the acoustic tile must rest on all four sides and be fixed with either a frame or clip on all four sides.





An acoustic tile resting on Vault Light bars and held in place by a white lacquered metal frame.



Vault with acoustic tile seen from below.

ARTICLE NUMBERS ACCESSORIES

2000256 VAULT PENDANT ACOUSTIC TILE COVER PLATE

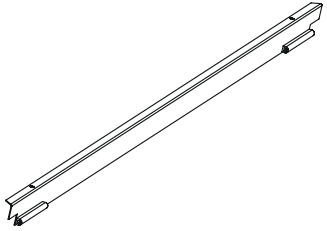

Metal frame (1 pce) for acoustic tile. Used on sides that are not adjacent to another acoustic tile.

2000257 VAULT ACOUSTIC TILE ANGLE BRACKETS

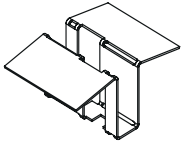

Metal clips for sides where two tiles are adjacent to each other.

2000258 VAULT ACOUSTIC TILE 1200x1200

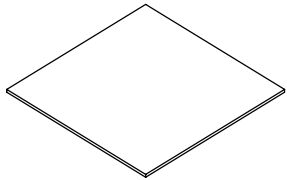

Ecophon Focus A 1200x1200 acoustic tile in mineral wool.
1 pce per 1144 square.

ORDER EXAMPLES

1 acoustic tile

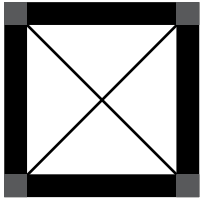

4 x 2000256
1 x 2000258

2 acoustic tiles (adjacent)

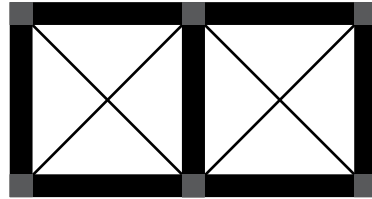

6 x 2000256
1 x 2000257
2 x 2000258

2 acoustic tiles (not adjacent)

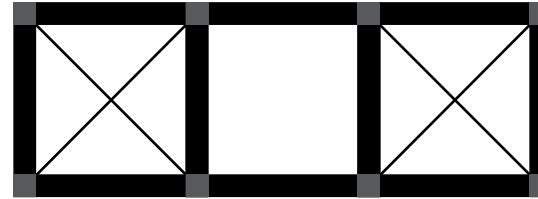

8 x 2000256
2 x 2000258



Not allowed, the acoustic plate must rest on all four sides.

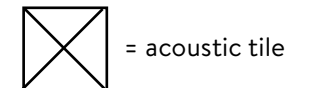

ateljé Lyktan