

Convene 530 Fifth Avenue

MEETINGS & EVENTS

530 Fifth Avenue, New York, NY 10036



Convene 530 Fifth Avenue is a premium meeting and event venue in Midtown Manhattan. With more than 15,000 square-feet of meeting space, it offers five flexible rooms, the largest of which can accommodate up to 74 guests; it is ideal for board meetings, executive retreats, corporate offsites, and networking receptions.

The modern yet comfortable design of this location will bring an elevated feel to any event. Convene 530 Fifth Avenue provides a white box space allowing for extensive client and event branding opportunities, in-house catering with customization options and dining private to each event, in-room A/V technology supported by an on-site team, and dedicated hospitality resources.

The location is in close proximity to multiple subway lines, Grand Central Station, and Bryant Park.

5
MEETING ROOMS

244
FULL BUYOUT CAPACITY

15,000
SQUARE FEET



HIGH SPEED
WIFI



STATE OF THE ART
TECHNOLOGY



FLEXIBLE MEETING
& EVENT SPACE



EVENT PLANNING
SERVICES



ON-SITE
GOURMET CHEF



UNLIMITED ON-SITE
DRINKS & SNACKS

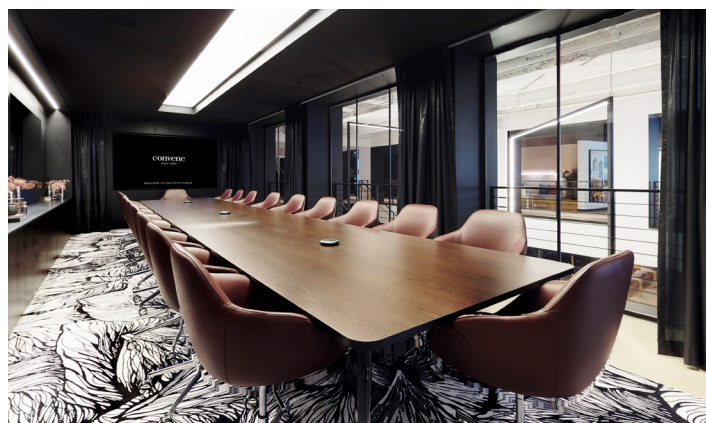

This collateral is based on the latest information reasonably available and may be updated on a periodic basis. Please check with your Convene Account Manager for the latest information.

convene

CONVENE.COM | 888-730-7307

Convene 530 Fifth Avenue

MEETINGS & EVENTS

530 Fifth Avenue, New York, NY 10036

Floorplan & capacities

9TH FLOOR

LEGEND

BATHROOMS	COAT CLOSET
PHONE ROOM	ENTRANCE
RESPIRE ROOM	ELEVATOR

GENERAL ACCESS

BATHROOMS & RESPITES

MEETING & EVENT ACCESS

GALLERY SPACE

MEETING ROOMS

NOURISH

WORKPLACE ACCESS

COMMON SPACE

MEETING ROOMS

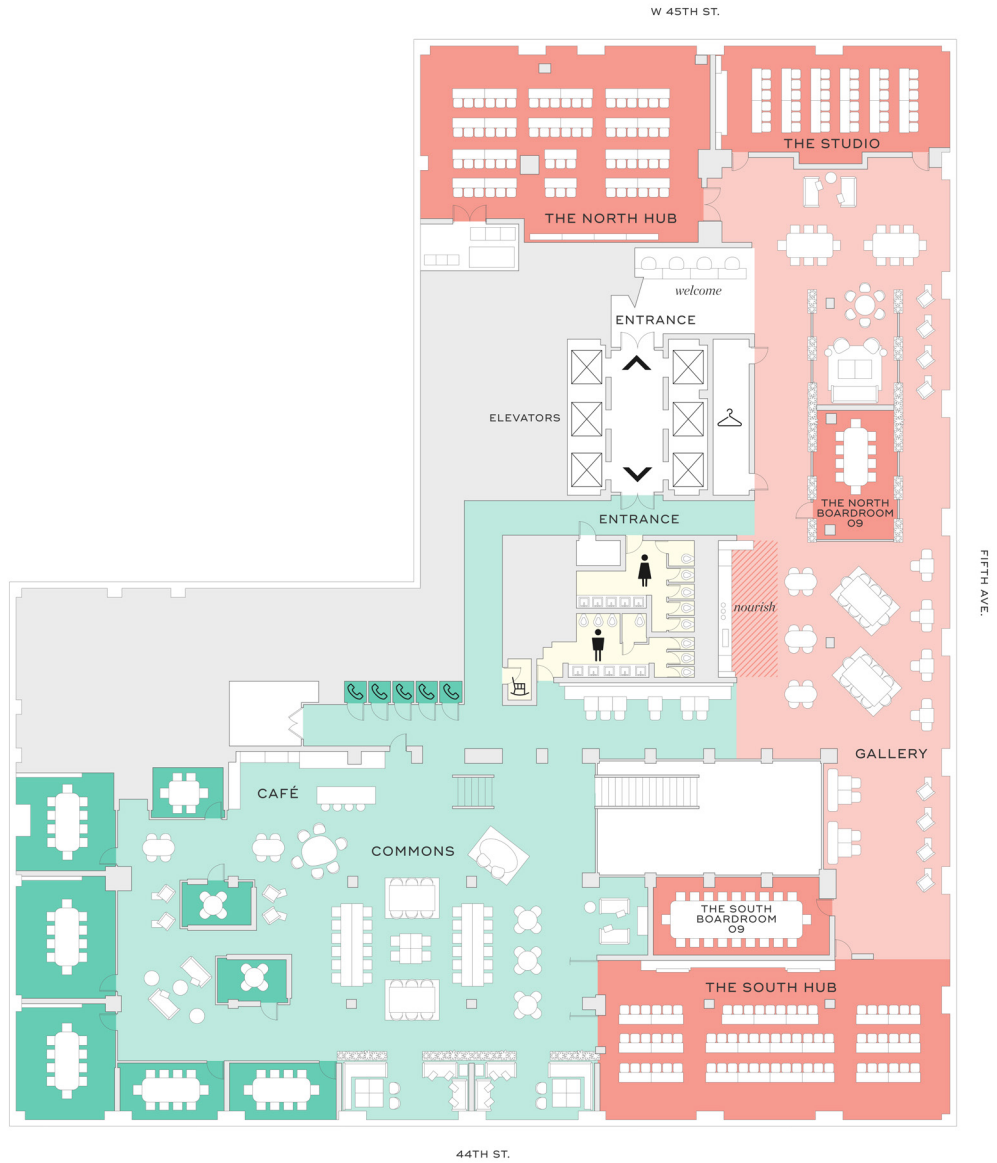

	MAX OCCUPANCY	DIMENSION [FT]	AREA [SQ FT]	CEILING HT [FT]	RECEPTION (MAX OCCUPANCY)	THEATER	CLASSROOM	U-SHAPE	CONFERENCE	PODS [6-TOP]
The North Hub	74	35' X 54'	1818'	14'	74	74	60	27	42	48
The South Hub	74	28' X 63'	1835'	14'	74	74	72	36	48	60
The Studio	74	42' X 21'	869'	14'	74	54	36	33	30	24
The North Boardroom	10	24' X 14'	341'	-	10	-	-	-	10	-
The South Boardroom	20	15' X 35'	457'	-	20	-	-	-	20	-

This collateral is based on the latest information reasonably available and may be updated on a periodic basis. Please check with your Convene Account Manager for the latest information.