

# Sancroft, St. Paul's



Located in the iconic Paternoster Square, Sancroft, St. Paul's, is conveniently centralized, easy to access and surrounded by a collection of historical London landmarks within the City. Unique to London venues, this property boasts an exceptional blueprint with meeting rooms surrounded by generous natural light, exposed ceilings ranging from 9' to 14' height, and a 900-person Hall space. Inspired by the craftsmanship in the local neighborhood, Convene's newest London property takes curated design to the next level. The interior design restores medieval vistas and perspectives, while reflecting the contemporary architecture within the otherwise traditional area.

Apart from the impressive scale and design, this property is one of the largest meeting and event spaces within the city limits. With a max capacity of 1200 and 7 large meeting rooms, this property's intentional architecture makes it the perfect backdrop for exhibitions, large hybrid conferences, evening receptions, executive off sites, seminars and other gatherings.

4,181m<sup>2</sup>  
TOTAL SQUARE METERS

---

7  
MEETING SPACES

---

1,200  
FULL BUYOUT CAPACITY

-   
FLEXIBLE MEETING & EVENT SPACE
-   
INNOVATIVE TECHNOLOGY
-   
EVENT PLANNING & MANAGEMENT
-   
FULLY STAFFED & SERVICED
-   
ON-SITE GOURMET CATERING
-   
PREMIUM DESIGN

## THE INSPIRATION

### Every space tells a story.

- Inspired by Paternoster Square's rich historic stand alone buildings with a modern twist
- Influenced by the Elizabethan Era, revealing layers in texture, pattern, and interior styling to capture the essence of home
- Embodies the spirit of 'Unstoppable Britain' through the concept of regeneration and moving forward with innovation and energy

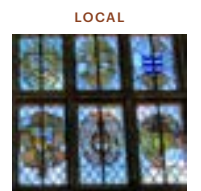
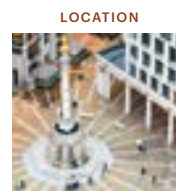

## Floorplan & Capacities

### LEVEL 1

**LEGEND**

- WC
- LIFTS
- ENTRANCE
- WCS & RESPITES
- GALLERY SPACES
- HUBS & BOARDROOMS
- WELCOME DESK
- TENANT COMMON SPACE
- BACK OF HOUSE
- DIGITAL SIGNAGE

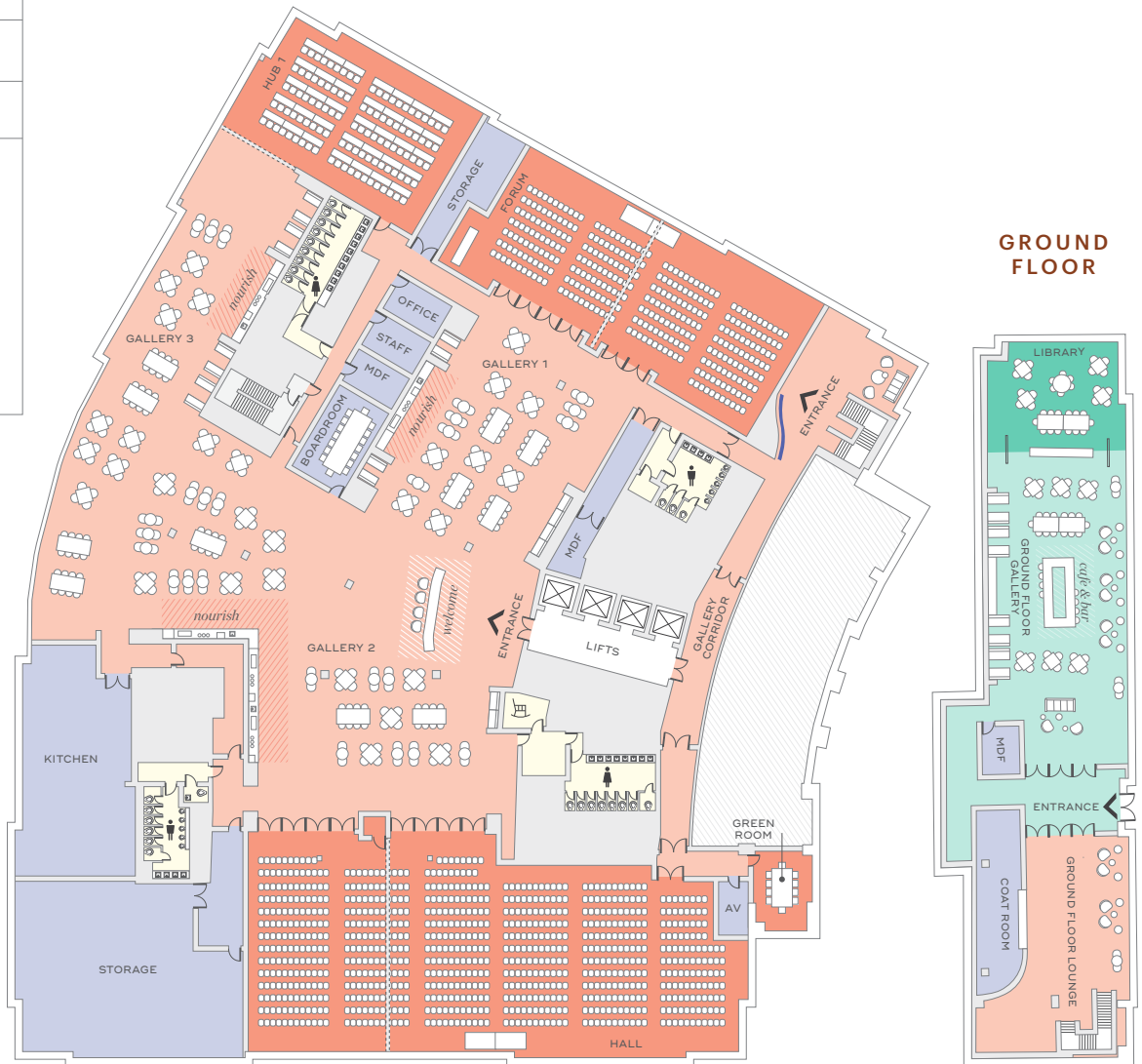

	AREA SQ METERS	AREA SQ FEET	THEATER	CLASSROOM [3-TOP]
Forum	325 m <sup>2</sup>	3,500 ft <sup>2</sup>	349	76
Hub 1	206 m <sup>2</sup>	2,212 ft <sup>2</sup>	175	84
Hall	667 m <sup>2</sup>	7,176 ft <sup>2</sup>	900	350
Level 1 Gallery	1,400 m <sup>2</sup>	15,067 ft <sup>2</sup>	-	-