

One Boston Place

convene



Convene at One Boston Place is the newest on-demand meeting, event, and conference space in the heart of Boston's Financial District. The state-of-the-art venue includes a private outdoor terrace, built-in technology, a dedicated on-site team, and fresh food made on-site making it perfect for hosting board meetings, town halls, team off-sites, trainings, and corporate receptions.

Additionally, Convene can enable all virtual and hybrid event types.

[Convene Studio](#) is a premium virtual and hybrid solution that delivers events for up to 10,000 attendees and is powered by our professional production teams and virtual event technology.

6

MEETING ROOMS

160

MAX ROOM CAPACITY

15,000

SQUARE FEET

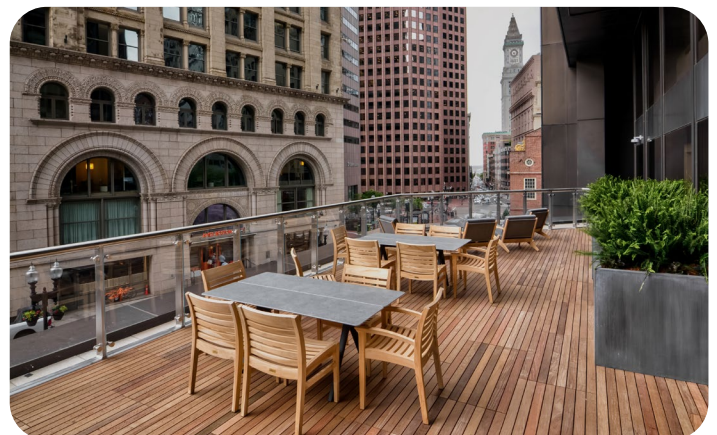
HIGH-SPEED
WIFISTATE OF THE ART
TECHNOLOGYFLEXIBLE MEETING
& EVENT SPACEEVENT PLANNING
SERVICESON-SITE
GOURMET CHEFUNLIMITED ON-SITE
DRINKS & SNACKS

Floorplan & Capacities

2ND FLOOR

LEGEND

 BATHROOMS

 ELEVATOR

 ENTRANCE

GENERAL ACCESS

 BATHROOMS

MEETING & EVENT ACCESS

 GALLERY SPACE

 MEETING ROOMS

 NOURISH & WELCOME

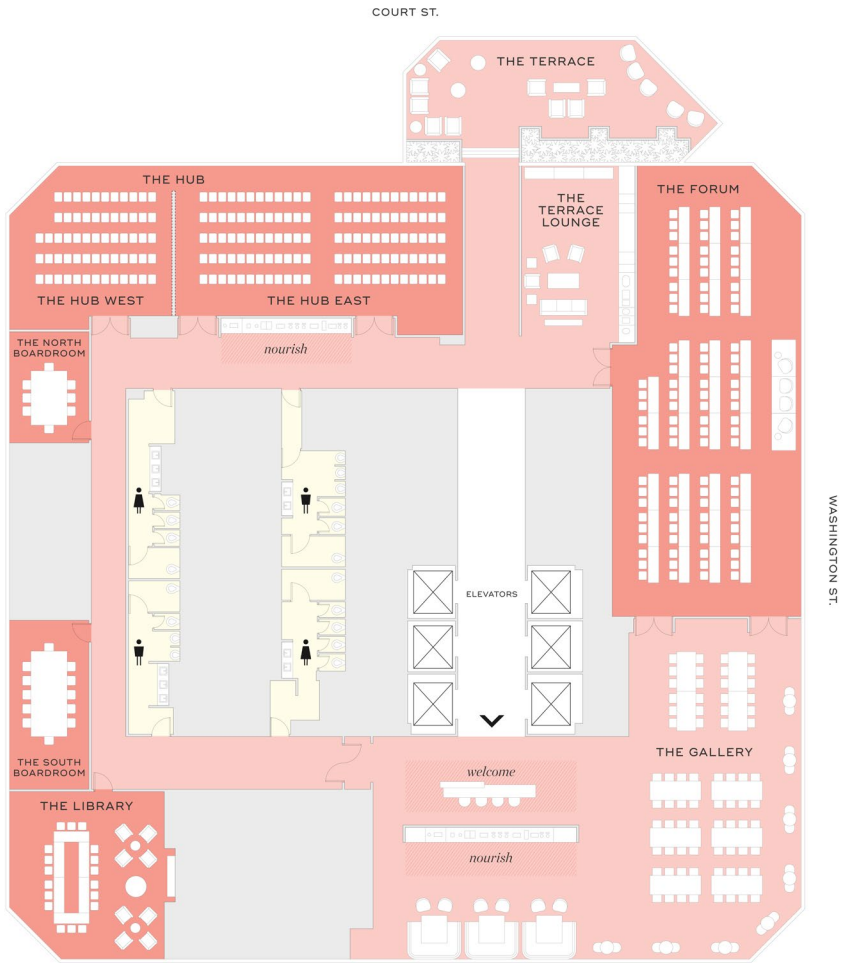

	DIMENSION [FT]	AREA [SQ FT]	CEILING HT [FT]	RECEPTION	THEATER	CLASSROOM	CONFERENCE	U-SHAPE	HOLLOW SQUARE	PODS
The North Boardroom	13' x 18'	234'	8'	n/a	n/a	n/a	8	n/a	n/a	n/a
The South Boardroom	13' x 27'	351'	8'	n/a	n/a	n/a	12	n/a	n/a	n/a
The Library	25' x 27'	675'	8'	30	41	27	22	18	24	36
The Hub	25' x 73'	1,825'	8'	125	129	81	66	42	56	60
The Hub East	25' x 46'	1,150'	8'	80	80	54	42	30	42	42
The Hub West	25' x 27'	675'	8'	30	41	27	22	18	30	30
The Forum	28' x 73'	2,044'	8'	135	160	105	66	48	78	72
The Gallery	32' x 53'	1,696'	8'	150	n/a	n/a	n/a	n/a	n/a	n/a
The Terrace Lounge	28' x 16'	448'	n/a	20	n/a	n/a	n/a	n/a	n/a	n/a
The Terrace	18' x 40'	720'	n/a	45	n/a	n/a	n/a	n/a	n/a	n/a