

WORKPLACE

## 600 14th Street NW



**Convene at 600 14th Street NW** is the newest place to work and meet in Downtown DC. The venue includes tailored, furnished work suites, on-demand meeting spaces, and membership-based work areas. With design inspiration stemming from local architecture and interiors from 1950's couture, visitors will experience a sense of comfort and warmth while working in the space.

HIGH-SPEED  
WIFIRESERVABLE  
MEETING SPACEOFFICE  
SUPPLIESCOMMUNITY  
EVENTSAMPLE COMMUNAL  
SPACEON-SITE GOURMET  
CATERINGPRIVATE  
STORAGEUNLIMITED ON-SITE  
DRINKS & SNACKS

53,200

RENTABLE SQ FT

13

WORKSUITES

284

WORK STATIONS

146

SOCIAL DISTANCE  
WORK STATIONS

14

MEETING ROOMS

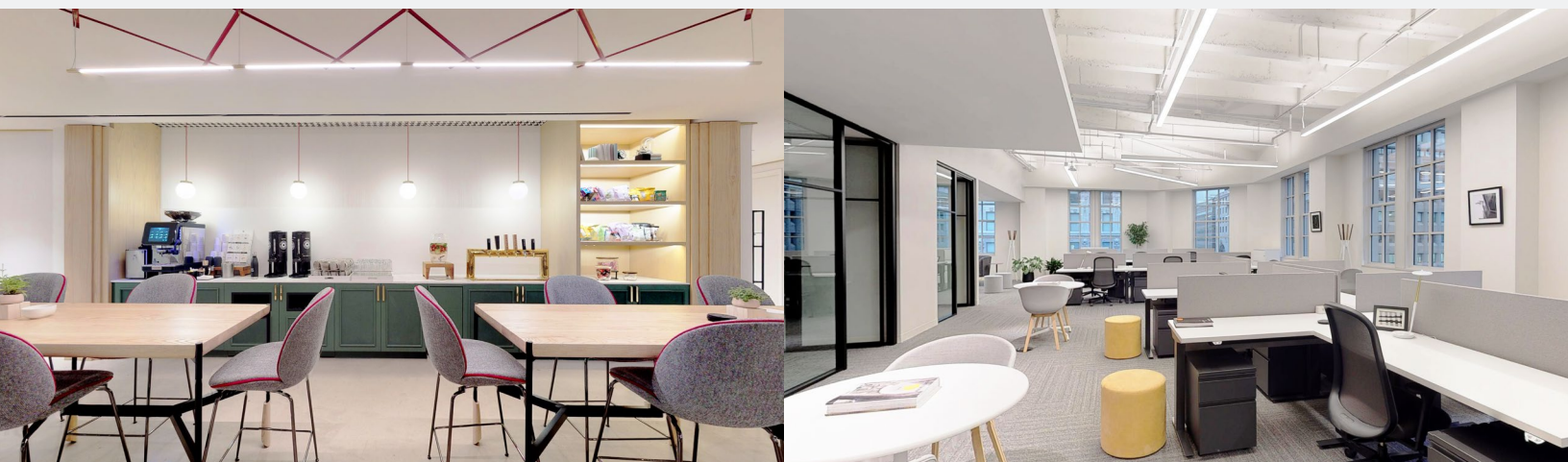

# WorkPlace Floorplan & Capacities

## 5TH FLOOR

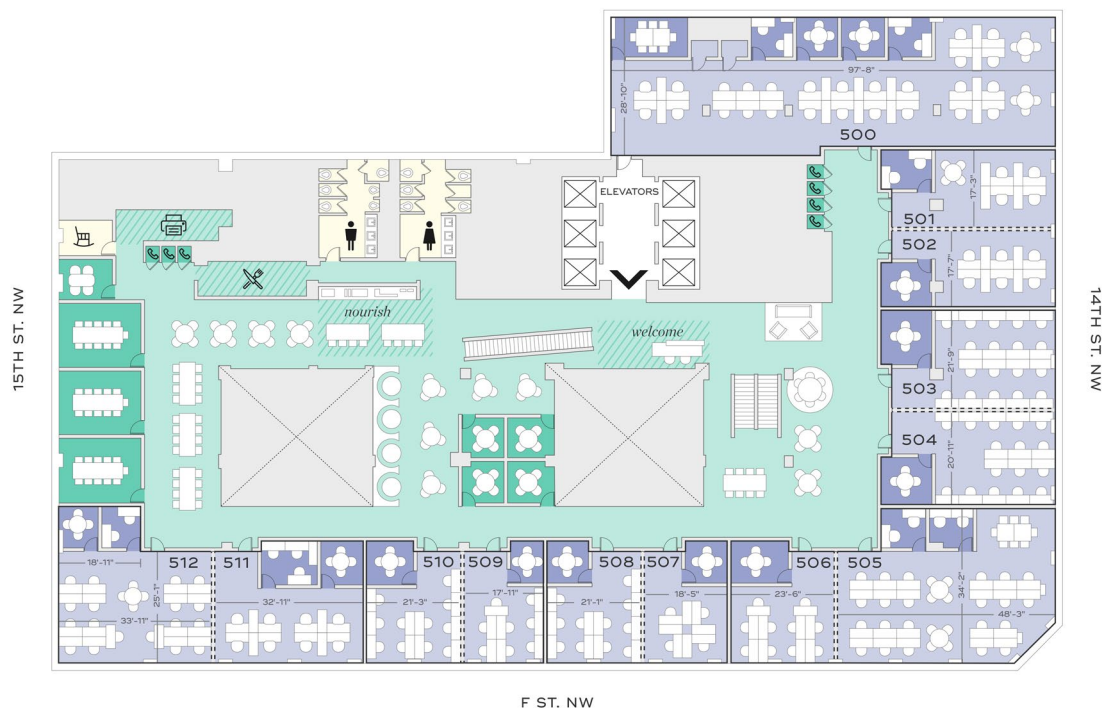
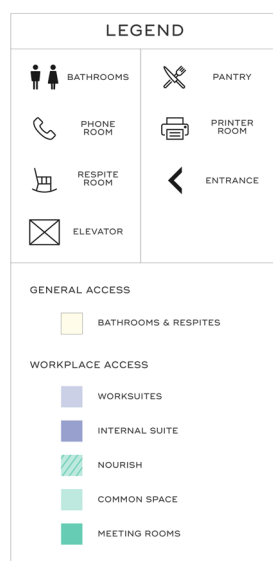

WORKSUITE	MEMBERSHIPS INCLUDED	INTERNAL SUITE	WORKSUITE	MEMBERSHIPS INCLUDED	INTERNAL SUITE	MEETING ROOMS	CAPACITY	QUANTITY
WorkSuite 500	65	5	WorkSuite 507	9	1	Huddles	4	5
WorkSuite 501	15	1	WorkSuite 508	14	1	Conference Rooms	10	3
WorkSuite 502	16	1	WorkSuite 509	10	1	Phone Rooms	1	7
WorkSuite 503	21	1	WorkSuite 510	14	1			
WorkSuite 504	20	1	WorkSuite 511	22	2			
WorkSuite 505	38	2	WorkSuite 512	27	2			
WorkSuite 506	13	1						
						COMMON SPACE	SQ FT	SEATS
						Commons	8,342	112

# Meeting & Event Space Floorplan & Capacities

## 4TH FLOOR

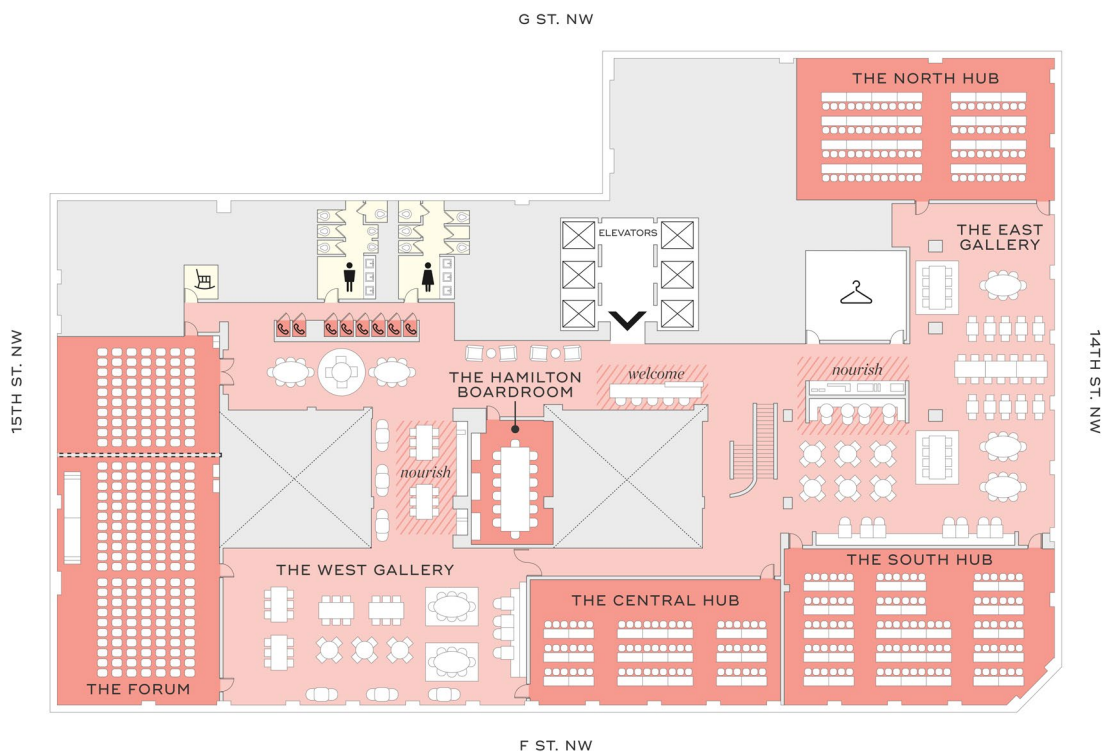
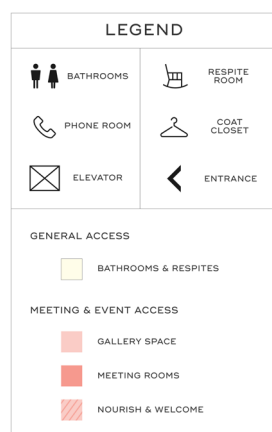

	DIMENSION [FT]	AREA [SQ FT]	CEILING HT [FT]	THEATER	CLASSROOM	CONFERENCE	ROUNDS	U-SHAPE	HOLLOW SQUARE	PODS
The Forum	36' x 81'	3,046'	9'	259	156	80	144	60	90	144
The Forum South	36' x 53'	2,066'	9'	192	126	50	96	45	72	90
The Forum North	36' x 26'	980'	9'	66	48	20	48	30	42	48
The South Hub	34' x 59'	2,072'	10'	134	126	50	104	42	60	102
The North Hub	31' x 56'	1,830'	9'	124	105	44	72	36	60	60
The Central Hub	27' x 54'	1,552'	10'	104	72	44	64	33	54	66
The Hamilton Boardroom	17' x 27'	493'	9'	n/a	n/a	14	n/a	n/a	n/a	n/a
The East Gallery		3,655'	11'	n/a	n/a	n/a	n/a	n/a	n/a	n/a
The West Gallery		2,341	9'	n/a	n/a	n/a	n/a	n/a	n/a	n/a