

Convene Willis Tower

233 S Wacker Drive, Chicago, IL 60606

MEETINGS & EVENTS



Convene Willis Tower is a premium venue in one of the most iconic trophy buildings in the world. Spanning 90,000 square-feet across the entire third floor and offering 11 unique meeting spaces, it is conveniently located in the Loop neighborhood of Chicago. With the largest meeting room able to accommodate 869 guests, it is ideally suited for large summits, events that require substantial exhibitor space, and corporate galas.

The design was inspired by the Chicago city motto "Urbs in Horto" - i.e. "city in a garden" - and features park-like design elements as well as 24-foot floor-to-ceiling windows, five private outdoor terraces, and plenty of natural light. Convene Willis Tower provides a white box space allowing for client and event branding opportunities, in-house catering with customization options and dining private to each event, in-room A/V technology supported by an on-site team, and dedicated hospitality resources.

The venue is located near the Washington/Wells Station, Quincy Station, and Union Station and additionally offers nearby paid parking.

11
MEETING ROOMS

1,945
FULL BUYOUT CAPACITY

90,000
SQUARE FEET



HIGH SPEED
WIFI



STATE OF THE ART
TECHNOLOGY



FLEXIBLE MEETING
& EVENT SPACE



EVENT PLANNING
SERVICES



ON-SITE
GOURMET CHEF



UNLIMITED ON-SITE
DRINKS & SNACKS



This collateral is based on the latest information reasonably available and may be updated on a periodic basis. Please check with your Convene Account Manager for the latest information.

convene

CONVENE.COM | 888-730-7307

Convene Willis Tower

233 S Wacker Drive, Chicago, IL 60606

MEETINGS & EVENTS

Floorplan & Capacities

S WACKER DR.

LEVEL THREE

LEGEND

- BATHROOMS
- ENCLAVE
- ELEVATOR
- PANTRY
- RESPITE
- ENTRANCE
- BATHROOMS & RESPITES
- GALLERY SPACES
- MEETING ROOMS
- NOURISH & WELCOME DESK

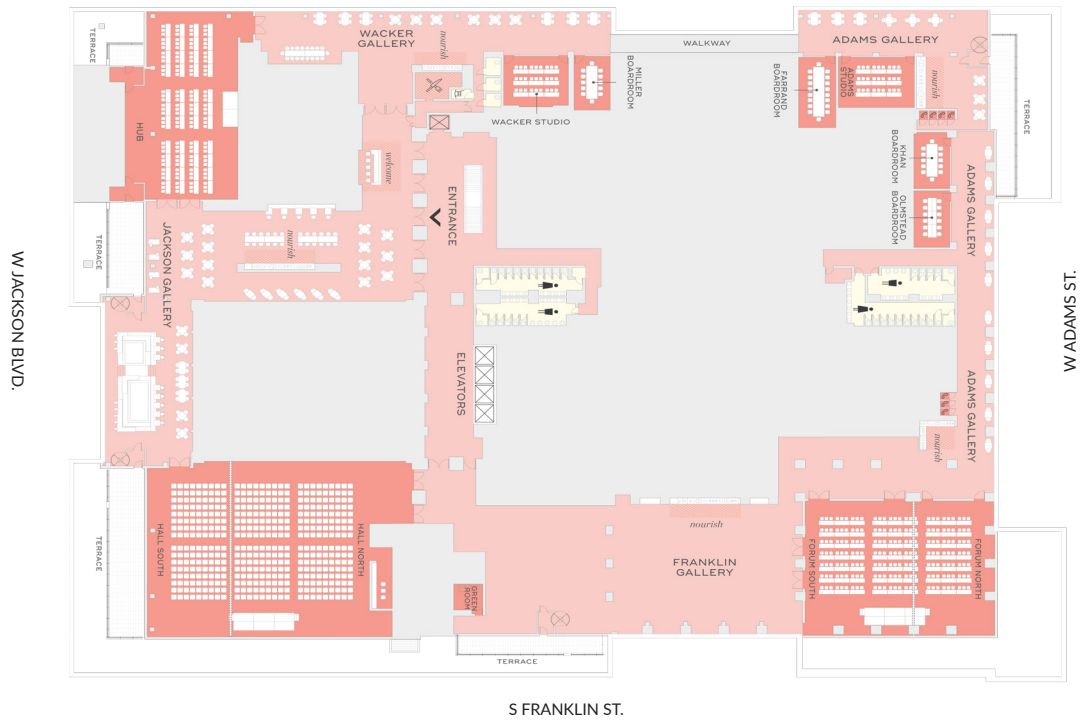

	DIMENSION [FT]	AREA [SQ FT]	CEILING HT [FT]	RECEPTION (MAX CAPACITY)	THEATER	CLASSROOM	ROUNDS [10-TOP]	U-SHAPE	CONFERENCE	PODS [6-TOP]	CRESCENT ROUNDS	HALF ROUNDS
The Hall	79' x 84'	8,019'	15'	869	646	363	420	-	-	378	280	345
The Hall with Stage	79' x 84'	8,019'	15'	869	627	330	390	-	-	378	280	350
Hall North	79' x 54'	5,387'	15'	761	432	231	260	-	-	252	210	200
Hall North with Stage	79' x 54'	5,387'	15'	761	396	210	260	-	-	252	210	200
Hall South	77' x 28'	2,632'	15'	417	204	99	120	-	-	144	98	100
Hall South with Stage	77' x 28'	2,632'	15'	417	192	90	120	-	-	126	84	100
Forum	56' x 71'	4,348'	15'	661	372	189	240	-	-	252	231	210
Forum with Stage	56' x 71'	4,348'	15'	661	341	189	240	-	-	210	196	200
Forum North	56' x 27'	1,809'	15'	281	144	72	100	51	42	72	56	70
Forum North with Stage	56' x 27'	1,809'	15'	281	132	63	80	45	36	60	56	60
Forum South	56' x 42'	2,539'	15'	380	260	105	150	51	42	144	98	105
Forum South with Stage	56' x 42'	2,539'	15'	380	209	105	120	45	36	120	84	90
Hub	85' x 36'	3,225'	16'	299	216	132	160	54	72	132	140	140
Adams Studio	23' x 30'	696'	11'	60	60	27	30	21	18	35	35	30
Wacker Studio	22' x 25'	575'	11'	40	40	27	30	18	18	24	27	27
Miller Boardroom	23' x 14'	351'	11'	-	-	-	-	-	12	-	-	-
Farrand Boardroom	30' x 14'	482'	11'	-	-	-	-	-	18	-	-	-
Kahn Boardroom	21' x 14'	361'	11'	-	-	-	-	-	12	-	-	-
Olmstead Boardroom	24' x 14'	364'	11'	-	-	-	20	-	12	12	14	15

TPA may be required for some meeting room layouts

This collateral is based on the latest information reasonably available and may be updated on a periodic basis. Please check with your Convene Account Manager for the latest information.

convene

CONVENE.COM | 888-730-7307