

# Convene Rathbone

**Meetings & Events**  
1 Rathbone Square, London

Opening Spring 2027

**9**

event spaces

**1,200**

full buyout capacity

**5017**

square meters

Convene's upcoming venue will unite its core conference expertise with state-of-the-art production capabilities such as 180-degree projection mapping, street-facing LED walls, and a dedicated rigging system. This unique blend can host bespoke events ranging from dynamic brand showcases to luxury receptions, high-powered summits, and industry-leading gatherings.

Designed by renowned architect, Frank Gehry, and MAKE Architects, the venue occupies a centrally located address, billed as one of the most connected locations in the city. The venue is located a one-minute walk from Tottenham Court Road Station, providing seamless access to the Elizabeth line. This provides a rapid two-minute travel time to Farringdon and the City of London, while offering international business travellers a direct, single-line connection to London Heathrow Airport.



FLEXIBLE MEETING  
AND EVENT SPACES

INNOVATIVE  
TECHNOLOGY

EVENT PLANNING  
AND MANAGEMENT

PREMIUM DESIGN

ON-SITE GOURMET  
CATERING

FULLY STAFFED  
AND SERVICED

[convene.com](https://convene.com)

**convene**

FLOORPLAN AND CAPACITIES

**LEGEND**

	BATHROOMS		RESPIRE
	ENCLAVE		COAT CLOSET
	LIFTS		ENTRANCE

	BATHROOMS & RESPITES
	GALLERY SPACES
	HUBS & BOARDROOMS
	NOURISH & WELCOME DESK
	BACK OF HOUSE
	DIGITAL SIGNAGE
	PARTITION WALL

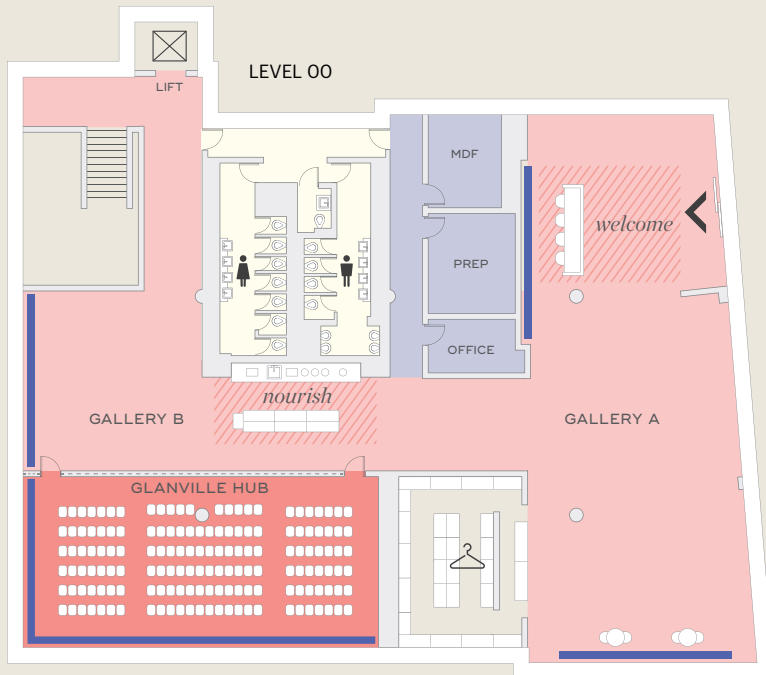
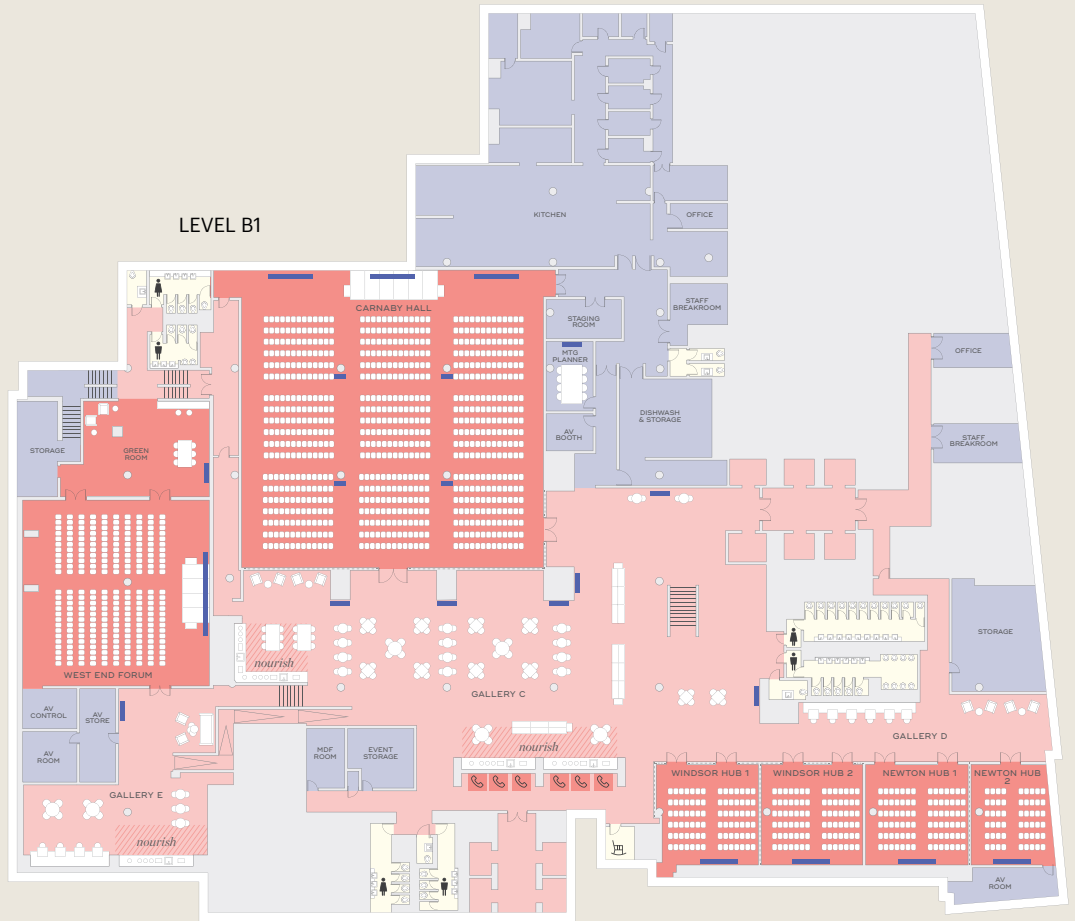

	Theatre with stage	Theatre without stage	Area (SQFT)	Area (SQM)
Carnaby Hall	741	819	6,997	650
West End Forum	250	300	2,669	248
Windsor Hub	135	162	1,647	153
Windsor Hub 1	70	84	802	75
Windsor Hub 2	70	84	802	75
Newton Hub	111	134	1,453	135
Newton Hub 1	70	84	802	75
Newton Hub 2	45	54	630	59
Glanville Hub	128	154	1,539	143

This collateral is based on the latest information reasonably available and may be updated on a periodic basis. Please check with your Convene Account Manager for the latest information.